

ULTRAMAR MFG. CORP.

MODELS 307, 317
Schematic, Socket
Trimmers, Alignments

MODEL 307

MODEL 317

NAME	FREQUENCY COVERAGE	NAME	FREQUENCY COVERAGE
A	AIRY WAVE - 13.4-50 METERS.	A	AIRY WAVE - 13.4-50 METERS.
B	MEDIUM WAVE - 1700-6000 K. C.	B	BROADCAST - 557-1750 K. C.
C	BROADCAST - 557-1750 K. C.	C	LONG WAVE - 600-2000 METERS.

ALIGNMENT PROCEDURE MODEL 307

OPER- DUMMY ATION ANT. NO.	CONNECT SIG. GEN. TO	SET SIG. GEN. DIAL AT	SET RADIO DIAL AT	WAVE BAND	ADJUST TRIMMERS	REMARKS
1	1/2 MFD 637G	465 645 KC M	1000 KC 500 M	C	A-B-C-D	IF ALIGNMENT
2	400 OHMS RED WIRE	18 M	18 M	A	1	DIAL CALIBRATION
3	400 OHMS RED WIRE	18 M	18 M	A	2-3	ROCK VAR. COND.
4	400 OHMS RED WIRE	5000 KC 60 M	5000 KC 60 M	B	4-5-6	
5	400 OHMS RED WIRE	2000 KC 150 M	2000 KC 150 M	B	7	ROCK VAR. COND.
6	400 OHMS RED WIRE	REPEAT OPERATION FOUR				
7	250 MMFD RED WIRE	3500 KC 800 M	1500 KC 800 M	C	8-9-10	
8	250 MMFD RED WIRE	600 KC 500 M	600 KC 500 M	C	11	ROCK VAR. COND.
9	250 MMFD RED WIRE	REPEAT OPERATION SEVEN				

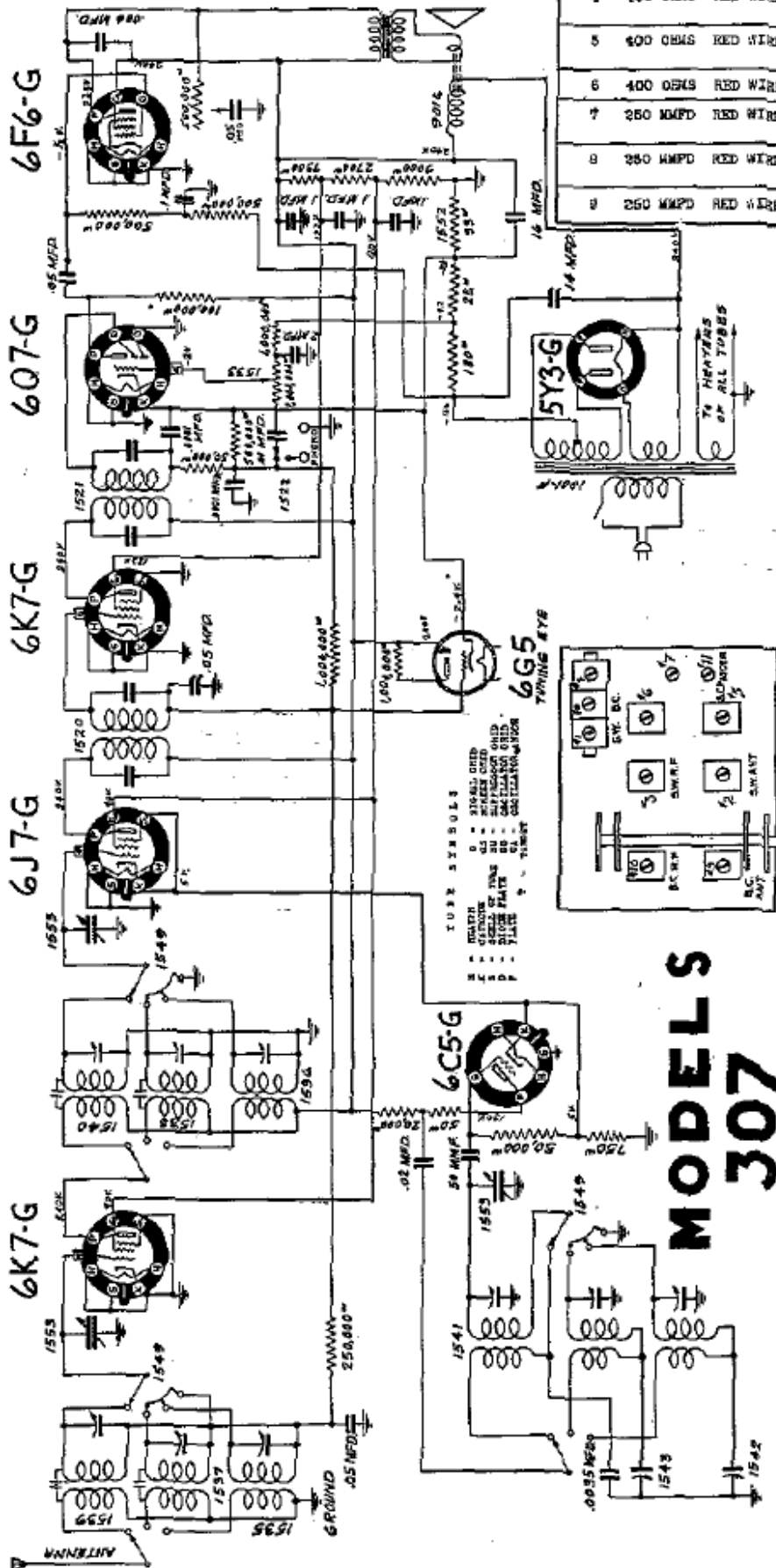

BOTTOM VIEW SHOWING
LOCATION OF TRIMMERS

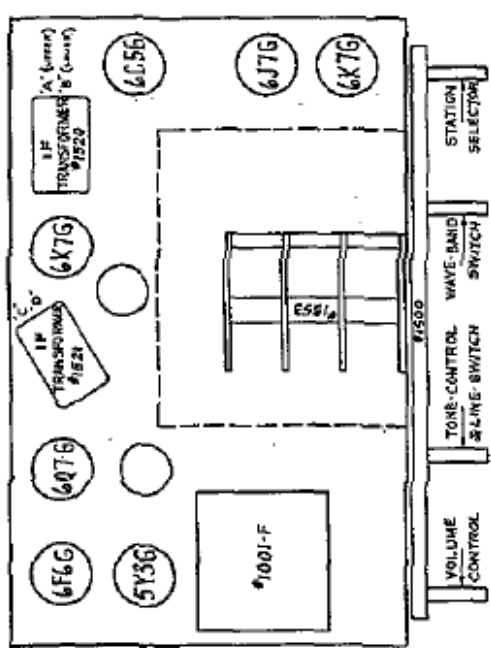

MODELS 307 317

ALIGNMENT PROCEDURE MODEL 317

OPER- DUMMY ATION ANT. NO.	CONNECT SIG. GEN. TO	SET SIG. GEN. DIAL AT	SET RADIO DIAL AT	WAVE BAND	ADJUST TRIMMERS	REMARKS
1	1/2 MFD	637G GRID	465 KC 645 M	1000 KC 500 M	C	IF ALIGNMENT
2	400 OHMS	RED WIRE	18 M	18 M	A	1 DIAL CALIBRATION
3	400 OHMS	RED WIRE	18 M	18 M	A	2-3 ROCK VAR. COND.
4	250 MMFD	RED WIRE	1500KC 200 M	1500 KC 200 M	B	4-8-10
5	250 MMFD	RED WIRE	600 KC 500 M	600 KC 500 M	B	11 ROCK VARIABLE CONDENSER
6	250 MMFD	RED WIRE	REPEAT OPERATION FOUR			
7	250 MMFD	RED WIRE	900 M	900 M	C	6-8-6
8	250 MMFD	RED WIRE	1800M	1800 M	C	7 ROCK VAR. COND.
9	250 MMFD	RED WIRE	REPEAT OPERATION SEVEN			