

TCS-430

SERVICE MANUAL

US Model
AEP Model
UK Model
E Model

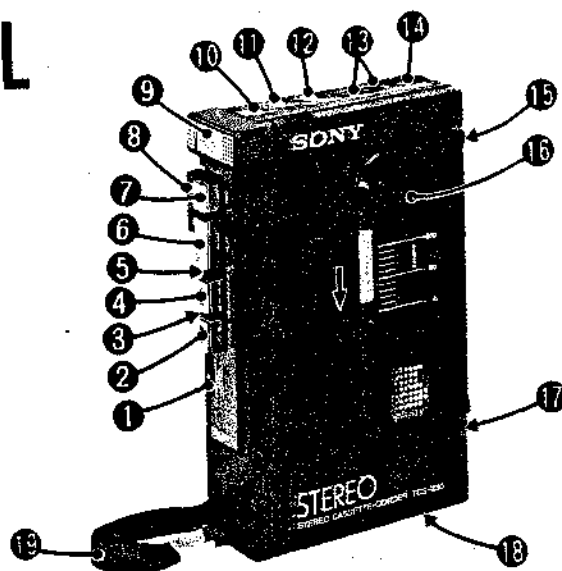

SPECIFICATIONS

Recording system	4-track 2-channel stereo
Speaker	Approx. 4.5 cm (1 ¹¹ / ₁₆ inches) dia.
Fast winding time	Approx. 2 min. with Sony C-60 cassette
Frequency response	70-10,000 Hz
Tape speed	40-14,000 Hz (playback) 4.8 cm/sec. (1 ⁷ / ₈ ips) approx. ^{+5%} adjustable in playback
Input	Microphone input jack (stereo minijack) sensitivity 0.2 mV (~72 dB) for 3 kilohms or lower impedance microphone
Output	Headphones (stereo minijack) load impedance 8-300 ohms
Power output	Headphones: 20 mW + 20 mW (32 ohms, at 10% harmonic distortion) Speaker: 170 mW (at 10% harmonic distortion)
Power requirements	3V DC Two R6 (size AA) batteries DC IN 3V jack accepts: • optional Sony AC-D2M AC power adaptor available in the United Kingdom for use on 240 V AC, 50 Hz, or available in the USA for use on 120 V AC, 60 Hz • optional Sony EBP-500A battery case for use on two R20 (size D) batteries • optional Sony DCC-70 car battery cord for use with 12V car battery

Batteries	Continuous recording (hours)
Sony batteries SUM-3 (NS)	Approx. 2
Sony Alkaline batteries AM3 (N)	Approx. 6.5

Tape Transport Mechanism Type MT430-06

Dimensions	Approx. 91.1 × 133.4 × 33.5 mm (w/h/d) (3 ⁵ / ₈ × 5 ¹ / ₈ × 1 ¹ / ₈ inches) incl. projecting parts and controls
Weight	Approx. 300 g (10.6 oz) incl. batteries, not incl. other accessories

PARTS IDENTIFICATION

- 1 SPEED CONTROL
- 2 ▼ FF/CUE (fast forward/cue) button
- 3 || PAUSE switch
- 4 ▲ REW/REVIEW (rewind/review) button
- 5 PB EQ (playback equalizer) selector
- 6 ▼ PLAY (playback) button
- 7 ● REC (record) button
- 8 STOP/EJECT button
- 9 Built-in one-point stereo microphone
- 10 REC/BATT (record/battery) indicator
- 11 PHONES (headphones) jack (stereo minijack)
- 12 MIC (microphone) (PLUG IN POWER) jack
- 13 TAPE COUNTER and reset button
- 14 VOLUME control
- 15 DC IN 3V (external power input) jack (right side)
- 16 Cassette compartment
- 17 Battery compartment (rear)
- 18 Speaker (rear)
- 19 Carrying strap

STEREO CASSETTE-CORDER
SONY®



SERVICING NOTE

Replacing chip components

All chip components should be connected and disconnected, using a tapered soldering iron [temperature of the iron tip: less than 280°C (536°F)], a pair of tweezers and braided wire.

Precautions for replacement

1. Do not disconnect the chip component forcefully. Otherwise, the pattern may peel off.
2. Never re-use a disconnected chip component. Dispose of all old chip components.
3. To protect the chip component, heating time for attaching the component should be within 3 seconds.

○ **Removing chip components**

(1) Removing solder at electrode

Remove the solder at the electrode, using a thin braided wire. Do not remove the solder of the part (chip component) attached adjacent to the electrode.

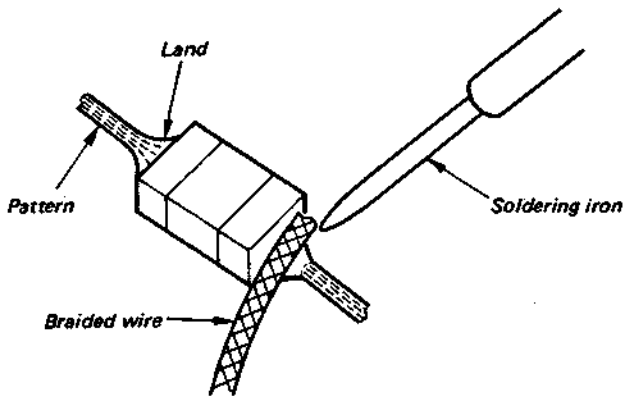

(2) Disconnecting chip components

Turn the tweezers with the soldering iron alternately applied to both electrodes, and the chip component will be disconnected. Take careful precautions while disconnecting, because if the chip component is forcefully removed the land may peel off. Never re-use a disconnected chip component.

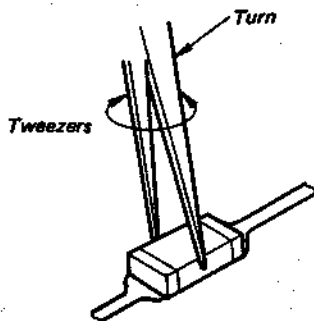

(3) Smoothing the soldered surface

After disconnecting the chip component, remove the solder by using a braided wire to smooth the land surface.

○ **Connecting chip components**

The value of chip components is not displayed on the main body. Take due precautions to avoid mixing new chip components with other ones.

(1) Applying solder to land on one side

Apply a thin layer of solder to the land on one side where the chip component is to be connected. Too much solder may cause bridging.



(2) Speedy soldering

Hold the chip component at the desired position, using tweezers, and apply the soldering iron in the arrow-marked direction. To protect the chip component, heating time should be within 3 seconds.

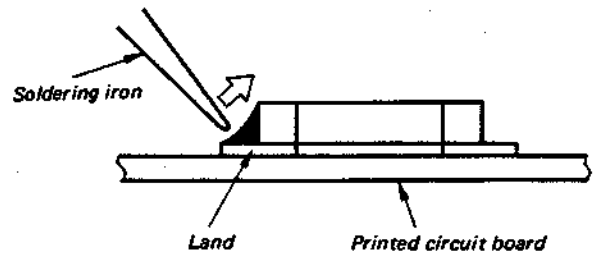

(3) Speedy soldering of electrode on the other side

Solder the electrode on the other side in the same way as in (2) above.

SECTION 1
DISASSEMBLY

Note: Follow the disassembly procedure in the numerical order given.

REAR CABINET REMOVAL

Remove four B1.7 x 8 screws and one (BLACK: M1.7 x 4, SILVER: M1.7 x 3.5) screw.

AUDIO BOARD REMOVAL

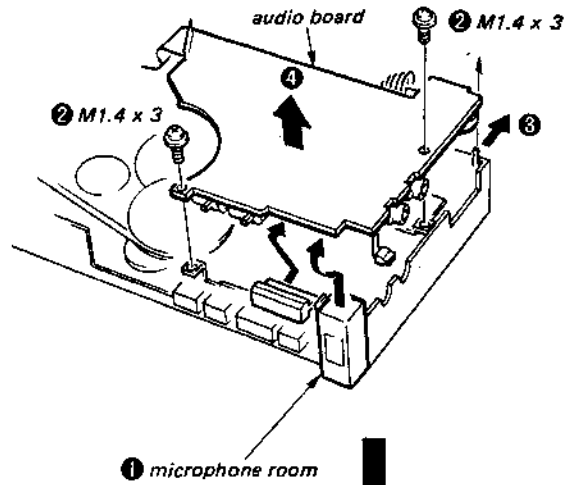

SERVO BOARD REMOVAL

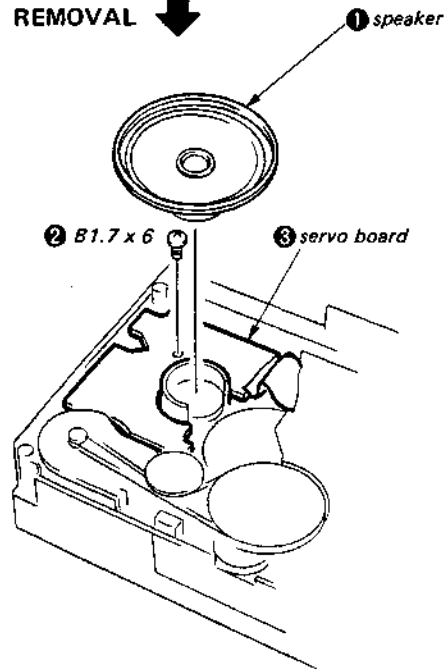

MECHANISM DECK REMOVAL

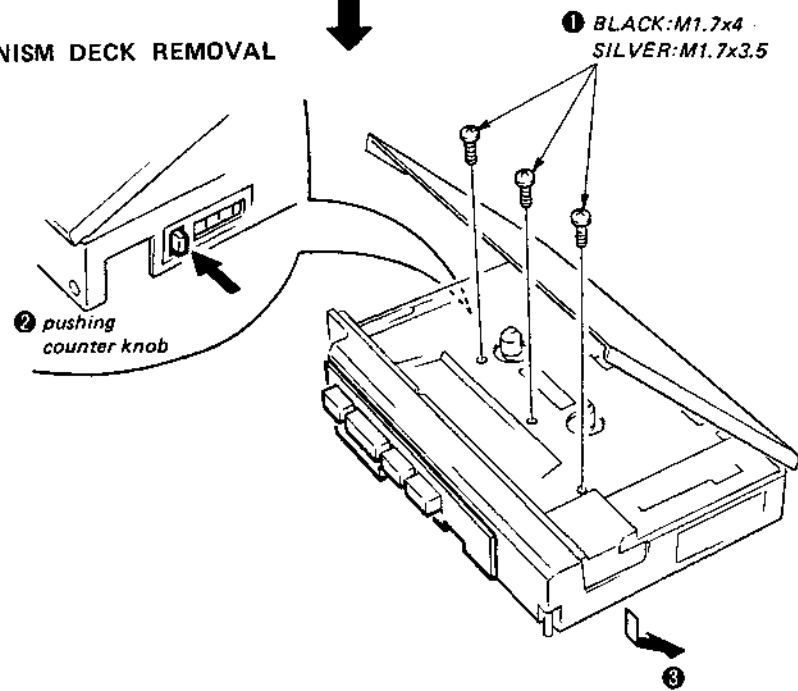

CASSETTE LID REMOVAL

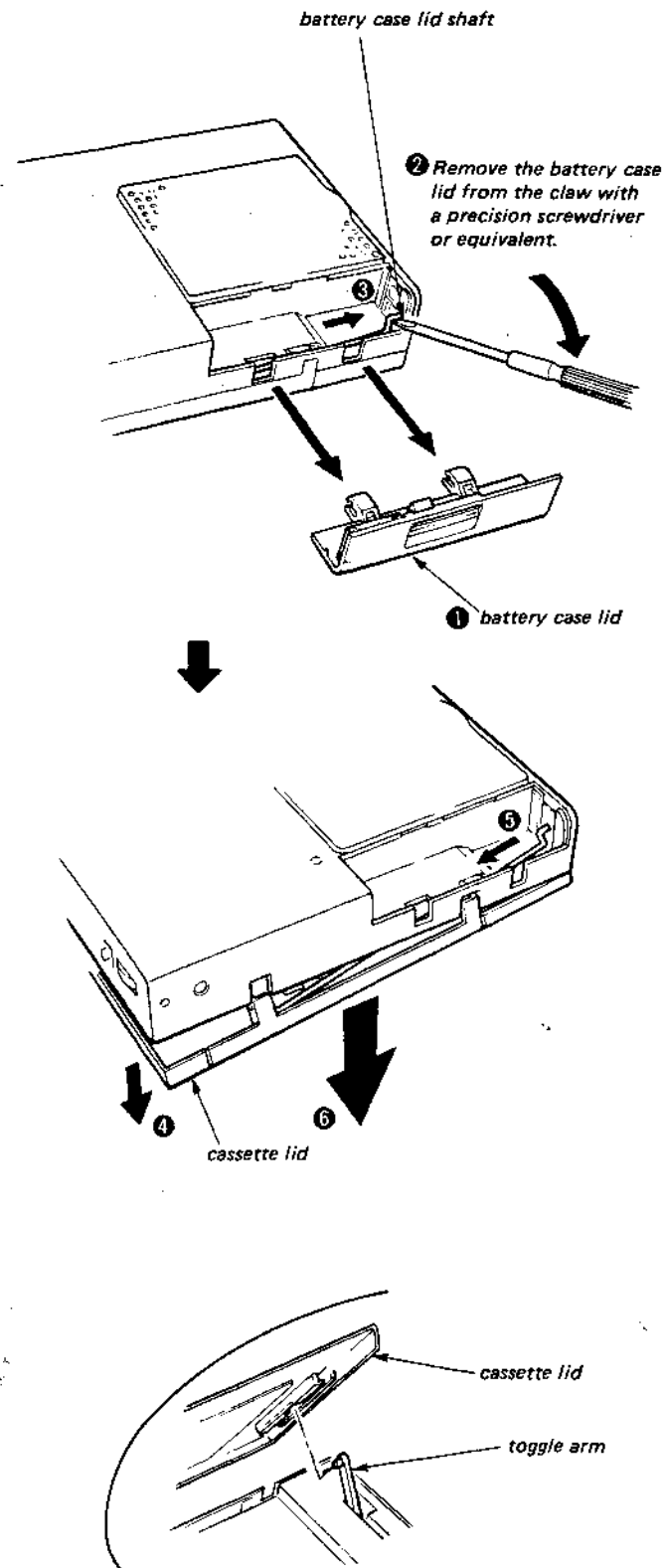

Caution for installation:
Assemble after inserting
the claw of toggle arm into
the cassette lid.

SECTION 2
MECHANICAL ADJUSTMENT

PRECAUTION

- Clean the following parts with a denatured-alcohol-moistened swab:

record/playback head	pinch roller
erase head	rubber belts
capstan	idlers
- Demagnetize the record/playback head with a head demagnetizer. (Do not bring the head demagnetizer close to the erase head.)
- Do not use a magnetized screwdriver for the adjustments.
- After the adjustments, apply suitable locking compound to the parts adjusted.
- The adjustments should be performed with the rated power supply voltage unless otherwise noted.

power supply voltage : 3V dc
SPEED CONTROL knob : center click

Torque Measurement

Torque	Meter Reading	Torque Meter
Forward	22 - 45 g-cm (0.3 - 0.62 oz-inch)	CQ-102C
Fast Forward and Rewind	65 - 100 g-cm (0.89 - 1.38 oz-inch)	CQ-201B
Back Tension	1.5 - 3.5 g-cm (0.02 - 0.048 oz-inch)	CQ-102C

Tape Tension Measurement

Meter	Meter Reading
CQ-403A	130 - 250 g (4.59 - 8.83 oz)

SECTION 3
DIAGRAMS

TCS-430 TCS-430

3-1. MOUNTING DIAGRAM

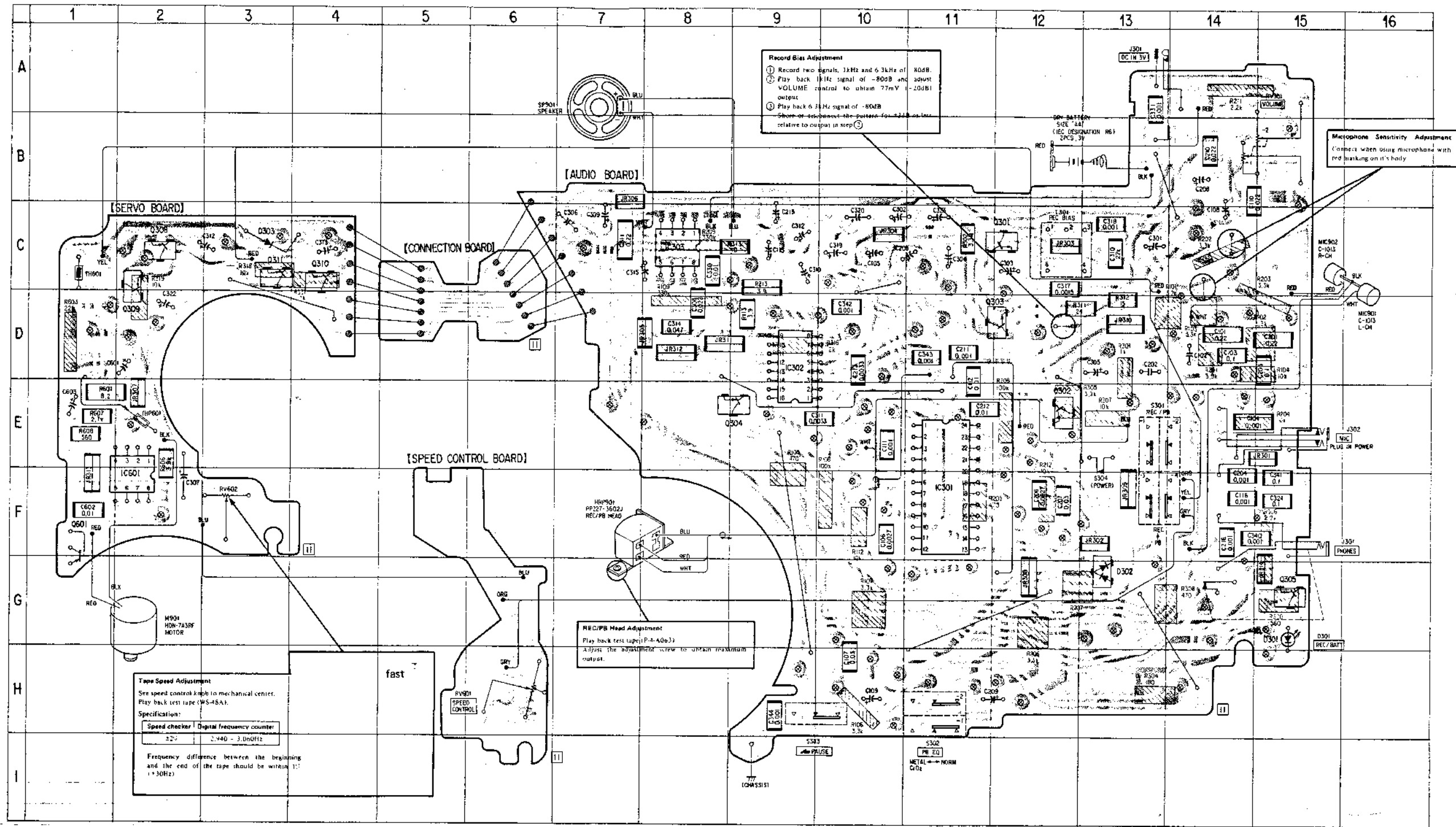

Note:
Color code of sleeving over the end of the jacket.

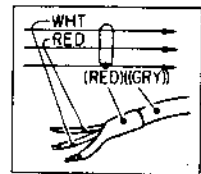

- — parts extracted from the component side.
- — parts extracted from the conductor side.
- ⊗ — Through hole.
- ▨ — component-side pattern.
- ▩ — Printed resistor.

● Semiconductor Lead Layouts

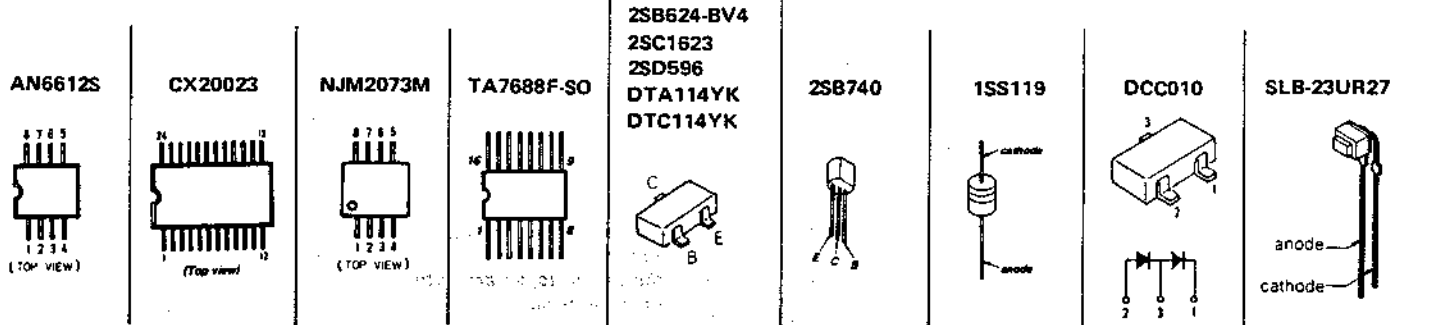

● Semiconductor Location

Ref. No.	Location	Ref. No.	Location
D301	G-15	Q301	C-12
D302	G-13	Q302	E-12
D303	C-3	Q303	D-12
		Q304	E-9
IC301	F-11	Q305	G-15
IC302	D-9	Q308	C-2
IC303	C-8	Q309	C-2
IC601	F-2	Q310	C-4
		Q311	C-3
		Q601	F-1

TCS-430 TCS-430

3-2. SCHEMATIC DIAGRAM

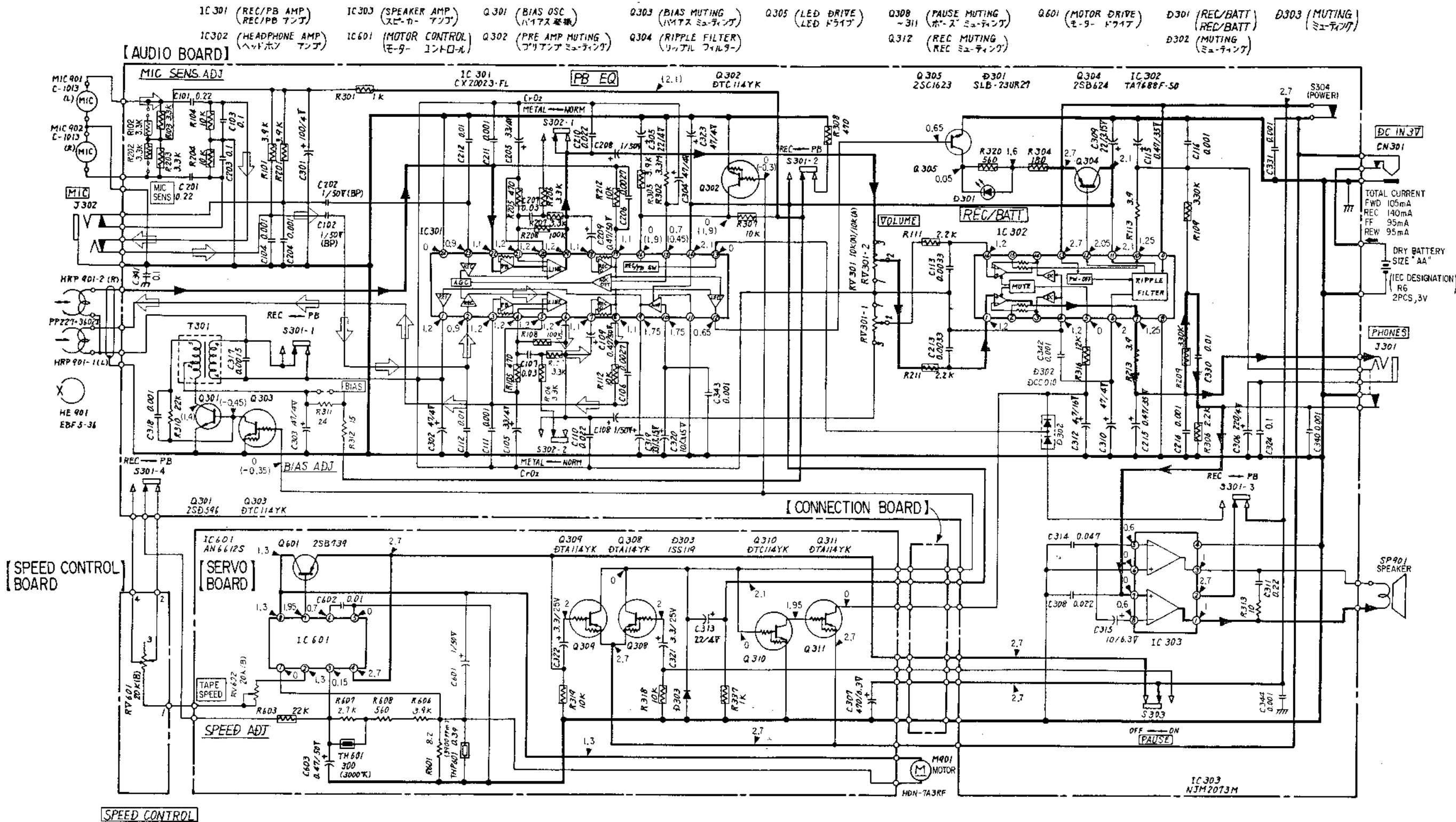

Notes:

- All capacitors are in μF unless otherwise noted. $\text{pF} = \mu\text{F} \times 10^{-6}$. 50 WV or less are not indicated except for electrolytics and tantalums.
- All resistors are in Ω and $\frac{1}{4}\text{W}$ or less unless otherwise specified.

- --- : B+ bus.
- --- : adjustment for repair.
- Power voltage is 3V and fed with regulated dc power supply from battery terminal. Voltages are dc with respect to ground in PLAY mode. () : REC
- Voltage variations may be noted due to normal production tolerances.

- --- : playback signal path.
- --- : record signal path.
- --- : printed resistor.

• Switch

Ref. No.	Switch	Potision
S301	REC/PB	PB
S302	PB, EQ	NORMAL
S303	PAUSE	OFF
S304	POWER	ON

SECTION 4 EXPLODED VIEWS

NOTE:

The mechanical parts with no reference number in the exploded views are not supplied.

Items marked "*" are not stocked since they are seldom required for routine service. Some delay should be anticipated when ordering these items.

The construction parts of an assembled part are indicated with a collation number in the remark column.

Color Indication of Appearance Parts
Example: (RED)..... KNOB, BALANCE (WHITE)

Cabinet's Color Parts' Color

(1)

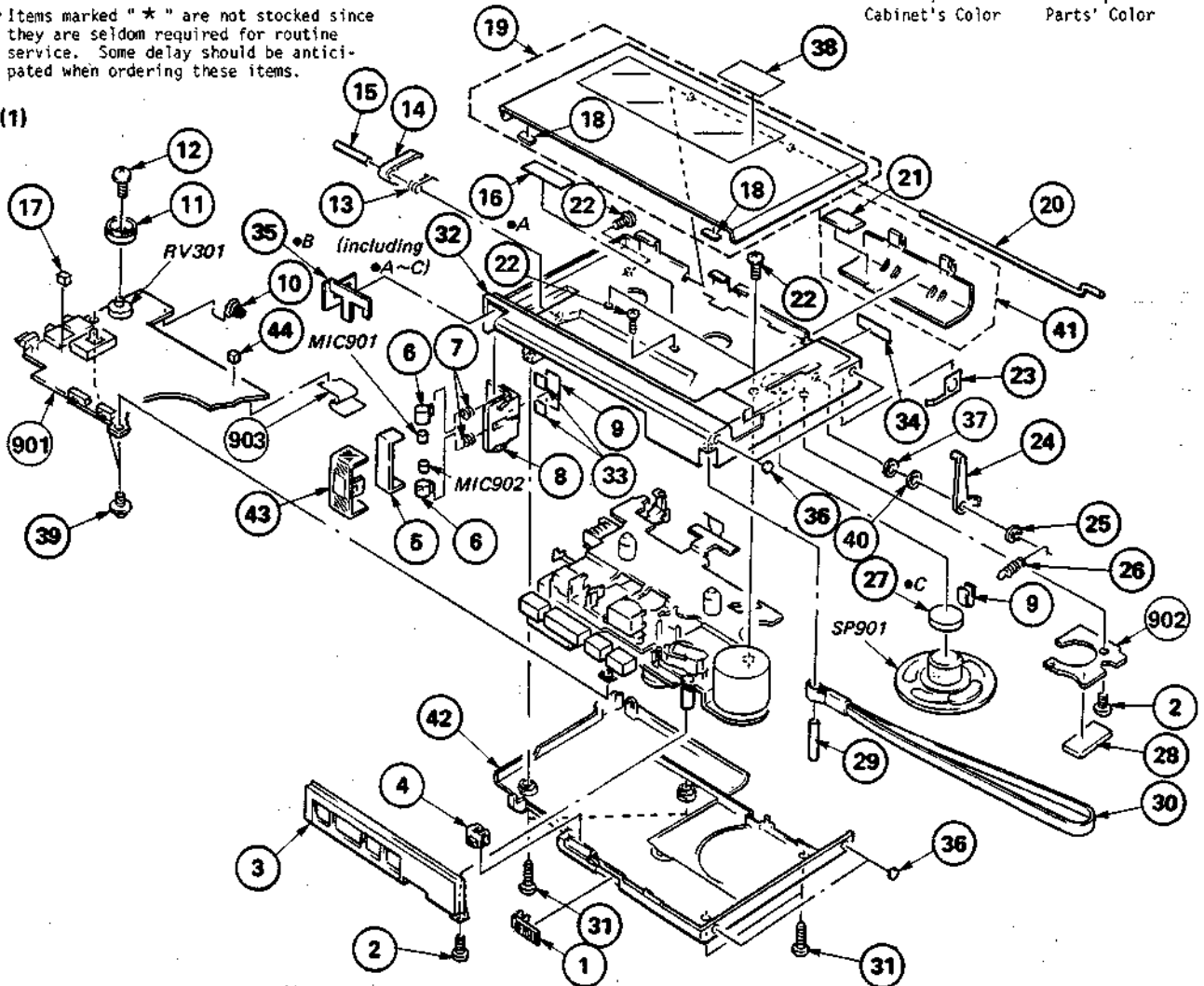

No.	Part No.	Description	Remarks	No.	Part No.	Description	Remarks
1	3-318-227-01	(BLACK)...KNOB, PAUSE		26	3-318-347-01	SPRING, TENSION	
	3-318-227-11	(SILVER)...KNOB, PAUSE		27	9-911-844-XX	CUSHION, SPEAKER	
2	3-318-203-01	SCREW (8 1.7X6), TAPPING		28	9-911-815-01	CUSHION	
3	X-3313-532-1	PANEL ASSY, CONTROL		29	3-318-322-01	SHAFT, STRAP	
4	3-313-555-01	(SILVER)...KNOB, SELECTION		30	3-320-908-01	STRAP, HAND	
	3-313-555-11	(BLACK)...KNOB, SELECTION		31	3-318-203-21	(SILVER)...SCREW (81.7X8), TAPPING	
5	*3-313-550-01	WINDSCREEN			3-318-203-31	(BLACK)...SCREW (81.7X8), TAPPING	
6	3-313-548-01	HOLDER, M		32	X-3313-534-1	(SILVER)...CABINET FRONT ASSY	
7	3-313-547-01	SPRING			X-3313-534-2	(BLACK)...CABINET FRONT ASSY	
8	3-313-558-01	ROOM, MICROPHONE		33	3-831-441-XX	CUSHION,CABINET UPPER 10X7X0.3	
9	3-831-441-11	CUSHION (B)		34	3-527-213-00	LABEL, SERIAL NUMBER	
10	3-318-210-01	SPRING		35	3-313-563-01	PAPER, SHIELD, LED	
11	3-313-556-01	KNOB, VOL		36	3-305-454-00	FOOT, RUBBER	
12	7-627-552-47	SCREW, PRECISION +P 1.7X4		37	3-701-439-01	WASHER (t=0.13)	
13	3-318-215-01	SPRING		38	3-703-710-01	STICKER, SONY SYMBOL (12)	
14	3-321-022-01	LEVER, EJECT		39	3-313-567-01	SCREW (M1.4X3), TAPPING; PWM	
15	3-703-357-06	PIN, PARALLEL (DIA. 1.6X14)		40	3-701-439-11	WASHER (t=0.25)	
16	3-578-101-11	PLATE, ORNAMENTAL		41	X-3313-529-1	(SILVER)...LID ASSY, BATTERY CASE	
17	9-911-839-XX	SPACER, RUBBER			X-3313-529-2	(BLACK)...LID ASSY, BATTERY CASE	
18	3-831-441-XX	CUSHION		42	X-3313-530-1	(SILVER)...CABINET REAR ASSY	
19	X-3313-533-1	(SILVER)...LID ASSY, CASSETTE			X-3313-530-2	(BLACK)...CABINET REAR ASSY	
	X-3313-533-2	(BLACK)...LID ASSY, CASSETTE		43	X-3313-531-1	(SILVER)...COVER ASSY, MIC	
20	*3-313-552-01	SHAFT, BATTERY CASE LID			X-3313-531-2	(BLACK)...COVER ASSY, MIC	
21	9-911-815-01	CUSHION		44	3-533-310-11	CUSHION	
22	3-318-204-91	(BLACK)...SCREW (M1.7X4), TAPPING		901	*A-3015-502-A	PC BOARD ASSY, AUDIO	
	3-329-105-01	(SILVER)...SCREW (M1.7X3.5), TAPPING		902	*A-3015-503-A	PC BOARD ASSY, SERVO	
23	3-318-209-01	TERMINAL BOARD, PLUS		903	1-616-835-11	PC BOARD, CONNECTION	
24	3-318-214-01	ARM, TOGGLE		MIC901	8-814-185-00	MICROPHONE UNIT (C-1013)	
25	7-624-104-04	RING, RETAINING (E)		MIC902	8-814-185-00	MICROPHONE UNIT (C-1013)	
				SP901	1-503-552-11	SPEAKER	

TCS-430

(2)

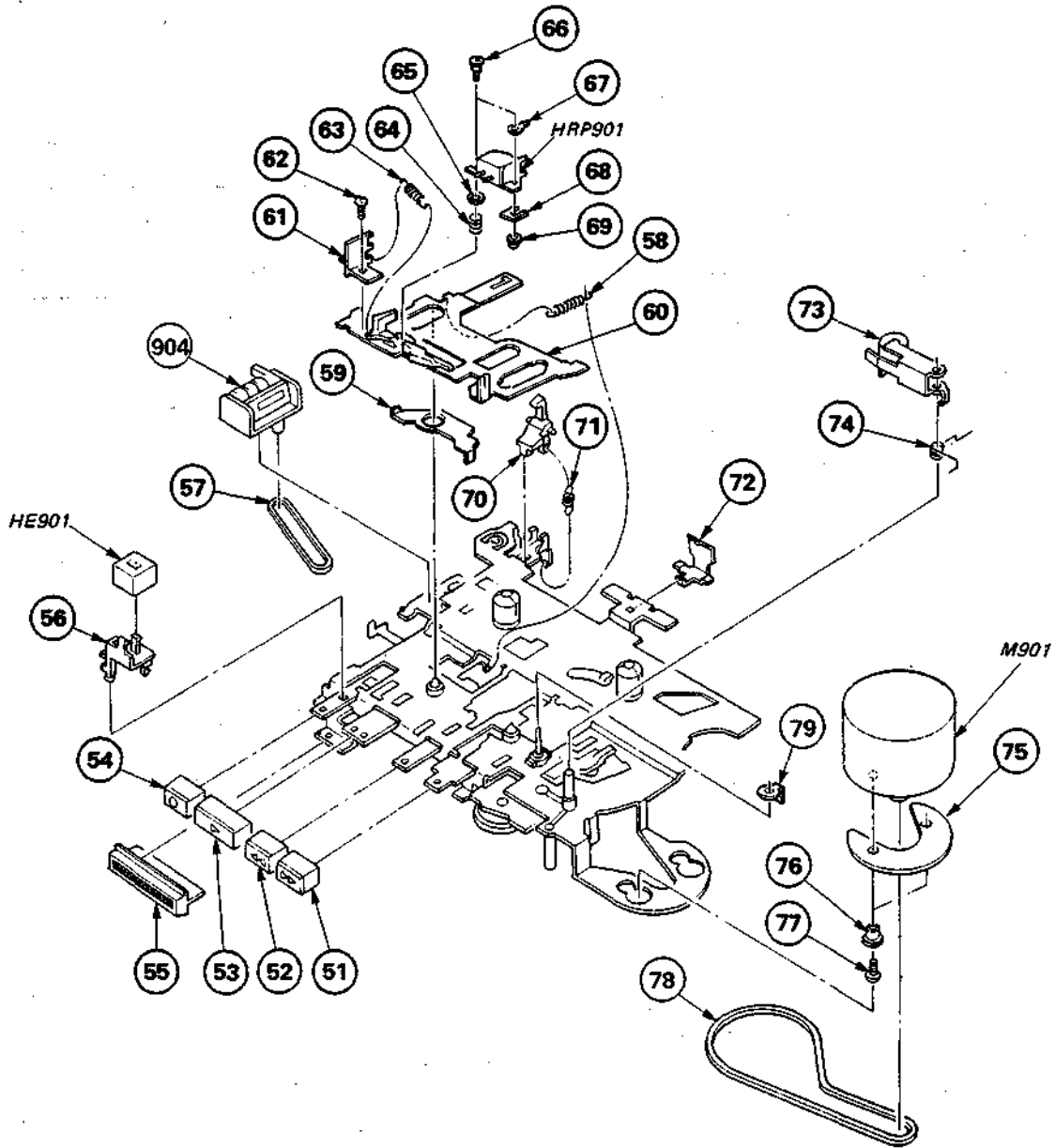

No.	Part No.	Description	Remarks	No.	Part No.	Description	Remarks
51	3-318-223-11	BUTTON, FF		68	3-578-138-01	SEAM (t=0.1)	
52	3-318-228-11	BUTTON, REW			3-578-138-11	SEAM (t=0.2)	
53	3-318-222-11	BUTTON, PLAY			3-578-138-21	SEAM (t=0.3)	
54	3-318-221-11	BUTTON, REC		69	3-318-309-01	SPACER, HEAD	
55	3-318-355-01	BUTTON, STOP		70	3-318-286-01	LEVER, ERASING PROTECTION	
56	3-318-285-01	BRACKET, ERASE HEAD		71	3-318-336-01	SPRING, TENSION	
57	3-318-239-01	BELT		72	3-318-269-01	SPRING	
58	3-565-927-00	SPRING, TENSION		73	A-3110-010-A	PINCH LEVER ASSY	
59	*3-318-267-01	LEVER, CR		74	3-318-275-01	SPRING	
60	X-3318-222-1	CHASSIS ASSY, HEAD		75	3-318-254-01	CUSHION, MOTOR	
61	3-318-287-01	GUIDE, TAPE		76	*3-318-310-01	COLLAR, MOTOR	
62	7-627-552-07	SCREW, PRECISION +P 1.7X2.5		77	7-627-552-67	SCREW, PRECISION +P 1.7X4.5	
63	3-318-238-01	SPRING, TENSION		78	3-318-242-01	BELT	
64	3-318-237-01	SPRING, COMPRESSION		79	*3-318-353-01	CONDUCTOR {2}	
65	7-688-001-01	W 2, SMALL		904	1-548-541-31	COUNTER	
66	3-318-240-02	SCREW (1.4), SPECIAL		HE901	8-658-096-02	HEAD, ERASE EBF5-36	
67	7-623-505-01	LUG, 2		HRP901	1-543-319-11	HEAD, MAGNETIC (REC/PB)	
				M901	1-541-414-21	MOTOR (HDN-7A3RF)	

(3)

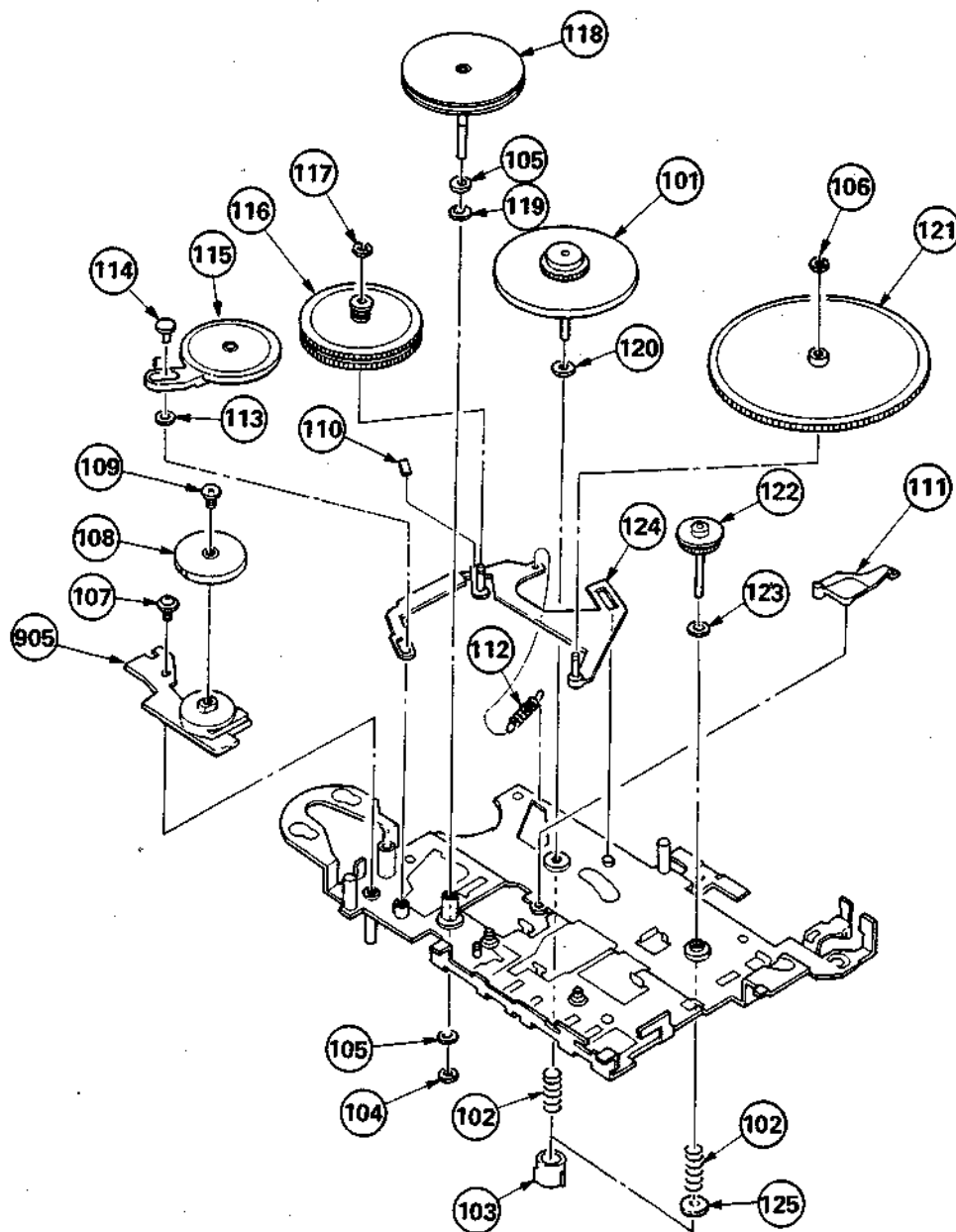

No.	Part No.	Description
101	X-3325-619-1	CLUTCH ASSY
102	3-318-241-01	SPRING, COMPRESSION
103	3-306-836-02	CAP, REEL, T
104	3-318-236-01	WASHER, POLY, SLIT
105	3-701-437-01	WASHER
106	3-570-615-00	POLY-WASHER (DIA.1.2)
107	3-318-201-21	SCREW (B) (1.4X5), TAPPING
108	3-318-379-01	KNOB, SPEED CONTROL
109	3-892-318-00	SCREW, SMALL
110	3-831-441-XX	CUSHION
111	3-318-288-01	ARM, FF
112	3-318-243-01	SPRING, TENSION
113	3-827-323-11	WASHER (DIA. 3.1)

No.	Part No.	Description
114	3-318-324-01	BUSHING, TOLER LEVER
115	X-3318-210-1	LEVER ASSY, FWD IDLER
116	X-3318-207-1	GEAR (A) ASSY, FR
117	3-578-265-11	WASHER, STOPPER
118	X-3313-509-1	FLYWHEEL ASSY
119	3-545-715-00	WASHER
120	3-701-437-41	WASHER
121	3-318-265-01	GEAR (B), FR
122	X-3318-204-1	GEAR ASSY, REW
123	3-701-437-21	WASHER
124	X-3318-208-1	LEVER ASSY, FR
125	3-325-690-01	WASHER, B.T
905	*1-621-305-11	PC BOARD, SPEED CONTROL

TCS-430

(4)

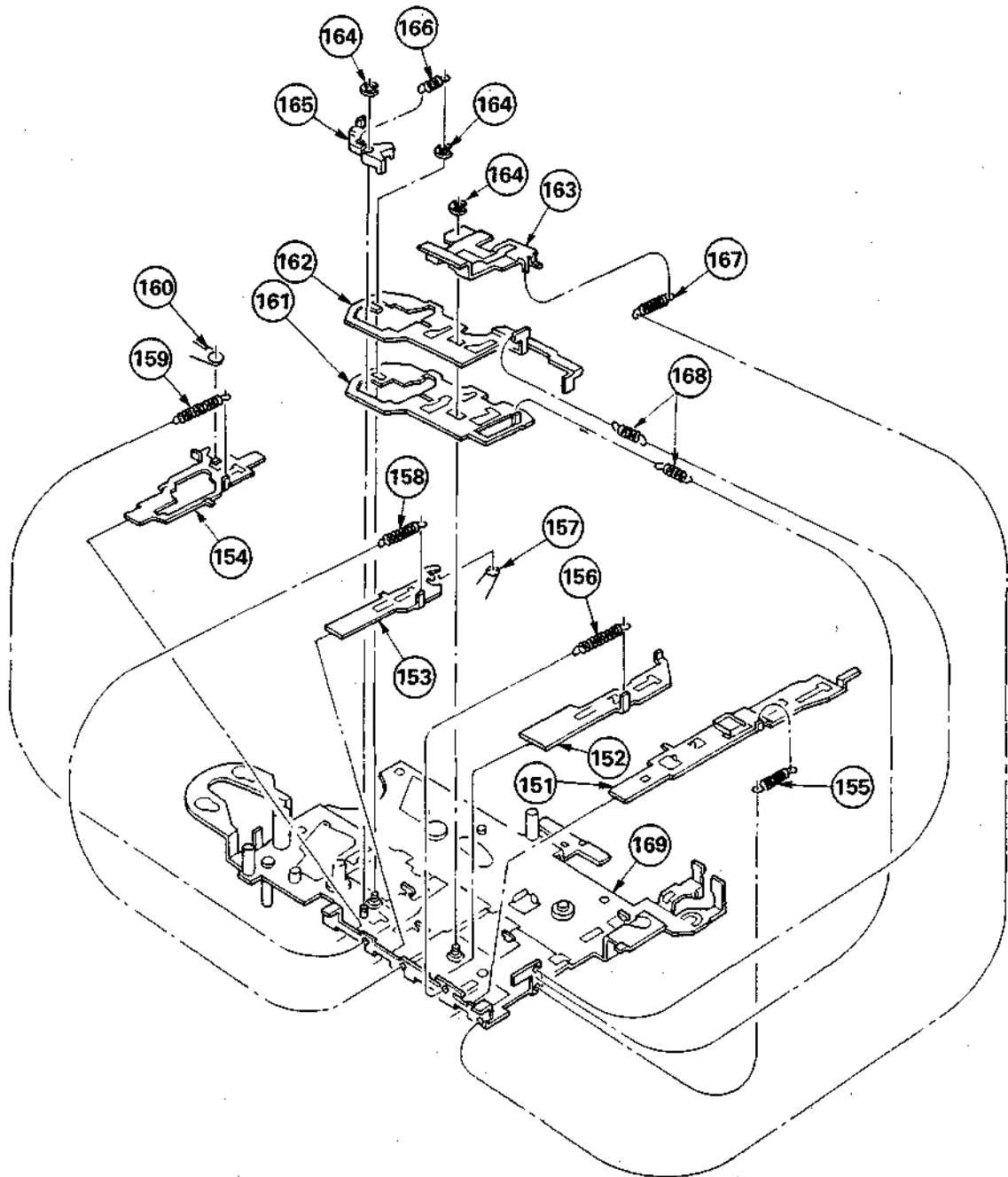

No.	Part No.	Description	Remarks	No.	Part No.	Description	Remarks
151	*3-318-289-11	LEVER, REC		161	*3-318-294-01	PLATE, LOCK	
152	*3-318-290-01	LEVER, PLAY		162	3-318-300-01	LEVER, SWITCH	
153	3-318-292-01	LEVER, REW		163	*3-318-293-01	LEVER, STOP	
154	3-318-291-01	LEVER, FR		164	7-624-101-01	RING, RETAINING E-1.2	
155	3-318-247-01	SPRING, TENSION		165	3-318-296-01	LEVER, SHUT-OFF	
156	3-318-246-01	SPRING, TENSION		166	3-318-351-01	SPRING, TENSION	
157	3-318-277-01	SPRING, REW		167	3-547-669-00	SPRING, TENSION	
158	3-318-251-01	SPRING, TENSION		168	3-318-248-01	SPRING, TENSION	
159	3-318-250-01	SPRING, TENSION		169	*X-3313-528-1	CHASSIS ASSY, MECHANICAL	
160	3-318-276-01	SPRING					

SECTION 5 ELECTRICAL PARTS LIST

NOTE:

Items marked "*" are not stocked since they are seldom required for routine service. Some delay should be anticipated when ordering these items.

If there are two or more same circuits in a set such as a stereophonic machine, only typical circuit parts may be indicated and capacitors and resistors in other same circuits may be omitted.

CAPACITORS:
MF:µF, PF:µµF.

RESISTORS
• All resistors are in ohms.
• F : nonflammable

COILS
• MMH : mH, UH : µH

SEMICONDUCTORS
In each case, U : µ, for example:
UA...: µA..., UPA...: µPA..., UPC...: µPC,
UPD...: µPD...

ELECTRICAL PARTS

Ref.No.	Part No.	Description			
901	*A-3015-502-A	PC BOARD ASSY, AUDIO			
902	*A-3015-503-A	PC BOARD ASSY, SERVO			
903	1-616-835-11	PC BOARD, CONNECTION			
904	1-548-541-31	COUNTER			
905	*1-621-305-11	PC BOARD, SPEED CONTROL			
C101	1-163-081-00	CERAMIC CHIP 0.22MF		25V	
C102	1-124-499-11	ELECT 1MF	20%	50V	
C103	1-163-038-00	CERAMIC CHIP 0.1MF		25V	
C104	1-163-047-00	CERAMIC CHIP 0.001MF	10%	50V	
C105	1-124-431-00	ELECT 33MF	20%	4V	
C106	1-163-014-00	CERAMIC CHIP 0.0027MF	10%	50V	
C107	1-163-810-00	CERAMIC CHIP 0.03MF	10%	25V	
C108	1-124-438-00	ELECT 1MF	20%	50V	
C109	1-124-465-00	ELECT 0.47MF	20%	50V	
C110	1-163-033-00	CERAMIC CHIP 0.022MF	10%	25V	
C111	1-163-141-00	CERAMIC CHIP 0.001MF	10%	50V	
C112	1-163-021-00	CERAMIC CHIP 0.01MF	10%	50V	
C113	1-163-015-00	CERAMIC CHIP 0.0033MF	10%	50V	
C115	1-131-345-00	TANTALUM 0.47MF	20%	35V	
C116	1-163-141-00	CERAMIC CHIP 0.001MF	10%	50V	
C201	1-163-081-00	CERAMIC CHIP 0.22MF		25V	
C202	1-124-499-11	ELECT 1MF	20%	50V	
C203	1-163-038-00	CERAMIC CHIP 0.1MF		25V	
C204	1-163-141-00	CERAMIC CHIP 0.001MF	10%	50V	
C205	1-124-431-00	ELECT 33MF	20%	4V	
C206	1-163-014-00	CERAMIC CHIP 0.0027MF	10%	50V	
C207	1-163-810-00	CERAMIC CHIP 0.03MF	10%	25V	
C208	1-124-438-00	ELECT 1MF	20%	50V	
C209	1-124-465-00	ELECT 0.47MF	20%	50V	
C210	1-163-033-00	CERAMIC CHIP 0.022MF	10%	25V	
C211	1-163-141-00	CERAMIC CHIP 0.001MF	10%	50V	
C212	1-163-021-00	CERAMIC CHIP 0.01MF	10%	50V	
C213	1-163-015-00	CERAMIC CHIP 0.0033MF	10%	50V	
C215	1-131-345-00	TANTALUM 0.47MF	20%	35V	
C216	1-163-141-00	CERAMIC CHIP 0.001MF	10%	50V	
C301	1-124-433-00	ELECT 100MF	20%	4V	
C302	1-124-432-00	ELECT 47MF	20%	4V	
C303	1-124-432-00	ELECT 47MF	20%	4V	
C304	1-124-432-00	ELECT 47MF	20%	4V	
C305	1-124-430-00	ELECT 22MF	20%	4V	
C306	1-123-827-00	ELECT 220MF	20%	4V	
C307	1-124-470-11	ELECT 470MF	20%	6.3V	
C308	1-163-033-00	CERAMIC CHIP 0.022MF	10%	25V	
C309	1-131-391-00	TANTALUM 22MF	10%	3.15V	

ELECTRICAL PARTS

Ref.No.	Part No.	Description			
C310	1-124-432-00	ELECT 47MF	20%	4V	
C311	1-163-081-00	CERAMIC CHIP 0.22MF		25V	
C312	1-124-461-11	ELECT 4.7MF	20%	16V	
C313	1-124-430-00	ELECT 22MF	20%	4V	
C314	1-163-035-00	CERAMIC CHIP 0.047MF		50V	
C315	1-124-435-00	ELECT 10MF	20%	6.3V	
C317	1-163-145-00	CERAMIC CHIP 0.0015MF	10%	50V	
C318	1-163-141-00	CERAMIC CHIP 0.001MF	10%	50V	
C319	1-131-392-00	TANTALUM 33MF	10%	3.15V	
C320	1-131-389-00	TANTALUM 10MF	10%	3.15V	
C321	1-124-436-00	ELECT 3.3MF	20%	25V	
C322	1-124-436-00	ELECT 3.3MF	20%	25V	
C323	1-124-432-00	ELECT 47MF	20%	4V	
C324	1-163-038-00	CERAMIC CHIP 0.1MF	10%	50V	
C330	1-163-021-00	CERAMIC CHIP 0.01MF	10%	50V	
C331	1-163-141-00	CERAMIC CHIP 0.001MF	10%	50V	
C340	1-163-141-00	CERAMIC CHIP 0.001MF	10%	50V	
C341	1-163-038-00	CERAMIC CHIP 0.1MF	10%	50V	
C342	1-163-141-00	CERAMIC CHIP 0.001MF	10%	50V	
C343	1-163-141-00	CERAMIC CHIP 0.001MF	10%	50V	
C344	1-163-141-00	CERAMIC CHIP 0.001MF	10%	50V	
C601	1-124-438-00	ELECT 1MF	20%	50V	
C602	1-163-021-00	CERAMIC CHIP 0.01MF	10%	50V	
C603	1-124-465-00	ELECT 0.47MF	20%	50V	
CN301	1-507-723-00	JACK, EXTENTION POWER (DC IN 3V)			
D301	8-719-908-16	DIODE SLB-23UR27			
D302	8-719-936-79	DIODE DCC010			
D303	8-719-911-19	DIODE 1SS119			
HE901	8-658-096-02	HEAD, ERASE EBF5-36			
HRP901	1-543-319-11	HEAD, MAGNETIC (REC/PB)			
IC301	8-759-907-63	IC CX20023			
IC302	8-759-205-43	IC TA7688F-S0			
IC303	8-759-701-02	IC NJM2073M			
IC601	8-759-400-12	IC AN6612S			
J301	1-562-785-11	JACK (PHONES)			
J302	1-507-999-11	JACK (MIC)			
JR301	1-216-295-00	METAL CHIP 0	5%	1/10W	
JR302	1-216-295-00	METAL CHIP 0	5%	1/10W	
JR303	1-216-295-00	METAL CHIP 0	5%	1/10W	
JR304	1-216-295-00	METAL CHIP 0	5%	1/10W	
JR305	1-216-295-00	METAL CHIP 0	5%	1/10W	
JR306	1-216-295-00	METAL CHIP 0	5%	1/10W	

ELECTRICAL PARTS

Ref.No.	Part No.	Description			
JR307	1-216-295-00	METAL CHIP	0	5%	1/10W
JR308	1-216-296-00	METAL CHIP	0	5%	1/8W
JR309	1-216-296-00	METAL CHIP	0	5%	1/8W
JR310	1-216-296-00	METAL CHIP	0	5%	1/8W
JR311	1-216-296-00	METAL CHIP	0	5%	1/8W
JR312	1-216-296-00	METAL CHIP	0	5%	1/8W
JR313	1-216-296-00	METAL CHIP	0	5%	1/8W
JR314	1-216-296-00	METAL CHIP	0	5%	1/10W
M901	1-541-414-21	MOTOR (HON-7A3RF)			
MIC901	8-814-185-00	MICROPHONE UNIT (C-1013)			
MIC902	8-814-185-00	MICROPHONE UNIT (C-1013)			
Q301	8-729-159-64	TRANSISTOR 2SD596			
Q302	8-729-900-52	TRANSISTOR DTC114YK			
Q303	8-729-900-52	TRANSISTOR DTC114YK			
Q304	8-729-102-44	TRANSISTOR 2SB624-BV4			
Q305	8-729-100-66	TRANSISTOR 2SC1623			
Q308	8-729-901-46	TRANSISTOR DTA114YK			
Q309	8-729-901-46	TRANSISTOR DTA114YK			
Q310	8-729-900-52	TRANSISTOR DTC114YK			
Q311	8-729-901-46	TRANSISTOR DTA114YK			
Q601	8-729-374-02	TRANSISTOR 2SB740			
R101	1-249-424-11	CARBON	3.9K	5%	1/6W
R102	1-249-423-11	CARBON	3.3K	5%	1/6W
R103	1-249-423-11	CARBON	3.3K	5%	1/6W
R104	1-249-429-11	CARBON	10K	5%	1/6W
R105	1-249-413-11	CARBON	470	5%	1/6W
R106	1-249-423-11	CARBON	3.3K	5%	1/6W
R107	1-249-423-11	CARBON	3.3K	5%	1/6W
R108	1-249-441-11	CARBON	100K	5%	1/6W
R109	1-215-481-00	CARBON	330K	5%	1/6W
R111	1-249-421-11	CARBON	2.2K	5%	1/6W
R112	1-249-429-11	CARBON	10K	5%	1/6W
R113	1-216-306-11	METAL CHIP	3.9	5%	1/10W
R201	1-249-424-11	CARBON	3.9K	5%	1/6W
R202	1-249-423-11	CARBON	3.3K	5%	1/6W
R203	1-249-423-11	CARBON	3.3K	5%	1/6W
R204	1-249-429-11	CARBON	10K	5%	1/6W
R205	1-249-413-11	CARBON	470	5%	1/6W
R206	1-249-423-11	CARBON	3.3K	5%	1/6W
R207	1-249-423-11	CARBON	3.3K	5%	1/6W
R208	1-249-441-11	CARBON	100K	5%	1/6W
R209	1-215-481-00	CARBON	330K	5%	1/6W
R211	1-249-421-11	CARBON	2.2K	5%	1/6W
R212	1-249-429-11	CARBON	10K	5%	1/6W
R213	1-216-140-00	METAL CHIP	3.9	5%	1/8W
R301	1-249-417-11	CARBON	1K	5%	1/6W
R302	1-216-133-00	METAL CHIP	3.3M	5%	1/10W
R304	1-249-408-11	CARBON	180	5%	1/6W
R305	1-249-424-11	CARBON	3.9K	5%	1/6W
R306	1-249-421-11	CARBON	2.2K	5%	1/6W
R307	1-249-429-11	CARBON	10K	5%	1/6W
R308	1-249-413-11	CARRON	470	5%	1/6W
R310	1-216-081-00	METAL CHIP	22K	5%	1/10W
R311	1-216-010-00	METAL CHIP	24	5%	1/10W
R312	1-216-005-00	METAL CHIP	15	5%	1/10W
R313	1-216-001-00	METAL CHIP	10	5%	1/10W
R316	1-249-430-11	CARBON	12K	5%	1/6W

ELECTRICAL PARTS

Ref.No.	Part No.	Description			
R318	1-249-429-11	CARBON	10K	5%	1/6W
R319	1-249-429-11	CARBON	10K	5%	1/6W
R320	1-249-414-11	CARBON	560	5%	1/6W
R337	1-249-417-11	CARBON	1K	5%	1/6W
R601	1-216-148-00	METAL CHIP	8.2	5%	1/8W
R603	1-249-433-11	CARBON	22K	5%	1/6W
R606	1-216-063-00	METAL CHIP	3.9K	5%	1/10W
R607	1-216-059-00	METAL CHIP	2.7K	5%	1/10W
R608	1-216-043-00	METAL CHIP	560	5%	1/10W
RV301	1-230-327-11	RES, VAR, CARBON 10K/10K (VOLUME)			
RV601	1-230-888-11	RES, VAR, CARBON 20K (SPEED CONTROL)			
RV602	1-230-600-11	RES, ADJ, CARBON 20K			
S301	1-554-745-11	SWITCH, SLIDE (REC/PB)			
S302	1-570-114-11	SWITCH, SLIDE (PB EQ)			
S303	1-553-510-00	SWITCH, SLIDE (PAUSE)			
S304	1-554-297-00	SWITCH, LEAF (POWER)			
SP901	1-503-552-11	SPEAKER			
T301	1-433-251-00	TRANSFORMER, BIAS OSCILLATOR			
TH601	1-806-716-00	THERMISTOR			
THP601	1-807-779-11	THERMISTOR, POSITIVE (0.39)			

ACCESSORY & PACKING MATERIAL

Part No.	Description
3-313-546-01	CUSHION
3-313-566-01	CASE, CARRYING
3-332-029-01	(US).....INDIVIDUAL CARTON
3-332-031-01	(AEP,UK,E)...INDIVIDUAL CARTON
3-332-034-01	SPACER
3-527-213-00	LABEL, SERIAL NUMBER
3-570-631-61	BAG, POLYETHYLENE
3-701-622-00	(US)...BAG, POLYETHYLENE
3-703-710-01	STICKER, SONY SYMBOL (12)
3-704-016-01	(AEP,E)...LABEL, COLOR (BLACK)
3-704-027-01	(AEP,E)...LABEL, COLOR (SILVER)
3-765-886-11	(AEP,E)...MANUAL, INSTRUCTION
3-765-886-21	(US,UK)...MANUAL, INSTRUCTION
3-795-748-21	(US)...SAFETY INSTRUCTIONS, HEADPHONE
8-952-168-99	MDR-010L

Sony Corporation
Audio Group

9-952-628-11

English
87B0494-1
Printed in Japan
© 1987. 2