

# SEQ-120

## SERVICE MANUAL

US Model  
AEP Model  
E Model

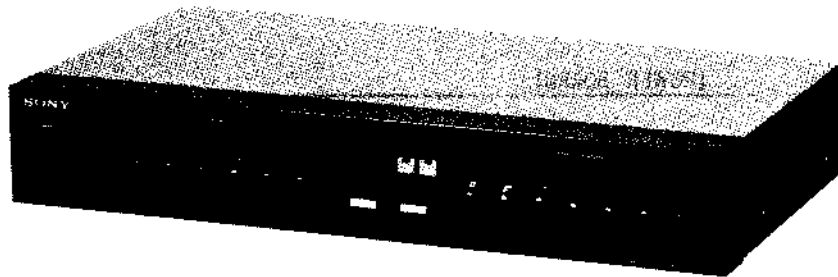

### SPECIFICATIONS

Power requirement	AEP model: 220 V ac (or 240 V ac adjustable by authorized Sony personnel), 50/60 Hz US model: 120 V ac, 60 Hz E model: 110 – 120 or 220 – 240 V ac adjustable, 50/60 Hz
Power consumption	5 W
AC outlet	AEP model: 100 W switched US, E model: 100 W unswitched
Inputs	LINE IN (phono type) 245 mV (-10 dBs)/50 kilohms TAPE (phono type) 245 mV (-10 dBs)/50 kilohms
Outputs	LINE OUT (phono type) 245 mV (-10 dBs) Output impedance 470 ohms TAPE (phono type) 245 mV (-10 dBs) Output impedance 4.7 kilohms
Graphic equalizer	Boost/cut range $\pm 10$ dB Center frequencies: 60 Hz, 150 Hz, 400 Hz, 1 kHz, 2.4 kHz, 6 kHz, 15 kHz
Frequency response	LINE 20 Hz – 50 kHz $\begin{matrix} +0 \\ -1.5 \end{matrix}$ dB
Distortion	LINE Less than 0.01% (1 V output, 1 kHz)
Signal-to-noise ratio	LINE More than 100 dB (IHF-A, 1 V output)
Dimensions	AEP model: Approx. 430 x 80 x 262 mm (w/h/d) (17 x 3 $\frac{1}{4}$ x 10 $\frac{3}{8}$ inches) US, E model: Approx. 430 x 80 x 255 mm (w/h/d) (17 x 3 $\frac{1}{4}$ x 10 $\frac{1}{8}$ inches) including projecting parts and controls
Weight	Approx. 2.4 kg (5 lb 5 oz), net Approx. 2.8 kg (6 lbs 3 oz), in shipping carton

### Equalization characteristics

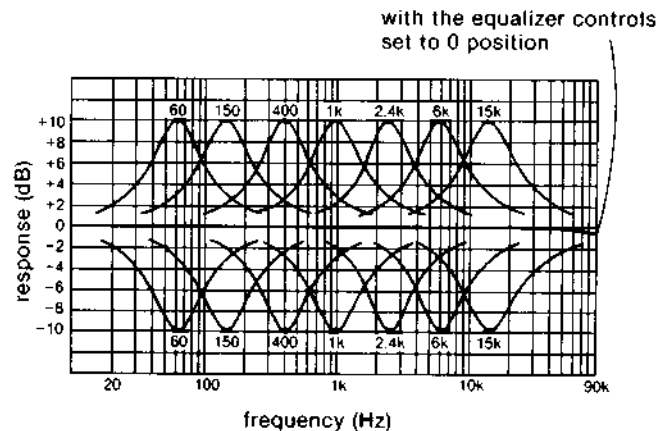

### SAFETY-RELATED COMPONENT WARNING!!

COMPONENTS IDENTIFIED BY SHADING AND MARK  ON THE SCHEMATIC DIAGRAMS AND IN THE PARTS LIST ARE CRITICAL TO SAFE OPERATION. REPLACE THESE COMPONENTS WITH SONY PARTS WHOSE PART NUMBERS APPEAR AS SHOWN IN THIS MANUAL OR IN SUPPLEMENTS PUBLISHED BY SONY.

# GRAPHIC EQUALIZER

# SONY®

AUD



**SAFETY CHECK-OUT (US Model)**

After correcting the original service problem, perform the following safety check before releasing the set to the customer:

Check the antenna terminals, metal trim, "metallized" knobs, screws, and all other exposed metal parts for AC leakage. Check leakage as described below.

**LEAKAGE TEST**

The AC leakage from any exposed metal part to earth ground and from all exposed metal parts to any exposed metal part having a return to chassis, must not exceed 0.5 mA (500 microampers). Leakage current can be measured by any one of three methods.

1. A commercial leakage tester, such as the Simpson 229 or RCA WT-540A. Follow the manufacturers' instructions to use these instruments.
2. A battery-operated AC milliammeter. The Data Precision 245 digital multimeter is suitable for this job.

3. Measuring the voltage drop across a resistor by means of a VOM or battery-operated AC voltmeter. The "limit" indication is 0.75 V, so analog meters must have an accurate low-voltage scale. The Simpson 250 and Sanwa SH-63Trd are examples of a passive VOM that is suitable. Nearly all battery operated digital multimeters that have a 2 V AC range are suitable. (See Fig. A)

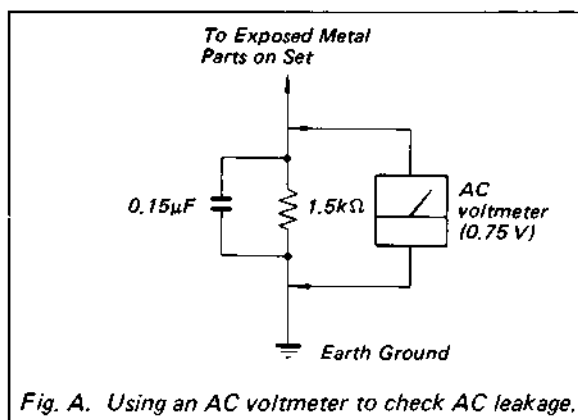
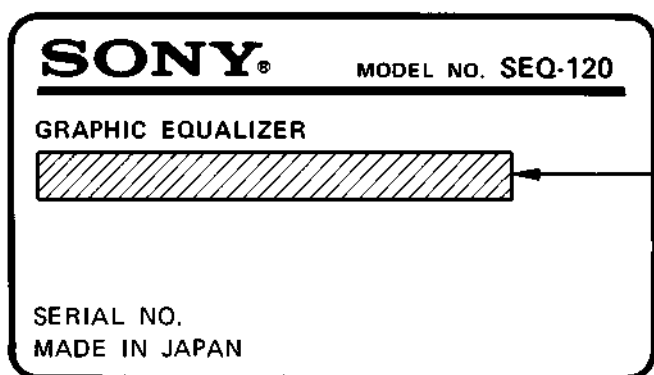

Fig. A. Using an AC voltmeter to check AC leakage.

**MODEL IDENTIFICATION**

— Specification Label —



US model:	AC 120 V 60 Hz 5 W
AEP model:	AC 220 V 50/60 Hz 5 W
E model:	AC 110 - 120/220 - 240 ~ 50/60 Hz 5 W

## LOCATION AND FUNCTION OF CONTROLS

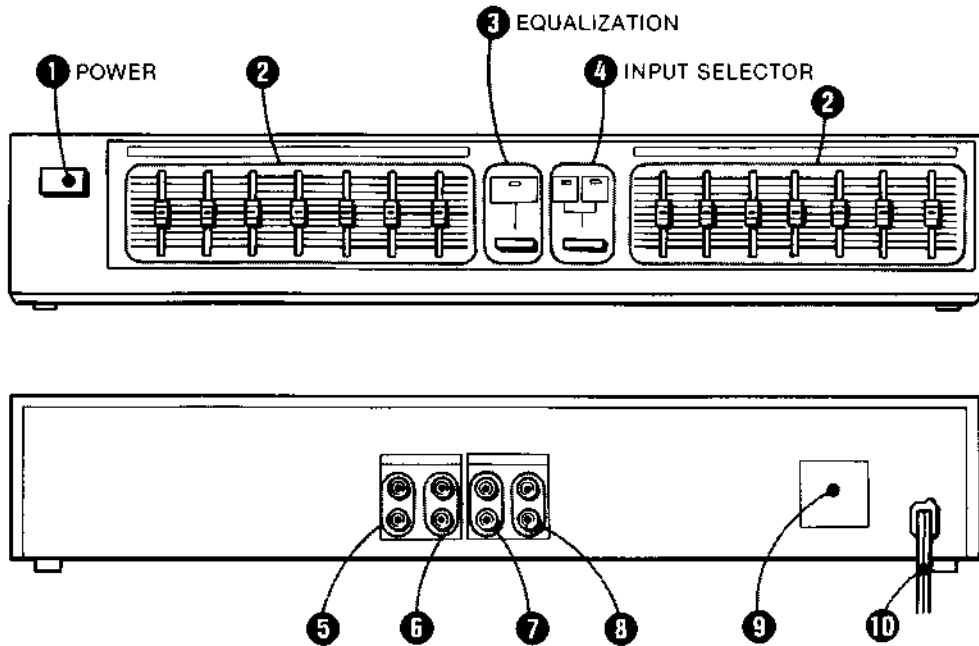

### Front panel

- 1 POWER switch**
- 2 Equalizer controls**  
Slide upwards or downwards to equalize the signal selected by the INPUT SELECTOR button.
- 3 EQUALIZATION button and indicator**  
Depress this button to add the set equalization values. The associated indicator will light up. To cut equalization, release the button (indicator off).
- 4 INPUT SELECTOR button and indicators**  
Press the button to select the input source to equalize or to listen to. The indicator above the button will light up.  
**LINE:** For playback output from the turntable, CD (compact disc) player or tuner connected to the amplifier.  
**TAPE:** For playback output from the tape deck connected to the TAPE RECORDER TAPE jacks.
- 7 TAPE RECORDER REC OUT jacks**  
When a tape deck is connected for recording, connect these jacks to the line input jacks of the deck.
- 8 TAPE RECORDER TAPE jacks**  
When a tape deck is connected for playback, connect these jacks to the line output jacks of the deck.
- 9 AC OUTLET**  
This outlet is used for connecting the power cord of compact disc player, tuner, tape deck or other program sources.  
**SWITCHED (AEP model):** This outlet interlocks with the POWER switch of the graphic equalizer: the power on/off of the connected equipment can be controlled by the POWER switch of the equalizer, when the power switch of the connected equipment is set to ON.  
This is convenient when the program source to be played frequently is connected to this outlet. The power consumption is 100W.  
**UNSWITCHED (US, E model):** This outlet provides power irrespective of whether the POWER switch of the equalizer is ON or OFF. Connect equipment with a power consumption of 100W maximum to this outlet.

### Rear panel

- 5 LINE IN jacks**  
Connect these jacks to the tape output or GRAPHIC EQ OUT jacks of the amplifier.
- 6 LINE OUT jacks**  
Connect these jacks to the tape input or GRAPHIC EQ IN jacks of the amplifier.
- 10 Power cord**

SECTION 1  
DIAGRAMS

1-1. MOUNTING DIAGRAM - Conductor Side -

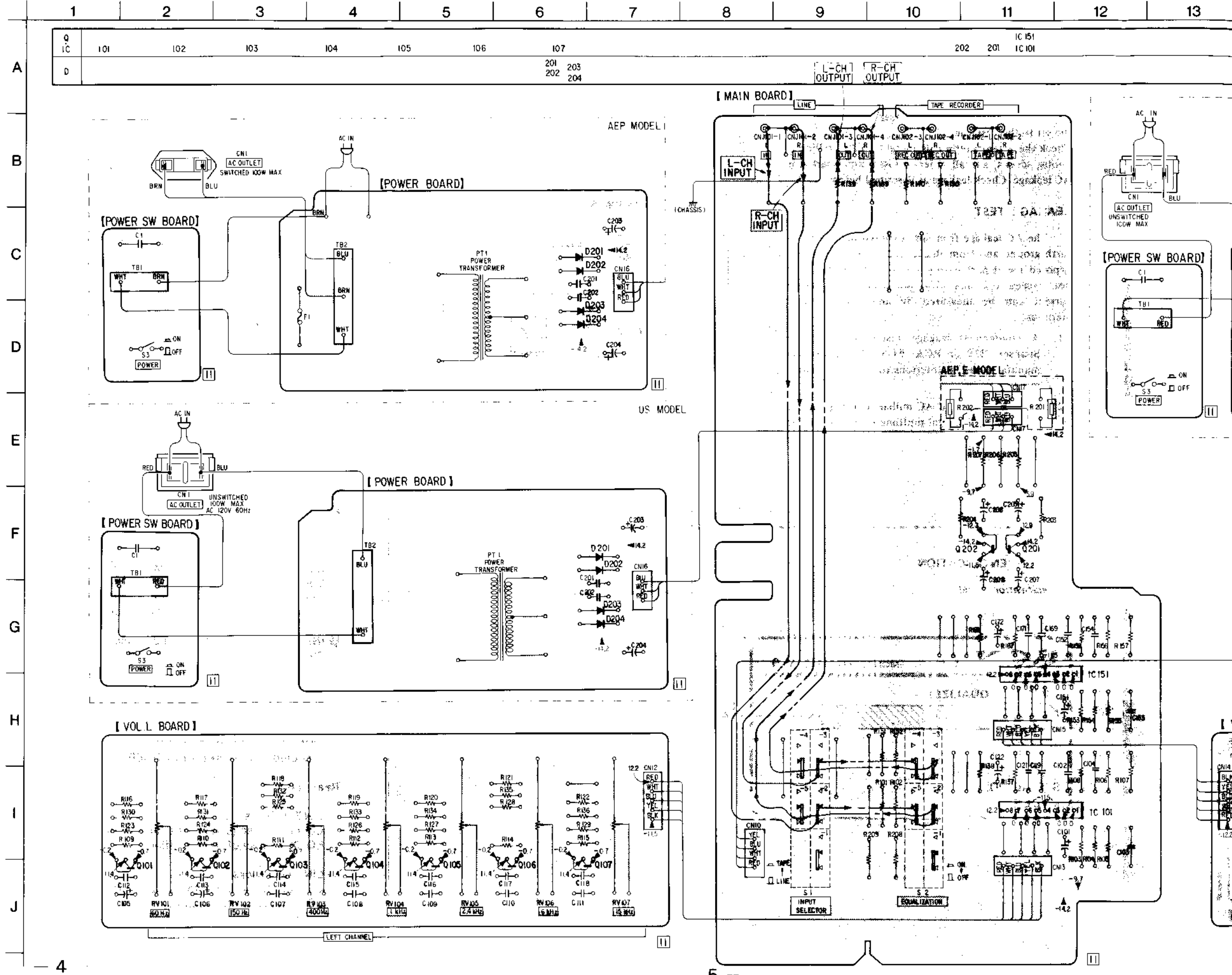

• Semiconductor Lead Layouts

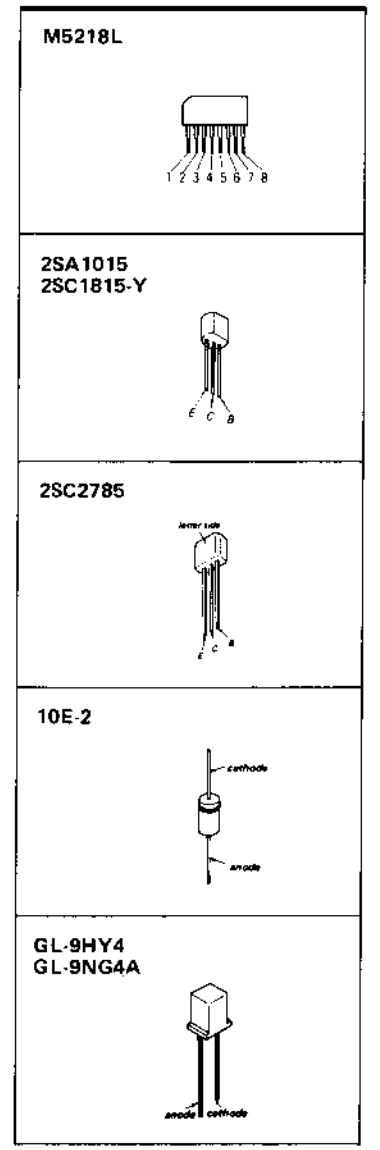

**Note:**

- : parts extracted from the component side.
- : signal path
- : L-CH signal path
- : R-CH signal path
- : B+ pattern

104	105	106	107	202	201	IC 151	151	152	153	154	155	156	157	Q
			201	203	IC 101						201	203	204	IC
			202	204			207	206	205					D

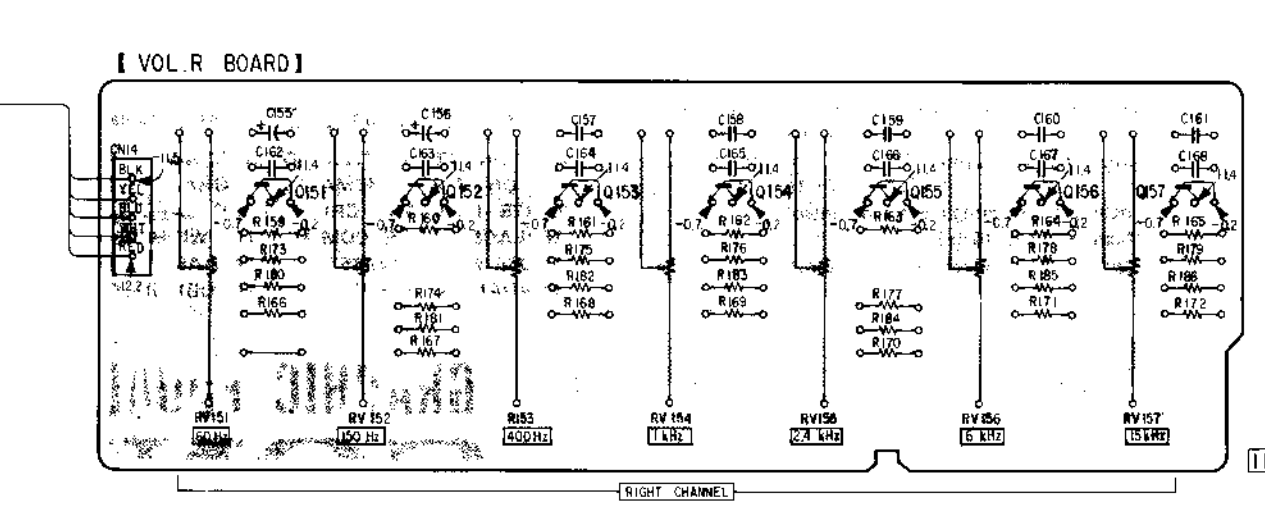
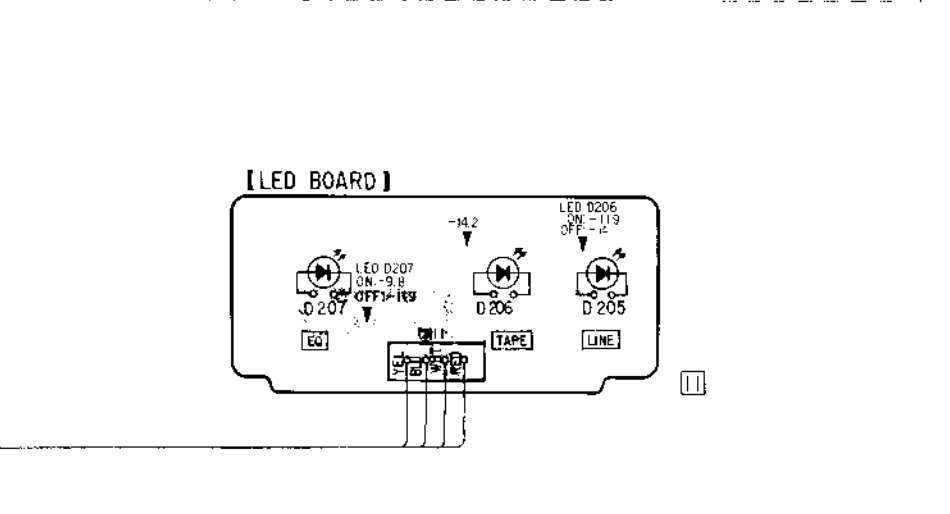
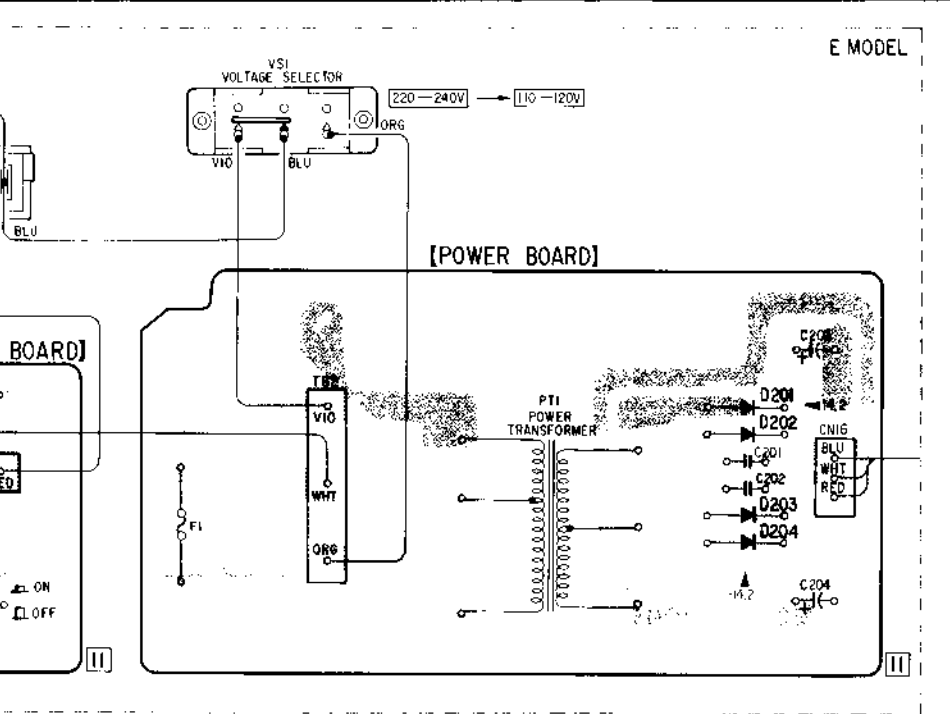
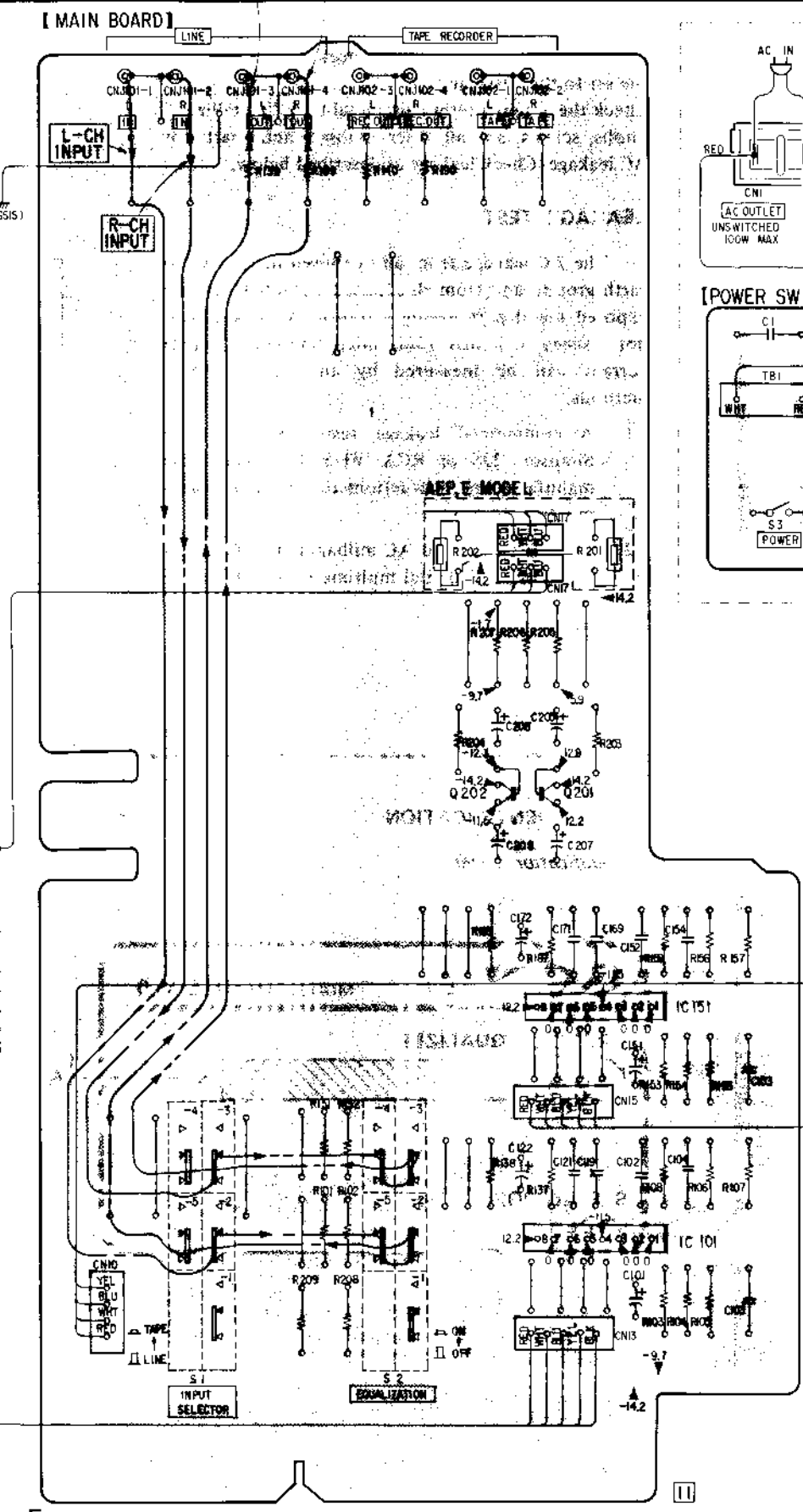
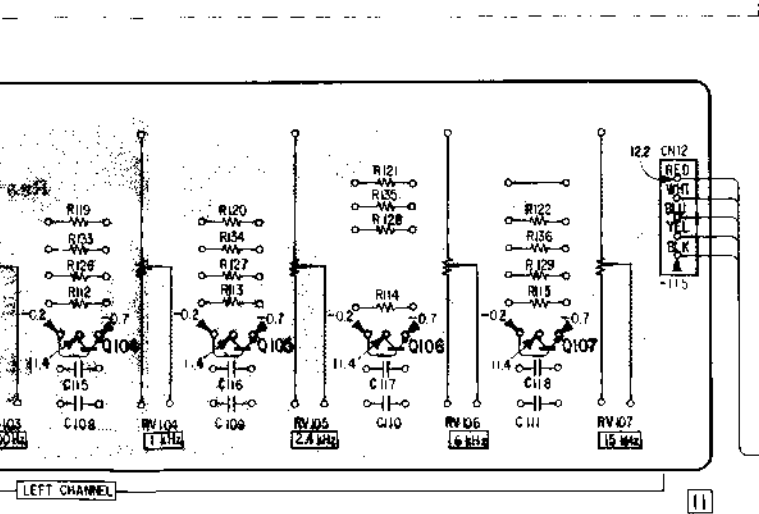
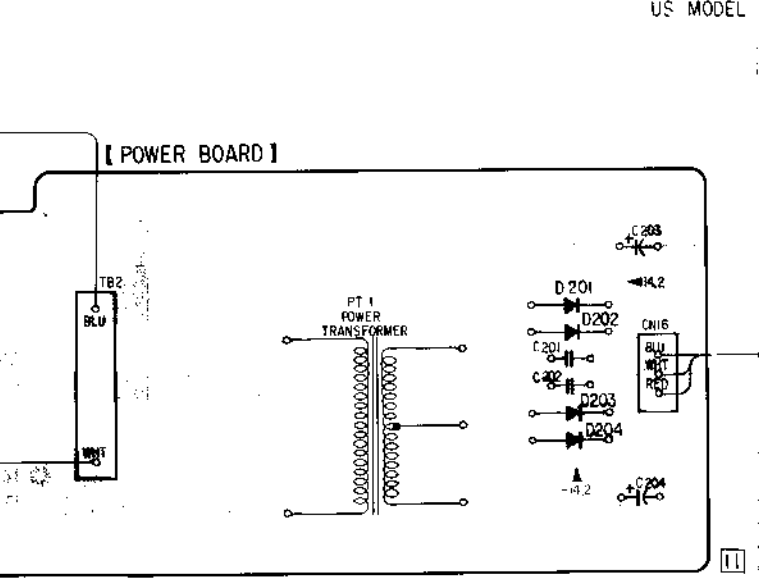
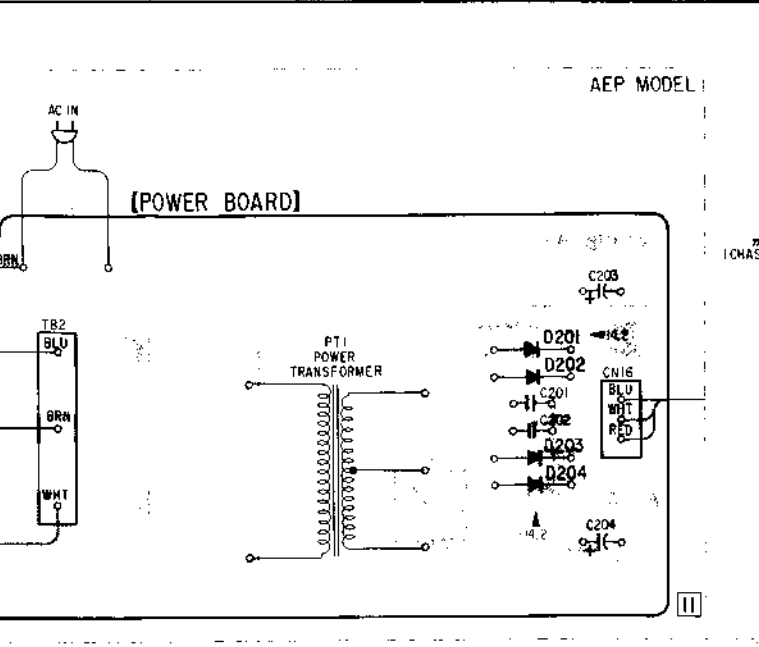

A B C D E F G H I J

1-2. SCHEMATIC DIAGRAM

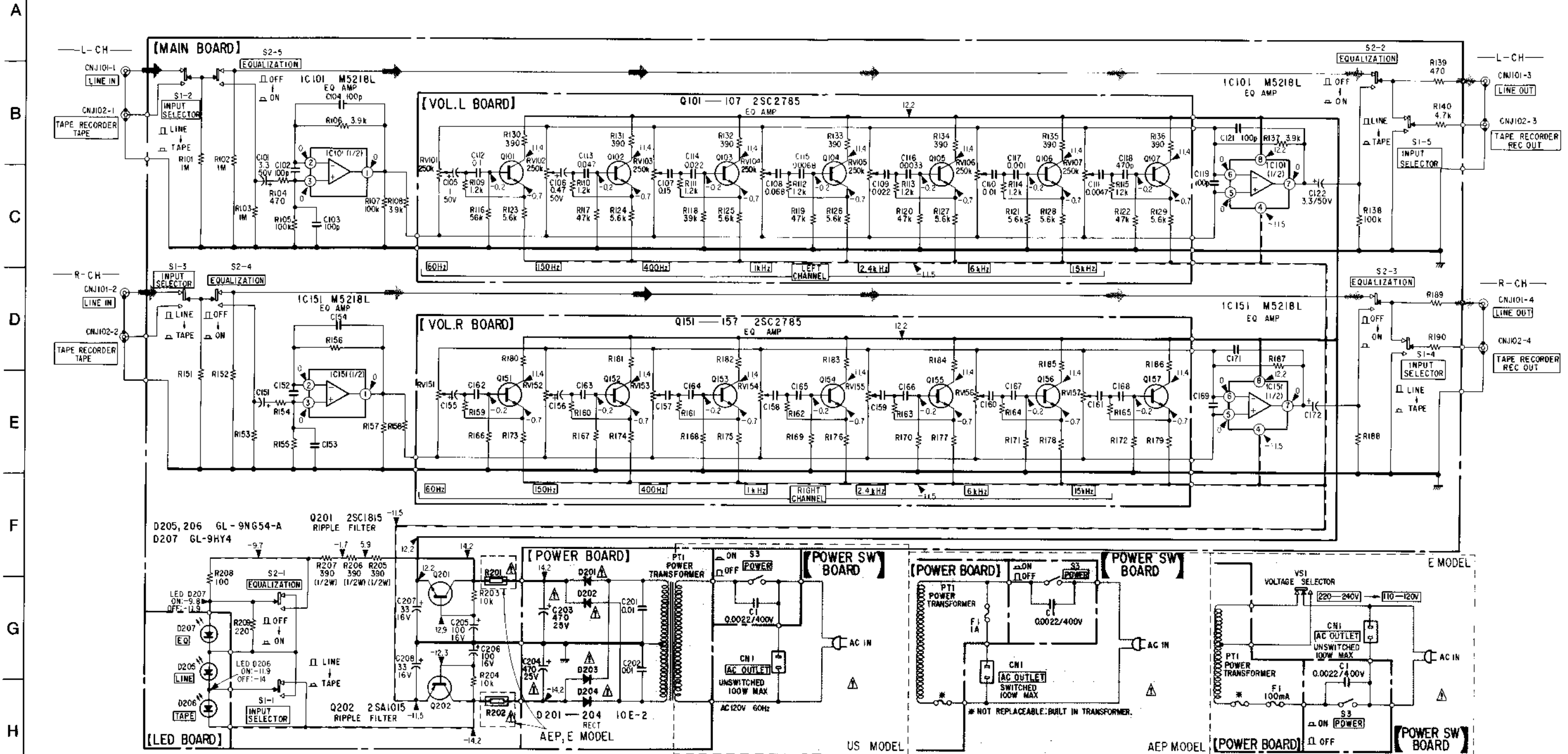

Note:

- All capacitors are in  $\mu\text{F}$  unless otherwise noted. pF:  $\mu\text{pF}$
- 50WV or less are not indicated except for electrolytics and tantalums.
- All resistors are in  $\Omega$  and  $\frac{1}{4}\text{W}$  or less unless otherwise specified.
- \* : signal path.
- Components for right channel have same values as for left channel.
- — : B+ bus.
- --- : B- bus.
- Voltages are dc with respect to ground unless otherwise noted.
- Readings are taken under no-signal conditions with a VOM (50k $\Omega$ /V).
- Voltage variations may be noted due to normal production tolerances.

Note: Voltages are measured with a VOM (50k $\Omega$ /V).

Note: The components identified by shading and mark  $\Delta$  are critical for safety. Replace only with part number specified.

SECTION 2  
EXPLODED VIEW AND PARTS LIST

NOTE:

The mechanical parts with no reference number in the exploded views are not supplied.  
Items marked " \* " are not stocked since they are seldom required for routine service. Some delay should be anticipated when ordering these items.

The construction parts of an assembled part are indicated with a collation number in the remark column.

The components identified by shading and mark  $\Delta$  are critical for safety. Replace only with part number specified.

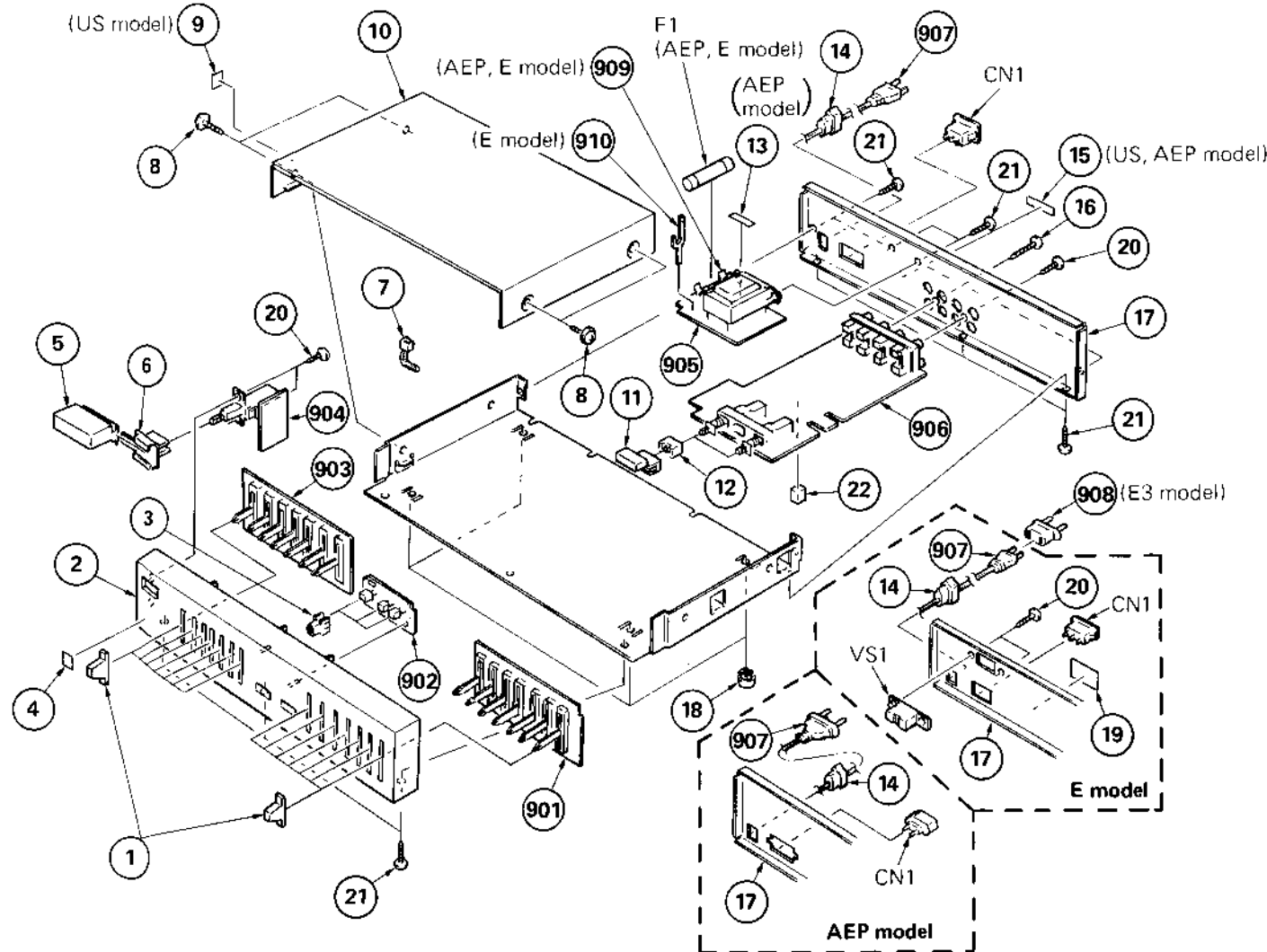

No.	Part No.	Description	REMARKS
1	4-905-462-01	KNOB, SLIDE	
2	X-4905-414-1	(SILVER)...PANEL ASSY	
	X-4905-415-1	(BLACK)...PANEL ASSY	
3	*4-904-475-01	HOLDER, LED	
4	3-703-713-01	STICKER, SONY SYMBOL (10)	
5	3-318-911-01	(SILVER)...KNOB (POWER.L), T MOLD	
	3-318-911-11	(BLACK)...KNOB (POWER.L), T MOLD	
6	*4-902-831-01	JOINT (G), KNOB	
7	*3-701-748-00	CLAMP	
8	4-889-321-01	(SILVER)...SCREW	
	4-889-321-11	(BLACK)...SCREW	
9	*3-703-680-00	(US)...LABEL, CAUTION, SUB, NEW UL	
10	4-905-463-01	(SILVER)...CASE	
	4-905-463-11	(BLAK)...CASE	
11	4-864-349-00	KNOB, SQUARE	
12	4-864-307-00	RING	
13	3-701-948-14	(AEP)...LABEL FUSE	
14	3-703-244-00	(AEP)...BUSHING (2104), CORD	
	3-703-571-00	(US,E)...BUSHING (S)(4516), CORD	
15	*4-302-759-00	(US,AEP)...LABEL, SERIAL NUMBER	

No.	Part No.	Description	REMARKS
16	3-703-473-00	SCREW, TERMINAL	
17	*4-905-453-01	(US)...PLATE, JACK	
	*4-905-453-11	(E)...PLATE, JACK	
	*4-905-453-21	(AEP)...PLATE, JACK	
18	X-3701-069-0	FOOT ASSY, M.F	
19	4-905-452-01	(E)...LABEL, MODEL NUMBER	
20	7-685-646-71	SCREW +BVTP 3X8 TYPE2 N-S	
21	7-685-871-01	SCREW +BVTT 3X6 (S)	
901	*1-615-672-11	PC BOARD, VOL.R	
902	*1-615-674-11	PC BOARD, LED	
903	*1-615-671-11	PC BOARD, VOL.L	
904	*1-615-675-11	PC BOARD, POWER SW	
905	*1-615-673-11	PC BOARD, POWER	
906	*1-615-670-11	PC BOARD, MAIN	
907	$\Delta$ 1-534-817-XX	(AEP)...CORD, POWER	
	$\Delta$ 1-551-472-00	(E)...CORD, POWER	
	$\Delta$ 1-551-628-00	(US)...CORD, POWER	
908	$\Delta$ 1-526-565-00	(E3)...AC PLUG ADAPTOR	
909	$\Delta$ 1-533-162-00	(AEP,E)...HOLDER, FUSE	
910	1-535-416-00	(AEP)...TERMINAL	

SECTION 3  
ELECTRICAL PARTS LIST

NOTE:

Items marked " \* " are not stocked since they are seldom required for routine service. Some delay should be anticipated when ordering these items.  
If there are two or more same circuits in a set such as a stereophonic machine, only typical circuit parts may be indicated and capacitors and resistors in other same circuits may be omitted.

CAPACITORS:  
MF:μF, PF:μμF.

RESISTORS  
All resistors are in ohms.  
F : nonflammable

COILS  
MMH : mH, UH : μH

SEMICONDUCTORS  
In each case, U : μ, for example:  
UA...: uA..., UPA...: uPA..., UPC...: uPC,  
UPD...: uPD...

The components identified by shading and mark  $\Delta$  are critical for safety. Replace only with part number specified.

Ref.No.	Part No.	Description				
901	*1-615-672-11	PC BOARD, VOL.R				
902	*1-615-674-11	PC BOARD, LED				
903	*1-615-671-11	PC BOARD, VOL.L				
904	*1-615-675-11	PC BOARD, POWER SW				
905	*1-615-673-11	PC BOARD, POWER				
906	*1-615-670-11	PC BOARD, MAIN				
907	$\Delta$ 1-534-817-XX	(AEP)...CORD, POWER				
	$\Delta$ 1-551-472-00	(E)...CORD, POWER				
	$\Delta$ 1-551-628-00	(US)...CORD, POWER				
908	$\Delta$ 1-526-565-00	(E3)...AC PLUG ADAPTOR				
909	$\Delta$ 1-533-162-00	(AEP,E)...HOLDER, FUSE				
910	1-535-416-00	(AEP)...TERMINAL				
C1	1-161-742-00	CERAMIC	0.0022MF	20%	400V	
C101	1-123-382-00	ELECT	3.3MF	20%	50V	
C102	1-161-271-00	CERAMIC	100PF	5%	50V	
C103	1-161-271-00	CERAMIC	100PF	5%	50V	
C104	1-161-271-00	CERAMIC	100PF	5%	50V	
C105	1-123-611-00	ELECT	1MF	20%	50V	
C106	1-123-610-00	ELECT	0.47MF	20%	50V	
C107	1-136-167-00	FILM	0.15MF	5%	50V	
C108	1-136-163-00	FILM	0.068MF	5%	50V	
C109	1-136-157-00	FILM	0.022MF	5%	50V	
C110	1-136-153-00	FILM	0.01MF	5%	50V	
C111	1-130-479-00	MYLAR	0.0047MF	5%	50V	
C112	1-136-165-00	FILM	0.1MF	5%	50V	
C113	1-136-161-00	FILM	0.047MF	5%	50V	
C114	1-136-157-00	FILM	0.022MF	5%	50V	
C115	1-130-481-00	MYLAR	0.0068MF	5%	50V	
C116	1-130-477-00	MYLAR	0.0033MF	5%	50V	
C117	1-130-471-00	MYLAR	0.001MF	5%	50V	
C118	1-130-467-00	MYLAR	470PF	5%	50V	
C119	1-161-271-00	CERAMIC	100PF	5%	50V	
C121	1-161-271-00	CERAMIC	100PF	5%	50V	
C122	1-123-382-00	ELECT	3.3MF	20%	50V	
C151	1-123-382-00	ELECT	3.3MF	20%	50V	
C152	1-161-271-00	CERAMIC	100PF	5%	50V	
C153	1-161-271-00	CERAMIC	100PF	5%	50V	
C154	1-161-271-00	CERAMIC	100PF	5%	50V	
C155	1-123-611-00	ELECT	1MF	20%	50V	
C156	1-123-610-00	ELECT	0.47MF	20%	50V	
C157	1-136-167-00	FILM	0.15MF	5%	50V	
C158	1-136-163-00	FILM	0.068MF	5%	50V	
C159	1-136-157-00	FILM	0.022MF	5%	50V	
C160	1-136-153-00	FILM	0.01MF	5%	50V	
C161	1-130-479-00	MYLAR	0.0047MF	5%	50V	

Ref.No.	Part No.	Description				
C162	1-136-165-00	FILM	0.1MF	5%	50V	
C163	1-136-161-00	FILM	0.047MF	5%	50V	
C164	1-136-157-00	FILM	0.022MF	5%	50V	
C165	1-130-481-00	MYLAR	0.0068MF	5%	50V	
C166	1-130-477-00	MYLAR	0.0033MF	5%	50V	
C167	1-130-471-00	MYLAR	0.001MF	5%	50V	
C168	1-130-467-00	MYLAR	470PF	5%	50V	
C169	1-161-271-00	CERAMIC	100PF	5%	50V	
C171	1-161-271-00	CERAMIC	100PF	5%	50V	
C172	1-123-382-00	ELECT	3.3MF	20%	50V	
C201	1-101-004-00	CERAMIC	0.01MF	50V		
C202	1-101-004-00	CERAMIC	0.01MF	50V		
C203	$\Delta$ 1-123-336-00	ELECT	470MF	20%	25V	
C204	$\Delta$ 1-123-336-00	ELECT	470MF	20%	25V	
C205	1-123-333-00	ELECT	100MF	20%	16V	
C206	1-123-333-00	ELECT	100MF	20%	16V	
C207	1-123-318-00	ELECT	33MF	20%	16V	
C208	1-123-318-00	ELECT	33MF	20%	16V	
CN1	$\Delta$ 1-526-774-11	(US,E)...OUTLET, AC				
CN1	$\Delta$ 1-526-794-11	(AEP)...OUTLET, AC				
CN10	*1-562-249-00	SOCKET, CONNECTOR 4P				
CN11	*1-562-249-00	SOCKET, CONNECTOR 4P				
CN12	*1-562-250-00	SOCKET, CONNECTOR 5P				
CN13	*1-562-250-00	SOCKET, CONNECTOR 5P				
CN14	*1-562-250-00	SOCKET, CONNECTOR 5P				
CN15	*1-562-250-00	SOCKET, CONNECTOR 5P				
CN16	*1-562-327-00	SOCKET, CONNECTOR 3P				
CN17	*1-562-327-00	SOCKET, CONNECTOR 3P				
CNJ101	1-507-788-00	JACK, PIN 4P				
CNJ102	1-507-788-00	JACK, PIN 4P				
D201	$\Delta$ 8-719-200-02	DIODE 10E-2				
D202	$\Delta$ 8-719-200-02	DIODE 10E-2				
D203	$\Delta$ 8-719-200-02	DIODE 10E-2				
D204	$\Delta$ 8-719-200-02	DIODE 10E-2				
D205	8-719-919-70	DIODE GL-9NG4A				
D206	8-719-919-70	DIODE GL-9NG4A				
D207	8-719-915-50	DIODE GL-9HY4				
F1	$\Delta$ 1-532-078-00	(AEP)...FUSE, TIME-LAG				
F1	$\Delta$ 1-532-610-XX	(E)...FUSE, TIME-LAG				
IC101	8-759-600-02	IC M5218L				
IC151	8-759-600-02	IC M5218L				
PT1	$\Delta$ 1-448-143-11	(US)...TRANSFORMER, POWER				
PT1	$\Delta$ 1-448-144-11	(AEP)...TRANSFORMER, POWER				
PT1	$\Delta$ 1-448-145-11	(E)...TRANSFORMER, POWER				

ELECTRICAL PARTS

Ref.No.	Part No.	Description			
Q101	8-729-178-55	TRANSISTOR	2SC2785-E		
Q102	8-729-178-55	TRANSISTOR	2SC2785-E		
Q103	8-729-178-55	TRANSISTOR	2SC2785-E		
Q104	8-729-178-55	TRANSISTOR	2SC2785-E		
Q105	8-729-178-55	TRANSISTOR	2SC2785-E		
Q106	8-729-178-55	TRANSISTOR	2SC2785-E		
Q107	8-729-178-55	TRANSISTOR	2SC2785-E		
Q151	8-729-178-55	TRANSISTOR	2SC2785-E		
Q152	8-729-178-55	TRANSISTOR	2SC2785-E		
Q153	8-729-178-55	TRANSISTOR	2SC2785-E		
Q154	8-729-178-55	TRANSISTOR	2SC2785-E		
Q155	8-729-178-55	TRANSISTOR	2SC2785-E		
Q156	8-729-178-55	TRANSISTOR	2SC2785-E		
Q157	8-729-178-55	TRANSISTOR	2SC2785-E		
Q201	8-729-281-52	TRANSISTOR	2SC1815-Y		
Q202	8-729-201-52	TRANSISTOR	2SA1015		
R101	1-246-545-00	CARBON	1M	5%	1/4W
R102	1-246-545-00	CARBON	1M	5%	1/4W
R103	1-246-545-00	CARBON	1M	5%	1/4W
R104	1-247-123-00	CARBON	470	5%	1/4W
R105	1-247-179-00	CARBON	100K	5%	1/4W
R106	1-247-145-00	CARBON	3.9K	5%	1/4W
R107	1-247-179-00	CARBON	100K	5%	1/4W
R108	1-247-145-00	CARBON	3.9K	5%	1/4W
R109	1-247-833-00	CARBON	1.2K	5%	1/6W
R110	1-247-833-00	CARBON	1.2K	5%	1/6W
R111	1-247-833-00	CARBON	1.2K	5%	1/6W
R112	1-247-833-00	CARBON	1.2K	5%	1/6W
R113	1-247-833-00	CARBON	1.2K	5%	1/6W
R114	1-247-833-00	CARBON	1.2K	5%	1/6W
R115	1-247-833-00	CARBON	1.2K	5%	1/6W
R116	1-247-873-00	CARBON	56K	5%	1/6W
R117	1-247-871-00	CARBON	47K	5%	1/6W
R118	1-247-869-00	CARBON	39K	5%	1/6W
R119	1-247-871-00	CARBON	47K	5%	1/6W
R120	1-247-871-00	CARBON	47K	5%	1/6W
R121	1-247-873-00	CARBON	56K	5%	1/6W
R122	1-247-871-00	CARBON	47K	5%	1/6W
R123	1-247-849-00	CARBON	5.6K	5%	1/6W
R124	1-247-849-00	CARBON	5.6K	5%	1/6W
R125	1-247-849-00	CARBON	5.6K	5%	1/6W
R126	1-247-849-00	CARBON	5.6K	5%	1/6W
R127	1-247-849-00	CARBON	5.6K	5%	1/6W
R128	1-247-849-00	CARBON	5.6K	5%	1/6W
R129	1-247-849-00	CARBON	5.6K	5%	1/6W
R130	1-247-821-00	CARBON	390	5%	1/6W

ELECTRICAL PARTS

Ref.No.	Part No.	Description			
R131	1-247-821-00	CARBON	390	5%	1/6W
R132	1-247-821-00	CARBON	390	5%	1/6W
R133	1-247-821-00	CARBON	390	5%	1/6W
R134	1-247-821-00	CARBON	390	5%	1/6W
R135	1-247-821-00	CARBON	390	5%	1/6W
R136	1-247-821-00	CARBON	390	5%	1/6W
R137	1-247-145-00	CARBON	3.9K	5%	1/4W
R138	1-247-179-00	CARBON	100K	5%	1/4W
R139	1-247-123-00	CARBON	470	5%	1/4W
R140	1-247-147-00	CARBON	4.7K	5%	1/4W
R151	1-246-545-00	CARBON	1M	5%	1/4W
R152	1-246-545-00	CARBON	1M	5%	1/4W
R153	1-246-545-00	CARBON	1M	5%	1/4W
R154	1-247-123-00	CARBON	470	5%	1/4W
R155	1-247-179-00	CARBON	100K	5%	1/4W
R156	1-247-145-00	CARBON	3.9K	5%	1/4W
R157	1-247-179-00	CARBON	100K	5%	1/4W
R158	1-247-145-00	CARBON	3.9K	5%	1/4W
R159	1-247-833-00	CARBON	1.2K	5%	1/6W
R160	1-247-833-00	CARBON	1.2K	5%	1/6W
R161	1-247-833-00	CARBON	1.2K	5%	1/6W
R162	1-247-833-00	CARBON	1.2K	5%	1/6W
R163	1-247-833-00	CARBON	1.2K	5%	1/6W
R164	1-247-833-00	CARBON	1.2K	5%	1/6W
R165	1-247-833-00	CARBON	1.2K	5%	1/6W
R166	1-247-873-00	CARBON	56K	5%	1/6W
R167	1-247-871-00	CARBON	47K	5%	1/6W
R168	1-247-869-00	CARBON	39K	5%	1/6W
R169	1-247-871-00	CARBON	47K	5%	1/6W
R170	1-247-871-00	CARBON	47K	5%	1/6W
R171	1-247-873-00	CARBON	56K	5%	1/6W
R172	1-247-871-00	CARBON	47K	5%	1/6W
R173	1-247-849-00	CARBON	5.6K	5%	1/6W
R174	1-247-849-00	CARBON	5.6K	5%	1/6W
R175	1-247-849-00	CARBON	5.6K	5%	1/6W
R176	1-247-849-00	CARBON	5.6K	5%	1/6W
R177	1-247-849-00	CARBON	5.6K	5%	1/6W
R178	1-247-849-00	CARBON	5.6K	5%	1/6W
R179	1-247-849-00	CARBON	5.6K	5%	1/6W
R180	1-247-821-00	CARBON	390	5%	1/6W
R181	1-247-821-00	CARBON	390	5%	1/6W
R182	1-247-821-00	CARBON	390	5%	1/6W
R183	1-247-821-00	CARBON	390	5%	1/6W
R184	1-247-821-00	CARBON	390	5%	1/6W
R185	1-247-821-00	CARBON	390	5%	1/6W



## ELECTRICAL PARTS

Ref.No.	Part No.	Description
R186	1-247-821-00	CARBON 390 5% 1/6W
R187	1-247-145-00	CARBON 3.9K 5% 1/4W
R188	1-247-179-00	CARBON 100K 5% 1/4W
R189	1-247-123-00	CARBON 470 5% 1/4W
R190	1-247-147-00	CARBON 4.7K 5% 1/4W
<del>R201 A</del>	<del>1-806-884-11</del>	<del>(AEP,E) THERMISTOR (POSITIVE)</del>
<del>R202 A</del>	<del>1-806-884-11</del>	<del>(AEP,E) THERMISTOR (POSITIVE)</del>
R203	1-247-155-00	CARBON 10K 5% 1/4W
R204	1-247-155-00	CARBON 10K 5% 1/4W
R205	1-247-230-00	CARBON 390 5% 1/2W
R206	1-247-230-00	CARBON 390 5% 1/2W
R207	1-247-230-00	CARBON 390 5% 1/2W
R208	1-247-107-00	CARBON 100 5% 1/4W
R209	1-247-115-00	CARBON 220 5% 1/4W
RV101	1-230-804-11	RES, VAR, SLIDE 250K, (60Hz)
RV102	1-230-804-11	RES, VAR, SLIDE 250K, (150Hz)
RV103	1-230-804-11	RES, VAR, SLIDE 250K, (400Hz)
RV104	1-230-804-11	RES, VAR, SLIDE 250K, (1kHz)
RV105	1-230-804-11	RES, VAR, SLIDE 250K, (2.4kHz)
RV106	1-230-804-11	RES, VAR, SLIDE 250K, (6kHz)
RV107	1-230-804-11	RES, VAR, SLIDE 250K, (15kHz)
RV151	1-230-804-11	RES, VAR, SLIDE 250K, (60Hz)
RV152	1-230-804-11	RES, VAR, SLIDE 250K, (150Hz)
RV153	1-230-804-11	RES, VAR, SLIDE 250K, (400Hz)
RV154	1-230-804-11	RES, VAR, SLIDE 250K, (1kHz)
RV155	1-230-804-11	RES, VAR, SLIDE 250K, (2.4kHz)
RV156	1-230-804-11	RES, VAR, SLIDE 250K, (6kHz)
RV157	1-230-804-11	RES, VAR, SLIDE 250K, (15kHz)
S1	1-570-238-11	SWITCH, PUSH (2 KEY), (INPUT SELECTOR)
S2	1-570-238-11	SWITCH, PUSH (2 KEY), (EQUALIZATION)
<del>S3 A</del>	<del>1-553-318-51</del>	<del>SWITCH, PUSH (1 KEY), (AC POWER)</del>
TB1	*1-535-139-00	BASE POST 22MM (10MM PITCH) 2P
TB2	*1-535-140-00	BASE POST 22MM (10MM PITCH) 3P
<del>YS1 A</del>	<del>1-552-536-00</del>	<del>(E) SWITCH, POWER &amp; VOLTAGE CHANGE</del>

## ACCESSORY & PACKING MATERIAL

Part No.	Description
1-551-734-11	CORD, CONNECTION (RK-74A)
3-701-630-00	BAG, POLYETHYLENE
3-703-895-01	(BLACK)...LABEL, COLOR
3-703-906-01	(SILVER)...LABEL, COLOR
3-760-434-11	(AEP,E)...MANUAL, INSTRUCTION
3-760-434-21	(US).....MANUAL, INSTRUCTION
3-760-434-41	(AEP).....MANUAL, INSTRUCTION
4-876-352-00	SHEET, PROTECTION
4-905-457-01	CUSHION (LEFT), LOWER
4-905-458-01	CUSHION (RIGHT), LOWER
4-905-459-01	CUSHION (LEFT), UPPER
4-905-460-01	CUSHION (RIGHT), UPPER
4-905-461-01	INDIVIDUAL CARTON

The components identified by shading and mark  are critical for safety. Replace only with part number specified.

MC-Service

Sony Corporation