

Style with Innovation

Spring Fair 2019

Introduction

The Steepletone Story...

The Company was started in the late 60's and was incorporated in March 1972 by the founder and our Chairman Tony Tyler. The family business is now managed by Mark Tyler, the son of the founder, with his wife Kendal, and now joined by their son Kristian – making him the third generation. Additionally we have a great and experienced team of individuals that make up the Steepletone family. Steepletone's UK Head Office is located in the village of Croughton on the South Northamptonshire/North Oxfordshire border, only 4 miles from the M40 Motorway and just South of the Silverstone Racing Circuit. In the early years of trading the Company's key products were Record Players and Music Centres, which were made in an old converted Cinema in a village some 12 miles from the current Head Office.

In the 1980's Steepletone moved its manufacturing to the Far East to remain competitive in the market place. An office was formed in the region, which plays a significant role in maintaining product development, design, packaging, production and, of course, the very important role of Quality Control to ensure a high level of out-of-box reliability.

The Far East Team is headed up by Patrick Chan. The team have responsibility for quality, production and ensuring that all the products conform to the many European Standards which apply to products. Unlike many other Brands/Importers, our pedigree of being an actual Manufacturer means we understand what it takes to make great products and the high grade components used to make them work for daily use. Styling and ease of use are key foundations to all our products, we continue to innovate and embrace the very latest technologies.

WELCOME TO OUR 2019 SPRING FAIR PREVIEW BROCHURE



Customer Care

We are highly aware that, even more so today, customers' expectations are far greater than ever before, not only for quality, but function, simplicity, delivery and packaging. Our determination to succeed in these areas is one of the keys to our continued growth. If we supply a faulty product we aim to put it right as soon as possible.

We produce a regular Newsletter to ensure all our customers, whether or not personally called on by our Sales Team, are kept up-to-date with the latest information on new products, stock levels, price changes and special offers.

All products comply with ERP2, which means if it is not in use on CD or MP3 the unit will go into 'Standby'- this is not a fault, it's an EU directive. We are one of the first Importers to add an override switch for this function, so the end user now has a choice.

After Sales Service

We believe we are one of the few Importers that still has an in-house Service Department catering for customers' needs, from missing Instruction Manuals to more critical components and fault diagnosis, we also have extensive spare parts, meaning end users can be reassured that the product they purchase will last longer than a few years – this, we believe, maximises customers' peace of mind.



Contents

Radios
4-10
NEW!
NR880 LXA

Nostalgic Audio
11-14
NEW!
STD-WEST

Retro Record Players
15-16
NEW!
ROXY 4

Reproduction Jukeboxes
17-20
NEW!
TOUCH ROCK 50 MW

Nostalgic Telephones
21
NEW!
SGSM1

Audio Visual
22-32
NEW!
FREEDOM SPEAKERS

Speaker Systems
33-36
NEW!
CUBE CONNEX

Clock Radios
37
NEW!
STLCR1 RS

Record Player Accessories
38-39
NEW!
SRB2 BROWN



NEW!
NR880 LXA - PAGE 5



NEW!
TOUCH ROCK 50 MW
PAGE 20



NEW!
OPENWEAR - PAGE 29



NEW!
FREEDOM SPEAKERS - PAGE 32



BABY BRIGHTON

RETRO STYLED 2-BAND RADIO

- Portable MW-FM Retro Radio
- Large Rotary Tuning Control
- Easy to read Dial Scale
- Rotary Controls for Volume and Tone
- 3.5mm dia. Aux-in & Headphone Sockets
- Portable via strong Carrying Handle
- Moulded Pure ABS colour (non spray finish) cabinet
- Battery powered: (3 x'C' size - not included)
- External Power source: 4.5V DC (5.5mm DC-to-USB lead supplied)
- Dimensions: Approx. 201h x 240w x 75d mm



black beige





NR880 LXA

Nostalgic Radio  WORKS WITH amazon alexa

Voice activation



fm radio



mw radio



- o Classic 1930's style Mw-Fm Radio
- o Illuminated Dial
- o Rotary Controls for On/Off/Volume, Tuning and Band selection
- o Dock on top for attaching e.g. an Amazon Alexa 'DOT' module or similar (not supplied)
- o 3.5mm dia. Aux-in jack for playing external Audio Players
- o Finished in medium oak real wood veneers
- o Built-in Speaker
- o 5V DC USB power cable supplied
- o 230V AC mains



(NOT INCLUDED)





BRIGHTON 2B

RETRO STYLED RADIO

- Portable Mw-Fm Radio
- Strong & Stylish Carrying Handle
- Rotary On/Off Volume Control
- Rotary Tone Control for Bass and Treble
- Direct Tuning
- Easy to read Dial Scale with Rotary Tuning
- Push Button Band Selection
- Moulded Pure ABS colour (non spray finish)
- Aux-in Playback via 3.5mm dia. socket
- Battery Powered: requires 6 x 'C' size/ 1.5V Battery (not supplied)
- Built-in Ferrite Antenna for Mw
- Telescopic Aerial for FM (4-section/50cm long)
- 230v AC Mains Operated via detachable Mains Lead (supplied)
- Dimensions: Approx. 210h x 300w x 80d mm



Brighton Wood (Ltd. Edition)



Radios

Dorset DAB RADIO

- Mw-Fm & DAB Receiver
- Strong & Stylish Carrying Handle
- Rotary On/Off/Volume Control
- Rotary Tone Control for Bass and Treble
- Direct Tuning
- Easy to read Dial Scale with Rotary Tuning
- LCD Display for DAB
- 10 DAB Presets
- Push Button Band Selection
- Moulded Pure ABS colour (non spray finish) cabinet
- Aux-in Playback via 3.5mm dia. socket
- Battery Powered: requires 6 x 'C' size/ 1.5V Battery (not supplied)
- Built-in Ferrite Antenna for Mw
- Telescopic Aerial for FM & DAB
- 230v AC Mains Operated via detachable Mains Lead (supplied)
- Dimensions: Approx. 210h x 300w x 80d mm



Top view showing LCD display



Devon

RETRO STYLED 2-BAND & DAB RADIO WITH AUX-IN

- Portable Retro Styled Mw-Fm & DAB Radio
- Front panel LCD display for DAB Digital Radio
- Direct Tuning
- 10 DAB Pre-sets; DAB Specifications RF Section: Band III, 174 MHz to 240 MHz
- Easy to read large Analogue Dial
- Rotary Tuning, Volume & Tone Controls
- Tone Control – Bass & Treble
- Push Button Controls for DAB functions
- Moulded Pure ABS colour (non spray finish) cabinet
- Headphone Socket (3.5mm dia.)
- Built-in Ferrite Antenna for Mw
- Battery Powered: requires 6 x 'C' size/ 1.5V Batteries (not supplied), or
- 230v AC Mains – via 9V/1A AC/DC Power Adaptor (supplied)
- Dimensions: Approx. 225h x 320w x 90d mm
- Telescopic Aerial for FM & DAB



Stirling 4

RETRO STYLE PORTABLE AC-DC 3-BAND RADIO WITH BLUETOOTH TRANSMITTING CD/MP3-CD PLAYER AND USB CHARGING PORT

- Vertical CD/MP3-CD Player
- Bluetooth Playback and Transmitting
- USB Charging Port for external audio devices (5V/1.0A - USB Charging Cable not supplied)
- Blue Backlit LCD Display for CD & MP3-CD
- Mw-Lw-Fm and FM-Stereo Analogue Radio
- Telescopic Aerial
- Built-in Stereo Speakers
- Battery operated (6 x size 'C' batteries not supplied), or 230V -50Hz Mains (detachable mains lead supplied)
- Dimensions: Approx. 360w x 120d x 195h mm



SRLM2002 'Heartbeat'

1960's RETRO STYLE PORTABLE AC-DC RADIO

- Portable MW-FM Retro Radio
- Large Rotary Tuning Control
- Easy to read Dial Scale
- Rotary Controls for Volume and Tone
- 3.5mm dia. Aux-in & Headphone Sockets

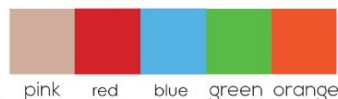

SCR209

PORTABLE 2-BAND RADIO WITH CASSETTE PLAYER/RECORDER

- Mw-Fm Radio with Analogue Dial Scale
- 6-Key Cassette Player/Recorder
- Built-in Condenser Mic
- Headphone Socket (3.5mm dia.)
- 6-section Telescopic Aerial for FM
- Powered by Batteries (not supplied) or 6V AC/DC Adaptor (supplied)
- Colours available: Black, Beige & Silver
- Dimensions: Approx. 220w x 150h x 70d mm



SRC315s

PORTABLE STEREO MW-FM ANALOGUE RADIO WITH CASSETTE PLAYER/RECORDER & MIC INPUT

- Portable MW-FM Retro Radio
- Large Rotary Tuning Control
- Easy to read Dial Scale
- Rotary Controls for Volume and Tone
- 3.5mm dia. Aux-in & Headphone Sockets



MBR1051

7 BAND RADIO

- High Sensitivity 7-Band World Receiver
- FM/AIR/MB/MW/LW/SW1-SW2
- Headphone Socket for private listening
- Two metal Grab Handles
- Carry Handle converts to Shoulder Strap
- Powered Via Mains or Battery





CHICHESTER III

ULTRA-COMPACT RETRO STYLE MUSIC SYSTEM WITH REMOTE CONTROL, 3-SPEED RECORD PLAYER, RADIO, CD & CASSETTE PLAYER, AUX IN/LINE OUT, HEADPHONE JACK

- 3-Speed Record Player (33 $\frac{1}{3}$ /45/78rpm) with Flip-over Stylus
- LED Display
- Remote Control
- Subwoofer-out Jack
- Headphone Sockets (3.5mm dia)
- Aux-in (3.5mm dia.) & Line Out Sockets (RCA)
- Powered by 12V-1.2A Switching Adaptor
- Built-in Stereo Speakers (2 x 3W RMS)
- Dark or Light Oak effect real wood veneer finish
- Dimensions: Approx. 230h x 375w x 350d mm



STD-I2

STAND FOR MODEL CHICHESTER III

- Easy fixing to the music centre
- Dark or light oak effect real wood veneer finish
- Dimensions: Appox. 570h x 350w x 335mm



light dark





NORFOLK

RETRO STEREO RECORD & CD PLAYER WITH MW-FM RADIO, LINE-OUT, USB/SD MP3 ENCODING & PLAYBACK

- 33/45/78 rpm Full Size Turntable with
- Guitar shaped Tone Arm
- Integral built-in Top Loading CD Player hidden under turntable platter
- MW-FM Radio (with built-in Antennas)
- USB Socket/SD Card Slot with MP3 & WMA Playback
- MP3-to-USB & SD/MMC Encoding from Phono, CD & Radio
(connect up to 32GB max)
- LCD Display Window on Turntable Deck
- Line-out (RCA: L + R)
- Headphone Jack (3.5mm dia.)
- Built-in Stereo Speakers (Output 2 x SW RMS)
- Finished in Light Oak or Dark Cherry
effect real wood veneers
- Powered by 12V/2A DC Adaptor
- Dimensions: Approx. 439w x 328d x 186h mm



light oak dark cherry





PHONO 1

GRAMOPHONE STYLE MUSIC SYSTEM WITH MP3 TO USB/SD ENCODING

- 3-speed (33/45/78rpm) Record Player
- Built-in Subwoofer in Stand & Speakers
- CD Player / Mw-Fm Radio
- Dark or Light real wood veneers
- Power by 230v AC Mains
- Dimensions: Top Unit 200h x 340w x 285d mm
- Top unit including Horn: 497h x 340w x 337d mm
- Subwoofer Module/Stand: 705h x 340w x 285d mm



USB NORWICH

RETRO RECORD PLAYER WITH MW/FM RADIO & MP3 PLAYBACK

- 3-speed (33',/45/78rpm) Turntable
- Variable pitch control
- Mw-Fm Radio
- SD/USB 2.0 Port for MP3 Playback (up to 4GB max)
- Line-Out & Line-In Socket
- Subwoofer Socket
- Front facing 2 x 2W (RMS) Stereo Speakers
- Powered by 230V AC Mains
- Dimensions:
Approx. 405w x 310d x 115h mm
- Flip Over Stylus- 33/45 + 78 (Diamond Tip)

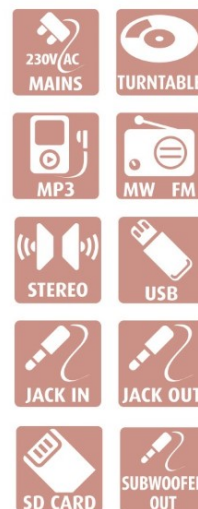



WESTMINSTER

NOSTALGIA 3-SPEED RECORD PLAYER WITH DAB+ AND FM RADIO, BLUETOOTH®, CD, LINE-IN, CASSETTE PLAYER AND USB/SD MP3 ENCODING

- Full Size Nostalgia Music Centre
- Full Function Remote Control
- 3-speed Turntable(33 $\frac{1}{3}$ /45/78rpm) with Flip Stylus, Cue Lever & Auto Stop switch
- DAB+ Radio (Wire plug-in Aerial supplied)
- FM Radio 88MHz - 108MHz; Manual & PLL Tuning (Wire plug-in Aerial)
- Draw Loading CD Player: plays CD-R/MP3-CD/CD-RW/WMA-CD
- MP3 Encoding to USB/SD (up to 32GB max)
- Slot Cassette Player with lockable Fast Forward
- Rotary Controls for Volume, Function selection and Tuning
- Headphone Socket (3.5mm dia.)
- Aux-in Socket (3.5mm dia.)
- 14 Watts p.m.p.o. Output
- Power by 230V ~50Hz AC Mains
- Full Function Remote Control



light dark



**STD-WEST
STAND NOW AVAILABLE**





Retro Style Record Players

DISCO BT

ROUND 3-SPEED RECORD PLAYER WITH BLUETOOTH TRANSMITTING AND AUX-IN/-OUT

- Round Shape 3-speed Turntable (33-1/3, 45 & 78rpm) with Flip-over Stylus
- Auto-Stop and Speed Selection Switch
- Built-in Bluetooth Transmitter for Bluetooth Music Streaming
- Pitch Control
- MDF Top High Gloss 'Piano' Finish
- Clear Perspex Dust Cover
- Rotary Power On/Off/Volume Control
- Power On LED indicator light
- Connect other Audio Player(s) to Line In Jack (3.5mm dia socket)
- Line-out Jacks (L + R)
- 3.5mm dia. Headphone Socket
- Subwoofer Socket (Subwoofer not supplied)
- Built-in Stereo Speakers
- Power by AC/DC Adaptor
- Dimensions: Approx. Dia: 350mm Height: 140mm

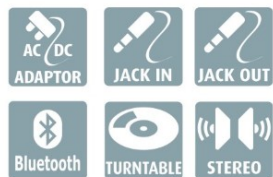

BLUETOOTH STREAMING



SRP1R16

SEMI AUTOMATIC 3-SPEED RECORD PLAYER ON LEGS WITH MW-FM RADIO, AUX-IN AND USB/SD MP3 PLAYBACK

- Semi-Automatic 60's 'Dansette' style portable Retro Style Record Player with detachable legs* (*for optional use - easy home self-assembly)
- Plays 33 1/3, 45 & 78rpm Records
- 45rpm Spindle Adaptor supplied
- USB 2.0 Port & SD Card Slot
- MW-FM Radio - Frequency Range: Am (Mw) 540 - 1600 KHz / Fm 88 - 108 MHz*
- Stereo Speakers: 2 x 5W RMS /8W p.m.p.o.
- Dimensions: Approx. 170h x 390w x 425d mm





Retro Style Record Players

ROXY 4

60'S STYLE RETRO 3-SPEED RECORD PLAYER WITH FM RADIO, CD PLAYER, MP3 TO USB/SD ENCODING & PLAYBACK AND AUX-IN PLAYBACK

- 60's style Retro Music Centre with infra-red Remote Control (for CD, USB/SD MP3 and Encoding)
- 3-sp (331/3 /45/78rpm) turntable under the hinged lid
- Tone arm fitted with Flip-over Stylus ('SSTY8')
- A spindle adaptor for 45rpm records is supplied
- Moulded Pure ABS colour (non spray finish)
- Full Function Drawer loading CD Player
- FM Analogue Radio with large Blue LED illuminated Frequency Dial numbers
- Built-in Amplifier
- USB Port & SD Card slot for MP3 Playback (up to 16GB limit)
- Earphone socket (3.5mm dia. Jack)
- Stereo built-in Speakers (2 x 5 Watts RMS)
- Power is by 230V AC mains ~50Hz
- Dimensions: Approx. 320w x 340d x 170h mm

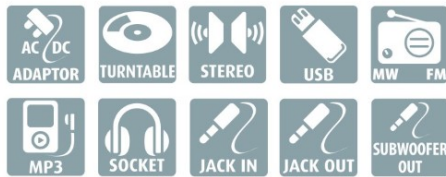

Jive Rock Sixty

MINI JUKEBOX WITH BLUETOOTH, RADIO, CD, MP3 & AUX-IN PLAYBACK

- Compact Mini table top Jukebox with full-function Remote Control (3V/CR2025 Lithium Cell Battery)
- Front vertical Loading single (Audio) CD Player
- Magnetic removable CD Door with Blue LED's
- LCD Display (with Blue LED backlight)
- MW/FM Radio
- USB Port & SD Card Slot for connection and music playback of MP3 Players/Flash Drives or SD/MMC Cards - none supplied (connect from 512MB up to 8GB max)
- 7-colour changing LED Tube lighting modes with sound-to-light feature
- Red-Blue-Green LED lighting in Half Moon
- Built-in 2 x 3"/8W/ 4 Ohm Stereo Speakers - 20W p.m.p.o. per channel
- Dimensions: Approx. 395h x 285w x 165d mm

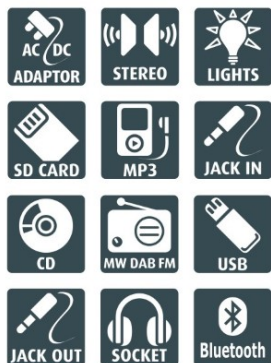

JIVE ROCK SIXTY *LXA*

- Retro Reproduction stereo Jukebox
- Hand-made wooden cabinet
- Amazon Alexa Dot Compatibility- CD door slot connection.
- Bluetooth connectivity-Music Play
- 7-colour changing LED illumination, with 4 lighting modes.
- Remote Control
- Front Loading vertical single CD/MP3 CD player
- CD Track LCD display
- Headphone socket for private listening.
- MW-FM Radio
- USB & SD MP3 play back.
- AUX in Jack to connect any external sound products.
- CD/MP3 track forward ski/reverse sky function.
- Colour LED Lit magnetic CD door.
- 40 Watts output (2x20)P.M.P.O
- 12c CD operated Via 12v AC/DC adaptor(supplied)

Now Compatible With
amazon alexa

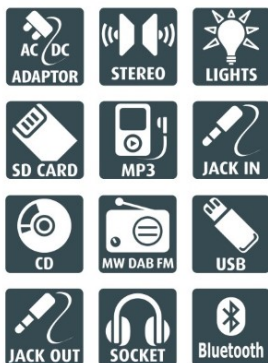
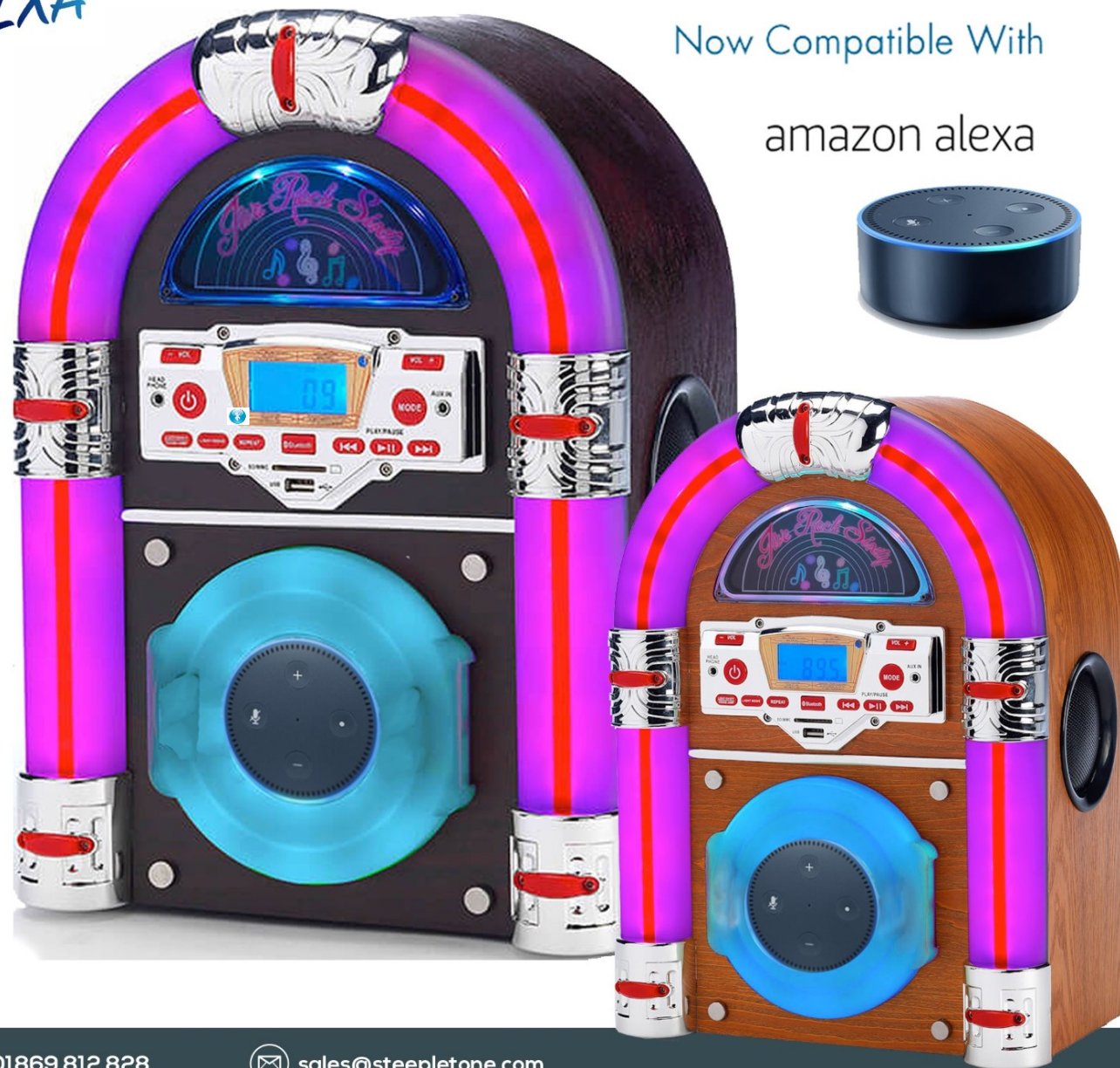

cherry wood
light wood





DINER BT

COMPACT 'WALL BOX' JUKEBOX WITH
BLUETOOTH, FM RADIO, USB/SD & AUX-IN

- ❑ Vintage Select-o-Matic style compact table top or wall mounting American Diner Jukebox
- ❑ Remote Control for Function selection (Radio/USB/S-D/Bluetooth) and USB/SD playback function (CR2025 cell battery included)
- ❑ Authentic looking 'COINS' slot Remote Control Sensor
- ❑ 'Song List' (with panel browsing control) and LED back light (with light on/off switch)
- ❑ Bluetooth – wireless Audio Streaming
- ❑ FM PLL Radio (FM 87.5 – 108Mhz) with Wire FM Antenna
- ❑ USB Port – play audio files
- ❑ SD Card Slot – play audio files
- ❑ Aux-in Jack for connecting and playback of external audio players
- ❑ 2 x 2W full range Stereo Speakers built in
- ❑ DC operated by 9V/1.0A Power Adaptor (supplied)



TOUCH ROCK MW 50

RETRO 2-PART JUKEBOX WITH TOUCH CONTROL SCREEN WITH IOS OR ANDROID SCREEN MIRRORING, CD & VIDEO PLAYER, RADIO, USB-SD MP3/AUX & BLUETOOTH PLAYBACK

- Reproduction 2-part Floor standing Jukebox with LED Lighting
- Separate Jukebox TOP and SPEAKER Base with easy home self-assembly/connection
- TFT Screen (6" □) in Multi-Audio & DVD Wi-Fi enabled module with Remote Control
- Touch Control with Mirroring for IOS or Android Devices
- Disc Slot in DVD Head unit:
- Bluetooth® Playback
- Mw-Fm Radio: Fm 87.5-108 MHz/Am (= MW) 522-1620 KHz – Wire Aerial cable supplied
- 1 x USB Port ('A') - 128MB – 8GB (USB cable not supplied)
- 2 x Micro SD Card Slots - 128MB – 8GB (cards not supplied)
- Aux-in Jack (3.5mm dia.) (Aux lead not supplied)
- Audio Input Jacks (RCA R+L) on rear panel
- Headphone Jack (3.5mm dia.) on rear panel
- Two Remote Controls can be stored magnetically on front panel of cabinet
- Colour changing SMD LED lighting system with dedicated 24-button Lighting Remote Control
- Audio output power: 2 x 25W RMS – 120W p.m.p.o.
- Speakers & Tweeters (4" and 8")
- Ext. Speaker Jack (R + L) - with INT/EXT; 4 Ohm/□
- Real wood veneer cabinet
- 100-230V □ 50Hz AC operated - 15V/10A AC/DC Switching Adaptor supplied



black cherry light white
wood wood wood





Nostalgic Telephones

STP121

1930'S STYLE DESK TOP

- Rotary Dialling
- Mechanical ringing Bell
- Last number re-dial
- Hands free dialling: Press centre button to allow dialling without picking up the handset
- Card supplied for owner's own telephone number under centre button cover
- Dimensions: Approx. Base: 130w 240w (incl. Handset) x 195d x 140h mm



SNW30PB

1930'S STYLE PUSH BUTTON

- Retro Desktop Telephone
- Push Button Dialling
- Antique Brass look Dial
- Glossy Black finish
- Last number re-dial
- Dimensions: 240w mm x 180 h x 140d mm



SNW30

1930'S STYLE ROTARY DIAL

- Retro Desktop Telephone
- Rotary Dialling
- Antique Brass look Dial
- Glossy Black finish
- Last number re-dial
- Dimensions: Approx. 240w mm x 180hx140d mm



SNW17

NOSTALGIA TABLE TOP

- Push button dialling
- Classic Dark Wood Effect Resin & Metal Effect Finish
- Dimensions: 250w mm (incl. handset) x 210h mm Base: dia. 170mm



STP1960

1970'S STYLE DESK TOP

- Rotary Dialling
- Mechanical ringing Bell
- Hands free dialling - Press centre button to dial without picking up the handset
- Last number re-dial
- Card supplied for owner's own telephone number under centre button cover
- Handset with plastic curly cable
- Dimensions: Approx. 210W x 230L x 120H mm



SGSM1

BIG BUTTON GSM PHONE

- Big Button Push-button Dial
- SIM Slot: Insert any SIM Card
- Send & Receive SMS Text Messages
- Easy Read LCD Display
- Three photo frame Speed Dial/Memory buttons
- Push buttons for 'On-Off / Display adjustment / Mute / Answer'
- Built-in rechargeable Li-ion Battery
- AC/DC Charging Adaptor supplied
- Dimensions: Approx. 80h x 180w x 200d mm



BROADWAY

MP3 ENCODING MUSIC SYSTEM WITH BLUETOOTH, VINYL, RADIO, CD & AUX PLAYBACK AND MP3-TO-USB ENCODING

- 3-speed (33/45/78rpm) Record Player with Flip-over Stylus
- Bluetooth® Playback
- Full Function CD Player with 20 track programming
- USB Port for MP3 music playback, connect up to max. 16 GB
- LCD Display and Blue LED backlit Volume Control, Clock; Sleep Timer
- EQ Function
- RCA Line out Jacks
- 3.5mm dia. Aux-in Jack
- 3.5mm dia. Headphone Socket
- Separate Twin Stereo Speakers: 2 x 2W
- RMS Output - 10W p.m.p.o.
- Powered by 230V AC Mains



MEMPHIS 2

5-IN-1 MUSIC SYSTEM WITH DAB & FM RADIO & MP3 TO USB/SD ENCODING

- Pro Deck style Turntable with Pitch Control Strobe
- Illuminator, Auto-stop Switch & Flip-stylus
- Remote Control
- CD Player / Cassette Player
- DAB PLL Radio with Telescopic Aerial
- USB Port & SD Card Slot (max 16GB)
- Aux-in (3.5mm dia) & Line-out (RCA) Jacks
- Subwoofer Jack
- Power by 230V AC Mains
- Dimensions: Approx. 172h x 320w x 305d mm
- Each Speaker: Approx. 225h x 146w 160d mm



Black face



Silver face



METRO

MODULAR MULTI-FUNCTION MUSIC SYSTEM WITH 3-SPEED TURNTABLE, PLL RADIO, AUX-IN/OUT, USB/SD, CASSETTE & CD PLAYER, MP3-TO-USB ENCODING, CD RECORDING & CD-TO-CD COPYING VIA USB MEMORY BUFFERING

- 3-speed 'Pro-Deck' style Turntable (33/45/78rpm) with Pitch Control & Strobe illumination
- Top Module contains Main Controls and Amplifier
- Base Module contains:
 1. Single key Cassette Player
 2. Single CD Player/Burner for
 - (a) CD Recording from Phono, Cassette, USB or Aux
 - (b) CD-to-CD copying via USB Memory Buffering (2GB USB memory stick not supplied)
- USB & SD/MMC playback- connect up to 16GB
- MP3-to-USS recording from CD, Phono, Cassette or Aux
- Aux-in (3.5mm dia.) & Line-out (RCA) Headphone and Subwoofer-out Jack
- Available in Black-silver and Dark-silver finish Separate stereo speakers 2 x 4W RMS
- Power by 230V AC Mains
- Dimensions: Approx. 220h x 305w x 290d mm
Each Speaker Box: Approx. 226h x 140w x 146d mm



black dark
silver silver





ATLANTIC

MODULAR MUSIC SYSTEM WITH 3-SPEED TURNTABLE, DAB+/PLL FM RADIO, CASSETTE & CD PLAYER/CD RECORDER, SD & USB WITH MP3-TO-USB ENCODING AND CD-TO-CD COPYING VIA USB MEMORY BUFFERING

- A 6-in-1 modular Hi-Fi music system with 3-speed 'Pro-Deck' style Turntable (33/45/78rpm), Pitch Control, Strobe illumination & Auto-Stop Switch
- DAB+ Digital & PLL FM Radio (up to 10 pre-sets each)
- Remote Control
- Two user-detachable/removable Modules for Amp, Turntable, etc. or CD & Cassette player servicing - Exchange Modular System
- Top Module contains main controls and Amplifier
- Base Module contains Cassette Player and single CD Deck for Playback & CD Recording/Burning
 - a. Cassette Player (slot-type) with Lockable Fast Forward
 - b. CD Player/Burner - for recording to CD - with track separation - from Vinyl, Cassette, USB & Aux-in
- CD-to-CD copying - via USB Memory Buffering
Connect a Flash Drive - min. 2GB required for copying an entire CD (not supplied)
- MP3 Copying from SD to USB & vice versa
- X-BASS On-Off button
- Subwoofer-out socket (Subwoofer not supplied)
- Dimensions: Approx. 290d x 305w x 220h mm
Each Speaker: Approx. 226h x 140w x 146d mm

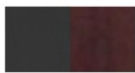

black dark
wood wood



DAB+

BT SMC386 PRO COMP

COMPACT 5-IN-1 MUSIC SYSTEM WITH MP3 TO USB/SD & CASSETTE RECORDING

- 3-speed (33/45/78rpm) Record Player
- Pro Deck style Turntable with Pitch Control
- Strobe Illuminator, Auto-stop Switch & Flip-stylus
- Built-in Speakers
- CD Player / Mw-Fm Radio
- Twin Cassette Player/Recorder
- USB Port/SD Card Slot (max. 16GB)
- Bluetooth Playback
- Black or Silver finish
- Power by 230V AC Mains
- Dimensions: Approx. 290h x 320w x 290d mm



BT SMC386 PRO

5-IN-1 MUSIC SYSTEM WITH MP3 TO USB/SD & CASSETTE RECORDING

- 3-speed (33/45/78rpm) Record Player
- Pro Deck style Turntable with Pitch Control
- Strobe Illuminator, Auto-stop Switch & Flip-stylus
- CD Player / Mw-Fm Radio
- Bluetooth Playback
- Twin Cassette Player/Recorder
- USB Port/SD Card Slot (max. 16GB)
- Black or Silver finish
- Power by 230V AC Mains
- Dimensions: Approx. 290h x 320w x 290d mm





ST-938 BT

3-SPEED RECORD PLAYER WITH BLUETOOTH STREAMING & AUX-IN

- Built-in Bluetooth Transmitter
- 3-speed (33/45/78rpm) Turntable
- Flip-over Stylus and Cueing Arm
- Pitch Control - Turntable Speed adjustment +/- 4%
- Subwoofer-out Socket
- Line-out socket (RCA - L + R)
- Aux-in Jack & Headphone Socket (3.5mm dia.)
- Built-in Stereo Speakers (2 x 1 W RMS)
- Available in Black, Silver & Cream
- Power by 1 2V/800 mA AC/DC Adaptor
- Dimensions: Approx. 305w x 125h x 285d mm



BLUETOOTH
STREAMING





T-012

2.1 MULTI-MEDIA ACTIVE SUBWOOFER WITH SATELLITE SPEAKERS

- Powerful Multi-media Active Subwoofer with two Satellite Speakers•
- Red Power On LED indicator
- Speakers: 2 x 5w RMS (cable length: 1.25m)
- 150 Watts p.m.p.o.
- Connect this system to any Steepletone Audio product that has a 3.5mm dia. Subwoofer out Socket, or to any other external device via its 3.5mm dia. Headphone Jack or other output jack (Aux. connection lead not supplied)



ST930 PRO

3-SPEED RECORD PLAYER WITH MP3 TO USB-SD RECORDING

- 3-speed (33/45/78rpm) 'Pro Deck' style Turntable with flip-over stylus and 45rpm Spindle Adaptor
- Pitch Control and Turntable Strobe Illuminator
- Turntable Auto-Stop On/Off Switch
- Subwoofer-out Jack
- Line-out Jack (RCA: L + R)
- Aux-in Jack (3.5mm dia.)
- Built-in Stereo Speakers: 2 x 1 W RMS Output
- Silver or Black front
- Grey Perspex Dust Cover
- 230V AC Mains powered
- Dimensions: Approx. 320w x 135h x 285d mm





DUO

STEREO BLUETOOTH WIRELESS PAIRING HEADPHONES WITH OPTIONAL BT TX



• SHAREABLE BLUETOOTH HEADPHONES

- 2 Pairs of Bluetooth Wireless Headphones
- Independent +/- Volume on each Headphone
- Operation range up to 10m (open area)
- Built in Lithium Battery/ies
- Rubberized Paint finish
- Soft cup Ear Pads
- 3.5mm Jack to Jack Lead supplied for wired connection
- FM Auto-Scan RadiO
- Use with any audio source, e.g. DVD Player, CD Player, i-POD, iPhone, MP3 Player, TV, VCR, Hi-Fi System or Radio with 3.5mm dia. headphone socket
- Dimensions: Approx. 200h x 190w x 80d mm



2 pairs



red red



optional extra





OPENWEAR

WEARABLE WIRELESS SOUND



- ☒ Bluetooth Connectivity for music or sound Playback - version 4.1
- ☒ Built in FM Analogue Radio
- ☒ Ultra-compact portable, wearable personal stereo Speaker.
- ☒ Oval shape
- ☒ 2 speakers 3W RMS(rated power)
- ☒ Built in FM Radio 87.5~108MHZ
- ☒ Hands Free & ear free calling – with a built-in Microphone.
- ☒ Dual pairing technology to allow both to connect to one device
- ☒ TF (micro SD card) playback
- ☒ MP3, WAV & WMA format music playback.
- ☒ Colour fabric finish
- ☒ Matt Rubber effect for anti-slip on base.
- ☒ Allows user to have immersive headphone listening experience but be open to the outside world.
- ☒ Universal comfortable fit
- ☒ Recharge lithium battery(1100mAh)- up to 4-hour battery life.
- ☒ Lightweight (280g)
- ☒ Micro USB charging cable supplied.





TABBLUE

2.1 BLUETOOTH SOUND SYSTEM WITH AUX PLAYBACK AND TWO USB CHARGING SOCKETS

- Attractive 3 legged table with Real wood Veneer Top
- Bluetooth Playback (BT Version 4.2)
- Aux input for external Audio Players (3.5mm to 3.5mm stereo Aux lead supplied)
- Built in 11.1V/2200mAh (rechargeable) Lithium Battery for wire free play (approx. 3-7hrs)
- Twin USB Ports
- LED function indicator lights
- Hands free calling with built-in Mic
- Built-in Amp
- Stereo Speakers (2.75" 4 Ω - 4 x 12W RMS)
- AC/DC Power Adaptor/Charger (supplied)
- Approx. 408mm dia. x 610mm high



dark wood light wood

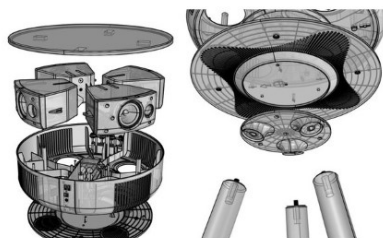

Promo Video
SCAN ME





CAMDEN

PROFESSIONAL WOOD EFFECT FACE AUTO-RETURN TURNTABLE WITH EXTERNAL SPEAKERS AND BLUETOOTH PLAYBACK & TRANSMITTING

- Record Player with Bluetooth Playback
- Professional full size Turntable with felt anti-slip mat
- 3-Speed Turntable: plays 33 1/3, 45 & 78 rpm records - 45rpm spindle adaptor supplied
- Auto-return S-shaped Tone Arm with Flip-over Stylus
- Counter Balance for tone arm weight adjustment
- Turntable Speed/Pitch Control
- Bluetooth Receiver
- RCA Line-out (L + R)
- Stereo Sound via separate speakers - 2 x 4W RMS in matching wood effect
- Sound Output: 25W p.m.p.o.
- 230V AC Mains powered
- Dimensions: Approx. 460w x 166h x 337d mm
- Bluetooth Transmitting for Wireless Speaker Connection



dark wood



BLUETOOTH STREAMING

NEW FEATURE

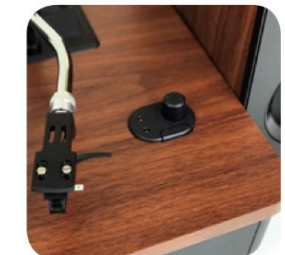



F R E E D O M

M U L T I R O O M S P E A K E R S E T

- ❑ Set of 4 compact wireless Bluetooth Speaker Boxes
- ❑ Synchronised speaker connectivity – range up to 35m, all 4 Speakers can play sound from one music source and be heard in different rooms of an entire house
- ❑ Bluetooth Receiver (vs 4.1) for connection and sound playback of Audio Players and Smart devices (with Bluetooth Transmitter)
- ❑ 3.5mm dia. Aux-in jack
- ❑ Push button controls on each speaker for On/Off, Master/Slave, Bluetooth and Volume Up+/Down-
- ❑ Powered by built-in rechargeable Lithium Battery (Micro USB-to-USB DC Charging Cable supplied – DC charger plug not supplied)
- ❑ 2 x 5W RMS Speakers in each speaker box
- ❑ Up to 21 speakers can be linked
- ❑ Up to 5 hours of cordless play (at 75% volume) on full charge
- ❑ Available in Black or Teak Wood effect with Black Mesh Speaker Grill (removable)
- ❑ Removable speaker grills



SOLD AS A SET OF 4





IBIZA TUBE

2.1 SOUND SYSTEM WITH LED LIGHTING, BLUETOOTH, FM RADIO, MP3 & AUX PLAYBACK

• AMAZING SOUND-TO-LIGHT HIGH POWER SOUND SYSTEM

- Floor standing LED Sound System
- Bluetooth Playback (+ NFC)
- USB Port & SD/MMC card slot for MP3 playback
- Aux input for external Audio Players (Aux connection lead supplied)
- FM radio (with wire Aerial)
- 111 SMD LED Multi-Mode Colour Changing chasing Lights
- Sound-to-Light effect
- Full function Remote Control
- Built-in Stereo Speakers (2 x 15W RMS)
- Super 100W p.m.p.o.
- Pulse button Controls
- Transparent (Opaque) Tube & multi SMD LED's: 5 Light Modes and 7 Colour Modes
- Powered by 230v AC mains
- Dimensions: Approx. 220dia/Base 295mm dia x 1060mm h

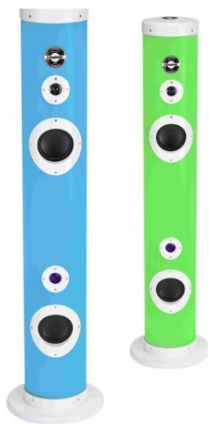

MODULAR FLOOR BOX SYSTEM

3-MODULE SPEAKER SOUND SYSTEM WITH LASER LIGHT, REMOTE CONTROL, RADIO, BLUETOOTH, MIC INPUT, GUITAR, AUX & USB/SD MP3 PLAYBACK

SFB1 M - FLOOR BOX 2-TWEETER TOP AMPLIFIER MODULE

SFB1 S - FLOOR BOX 1-SPEAKER MID-SECTION MODULE

SFB2B - FLOOR BOX 2-SPEAKER BASE SECTION MODULE WITH WHEELS

- Powerful Speaker and Sound Amplifier System
- LED Laser Light on top panel (with On/Off Switch)
- Modular design:
 - (1) SFB1 M: Main Amp Top module (2 x 1" Tweeters)
 - (2) SFB1 S: Single Speaker module (1 x 10" Speaker)
 - (3) SFB2B: 2-sprk wheeled base module (2 x 10" Spkr)
- Sound activated LED's in Tweeters
- Bluetooth™ Connectivity & Playback
- USB & SD/MMC connection and MP3 playback
- FM Scan Radio
- MIC Input (1 + 2) (for PNKaraoke use - Microphones not supplied)
- Guitar Amplification input socket with Volume Control
- RCA (L + R) Aux-in socket for connecting external Audio Players
- Handles (L + R) and Wheels for ease of transportation
- 230V -50Hz AC Mains operated via detachable AC Power Cable
- Dimensions: assembled 3-sprk System: Approx. 1170h x 330w x 330d mm
2-sprk System: Approx. 1037h x 330w x 330d mm

SFB1M tweeter top amplifier module

SFB1S middle speaker

SFB2B double speaker with wheels





Speaker Systems

AZTEC 2

SOUND SYSTEM WITH LED LIGHTING, BLUETOOTH, MP3 & AUX PLAYBACK

- Floor standing LED Sound System
- Bluetooth Playback
- USB Port & SD/MMC card slot for MP3 playback
- Aux input for external Audio Players
- Mic Input socket with Mic Control
- Multi-Mode LED Colour Changing chasing Lights
- Sound-to-Light effect
- Full function Remote Control
- Built-in Stereo Speakers (2 x 10 RMS)
- Super 55W p.m.p.o. built-in Subwoofer
- Master Volume, Bass & Treble Controls
- Hi-Gloss 'Piano' Effect Finish: Red, White or Black
- Powered by 15V/2.1A DC Adaptor (supplied)
- Dimensions: Approx. 710h/1032h x 175w x 210d mm



SM001 XP

HI POWER BLUETOOTH / MP3 / USB / SD BOOM BOX

• AMAZING SOUND-TO-LIGHT HIGH POWER SOUND SYSTEM

- 'No Moving Parts' Stereo Music System
- MP3 music playback from USB & SD/MMC card (up to 16GB)
- Built-in Amplifier with digital power IC's
- Powerful 20W built-in Subwoofer - venting ports with LED lighting
- Built-in Speakers: 2 x 5W Output
- AUX input (3.5mm dia. jack) for playback of external music players
- MIC input Socket (Microphone not supplied)
- Control Panel with Volume, Mic, Echo, Treble & Bass adjustment controls and USB/SD
- Tough Trolley style cabinet with Carry Handle, single direction caster wheels and travel case style telescopic Pull Handle
- Protective Corners on cabinet
- Powered by lightweight built-in rechargeable 4400Ma Lithium battery, or by using the AC/DC Adaptor/Charger (15V/2.1A - supplied)
- Dimensions: Approx. 230d x 220w x 450h mm dia. x 1060mm h



Carry handle



Control panel



Rear view





Connect up to 99 Cubes



CUBE CONNEX 20_{CM}

Multi Link Bluetooth Cube Speakers- With Sound-2-Light LED Flashing

- Multi Connective Cube Speakers
- Unlimited amount that can be connected
- Synchronised speaker connectivity-allowing 35-meter range.
- Rechargeable lithium battery-6 hours of cordless play.
- Hard, Strong and robust, transparent plastic.
- Water Resistant with IPX rating(certification)
- Bluetooth Playback
- SMD LED Multi-Mode Colour Changing Chasing Lights
- Supplied Remote Control
- Downloadable App for Android or IOS
- Sound-to-Light effect
- 20cmx20cmx20cm



Multi
Colour
Light
Changing

Colour changing.





CUBE CONNEX 30_{CM}



Connect up to 99 Cubes

Multi Link Bluetooth Cube Speakers- With Sound-2-Light LED Flashing

- Multi Connective Cube Speakers
- Unlimited amount that can be connected
- Synchronised speaker connectivity-allowing upto 35M range.
- Rechargeable lithium battery for upto 6 hours of cordless play.
- Hard, Strong and robust, transparent plastic.
- Water Resistant with IPX rating
- Bluetooth Playback
- SMD LED Multi-Mode Colour Changing Chasing Lights
- Sound-to-Light effect
- Supplied Remote Control
- Downloadable App for Android or IOS
- 30cmx30cmx30cm

Cube 30

Cube 20



Multi Colour Light Changing



STLCR1 RS

**RADIO-CONTROLLED AUTO TIME SETTING
ALARM CLOCK RADIO WITH TOUCH
CONTROL "LIFETIME LIGHT"**

- Radio-controlled Clock with accurate 'Auto Time Setting & Maintaining'
- Lifetime guaranteed SMD LED Light System with 24-LED SMD Light Panel
- Touch Control brightness system
- Mw-Fm Analogue Radio
- Red LED Clock backlight
- Alarm & Snooze Function
- 3.5mm dia. Headphone Jack
- Clock, Radio & Lights powered by 9V/1 A DC Adaptor
- Clock back-up battery not supplied (1 x 1.5v/'AAA' size)
- Dimensions: Approx. 260h x 160 dia base/Shade 210mm dia mm

Tap
On/Off

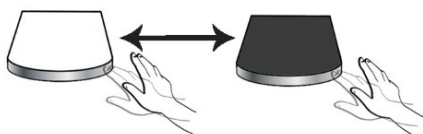

Touch &
Hold
To Dim

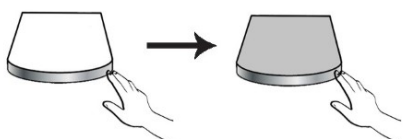

Touch &
Hold
To Brighten

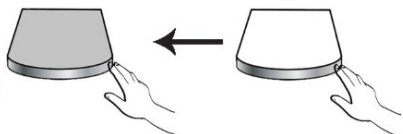



SRB2

LP RECORD STORAGE CARRY CASE

- Portable LP Record Storage Box with Carry Handle
- Robust Vinyl covering
- Protective Chrome effect trim on corners and all edges of the box
- Hinged Lid with closing clasps
- Holds approx. up to 50 LP's in their sleeves
- Dimensions: Approx. 345w x 200d x 336h mm



SRB07SGL

COMPACT 7 INCH 'SINGLES' STORAGE & CARRY CASE

- Robust Vinyl covering - 5 colours available
- Protective Corners and Trim
- Carry Handle
- Holds up to approx. fifty 7" singles in their sleeves
- Dimensions: Approx. 217w x 195d x 217h mm





SRB3M

LARGE PARTITIONED STORAGE & CARRY CASE WITH REMOVABLE HINGED LID

- Storage for LP's, CD's, Singles or Cassettes
- One adjustable partition
- Robust Vinyl covering - available in 4 colours: Black, Orange, Green & Blue
- Protective Chrome effect Aluminium trim on corners and all edges
- Strong Vinyl Carry Handle & Closing Clasps
- Removable hinged Lid
- Dimensions: Approx. 350w x 210d x 340h mm



SCD24

COMPACT PORTABLE CD STORAGE & CARRY CASE

- Holds approx. 24 CD's in their jewel cases
- Robust Vinyl covering
- Available in Black & Red
- Protective Chrome effect Aluminium trim on corners and all edges
- Strong Vinyl Carry Handle & Closing Clasp
- Hinged Lid
- Dimensions: Approx. 280w x 155d x 175h mm

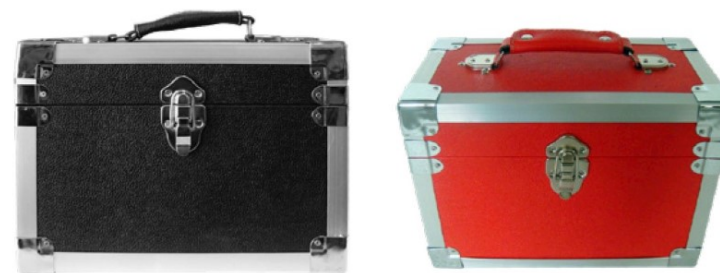

SSTY1 / SSTY3 / SSTY4 / SSTY8

SINGLE REPLACEMENT OF STYLUS

SOLD INDIVIDUALLY

SBSK1 / SBSK3 / SBSK4 / SBSK8

STYLUS & RECORD CLEANING KITS

- Anti-static velvet & wood record cleaning 'brush'
- 25cc Bottle of Distilled water for cleaning records
- Two replacement universal Sapphire Styli
- Compatible with Steepletone Record Players





STEEPLETONE UK LTD, PARK END WORKS, CROUGHTON, BRACKLEY, NORTHANTS, NN13 5RD

Trade Sales: 01869 812828
Technical Support: 01869 812 822
Service Administration: 01869 812 830
Accounts: 01869 812 827
General Enquiries: 01869 810 081
Fax: 01869 810 784

sales@steepletone.com

www.steepletone.com

 Steepletone UK LTD

 @SteepletoneUK

 @SteepletoneUK