

PHILIPS *Service* notes

AG 4000

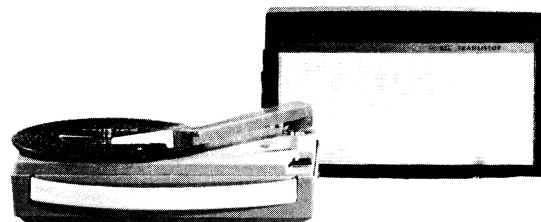

SPECIFICATIONS

Battery Equipment	-	6 x 1.5V cells (950, D50, 1050)
Current consumption (no signal)		50 - 70 mA
Record player		AG 2040
Pick-up Head		See table below

PICK-UP HEADS

<u>HEAD</u>		<u>STYLUS</u>	Description	Code No.
Type No.	Element			
AG 3306	Crystal	Sapphire, 75 μ macrogroove)	946/SS50
		Sapphire, 18 μ stereo microgroove		
AG 3310	Crystal	Sapphire, 75 μ macrogroove)	946/DS51
		Diamond, 18 μ stereo microgroove		
AG 3224	Ceramic	Sapphire, 75 μ macrogroove)	946/SS50
		Sapphire, 18 μ stereo microgroove		
AG 3228	Ceramic	Sapphire, 75 μ macrogroove)	946/DS51
		Diamond, 18 μ stereo microgroove		

REMOVAL FROM CASE

To remove the unit from the bottom portion of the case, remove the two screws from the underside of the case and the third screw located inside the battery compartment.

REMOVAL OF FRONT GRILLE

The front speaker grille is removed by unscrewing the four screws from the corner locations inside the speaker housing.

SPEAKER REMOVAL

After removal of the front grille, the speaker mounting screws are made accessible. Removal of these four screws allows the speaker to be lifted from its housing.

OUTPUT BIAS ADJUSTMENT

Alongside C6 on the component side of the printed board is a wire link which may be unsoldered at one end to allow of insertion of a meter for measurement of output transistor collector current. Adjust R13, without signal, for a combined output transistor collector current of 10 mA.

STYLUS PRESSURE

Stylus pressure should be between 4 and 6 gms. Adjustment of pressure is by way of adjusting strip 73.

March, 1963

Published by PHILIPS ELECTRICAL INDUSTRIES PTY. LIMITED

Branches in all States

AG 4000

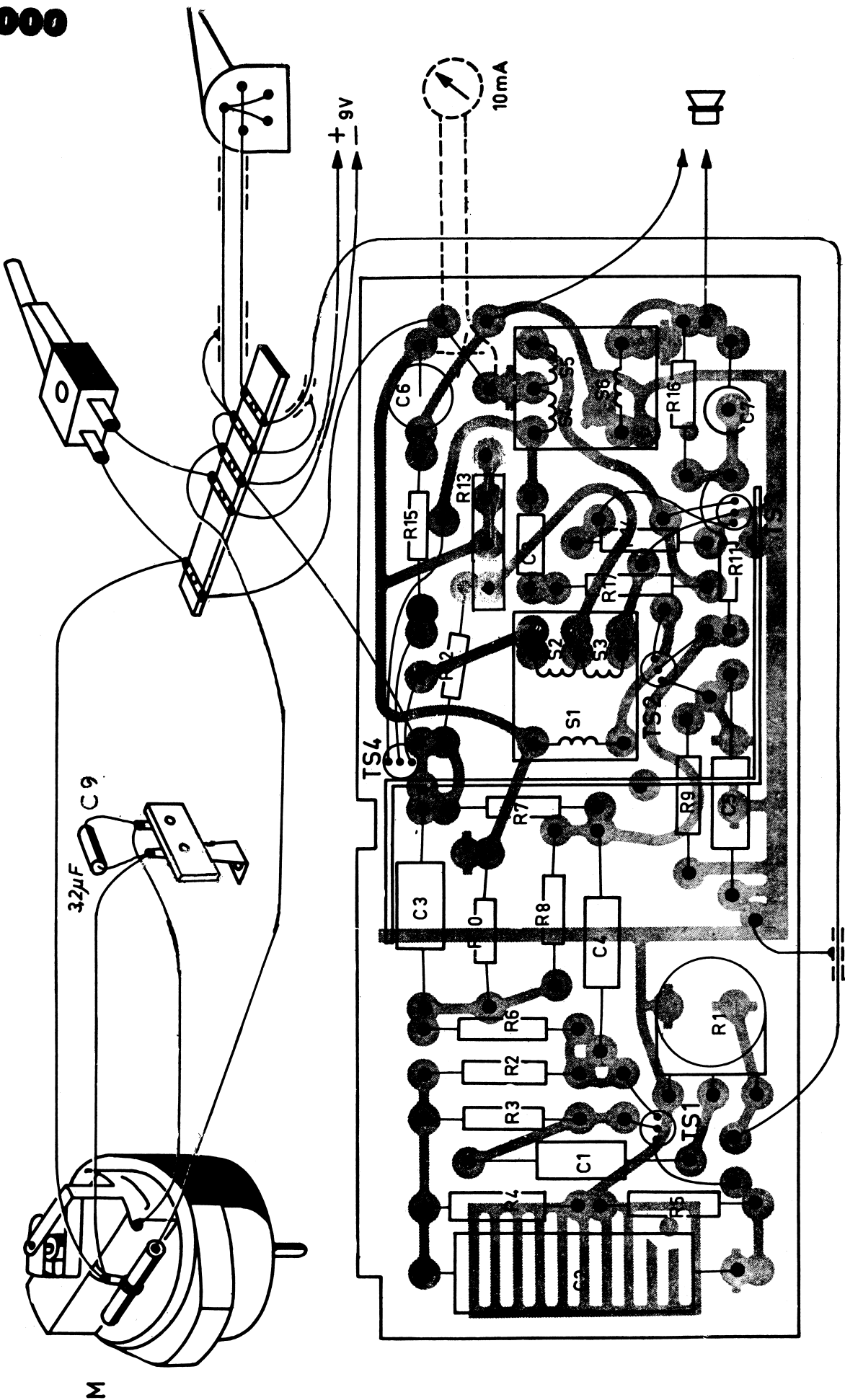

AG 4000

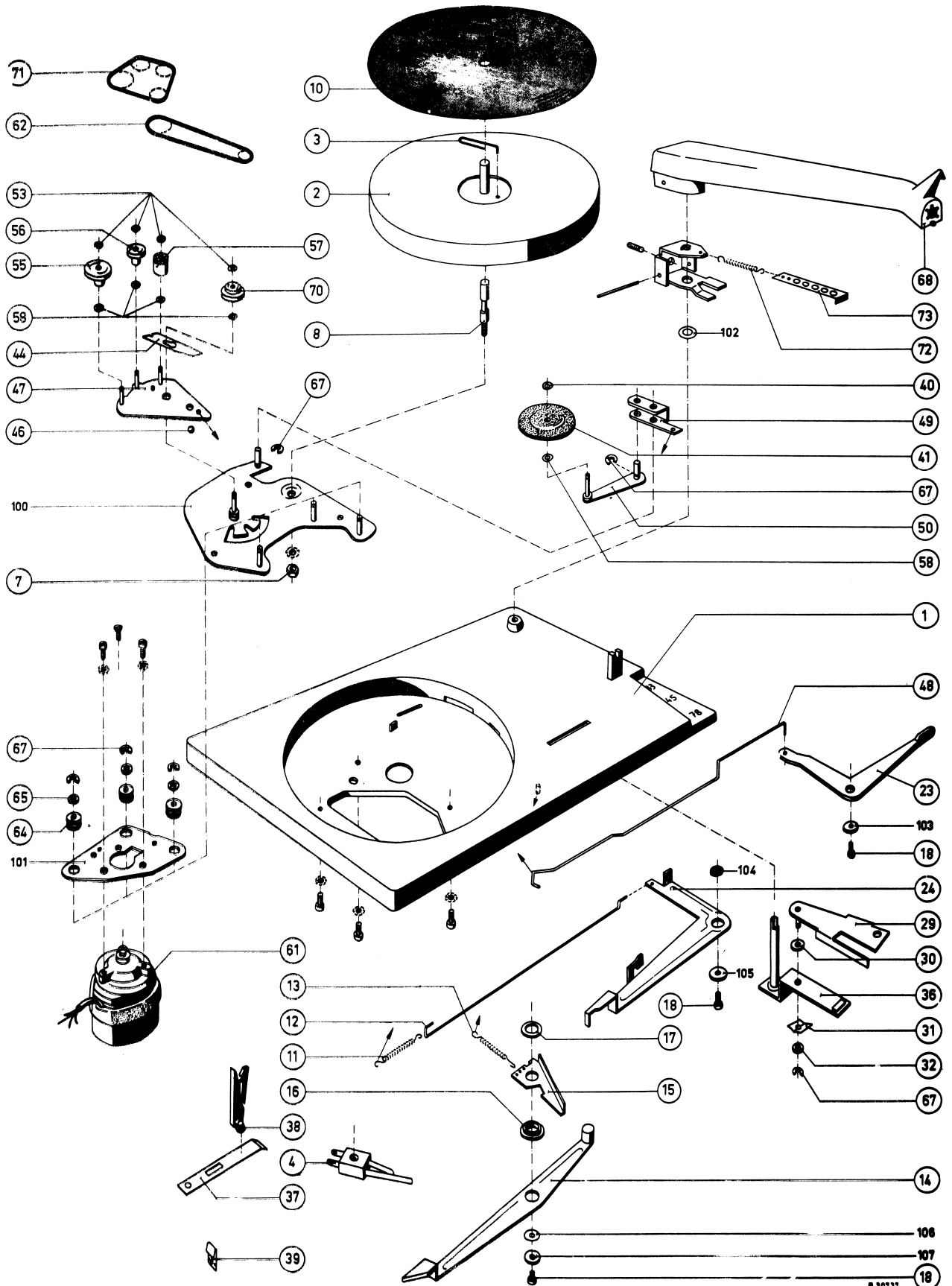

PARTS LIST - RECORD PLAYER AG 2040

<u>Drawing No.</u>	<u>Description</u>	<u>Code No.</u>
1	Mounting plate	TD.801.36
2	Turntable	AE.606.92
3	Turntable sec. spring	TD.700.48
4	Switch	P5.512.18/159
7	Nut	933/M4
8	Turntable spindle	TD.700.50
10	Turntable mat, brown	TD.650.17/KW
10	Turntable mat, red	TD.650.17/JF
10	Turntable mat, blue	TD.650.17/MY
11	Tension spring	TD.700.60
12	Bar	TD.500.29
13	Tension spring	TD.700.61
14	Record size finger	TD.050.70
15	Bracket	TD.050.71
16	Bush	TD.100.19
17	Washer	TD.000.18
18	Screw	B.054.EE/2x4
23	Lever	TD.300.48
24	Bracket	TD.050.72
29	Bracket assembly	AE.606.95
30	Washer	TD.600.04
31	Leaf spring	TD.700.58
32	Washer	988/3
36	Bracket assembly	TD.801.31
37	Leaf spring	TD.700.59
38	Pick-up arm support	TD.300.55
39	Leaf spring	TD.050.76
40	Ring	TD.300.49
41	Intermediate wheel	TD.801.27
44	Leaf spring	TD.700.51
46	Steel ball 1/8"	89.205.02
47	Bracket assembly	AE.606.96
49	U bracket	TD.050.78
50	Intermediate wheel bracket	AE.606.94
53	Washer	TD.300.49
55	33.1/3 r.p.m. wheel	TD.801.38
56	45 r.p.m. wheel	TD.801.39
57	78 r.p.m. wheel	TD.801.37
58	Washer	5N.290.29
61	Motor	JW.525.09
62	Drive belt (long)	TD.650.18
64	Grommet	TD.650.16
65	Washer	988/3
67	Washer	985/3
68	Pick-up arm assembly	TD.801.32
70	Idler wheel	TD.801.42
71	Drive belt (short)	AE.016.17
72	Tension spring	AE.014.74
73	Adjusting strip	AE.014.75
	45 r.p.m. record adaptor	TD.300.54