

Cassette recorder D6625/30P

Service
Service
Service

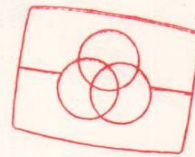

Free service manuals
Gratis schema's
Digitized by

www.freesevicemanuals.info

Service Manual

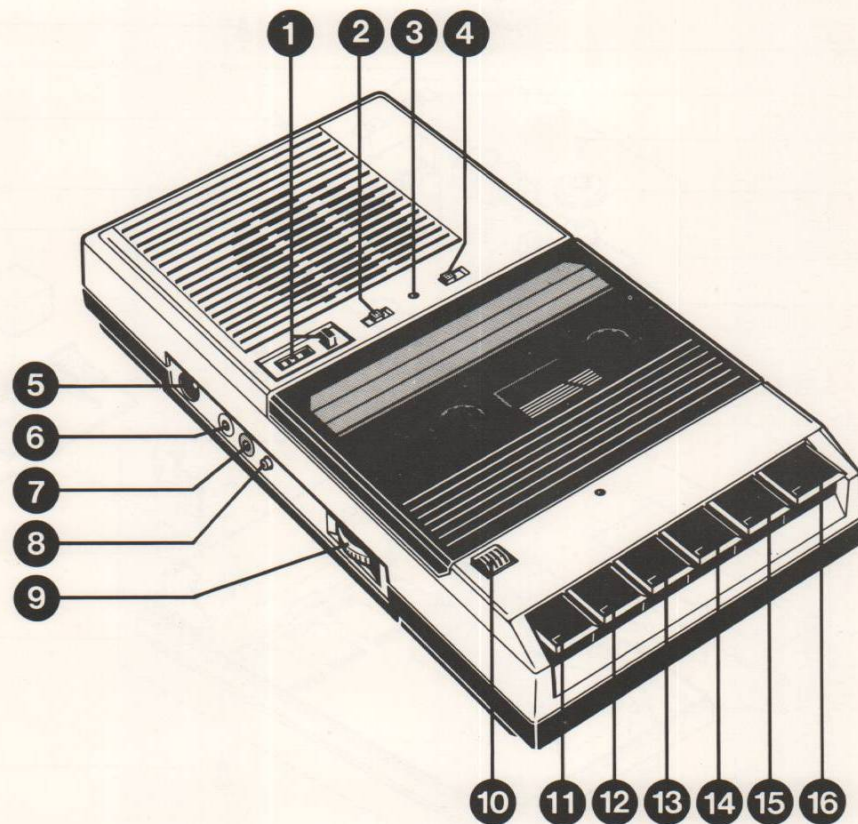

36 769 A

Connections and controls

1		Tape counter	
2		Phase switch	S3
3		Load save indicator	
4		Normal/Data monitor switch	S2
5		External supply DC	J4
6		Line out/earphone	J2
7		Line in/mice	J1
8		Remote control	J3
9			VR1
10			C.Mic
11			S4
12			S1, S4, S6
13			S1, S4, S6
14			S5, S4
15			S5, S4
16			

Specifications

	6V (4 x R6)		350 mW d = ≤ 10%
Tape speed	4,76 cm/s ± 3%	Frequency response	125 - 6,3 kHz + 4 - 8 dB
Wow and Flutter	0,35%		
Play back torque	30-65 G/cm		



Cue-View Adjustment

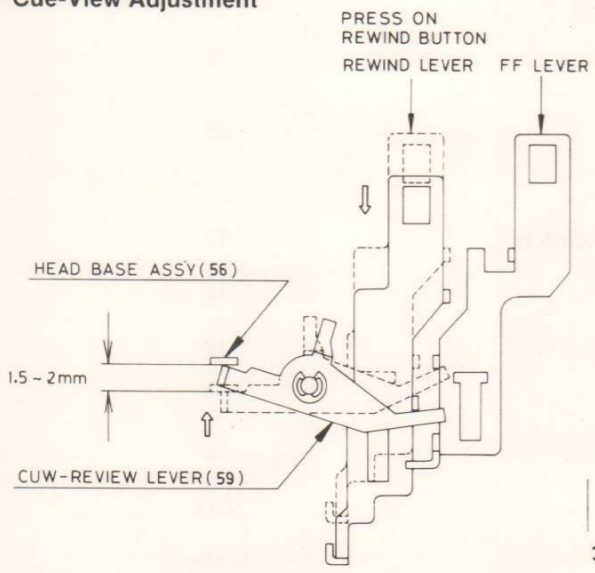

Flywheel Adjustment

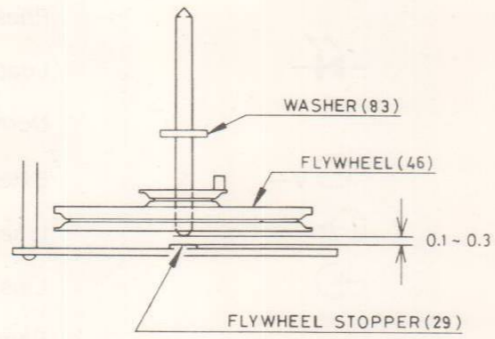

Checking operation of autostop

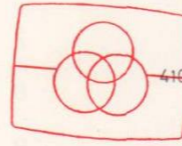
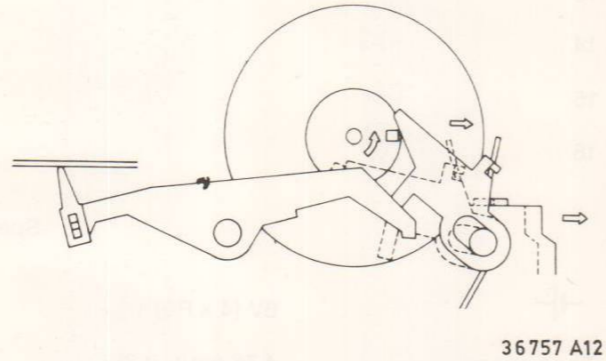
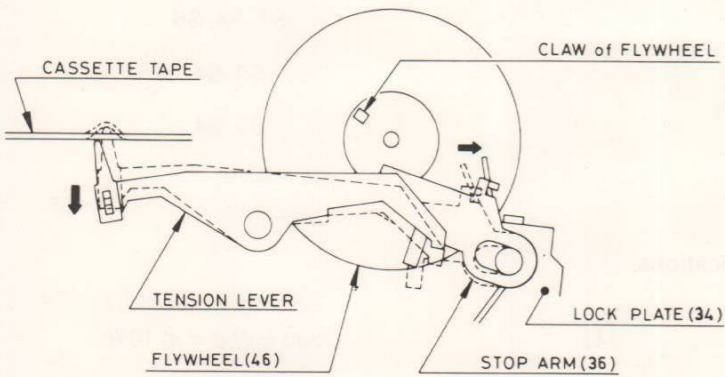

Free service manuals
Gratis schema's
Digitized by

www.freesevicemanuals.info

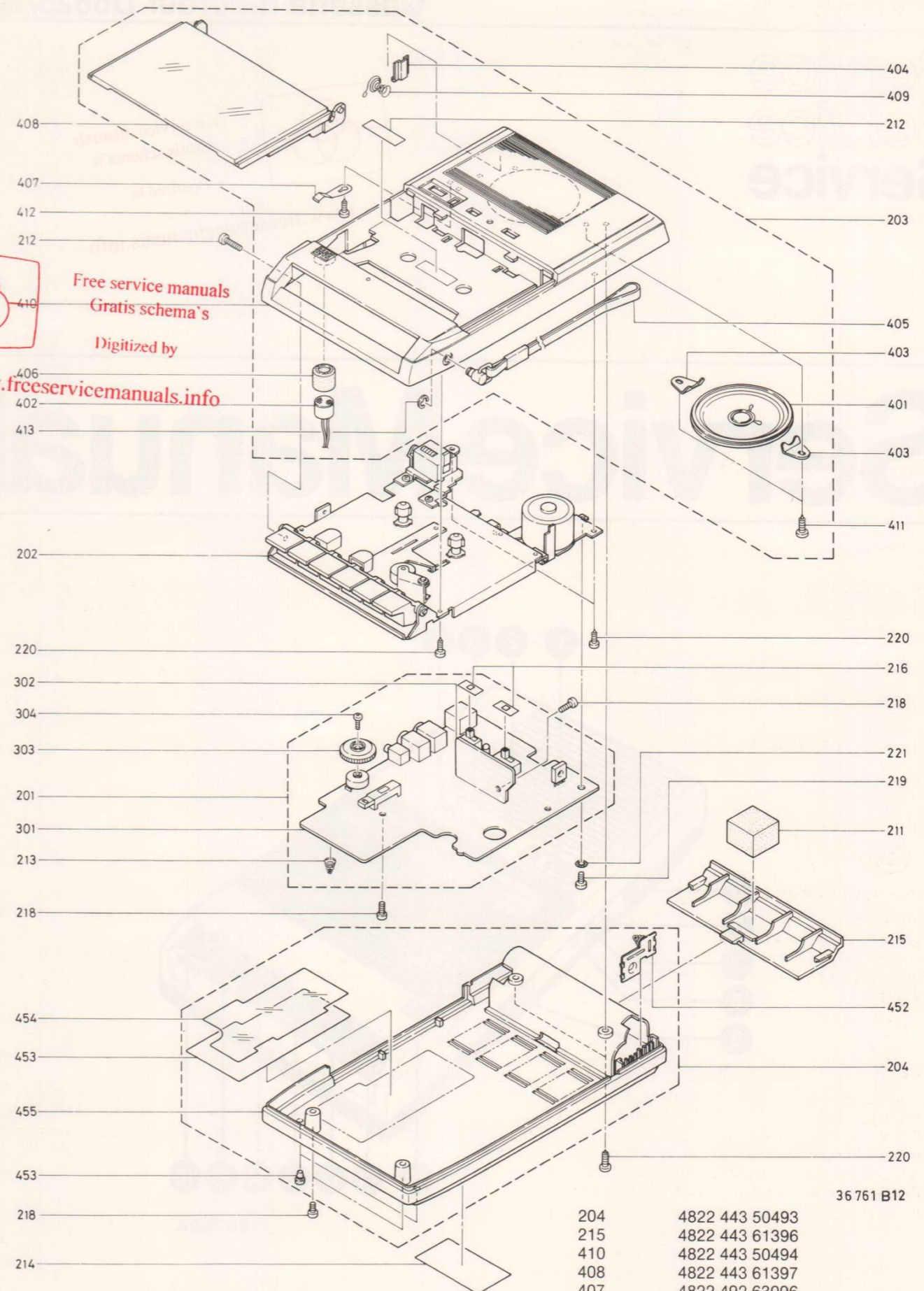

36 761 B12

204	4822 443 50493
215	4822 443 61396
410	4822 443 50494
408	4822 443 61397
407	4822 492 63096
409	4822 492 51654
401	4822 240 30276
402	4822 242 10049
404	4822 290 80479
405	4822 403 51357
303	4822 413 41241

GB

Cue-Review adjustment

If the "FF" or "Rew" button is depressed on a recorder set to "Play" mode ("Review" or "Cue"), the heads slide should move 1,5 to 2 mm. This can be adjusted by means of the lug as shown in Fig. 7.

NL

Instelling Cue-Review

Wanneer de "Fast Forward" of "Rewind" toets is ingedrukt in de "Play" situatie ("review" of "cue") moet de koppenschuif 1,5 mm - 2 mm verschuiven. Dit kan worden ingesteld met de lip zoals aangegeven in Fig. 7.

F

Réglage des fonctions Cue-Review

Lorsqu'on enfonce la touche "FF" (défilement rapide avant) ou la touche "Rew" (défilement rapide arrière), l'appareil étant en position "Play" (lecture), pour effectuer les positions "Review" ou "Cue", la glissière porte-têtes doit se déplacer sur 1,5 à 2 mm. Ce déplacement peut être ajusté au moyen de la languette (voir la figure 7).

D

Einstellung "Cue-Review"

Wenn in der "Play"-Stellung ("Review" oder "Cue"), die FF-oder REW-Taste gedrückt ist, soll der Kopfschieber um 1,5 - 2 mm verschieben. Dies lässt sich einstellen mit der Zunge wie in Bild 7 dargestellt.

I

Regolazione del "cue-review"

Quando il tasto "avvolgimento accelerato" o "riavvolgimento" viene premuto in posizione "marcia" ("cue" o "review") il corsoro di testa deve muoversi di 1,5 a 2 mm, il chè può essere regolato con la linguetta come apparisce in Fig. 7

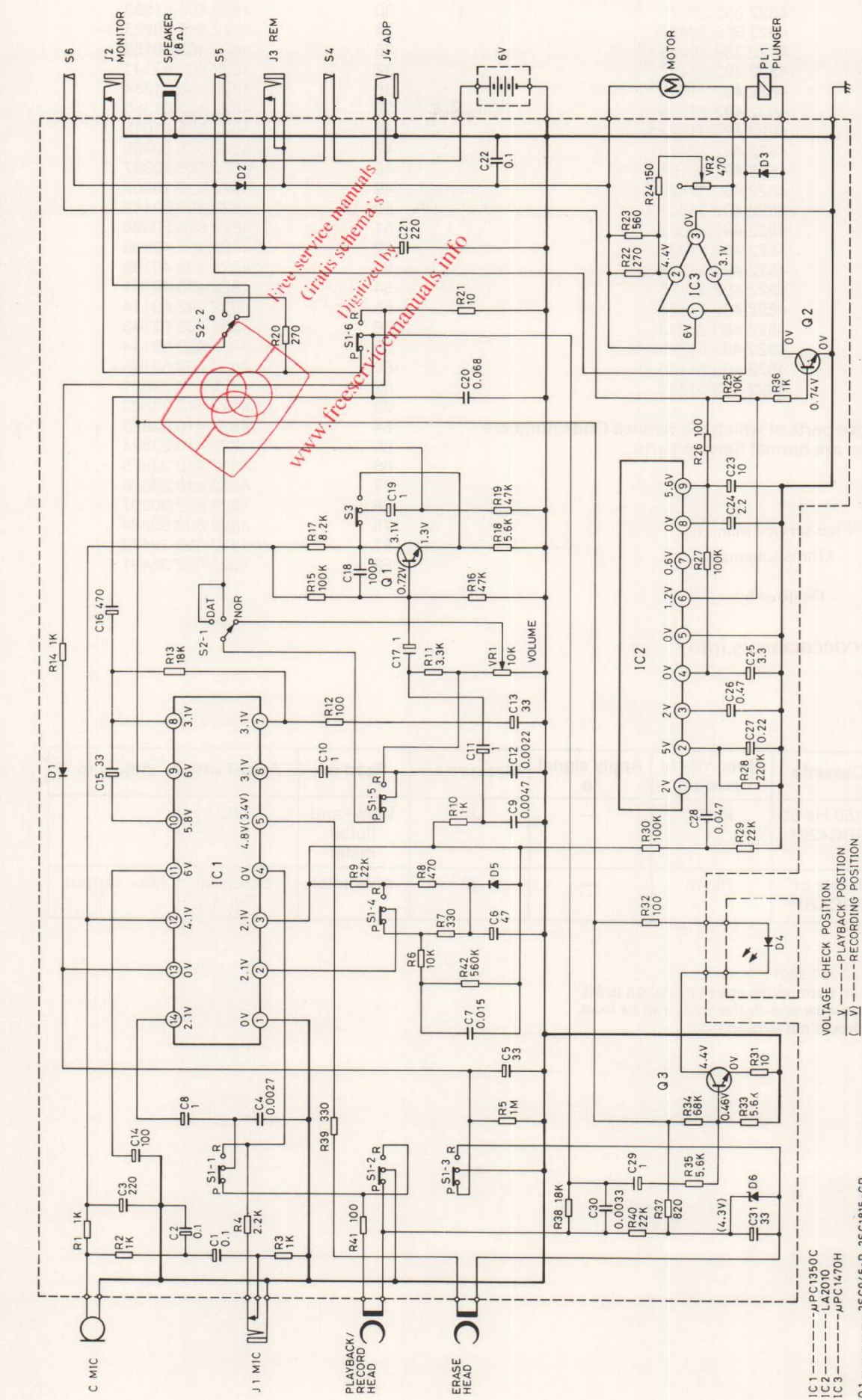

NOTES:
 1. ALL RESISTANCE VALUES ARE IN Ω, K=1000Ω, M=10000Ω.
 2. ALL CAPACITANCE VALUES ARE IN pF, P=10⁻¹² F.
 3. ALL COMPONENTS ARE TO BE USED UNLESS OTHERWISE SPECIFIED.
 4. VOLTAGES MEASURED FROM POINT INDICATING MINIMUM AND NO SIGNAL (SPECIFICATIONS AND CIRCUITS SUBJECT TO CHANGE WITHOUT NOTICE FOR IMPROVEMENT).
AS FROM SERIAL NUMBER 20001 THE POLARITY OF THE REMOTE CONTROL SOCKET J3 HAS BEEN REVERSED.

VOLTAGE CHECK POSITION
 V-----PLAYBACK POSITION
 V-----RECORDING POSITION

S1-----RECORD/PLAYBACK SWITCH (PLAYBACK POSITION)
 S2-----NORMAL/DATA MONITOR ON/OFF SWITCH (NORMAL POSITION)
 S3-----PHASE CHANGE SWITCH (REWIND POSITION)
 S4-----TAPE ON/OFF SWITCH (OFF POSITION)
 S5-----FAST-FORWARD/REWIND SWITCH (OFF POSITION)
 S6-----APDS SWITCH (OFF POSITION)

IC1-----µPC1350C
 IC2-----LA2010
 IC3-----µPC1470H
 Q1-----2SC945-P, 2SC1815-GR,
 2SC458-D or 2SC1684-S
 Q2-----2SC785-E, F or 2SC2458-GR
 Q3-----MA150, 1N4148,
 151888 or DS442
 D1,5-----SH-1A-02 or 1N4001
 D2,3-----TLR102A
 D4-----H25A-3 or RD4.7EB3
 D6-----

36 762 B12

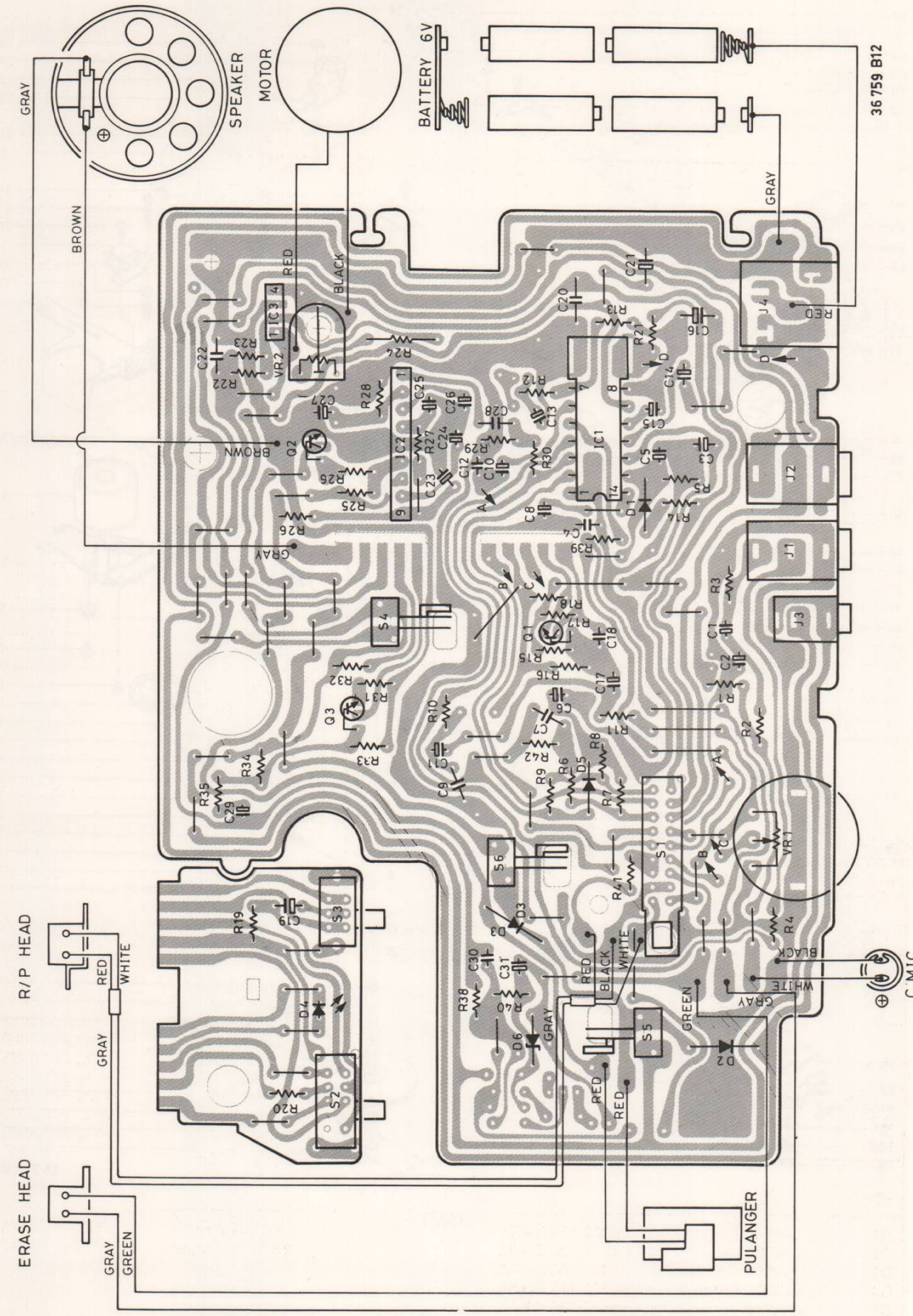

36 759 B12

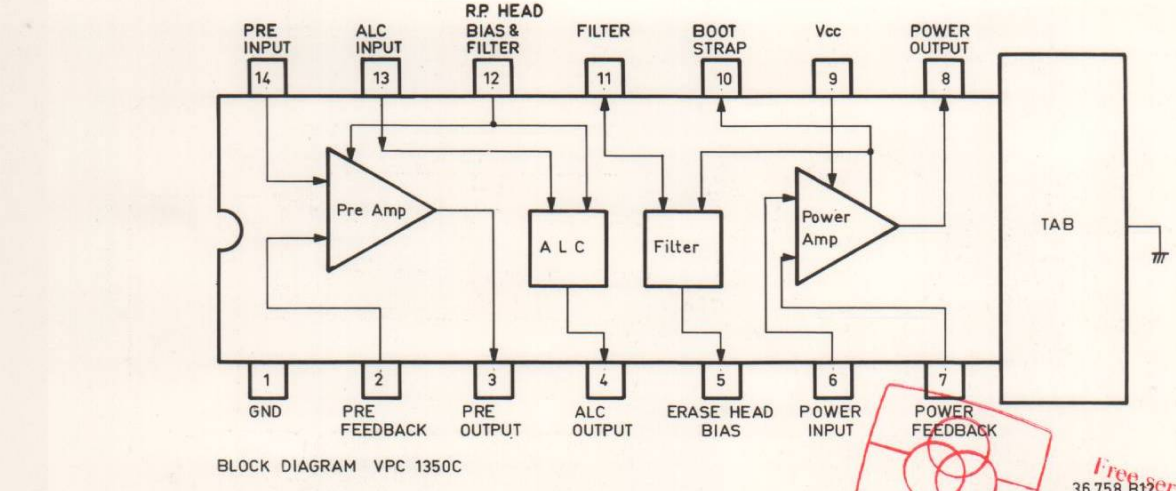

BLOCK DIAGRAM VPC 1350C

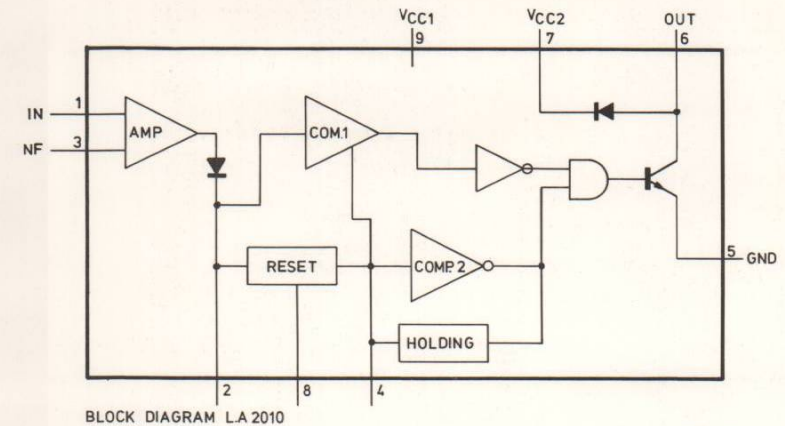

BLOCK DIAGRAM LA 2010

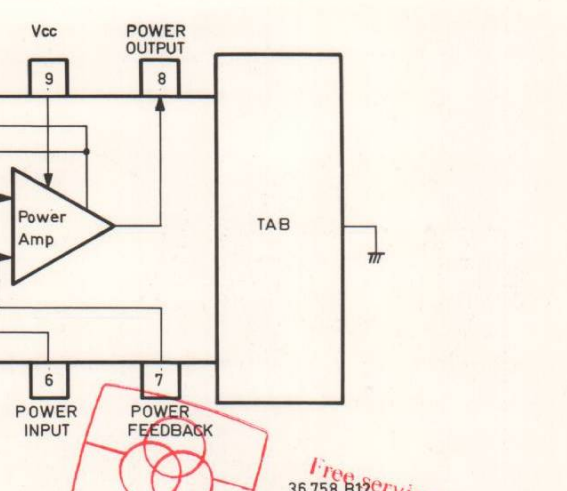

µPC1470H (Motor Control)

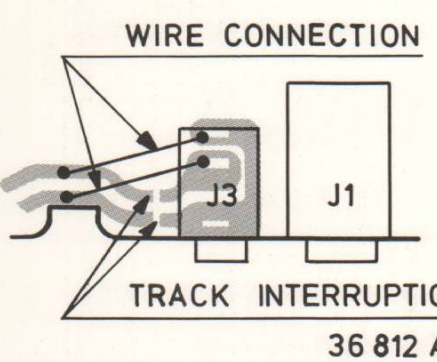

Fig.1

36 812 A12

For a proper switching of some computer versions, it may be necessary to reverse the polarity of the remote control socket. See Fig. 1.

-IC-		-Miscellaneous-							
1C1	µpc 1350 c	4822 209 80778	J1	Mice	4822 267 30583				
1C2	LA2010	4822 209 82424	J2	Line out	4822 267 30579				
1C3	µpc 1470H	4822 209 50107	J3	Remote control	4822 264 30135				
-TS-		J4		External supply	4822 264 30137				
		S1		R/P	4822 277 20802				
		S2		Normal/Data	4822 277 20955				
Q1	2SC945-p	4822 130 41198	S3		Phase	4822 277 20954			
Q2	2SD467	4822 130 41521	S4		R/P on-off	4822 277 60223			
Q3	2SC2785-E	4822 130 42364	S5		FF/Rew	4822 277 60223			
-D-		-R-		VR1	volume	4822 101 20781			
				D1	IN4148	4822 130 30621	VR2	Tape speed	4822 100 10427
				D2	IN4001	4822 130 31438			
				D3	IN4001	4822 130 31438			
				D4	LEDTLR102A	4822 130 32096			
				D5	IN4148	4822 130 30621			
D6	RD4 7EB3	4822 130 34174							

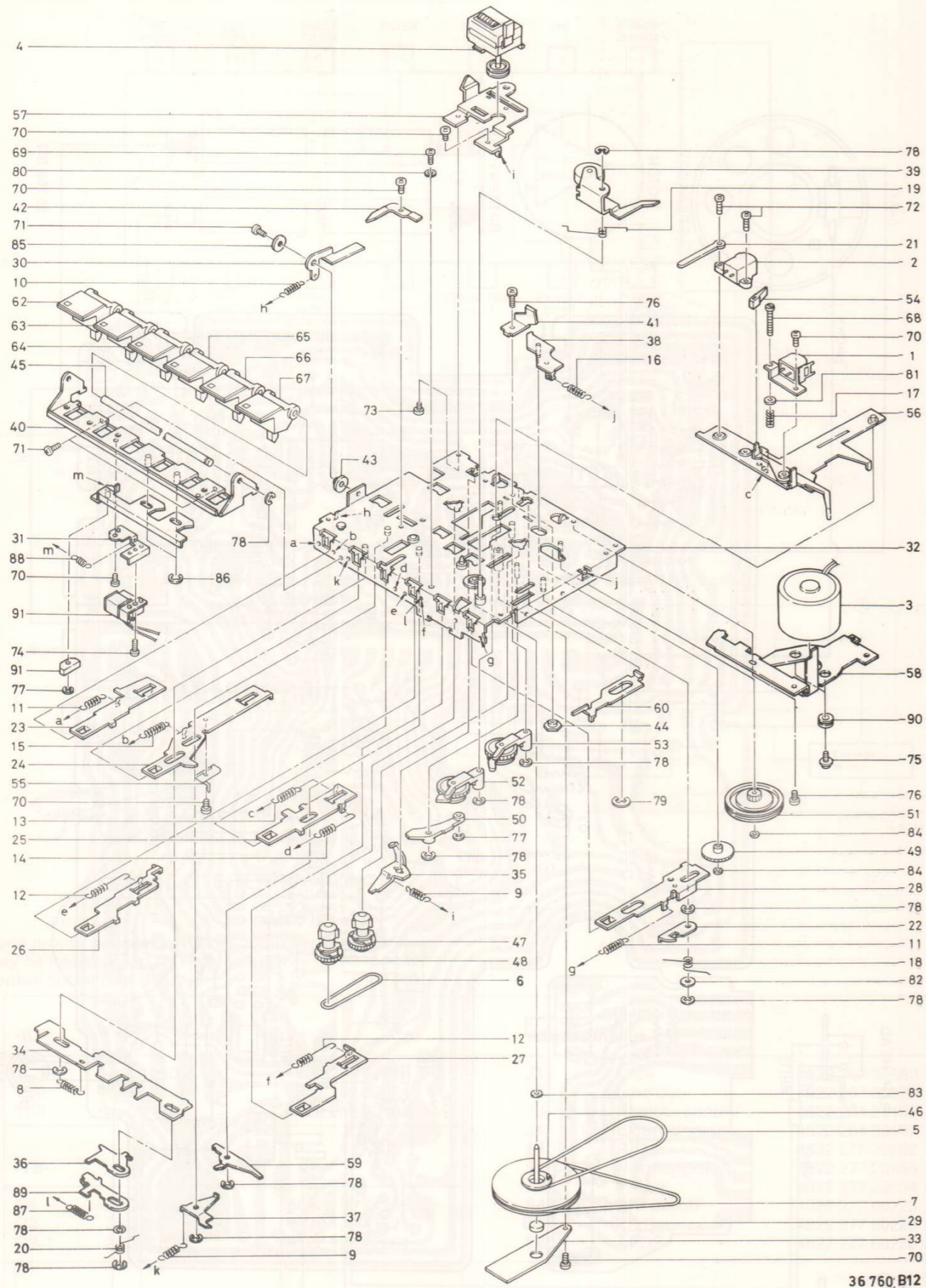
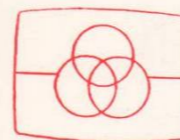

Fig. 1

36 760 B12

1	4822 249 10221	26	4822 403 51748
2	4822 249 40168	27	4822 403 51749
3	4822 361 20504	28	4822 403 52139
4	4822 349 50204	29	4822 532 51166
5	4822 358 20176	30	4822 403 51583
6	4822 358 30427	34	4822 459 80225
7	4822 358 30428	36	4822 403 10183
8	4822 492 32427	37	4822 403 52141
9	4822 492 31718	38	4822 403 51354
10	4822 492 31719	39	4822 403 51355
11	4822 492 31721	46	4822 528 81012
12	4822 492 32429	47	4822 528 20396
13	4822 492 32158	48	4822 528 20397
14	4822 492 32428	49	4822 522 10207
15	4822 492 31805	50	4822 403 52142
16	4822 492 31806	51	4822 528 20398
17	4822 492 51331	52	4822 403 40188
18	4822 492 31724	53	4822 403 40189
19	4822 492 31725	54	4822 403 40191
20	4822 492 41151	55	4822 492 63114
22	4822 460 20242	56	4822 403 52143
23	4822 403 51745	59	4822 403 52144
24	4822 403 51746	60	4822 403 52145
25	4822 403 51747	62	4822 410 23821
		63	4822 410 23822
		64	4822 410 23823
		65	4822 410 23824
		66	4822 410 23825
		67	4822 410 23826
		68	4822 502 30207
		75	4822 502 30224
		87	4822 492 32432
		88	4822 492 32431

Only those parts of which the Service Code numbers are stated are normal Service parts



Free service manuals
Gratis schema's
Digitized by

www.freesevicemanuals.info

Adjustment	Cassette	Recorder in position	Apply signal to	Measure on	Read on	Adjust with	Adjust to
Play back speed	3150 Hz of SBC420*	PLAY	—	J2	Wow- and flutter meter	VR2	
Azimuth R/P head	8 kHz of SBC420*	PLAY	—	J2	mV-meter	Screw 68 Fig. 1	Max. output

* SBC420: 4822 397 30071
** a The maximum permissible speed deviation is 3%. Moreover, the wow-and-flutter value can be read. This value should not exceed 0.35%.