

731

SERVICE MANUAL



PORTABLE RADIO

RP 8880UM

(EUROPE)

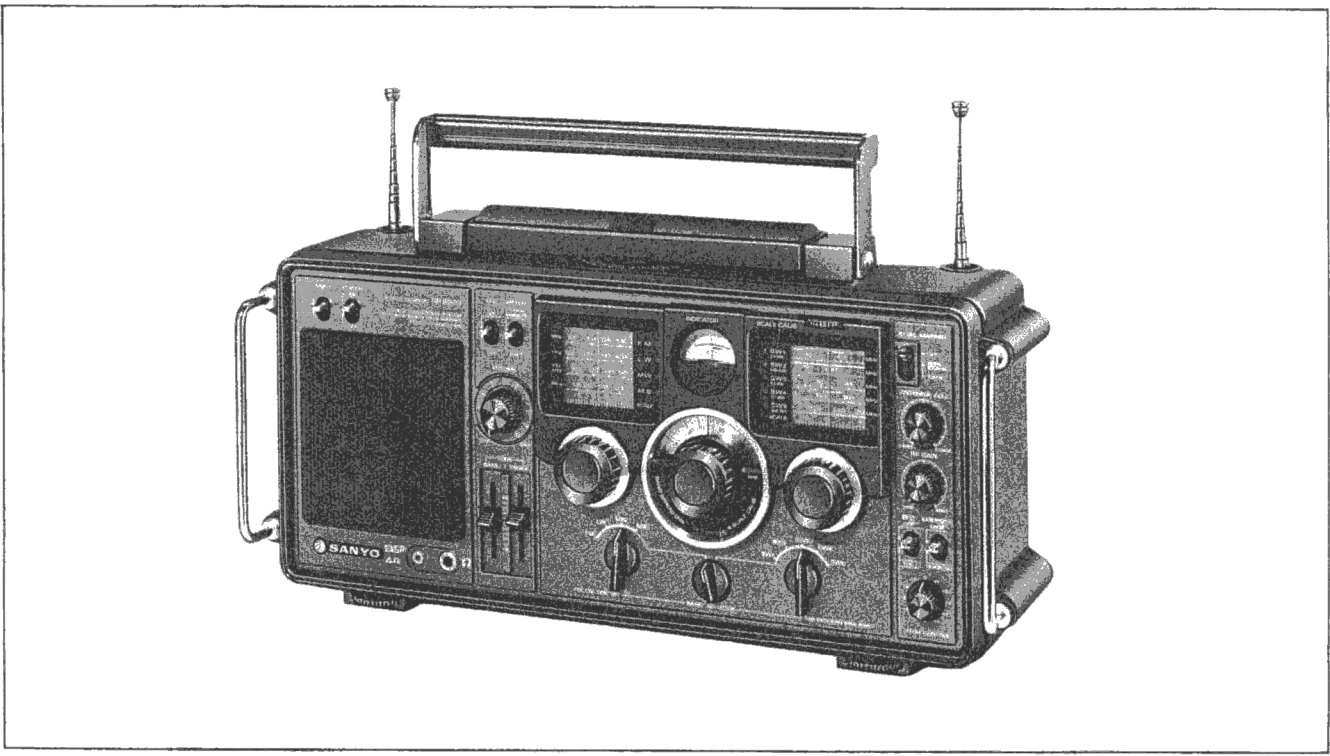

SPECIFICATIONS

Frequency ranges:	FM 87.5 - 108 MHz	Inyermediate	MW 460 kHz
	LW 150 - 405 kHz	frequency:	FM 10.7 MHz
	MW 510 - 1605 kHz	Output power:	
	MB 1.6 - 2.3 MHz	Maximum	4 W
	SW1 2.3 - 5.95 MHz	Undistorted	3 W
	SW2 5.95 - 6.2 MHz	Power source:	DC: "D" x 8Ω 12V
	SW3 6.2 - 10.0 MHz		AC: 120/200/220/240V
	SW4 11.7 - 20.0 MHz		50/60 Hz
	SW5 20.0 - 30.0 MHz	Current consumption:	
Sensitivity	FM 4 μV S/N=30dB	No signal	110 mA
for 50mW output:	LW 158 μV/m	Speaker:	120 mm, 4 Ω
	MW 31 μV/m	Dimensions:	475(W) x 243(H) x 147(D) mm
LW/MW/MB/SW1-5:	MB 48 μV/m S/N=6dB	Weight:	
	SW1 4.5 μV	without Batteries	4500 g
	SW2 3.1 μV		
	SW3 3.1 μV		
	SW4 3.1 μV		
	SW5 3.1 μV		

Note: Specifications are subject to change without notice.

731
WM-2937

CONTENTS

Specification	Cover	Functional flow chart (Tuner)	16
Disassembly of Cabinet and Chassis.	1	Wiring diagram (B.F.O).	17
Disassembly of P.C.B and Indicator.	2	Schematic diagram (Audio)	18
Assembly of Dial scale	3	Wiring diagram (Audio)	19
Dial cord stringing	4	Exploded View (Cabnet).	22
Maunting P.C.B and Dial Scale	8	Exploded View (Chassis).	23
Alignment	9	Exploded View (Miscellaneous)	25
Schematic diagram (Tuner)	14	Parts List	20 ~ 27
Wiring diagram (Tuner).	15		

DISASSEMBLY OF CABINET AND CHASSIS

Cover the work bench with cushion pad for protecting the unit being serviced, be sure to unplug the power cord and take out the batteries before proceeding to the steps described below.

1. Place the unit on the work bench, front side down. Remove the six screws fastening the back lid.
2. Remove the knobs and dial (2-tuning control, BAND SPREAD dial BAND SELECTOR and 2-selection knobs, ANTENNA ADJ., RF GAIN, PITCH CONTROL, VOLUME, and 2-TONE control knobs.) without snap switches (X-TAL MARKER, BAND WIDTH, BFO, METER TUNING, AFC, POWER, LIGHT)

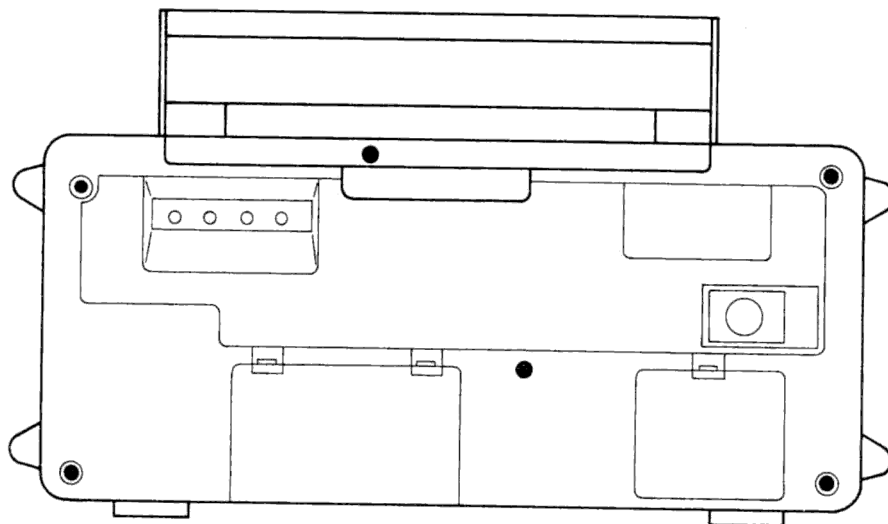

3. Detach the back lid from the cabinet after disconnecting it from the socket on the circuit board.
4. Remove the six screws (red marked tapping ones) fastening the chassis.
5. Pull the chassis to the fore and lift it out of the cabinet.

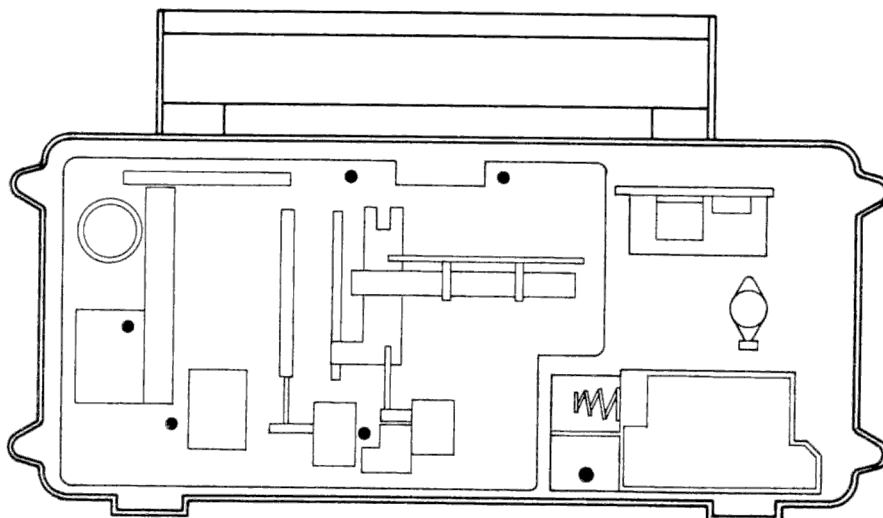

DISASSEMBLY OF P.C.B. AND INDICATOR

1. All P.C.B. mounting is latch set system:
2. Disconnect jumper lead connectors if necessary.
3. Cramp the drums to chassis with screws.
4. Disassemble the 201 P.C.B. Assembly and dial indicator bracket. (9, 10)

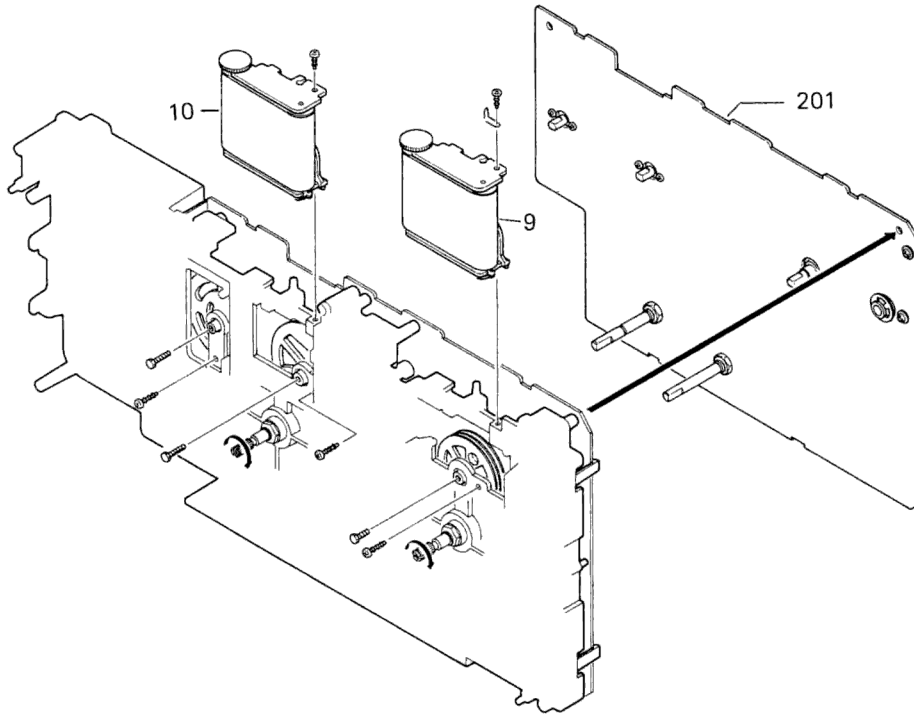

5. Disassemble the P.C.B. Assembly, 203, P.C.B. Assembly, 206 and P.C.B. Assembly 208.

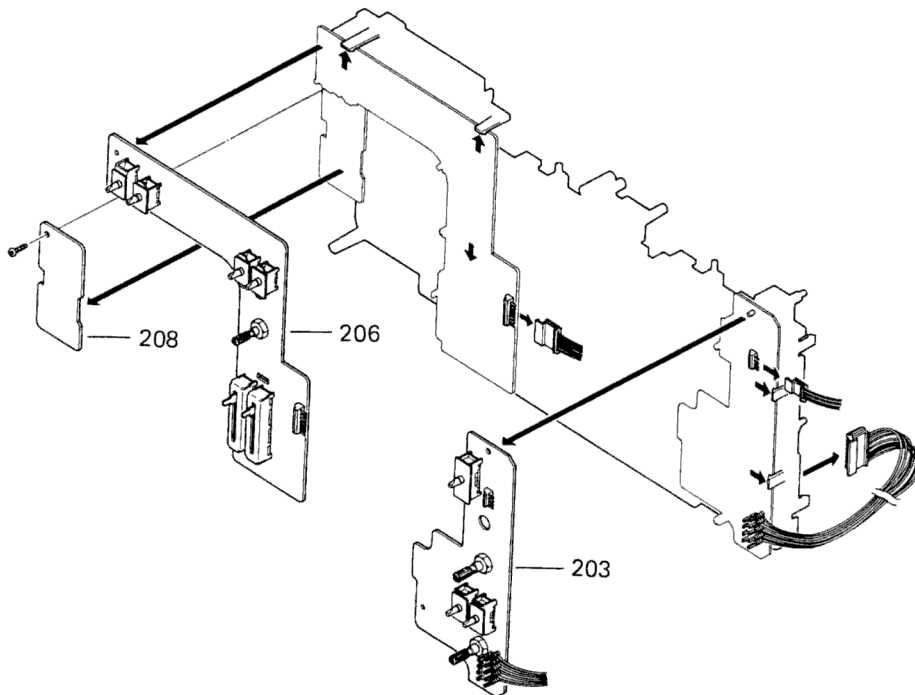

DISASSEMBLY OF P.C.B.

6. Disassemble the 207 P.C.B. Assembly.

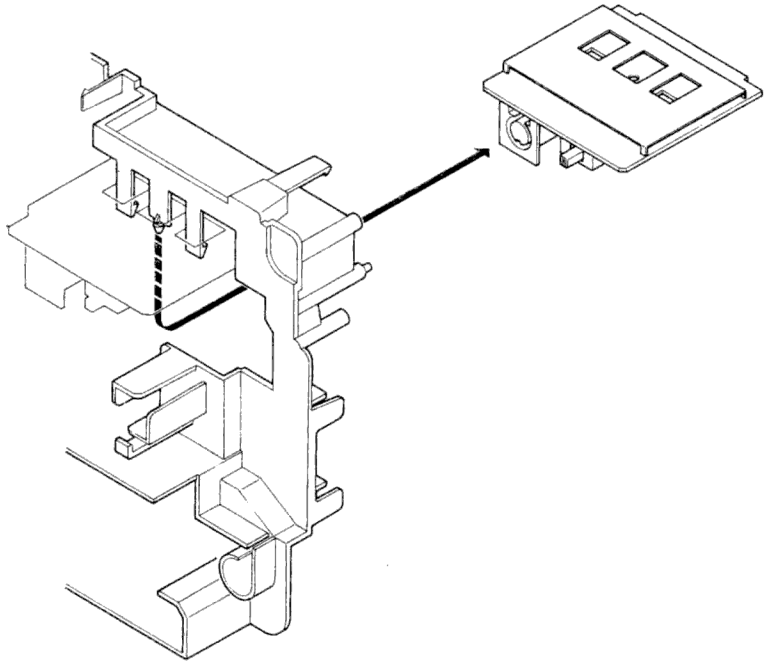

ASSEMBLY OF DIAL SCALE

1. Put the spring 6 and the gear (5) into the drum (4).
2. Mount the drum to bracket (1) and spring plate (8).
3. Fix the shaft (3) after turning the gears (5) about 6 clockwise turns.
4. Turn the gear another 3-½ turns with a screwdriver.

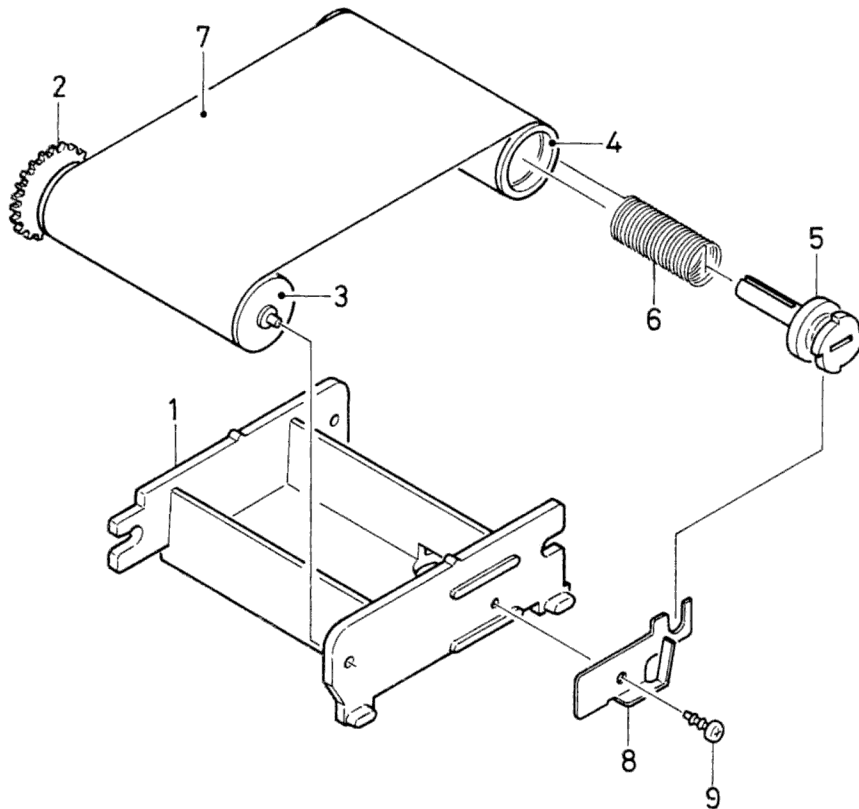

DIAL CORD STRINGING

1. Prepare dial cords and tension springs as shown below.

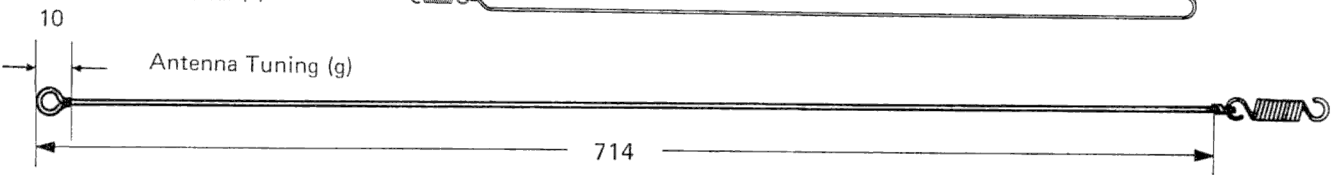
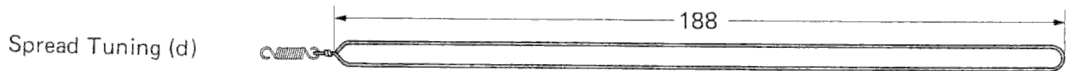

2. SW Dial (Cord e)

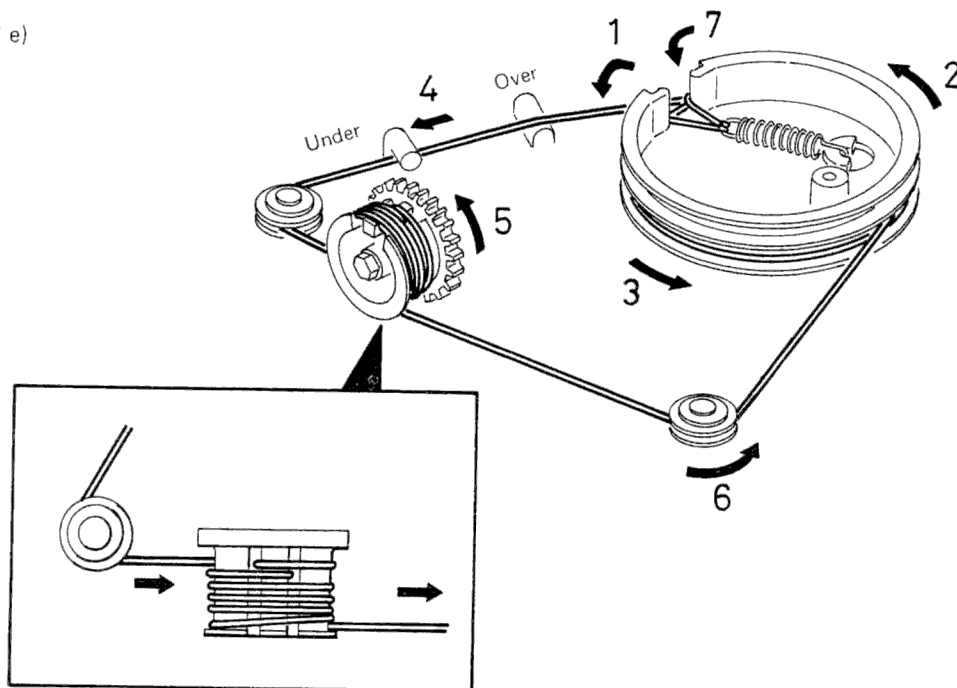

DIAL CORD STRINGING

3. SW Tuning (Cord b)

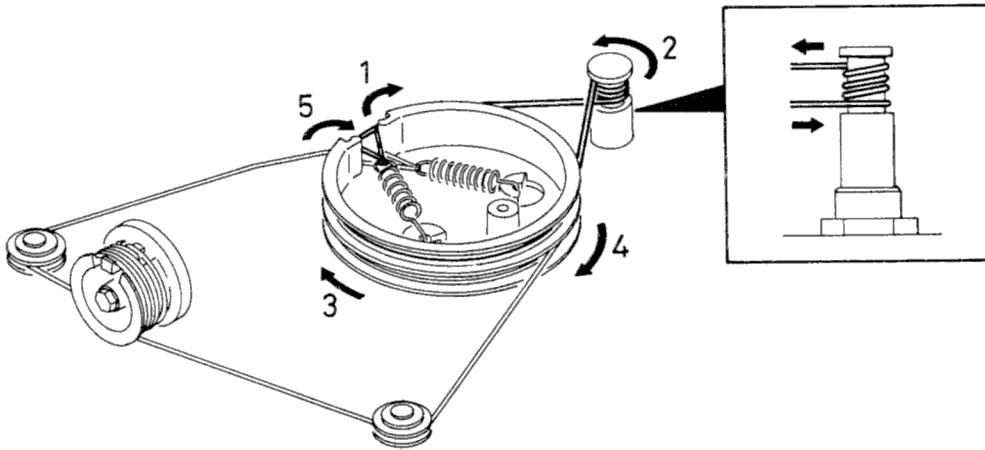

4. AM Dial (Cord f)

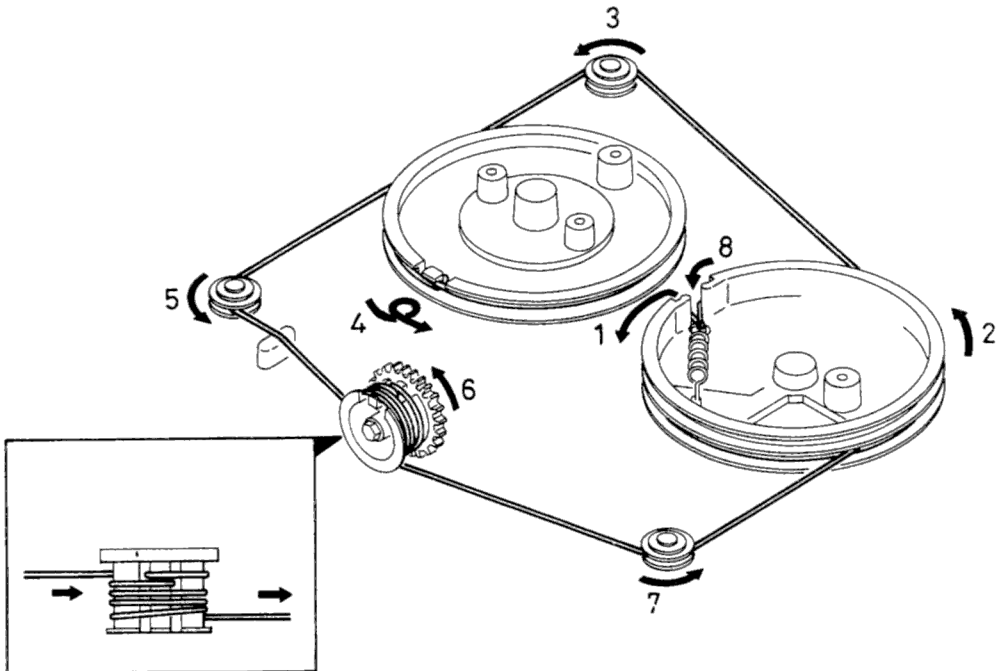

5. AM Tuning (Cord a)

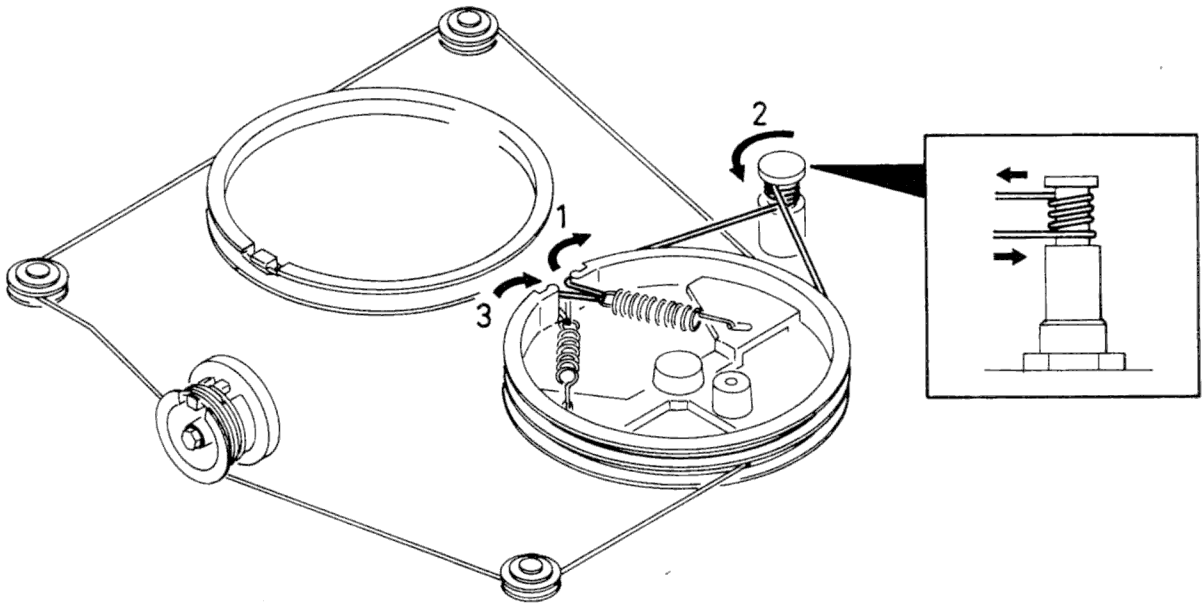

6. Spread Dial (Cord c)

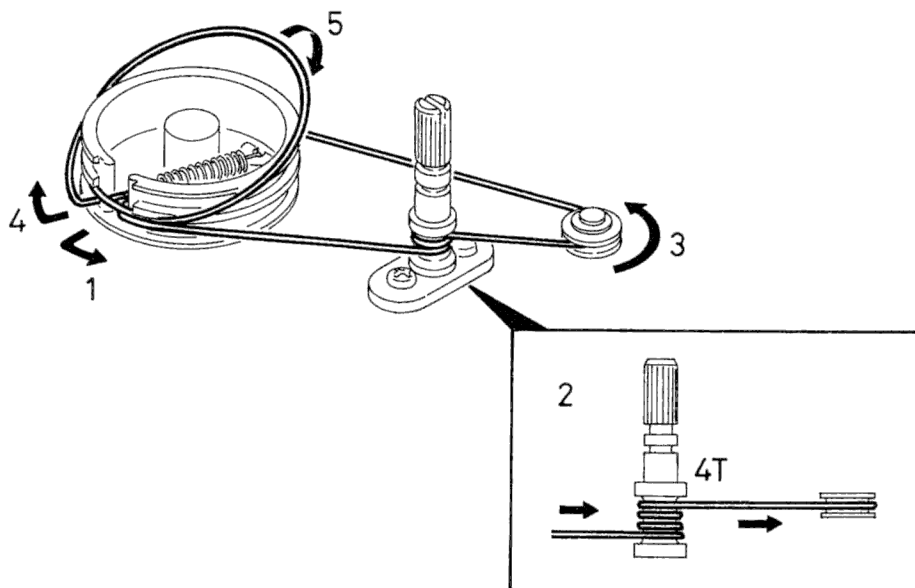

DIAL CORD STRINGING

7. Spread Tuning (Cord d)

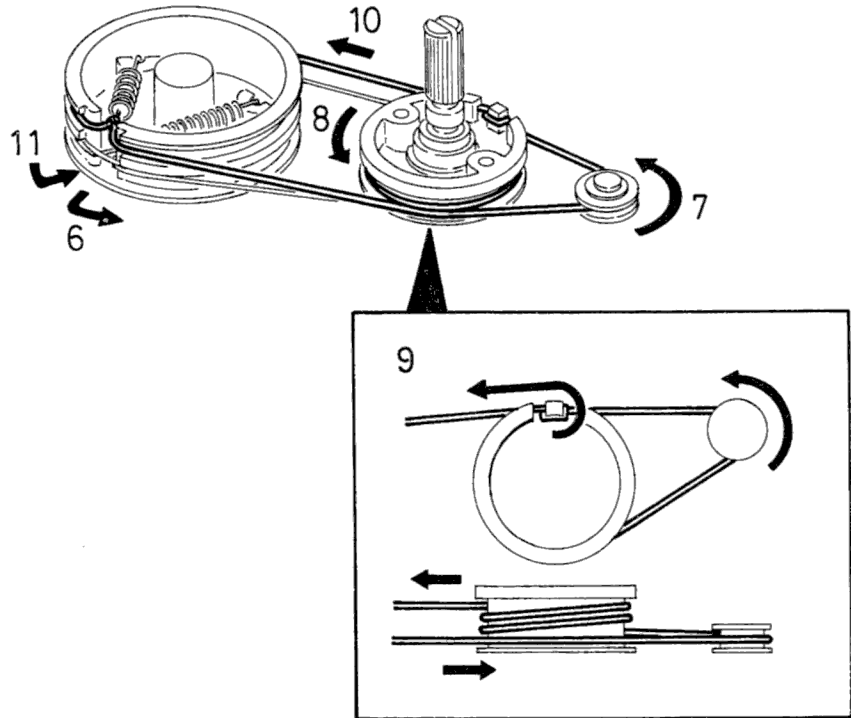

8. Antenna Adj. (Cord g)

1. Through dial cord to the core.
2. Set the adjusting screw on the drum to near center position.
3. Hook the rope end to the drum and thread the cord as shown by starting from No. 1 through No. 6.
4. Fasten the core at left side of antenna bobbin with a stuffing toothpic.
5. Settle the more fidily with a adjusting screw.

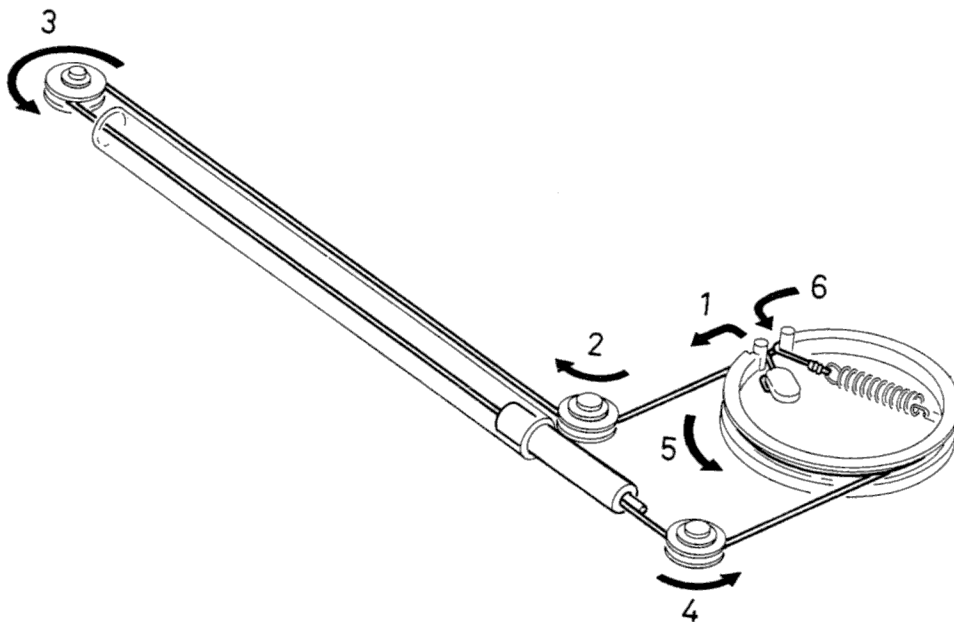

3. FM S CURVE

Input TP. 1 H TP. 2 G
 Output TP. 8 H TP. 6 G
 Adj. T. 303

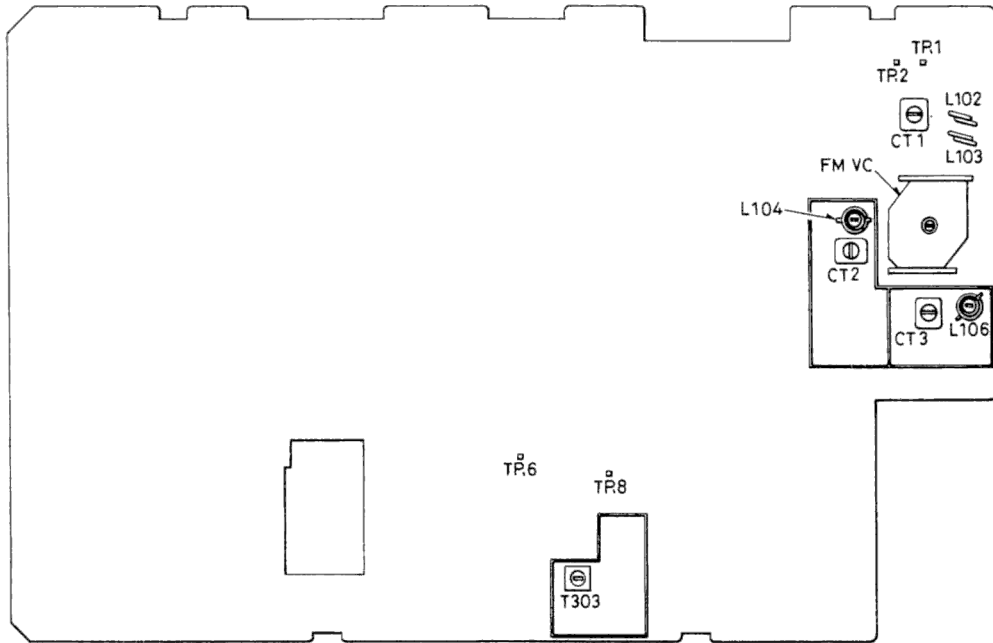
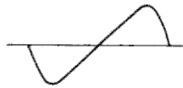

4. B.F.O. AND X-TAL MARKER

Input TP. 4 H TP. 6 G
 Output TP. 9 H TP. 10 G
 Adj. 1st. L. 301 "O" Beat
 2nd T. 306 Maximum (Near 1 kHz)
 3rd B.F.O. Switch Off
 4th X-TAL Switch On (1M/100K)
 5th SVR R. 356 "O" Beat

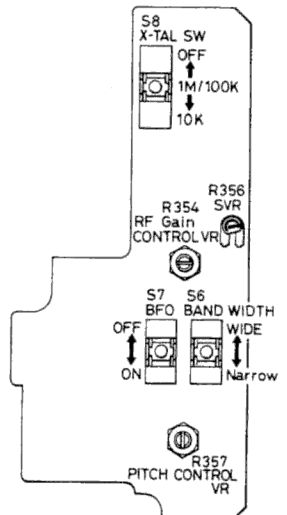
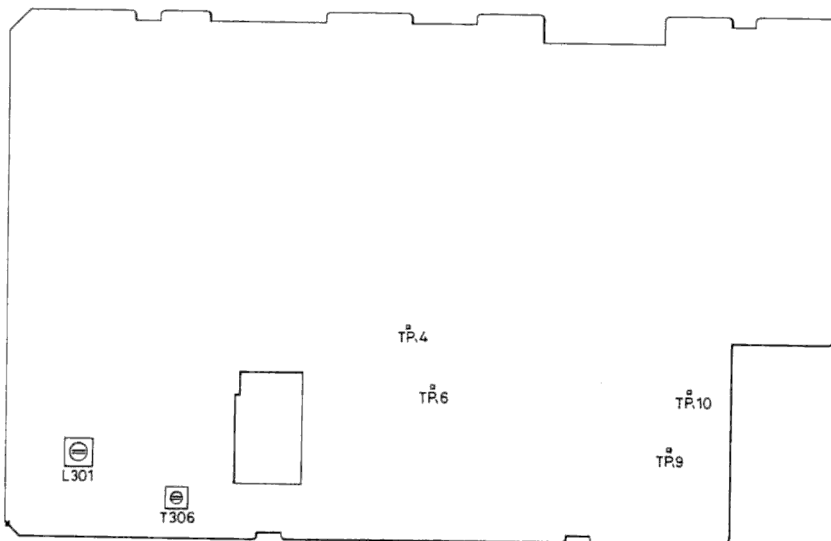

ALIGNMENT

5. SW #2 LOCAL COVER

Connect VC (Max 15.28pF) for TP5, TP6.

Input	TP.4 H	IF shield
Output	TP.9 H	TP.10 G
Antena	18PF Pad	
Cover	Low 10.67 MHz	L, 120
	High 10.83 MHz	CT. 19

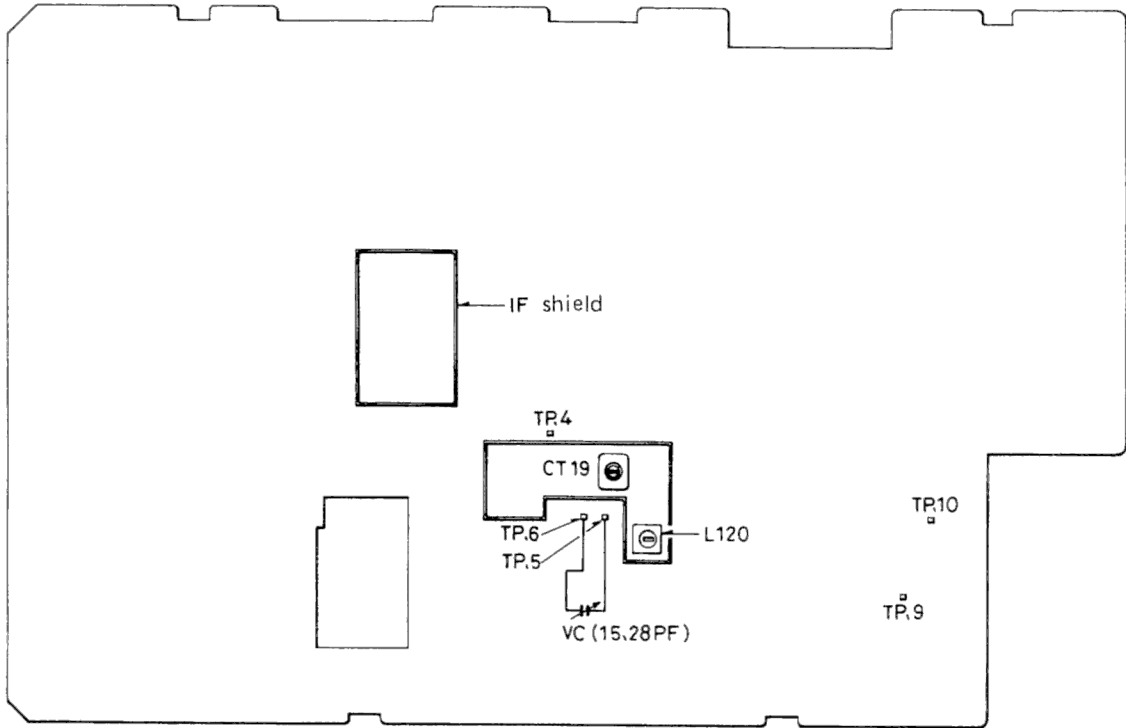

6. MW, LW COVER AND TRACKING

		LW	MW
	Low [MHz]	0.150	0.510
	High [MHz]	0.405	1.605
Cover	L	E [MHz]	0.145 0.505
		L NO	L121 L122
	H	F [MHz]	0.415 1.670
		CT NO	CT8-1 CT8-2
Tracking	L	F [MHz]	0.160 0.600
		L NO	L107a L109 L110
	H	F [MHz]	0.370 1.400
		CT NO	CT4-1 CT-6 CT4-1 CT7-1
TP	Input	L107	L107
	Output	TP9 H TP10 G	TP9 H TP10 G
Antenna		roop	roop

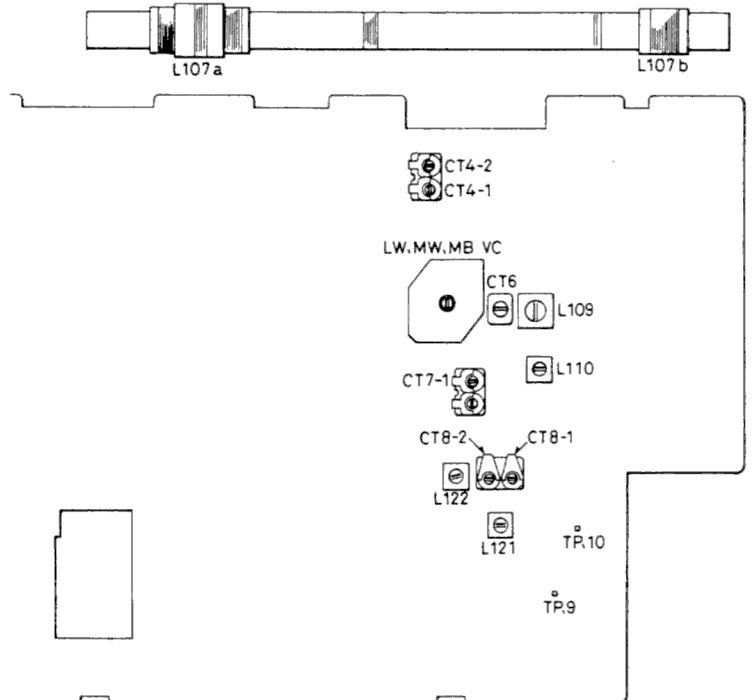

ALIGNMENT

7. MB COVER AND TRACKING

Input L.108 (Low 1.6MHz High 2.3MHz)
 Output TP.9 H TP.10 G
 Antena Loop
 Cover Low 1.55 L, 124
 High 2.38 CT, 9
 Tracking Low 1.6 L. 108, L, 111
 High 2.3 CT, 5, CT7-2

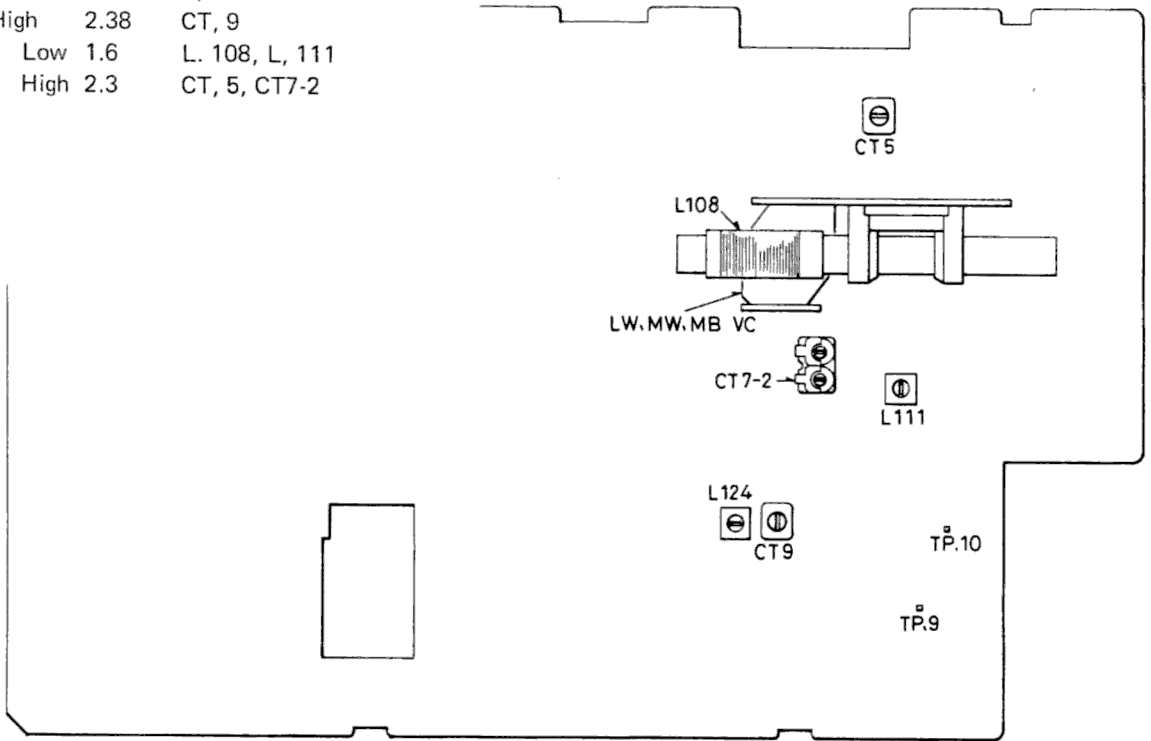

8. FM COVER AND TRACKING

Input TP.1 H TP.2 G (Low 87.5MHz High 108.0MHz)
 Output TP.8 H shield G
 Antena 75 ohm
 Cover Low 87.0MHz L106
 High 109.0MHz CT, 3
 Tracking Low 90 L102, 103, 104
 High 106 CT, 1 CT, 2

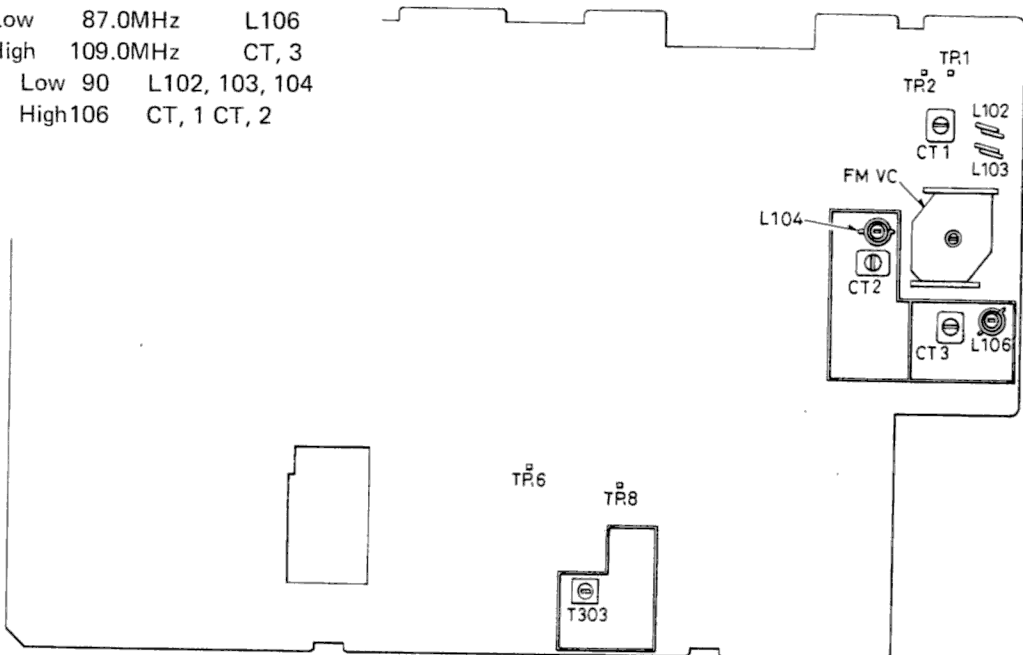

9. SW COVER AND TRACKING

Inspect to before alignment BAND SPREAD DIAL "0" and CALIB to center

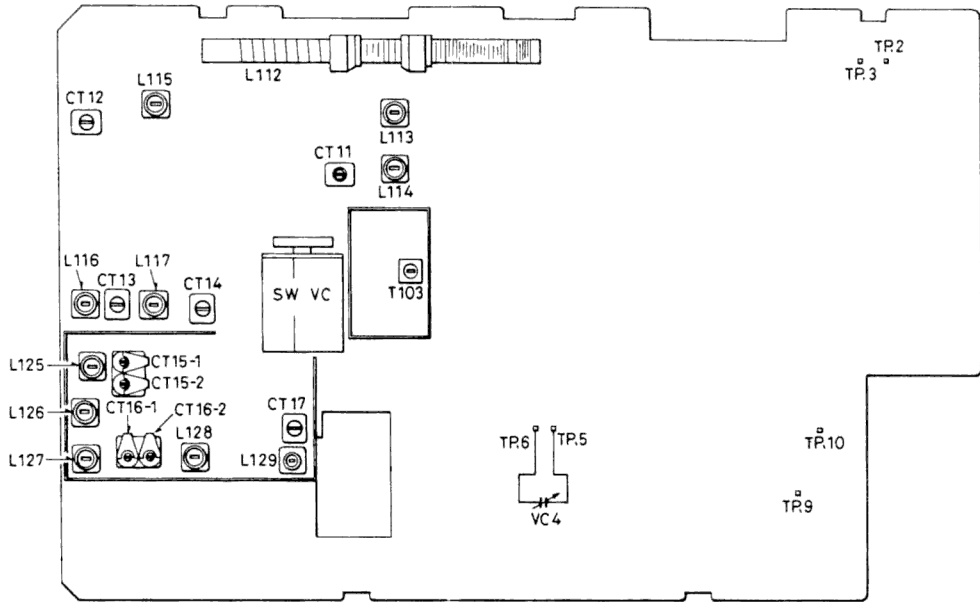

	Low [MHz]	High [MHz]	L		H	
			F [MHz]	L NO	F [MHz]	CT NO
SW1	2.3	5.95	2.2	L125	6.3	CT15-1
SW2	5.9	6.2	5.9	L126	6.25	CT15-2
SW3	6.2	10.0	5.9	L127	10.4	CT16-1
SW4	11.7	20.0	11.3	L128	20.5	CT16-2
SW5	20.0	30.0	19.5	L129	30.5	CT-17

	L		H		INPUT	OUTPUT	ANTENNA
	F [MHz]	L NO	F [MHz]	CT NO			
SW1	2.5	L113	5.5		TP.3 H	TP.9 H	18PF
					TP.2 G	TP.10 G	
SW2	6.95	L114	6.2	CT-11	TP.3 H	TP.9 H	18PF
					TP.2 G	TP.10 G	
SW3	6.5	L115	9.5	CT-12	TP.3 H	TP.9 H	18PF
					TP.2 G	TP.10 G	
SW4	12.5	L116	18.5	CT-13	TP.3 H	TP.9 H	18PF
					TP.2 G	TP.10 G	
SW5	21.0	L117	27.0	CT-14	TP.3 H	TP.9 H	18PF
					TP.2 G	TP.10 G	

10. AM, FM METER

AM Input TP.1 H TP.2 G (100db) R.327 measure "9"

FM Input TP.1 H TP.2 G (100db) R.328 measure "9"

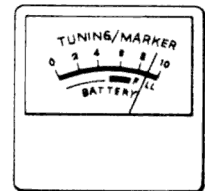
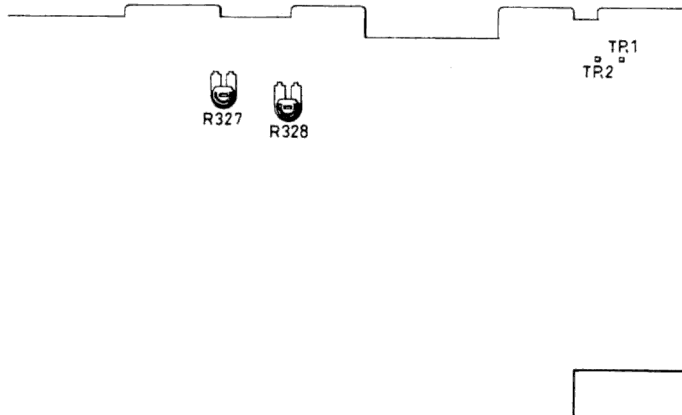

SCHEMATIC DIAGRAM (TUNER)

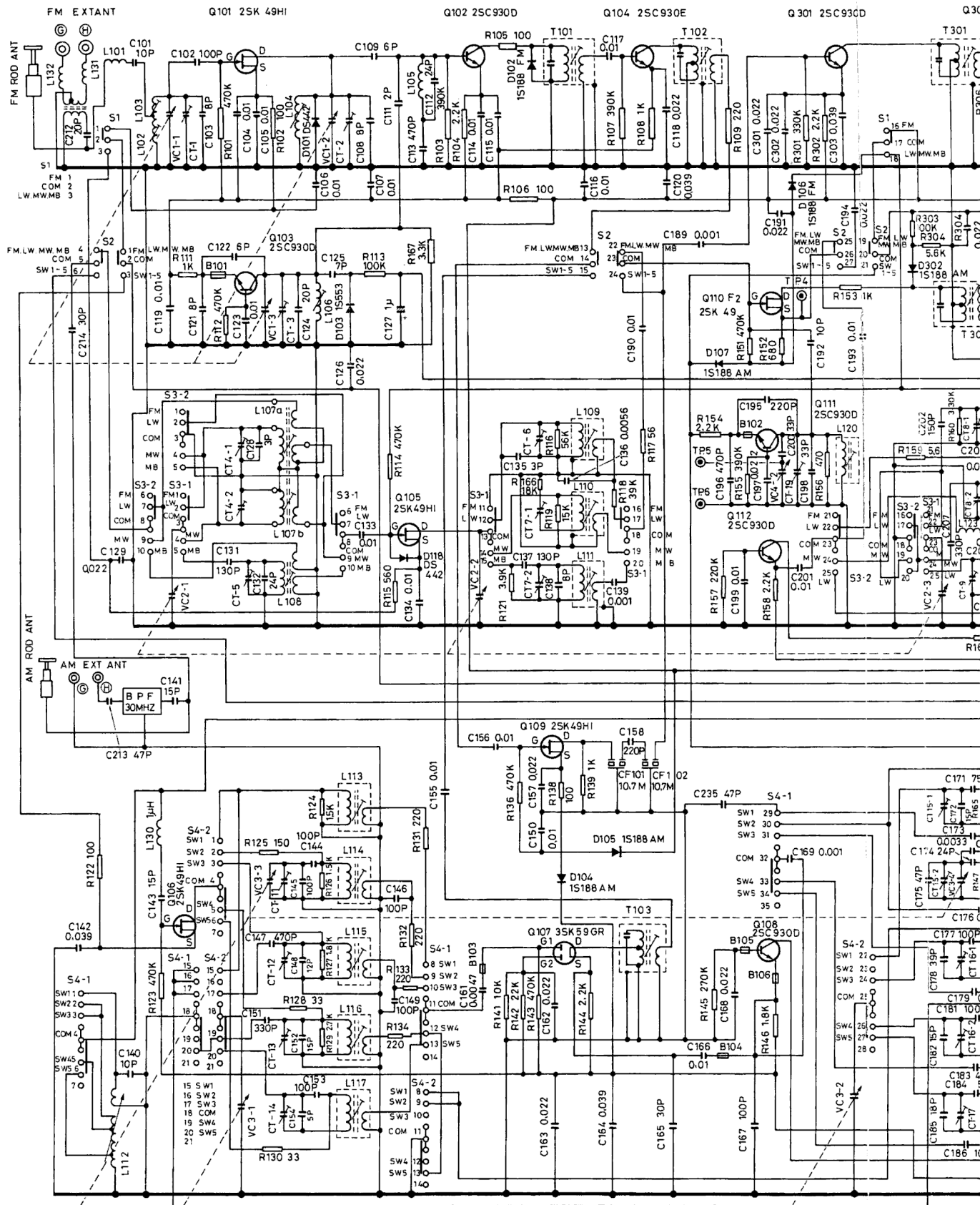

- S1..... BAND SWITCH (FM/LW, MW, MB)
- S2..... BAND SWITCH (SW1-5 / FM, LW, MW, MB)
- S3..... BAND SWITCH (FM/LW/MW/MB)
- S4..... BAND SWITCH (SW1/SW2/SW3/SW4/SW5)
- S6..... AM BAND WIDTH SWITCH
- S7..... BFO SWITCH (BFO)
- S8..... X-TAL MARKER SWITCH

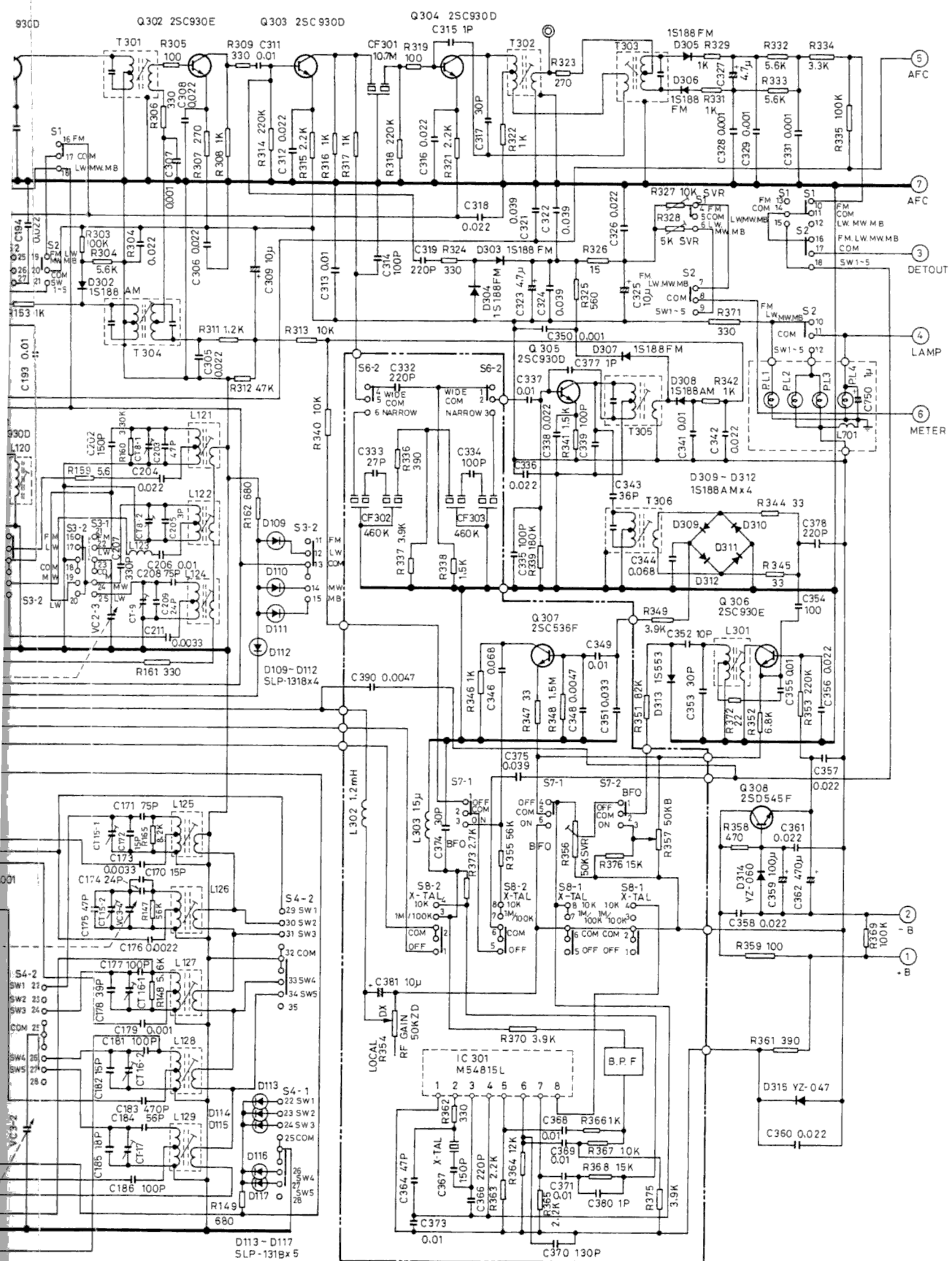

S6.....AM BAND WIDTH SWITCH (Narrow/Wide)
 S7.....BFO SWITCH (BFO ON/OFF)
 S8.....X-TAL MARKER SWITCH (X-TAL MARKER IM 100K/10K/OFF)

ALIGNMENT

1. AM IF (455 kHz)

Input TP. 4 H TP. 6 G
Output TP. 9 H TP. 10 G
Ceramic Filter Center
Adj. T. 304, T-305.

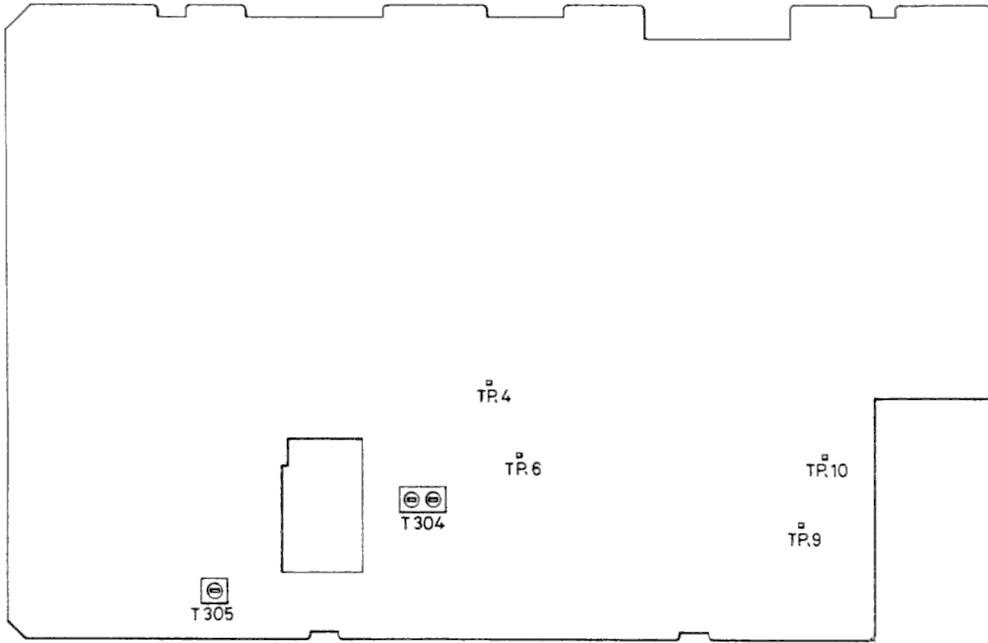
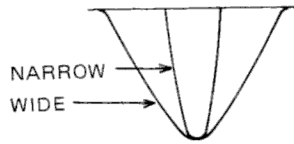

2. FM IF (10.7 MHz)

Input TP. 1 H TP. 2 G
Output TP. 7 H TP. 6 G
Adj. T.101, 102, 301, 302
Ceramic Filter Center

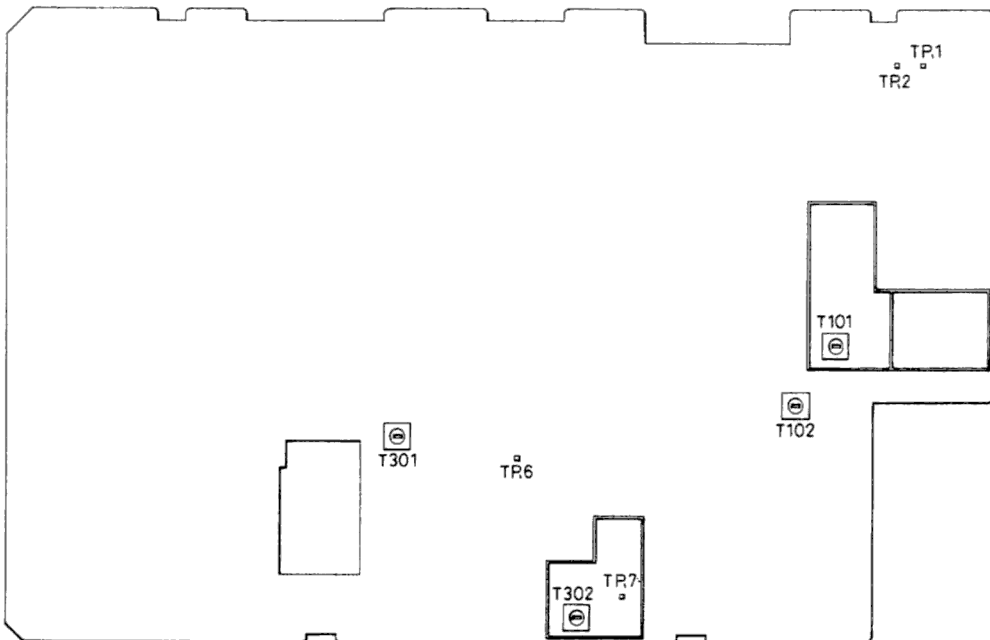
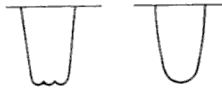

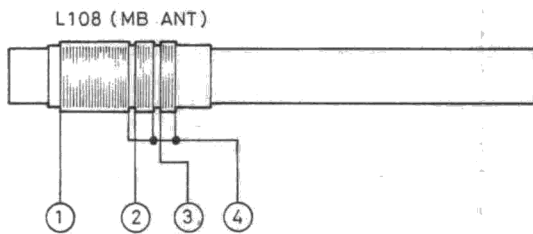
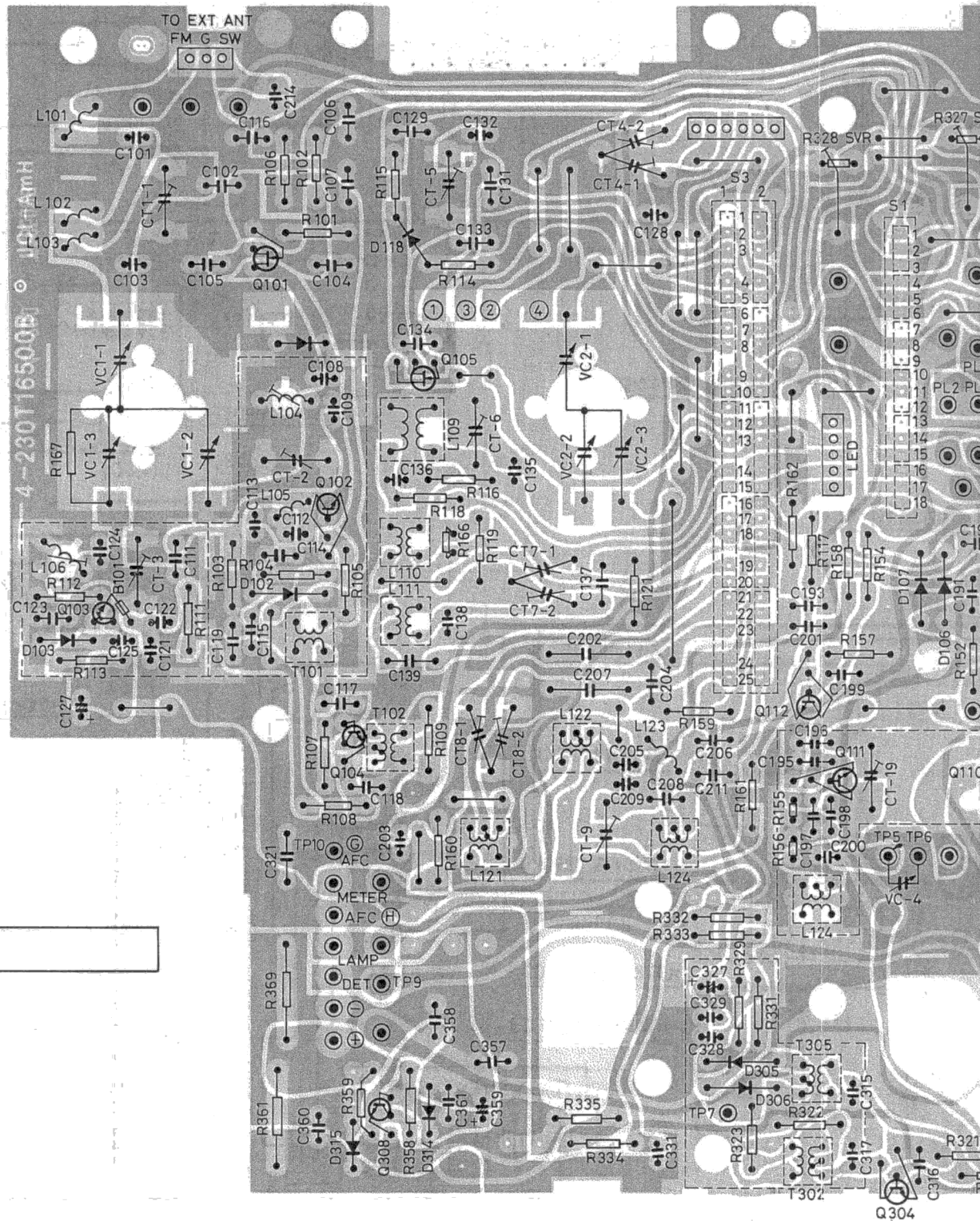

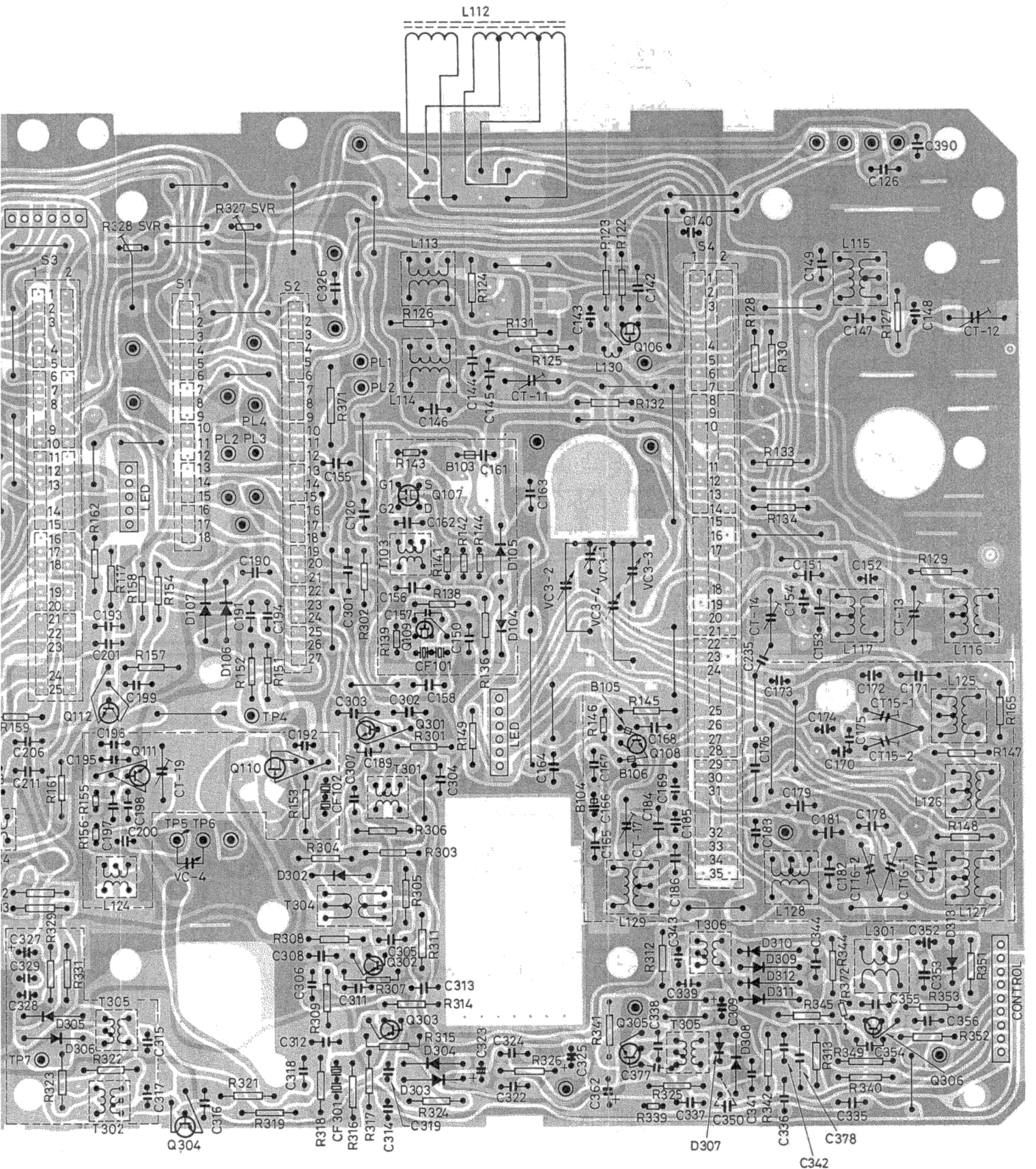

FUNCTIONAL FLOW CHART (TUNER)

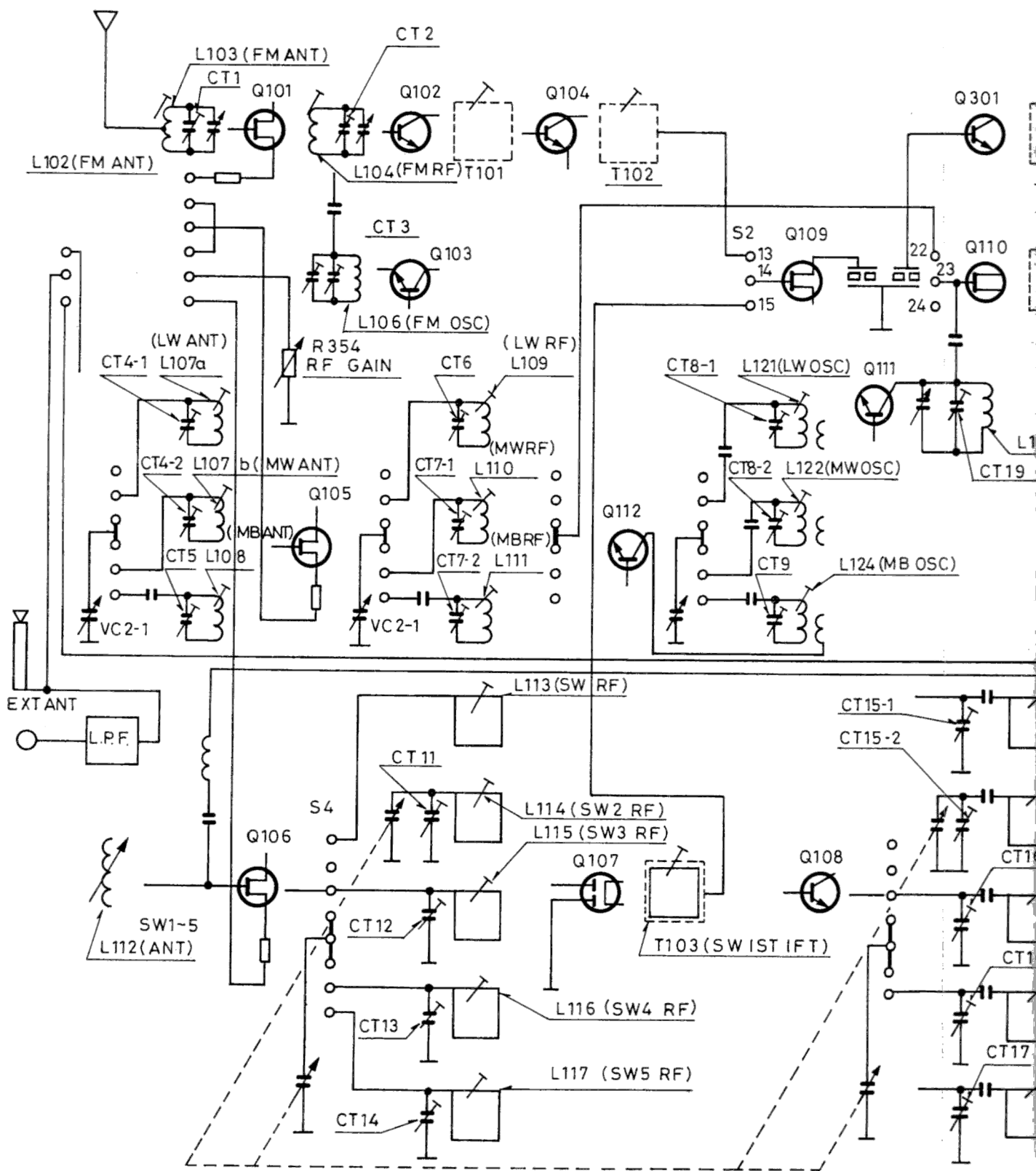

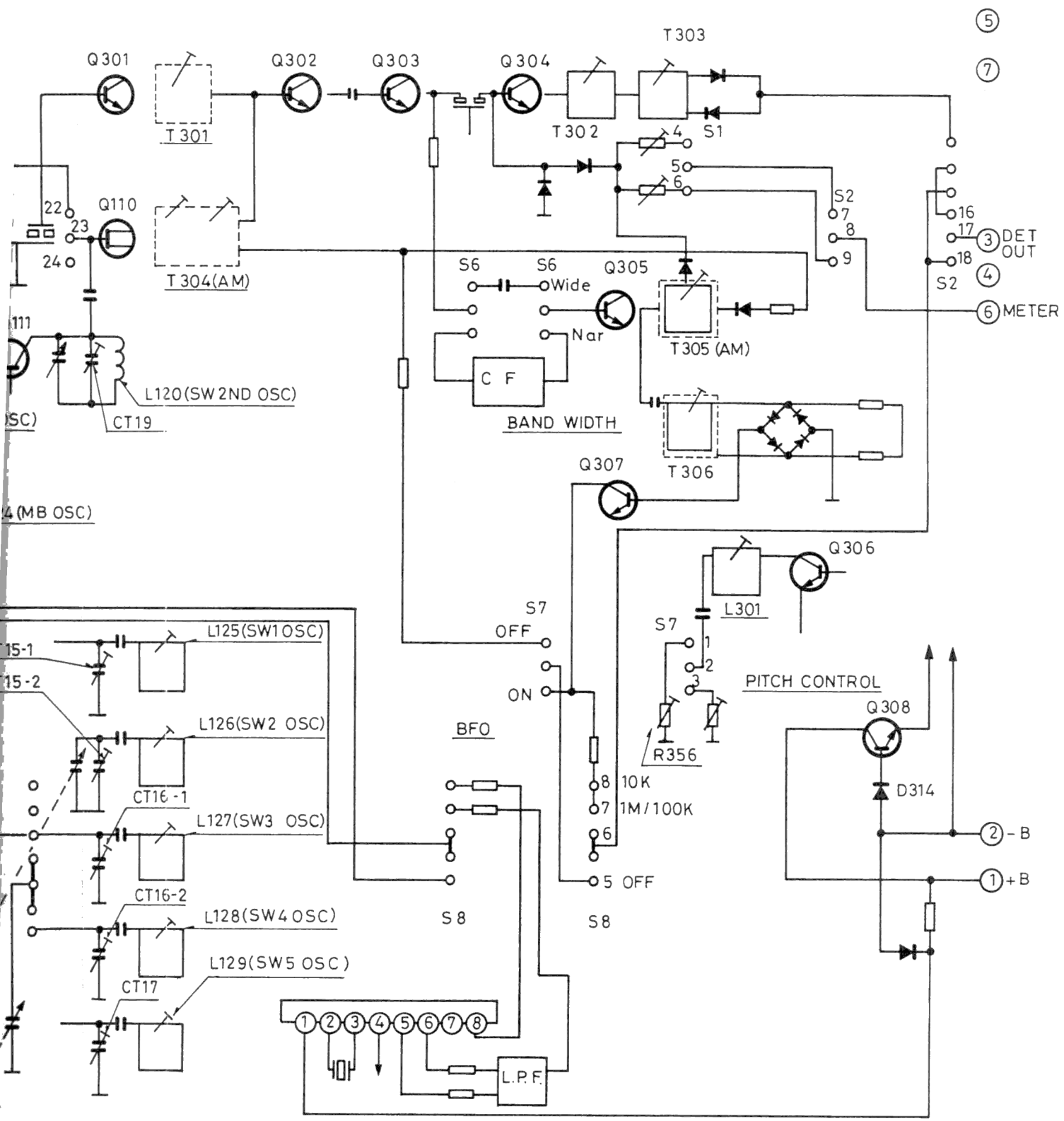

WIRING DIAGRAM (B.F.O.)

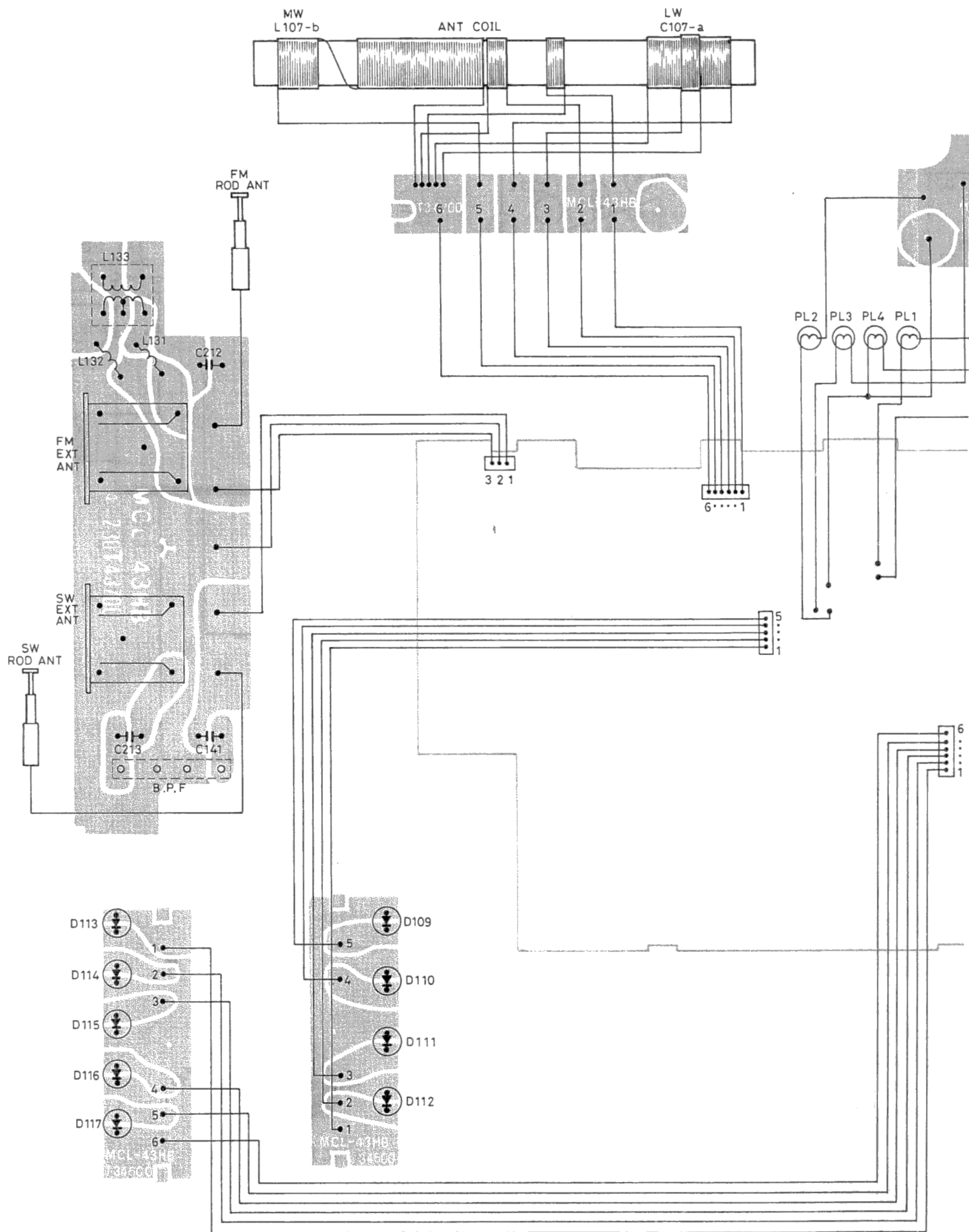

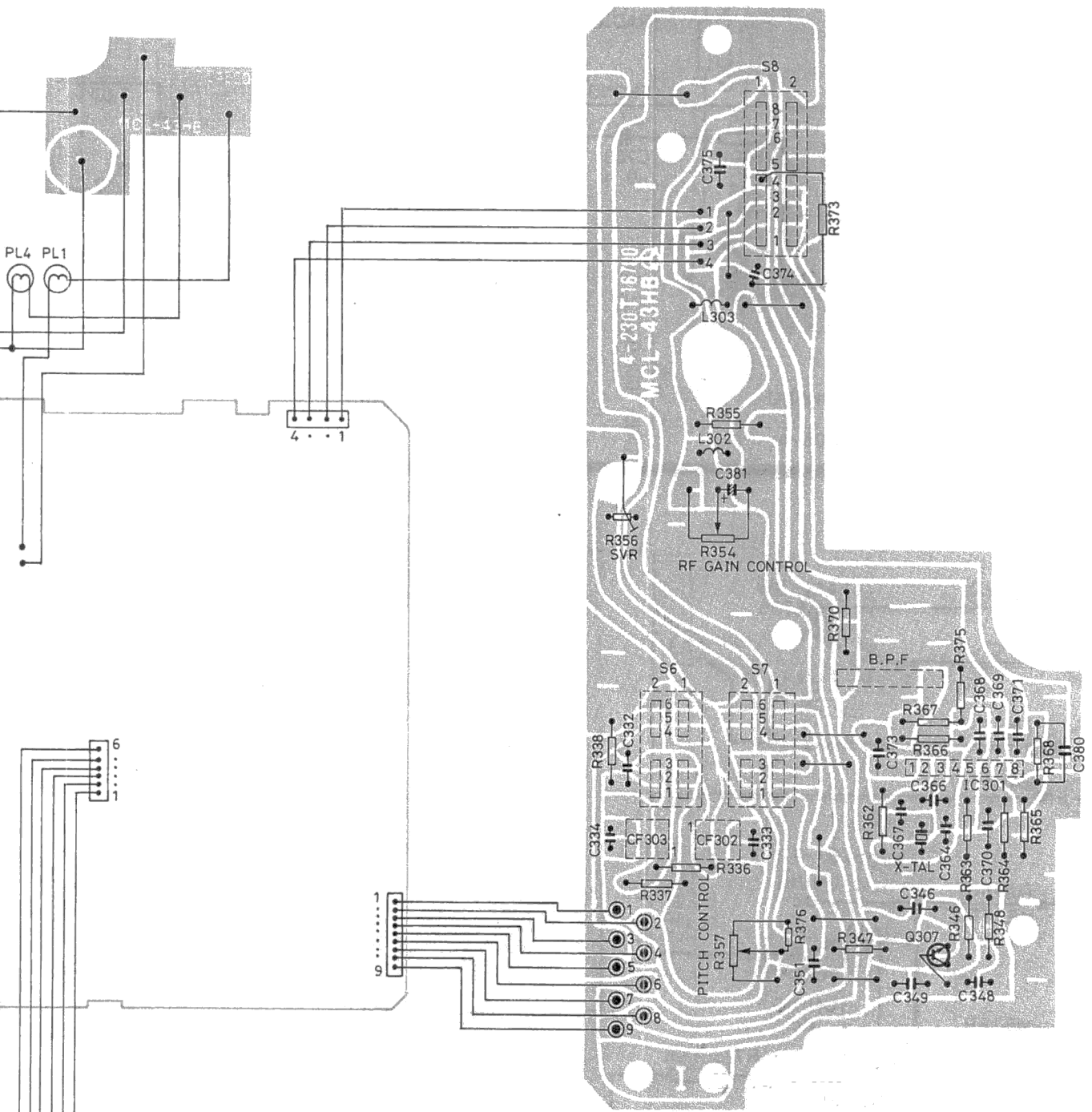

SCHEMATIC DIAGRAM (AUDIO)

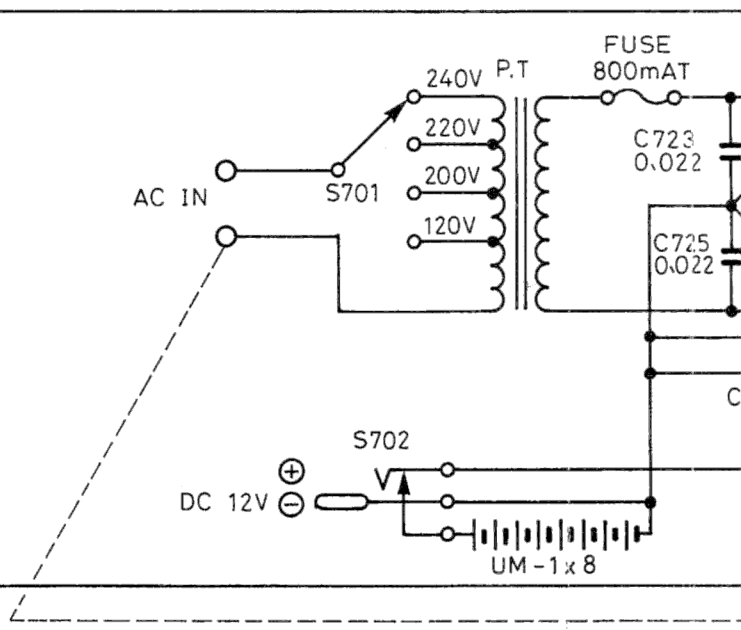
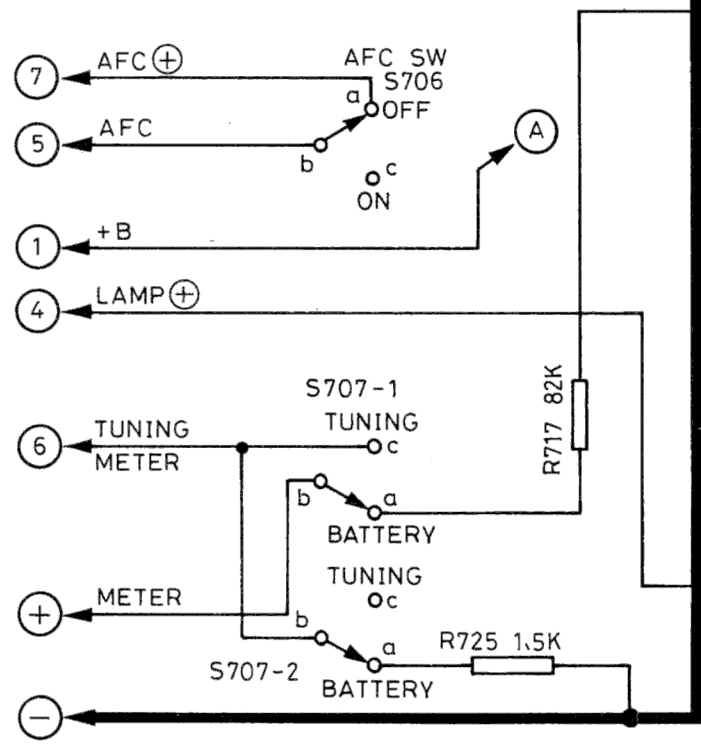
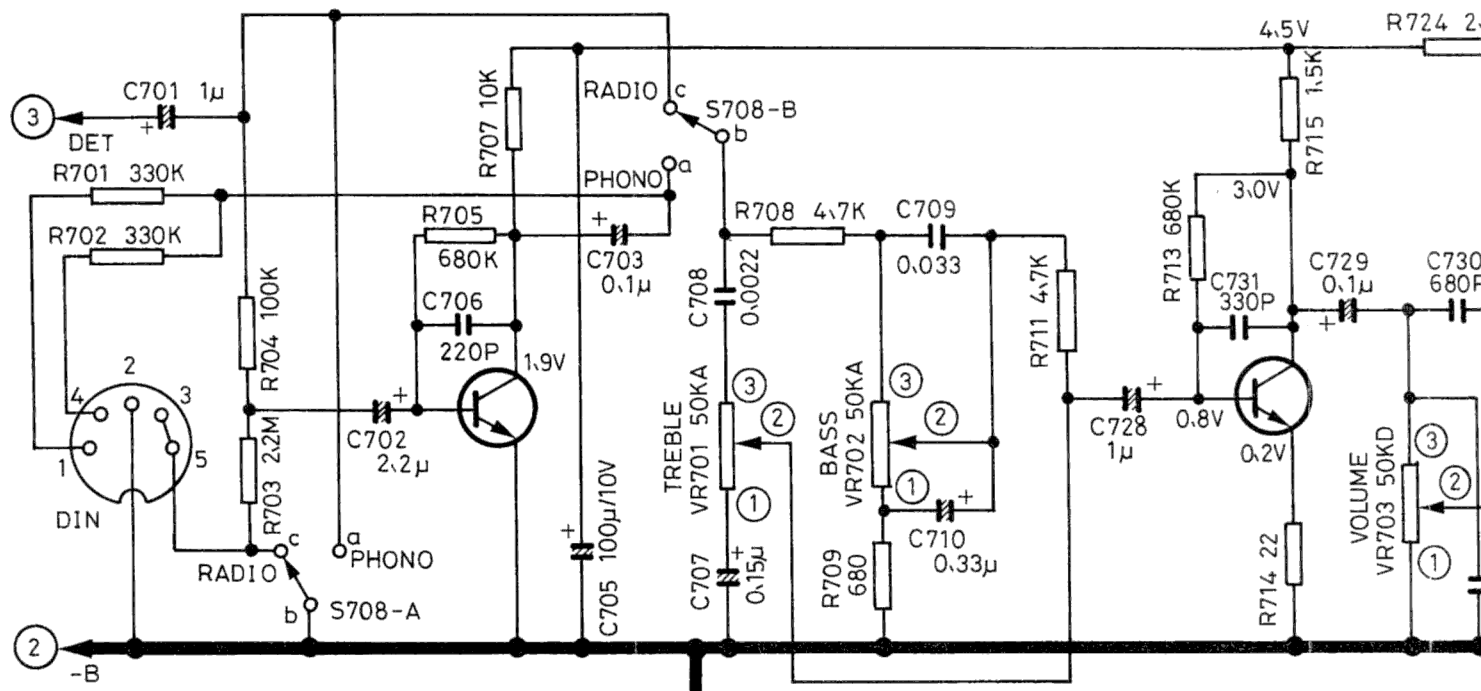

- S701.....AC CHANGING SW
- S702.....EXT SOURCE SWITCH
- S703.....AC/DC CHANGING SW
- S704.....POWER SWITCH
- S705.....PILOT LAMP SWITCH
- S706.....AFC ON/OFF SWITCH
- S707-1~2.....BATTERY / TUNING SW
- S708.....PHONO / RADIO SW

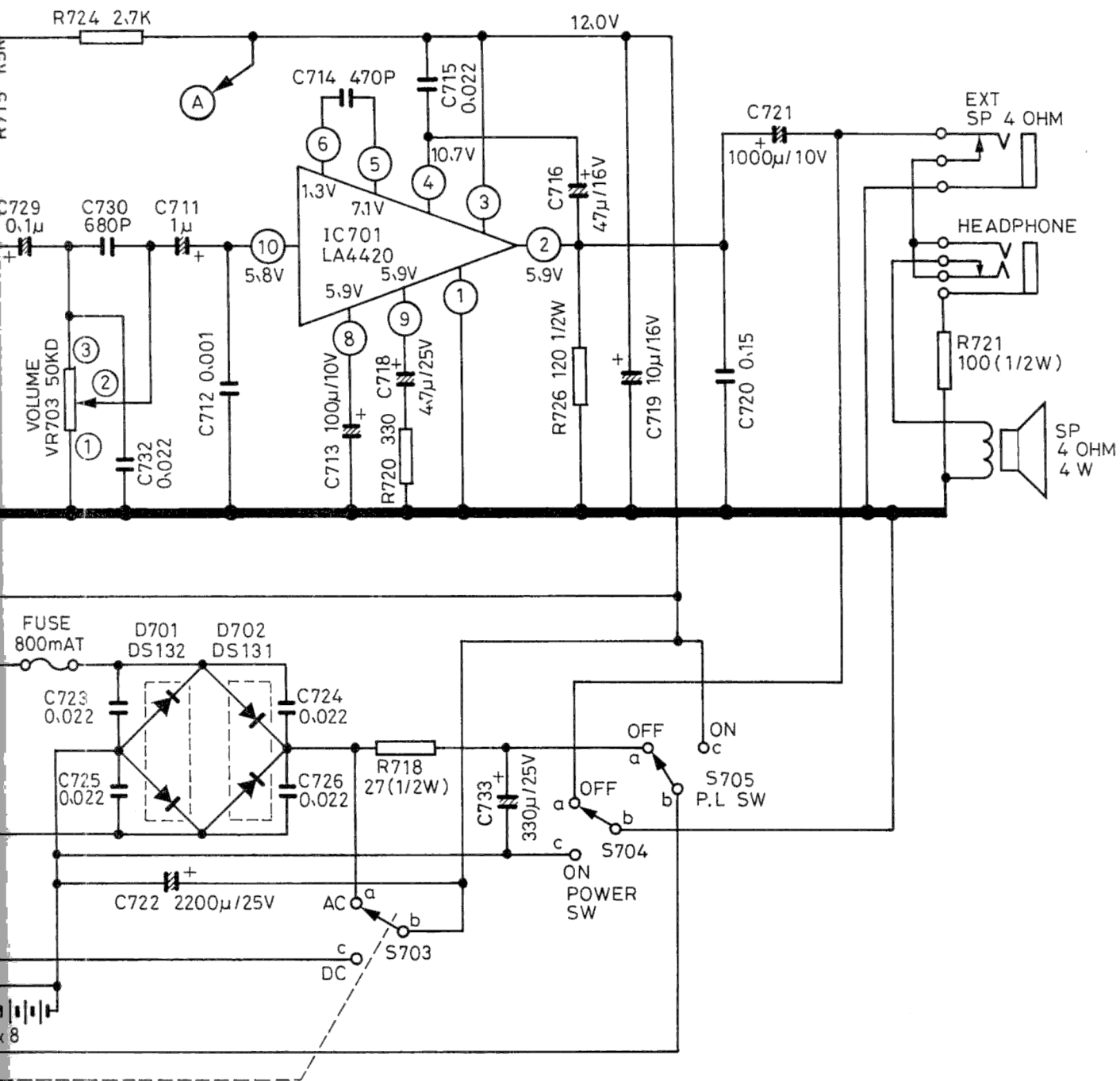

HANGING SWITCH
 SOURCE SWITCH
 C CHANGING SWITCH
 ER SWITCH
 T LAMP SWITCH
 ON/OFF SWITCH
 ERY/TUNING SWITCH
 O/RADIO SWITCH



2SC536G

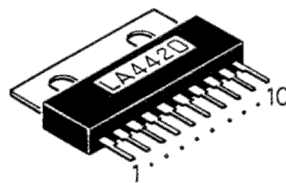

IC701 LA4420

WIRING DIAGRAM (AUDIO)

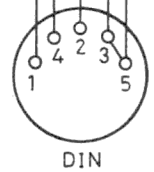
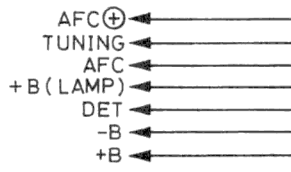
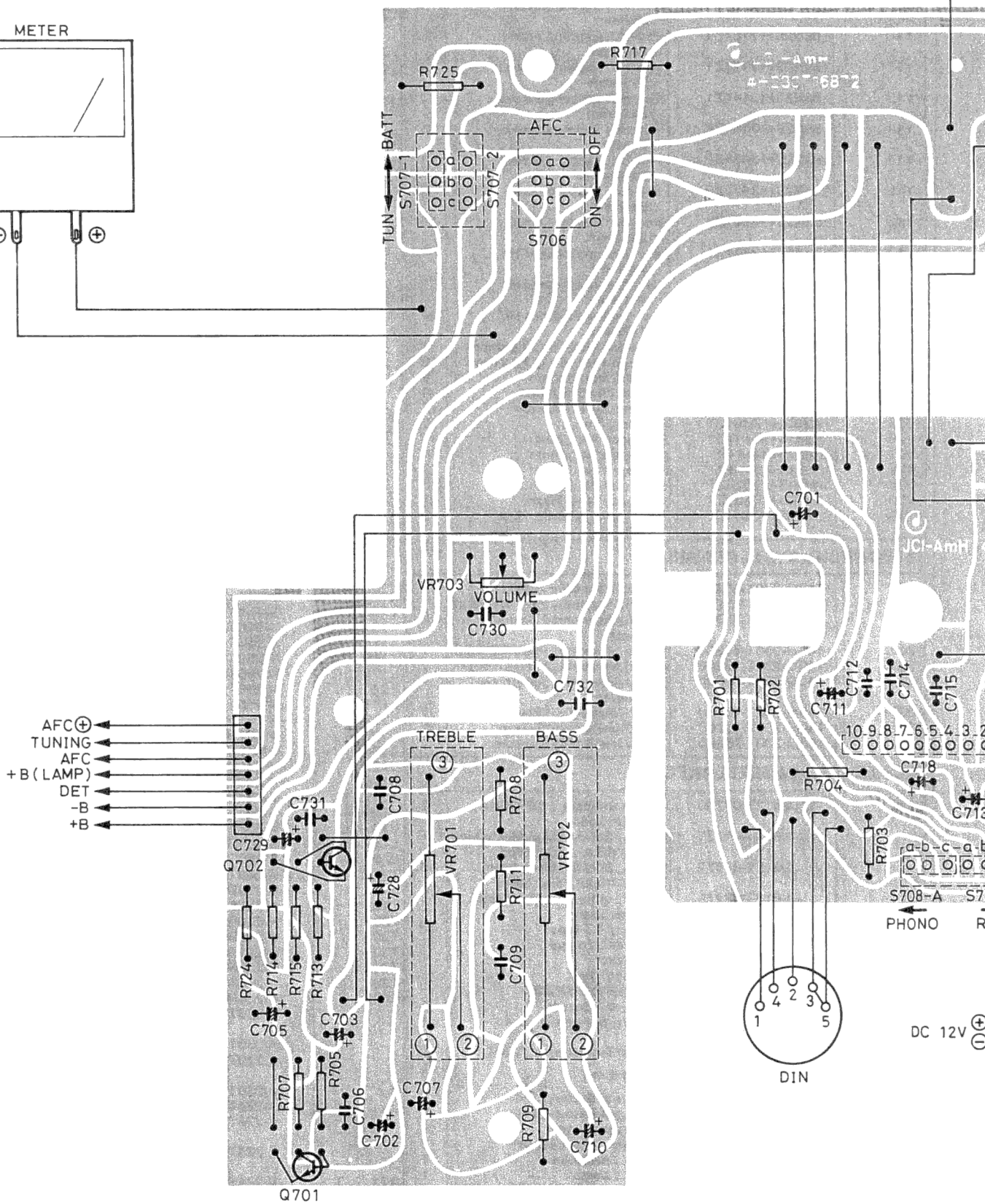
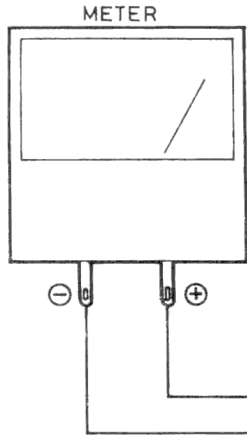

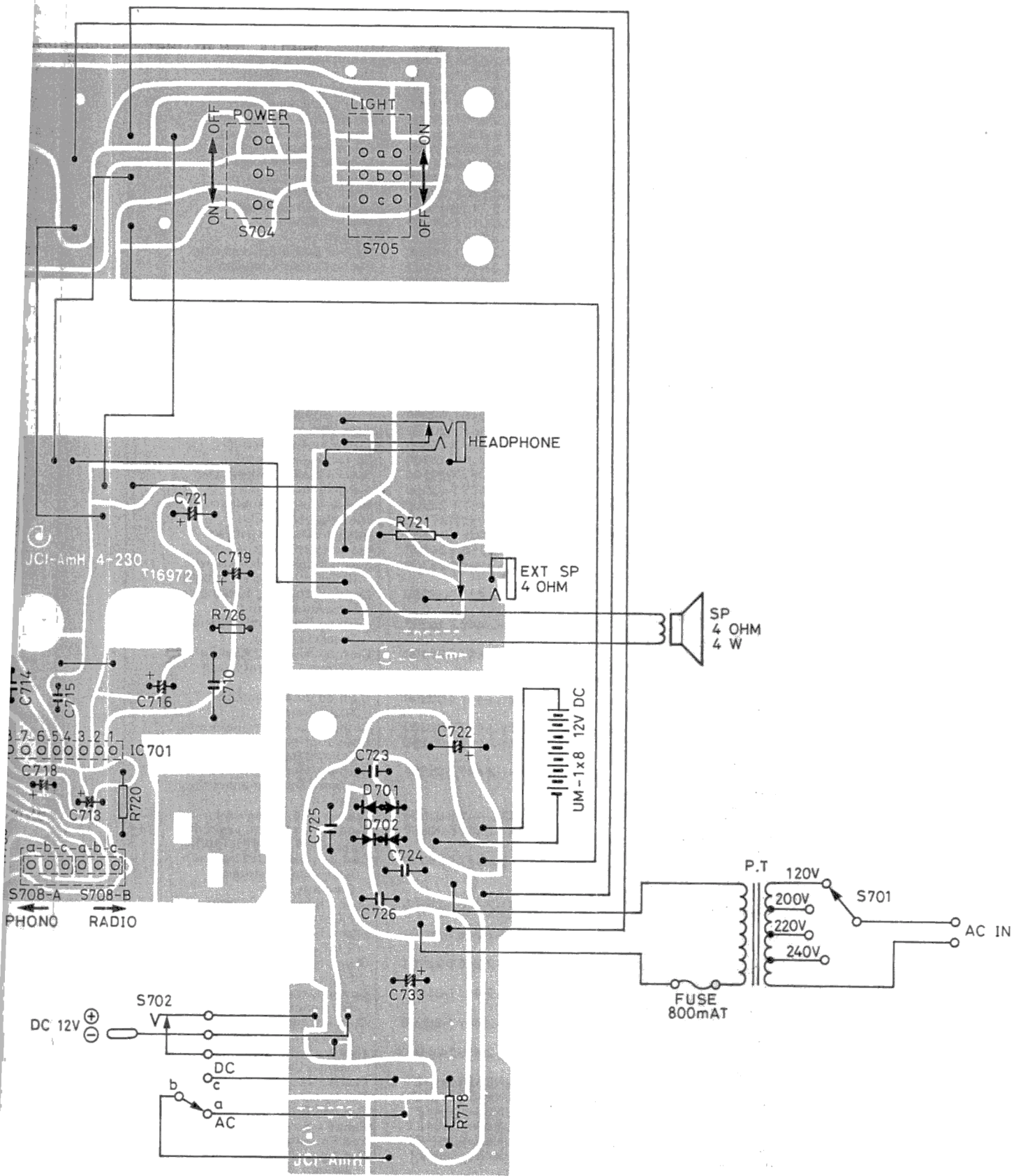

PARTS LIST

Ref. No.	Part No.	Description	Q'ty	Ref. No.	Part No.	Description	Q'ty
PACKING				CABINET & CHASSIS			
	141-6-141T-10404	Individual Carton	1	60	141-2-411T-06300	Plate Nut	2
	141-6-144T-42600	Pad, Top	1	61	141-2-538T-06700	Drum, Tuning Capacitor	1
	141-6-144T-42400	Pad, Right	1	62	141-2-538T-06800	Drum, Tuning Capacitor	1
	141-6-144T-42500	Pad, Left	1	63	141-2-210T-04700	Bracket, Tuning Capacitor	1
	141-6-410T-00104	Instruction Manual	1	64	123-2-481R-11800	Spring Coil, Dial Rope	6
	141-6-410T-00105	Instruction Manual	1	65	141-2-855T-20200	Spring Coil, Antenna Adj	1
	141-6-410T-00106	Instruction Manual	1	66	141-2-538T-06900	Drum, Spread Dial, Large	1
	141-6-231T-45900	Polyethylene Bag, Set	1	67	141-2-538T-07000	Drum, Spread Dial, Small	1
	141-6-231T-10200	Polyethylene Bag, Cord	1	68	141-2-310T-04300	Bracket, Tuning Capacitor	1
	141-6-316T-91100	Pad, Individual Carton	1	69	141-2-538T-07100	Drum, Tuning Capacitor	1
				70	141-2-538T-07200	Drum, Antenna Adj	1
CABINET & CHASSIS							
1	141-9-111T-10000	Cabinet Assembly	1	71	141-2-210T-04800	Bracket, Antenna Adj	1
2	141-9-126T-09304	Back Lid Assembly	1	72	141-2-210T-04900	Bracket, Antenna Adj	1
3	141-0-128T-03200	Battery Lid Assembly	1	73	141-2-210T-04900	Bracket, Drum	1
4	141-9-133T-01100	Compartment Lid Assembly	1	74	141-2-411T-03500	Plate Nut	2
5	141-9-122T-08400	Front Panel Assembly	1	75	141-2-445T-11801	Rubber Cushion, Lamp mtg.	2
6	141-0-163T-14000	Rotary Knob Assembly, SW	1	76	141-2-446T-05500	Plastic Cushion, Indicator	1
7	141-9-171T-00100	Handle Assembly, with Bracket	1	77	141-2-329T-04400	Refractor	1
8	141-9-369T-00100	Bracket Coil Assembly, Gyro Antenna	1	78	141-2-742T-11000	Lever, Switch, Large	1
9	141-9-210T-00100	Bracket Assembly, Dial Mechanism, FM/LW/MW/MB	1	79	141-2-742T-11500	Lever, Switch, Small	1
10	141-9-210T-00200	Bracket Assembly, Dial Mechanism, SW1-SW5	1	80	123-2-567R-10900	Pulley Shaft	1
11	141-0-163T-14100	Rotary Knob Assembly, TUNING	2	81	141-2-661T-16000	Pulley	1
12	141-9-311T-06300	Chassis Assembly	1	82	141-2-340T-00100	Rope, 500mm, Spread Dial	2
13	141-9-210T-00300	Bracket Assembly	1	83	141-2-340T-00200	Rope, 1100mm, AM Dial	1
14	141-9-331T-00200	Holder, Battery Assembly	1	84	141-2-340T-00200	Rope, 400mm, AM Tuning	1
15	141-0-566T-04400	Tuning Shaft Assembly, AM	1	85	141-2-340T-00100	Rope, 920mm, SW Dial	1
16	141-0-566T-04700	Tuning Shaft Assembly, SW	1	86	141-2-340T-00200	Rope, 500mm, SW Tuning	1
17	141-0-566T-04500	Tuning Shaft Assembly	1	87	141-2-340T-00100	Rope, 800mm, Antenna Adj	1
18	141-0-566T-04600	Tuning Shaft Assembly	1	88	141-2-447T-48000	Cushion, Antenna Coil	2
21	141-2-511T-10500	Pointer, AM/FM	1	89	141-2-421T-15700	Special Screw, Lever	1
22	141-2-511T-10600	Pointer, SW1-SW5	1	90	141-2-457T-23300	Special Washer, Spread Dial	1
23	141-2-511T-10700	Pointer, Spread Dial	1	91	141-2-457T-23000	Special Washer, Pulley	1
24	141-2-132T-03800	Sign Window, Voltage Selector	1	92	141-2-457T-23900	Special Washer, Antenna Adj	1
25	141-2-447T-06100	Cushion, Cabinet mtg.	1	93	141-2-453T-17100	Washer, Bracket Coil	3
26	141-2-271T-13700	Bracket Handle	2	94	141-2-465T-14800	Stopper, Dial Mechanism	1
27	141-2-174T-05300	Stand	2		123-2-310R-34700	Bracket EXT Antenna P.C.B.	1
28	141-2-210T-04100	Bracket, Stand mtg.	2		141-2-246T-25700	Sheet, 8x30mm, Pointer mtg. (Pointer 141-2-511T-10600)	1
29	141-2-163T-39900	Rotary Knob, Stand	2		141-2-447T-35200	Cushion, Rubber, 10x15x8mm, Rod Antenna mtg.	1
30	141-2-855T-12700	Spring Coil, Stand	2		141-2-447T-18200	Cushion, Felt, 20x20x20mm	1
31	141-2-171T-12500	Handle, Front	2		141-2-447T-33100	Speaker mtg.	2
32	141-2-271T-13900	Bracket Handle	4		141-2-447T-31000	Cushion, Rubber, 3.5x6x6x3.5mm, Lamp mtg, Dial Mechanism	2
33	141-2-369T-05000	Bracket Coil, Gyro Antenna	1		141-2-447T-00800	Cushion, 5x15mm, DIN Socket mtg.	2
34	141-2-210T-04200	Bracket, Gyro Antenna	1		141-2-447T-00800	Cushion, 5x15mm, Lead mtg.	2
35	141-2-310T-04200	Bracket, Gyro Antenna	1		141-2-447T-35200	Cushion, Rubber, 10x15x8mm, Chassis mtg.	1
36	141-2-753T-18600	Shaft, Gyro Antenna	1		141-2-447T-35801	Cushion, Rubber, 10x10x1.5mm Gyro Antenna Core mtg.	1
37	141-2-537T-07100	Bearing, Gyro Antenna	1				
38	141-2-457T-11700	Special Washer, Gyro Antenna	1		141-2-447T-01800	Cushion, 6φ, Chassis mtg.	3
39	141-2-855T-12800	Spring Coil, Gyro Antenna	1		141-2-447T-00800	Cushion, 5x15mm, Lever mtg. (Lever 141-2-742T-11000)	2
40	141-2-345T-00100	Stell Ball, 1/8 inch	1		141-2-447T-19300	Cushion, Felt, 13x15x10mm, Antenna Adj. Antenna Core mtg.	1
41	123-2-481R-15400	Spring Coil, Gyro Antenna	1				
42	141-2-146T-12700	Dial Scale, Spread Dial	1		141-2-246T-26500	Sheet, Fiber, 5x10x1mm, P.C.B. mtg.	1
43	141-2-530T-00100	Guide, Rope, SW	1		141-2-246T-18301	Sheet, Fiber, 10x10x1mm, P.C.B. mtg.	1
44	141-2-163T-40000	Rotary Knob, Spread Dial Tuning	1		141-2-246T-22801	Sheet, Fiber, 15x15x0.5mm, P.C.B. mtg.	1
45	141-2-163T-40200	Rotary Knob, Volume	1		141-2-447T-31300	Cushion, Rubber, 10x10x3mm, FM Tuning Capacitor mtg.	1
46	141-2-163T-40300	Rotary Knob, Antenna Adj/ RF Gain/Pitch Control	3		141-2-447T-36500	Cushion, Rubber, 5x8x30mm SW Tuning Capacitor mtg.	1
47	141-2-163T-40400	Rotary Knob, Band Selector	1		141-2-453T-01900	Washer, Fiber, 3x6x0.5mm, Tuning Capacitor mtg.	4
48	141-2-163T-40500	Rotary Knob, AM & FM/SW	2	Y01	BJNBS2R6+4+Z1	Pan Hd. Screw, 2.6x4mm	6
49	141-2-162T-12300	Lever Knob, POWER/ AFC/ METER/X-TAL MARKER/ BFO/BANDWIDTH	6	Y02	BJNBS2R6+6+Z1	Pan Hd. Screw, 2.6x6mm	2
50	141-2-162T-12301	Lever Knob, LIGHT	1	Y03	BJNBS++3+4+Z1	Pan Hd. Screw, 3x4mm	1
51	141-2-246T-06900	Sheet, X-TAL MARKER Switch	1	Y04	BJNBS++3+6+Z1	Pan Hd. Screw, 3x6mm	1
52	144-2-164T-19000	Slide Knob, TONE	2	Y05	BJNBS++3+8+Z1	Pad Hd. Screw, 3x8mm	1
53	123-2-246R-15800	Sheet, Lever Knob	6	Y06	BJX4S++3+8+Z1	Pan Screw, Washer Hd., 3x8mm	1
54	141-2-352T-10300	Spacer, Cabinet mtg.	3	Y07	BJX4S++320+Z1	Pan Screw, Washer Hd., 3x20mm	1
55	123-2-262R-10100	Bracket Knob, Band Switch	3	Y08	BJN2S++3+6+Z1	Pan Hd. Tapping Screw, 3x6mm	1
56	141-2-210T-04500	Bracket, FM/LW/MW/MB LED mtg.	1				
57	141-2-210T-04600	Bracket, SW1-SW5 LED mtg.	1				
58	141-2-538T-06600	Drum, Dial Rope, Chassis mtg.	2				
59	141-2-567T-01700	Pulley Shaft, Drum	2				

PARTS LIST

Ref. No.	Part No.	Description	Q'ty	Ref. No.	Part No.	Description	Q'ty	
CABINET & CHASSIS				ELECTRICAL (MISCELLANEOUS)				
Y09	BJN2S++3+8+Z1	Pan Hd. Tapping Screw, 3x8mm	4	225	4-231T-64000	Switch, Slider	1	
Y10	BJN2S++310+Z1	Pan Hd. Tapping Screw, 3x10mm	12		4-231T-64300	Switch, Rotary, FM/LW/MW		1
Y11	BJN2S++312+Z1	Pan Hd. Tapping Screw, 3x12mm	4		4-540T-00200	Remote Wire, MB		1
Y12	BJN2S++314+Z1	Pan Hd. Tapping Screw, 3x14mm	2		4-231T-64200	Switch, Slider		1
Y13	BJN2S++316+ZK	Pan Hd. Tapping Screw, 3x16mm	1		4-231T-64500	Switch, Rotary, FM/SW		1
Y14	BJN2S++340+ZR	Pan Hd. Tapping Screw, 3x40mm	1		4-540T-00271	Remote Wire, MB		1
Y15	BJN2S++345+ZR	Pan Hd. Tapping Screw, 3x45mm	2		4-224T-08700	Tuning Capacitor, Spread		1
Y16	BJN2S++350+ZK	Pan Hd. Tapping Screw, 3x50mm	6		4-244T-02500	Rod Antenna, SW		1
Y17	BJX6S++3+8+Z1	Pan Tapping Washer Hd. 3x8mm	7		4-244T-02700	Rod Antenna, FM		1
Y18	BJX6S++310+Z1	Pan Tapping Washer Hd. 3x10mm	2		141-2-472T-01001	Lug, Antenna, Lamp		2
Y19	BJX6S++312+Z1	Pan Tapping Washer Hd. 3x12mm	4	4-231T-64400	Switch, Rotary, SW	1		
Y20	BJRBS2R6+8+Z1	Hexagon Hd. Bolt, 2.6x8mm	1	4-540T-00100	Remote Wire, SW	1		
Y21	BJRBS2R614+Z1	Hexagon Hd. Bolt, 2.6x14mm	2	123-2-472R-00400	Lug, Rod Antenna	2		
Y22	WJBWS++3Y05Z1	Washer, 3x8x0.5mm	2	4-235T-34600	Socket, VC4, Lamp	3		
Y23	WJBWS++4J08Z1	Washer, 4x10x0.8mm	4	D109, 110, 115, 116, 111, 112, 117, 113, 114	LED, SLP131B, Band Indicator,	9		
Y24	WJBWS++5D08Z1	Washer, 5x12x0.8mm	1		4-237T-05800	Terminal	1	
Y25	WJBW++2R04Z1	Washer, 2mm	2		4-235T-42500	Socket, LED 5P	1	
Y26	NJRIS++3+++Z1	Hexagon Nut, 3mm	1		4-235T-42600	Socket, LED 6P	1	
Y27	NJRIS++4+++Z1	Hexagon Nut, 4mm	4		4-235T-49100	Socket, Antenna 6P	1	
Y28	NJRIS++5+++Z1	Hexagon Nut, 5mm	2		4-237T-07200	Terminal Board, EXT Antenna	1	
Y29	NJRIS++9075Z1	Hexagon Nut, 9mm	1		4-230T-34500	Ceramic, 30pF, ±5%, 50V	1	
Y30	NJRIS++10100Z1	Hexagon Nut, 10mm	3		4-230T-34600	P.C.B. Led, FM/AM	1	
Y31	BJX6S++314+Z1	Pan Tapping Washer Hd. 3x14mm	2			P.C.B., LED, SW1-5	1	
ELECTRICAL (P.C.B. ASSEMBLY)					ELECTRICAL (TUNER)			
201	140-9-230T-55100	P.C.B. Assembly, Tuner	1	L101	4-256R-11200	VHF Coil, FM Load	1	
202	140-9-230T-73100	P.C.B. Assembly, EXT Antenna	1	L102, 103	4-265R-13600	VHF Coil, FM Antenna	2	
203	140-9-230T-55301	P.C.B. Assembly, Tuning/Control	1	L104	4-265T-04530	VHF Coil, FM RF	1	
204	140-9-230T-55800	P.C.B. Assembly, FM/AM LED	1	L105	4-265R-05000	VHF Coil, 6½	1	
205	140-9-230T-55900	P.C.B. Assembly, SW1-5 LED	1	L106	4-265T-05230	VHF Coil, FM OSC	1	
206	140-9-230T-76000	P.C.B. Assembly, Switch & Volume	1	L108	4-257T-22502	Antenna Coil Assembly, MB	1	
207	140-9-230T-76100	P.C.B. Assembly, Power	1	L109	4-260T-00130	RF Coil, LW	1	
208	140-9-230T-76200	P.C.B. Assembly, Source	1	L110	4-260T-00230	RF Coil, MW	1	
209	140-9-230T-76300	P.C.B. Assembly, Speaker	1	L111	4-260T-00330	RF Coil, MB	1	
ELECTRICAL (MISCELLANEOUS)				L112	4-257T-22601	Antenna Coil Assembly, SW	1	
210	4-612T-07700	Lamp Indicator, 12V 40mA White Lead	1	L113	4-260T-00430	RF Coil, SW1	1	
	4-612T-07771	Lamp, FM/AM Dial Mechanism, 12V 40mA, Red Lead	1	L114	4-260T-00530	RF Coil, SW2	1	
	4-612T-07772	Lamp, SW Dial Mechanism, 12V 40mA, Blue Lead	1	L115	4-260T-00630	RF Coil, SW3	1	
211	4-612T-07773	Lamp, Indicator, 12V 40mA, Black Lead	1	L116	4-260T-00730	RF Coil, SW4	1	
214	4-235T-33200	Socket, AC Input	1	L117	4-260T-00830	RF Coil, SW5	1	
215	4-236T-09900	Plug, AC Voltage Selector	1	L120	4-258T-16530	Oscillator Coil, SW	1	
216	141-2-143T-17311	Marking Plate, 120/200/220/240V	1	L121	4-258T-15730	Oscillator Coil, LW	1	
	141-2-382T-03100	Terminal, Socket	5	L122	4-258R-19431	Oscillator Coil, MW	1	
	4-235T-34600	Socket, Speaker & Lamp	4	L123	4-265R-11200	VHF Coil, 12½	1	
			1	L124	4-258T-15930	Oscillator Coil, MB	1	
223	4-251T-74600	Power Transformer, T701	1	L125	4-258T-16030	Oscillator Coil, SW1	1	
	4-243T-77900	Power Cord	1	L126	4-258T-16130	Oscillator Coil, SW2	1	
	141-2-336T-11600	Terminal Battery, (-)	2	L127	4-258T-16230	Oscillator Coil, SW3	1	
	141-2-336T-07201	Terminal Battery, (+)	2	L128	4-258T-16330	Oscillator Coil, SW4	1	
212	4-511T-08085	Meter, Indicator	1	L129	4-258T-16430	Oscillator Coil, SW5	1	
213	4-151T-22900	Speaker, 12cm 4Ω 5W	1	L130	4-253R-11160	Choke Coil, 1 H	1	
227	4-230T-34700	P.C.B., Antenna	1	L301	4-258T-16630	Oscillator Coil, BFO	1	
228	4-230T-34800	P.C.B., Lamp	1	T101	4-256T-20831	IF Transformer, 10.7MHz	1	
224	4-257T-22400	Antenna Coil, MW/LW. L107	1	T102	4-256R-19531	IF Transformer, 10.7MHz	1	
	141-2-383T-03900	Fuse holder	1	T103	4-256R-15831	IF Transformer, 10.7MHz	1	
	4-234T-01900	Fuse	1	T301	4-256R-19531	IF Transformer, 10.7MHz	1	
	4-234T-05100	Fuse	1	T302	4-256R-15131	IF Transformer, 10.7MHz	1	
			1	T303	4-256R-02331	IF Transformer, 10.7MHz	1	
			1	T304	4-256R-80730	IF Transformer, 455kHz	1	
			1	T305	4-256R-00231	IF Transformer, 455kHz	1	
			1	T306	4-256R-00231	IF Transformer, 455kHz	1	
			1		4-230T-34100	P.C. Board, LW/MW/MB VC2 mtg.	1	
			1		4-230T-34200	P.C. Board, FM VC1 mtg.	1	
			1		4-230T-34300	P.C. Board, LW/MW/MB VC2 mtg.	1	
			2		4-230T-34400	P.C. Board, FM VC1 mtg.	1	
			2		4-224T-08500	Tuning Capacitor, FW VC1	1	
			1		4-224T-08600	Tuning Capacitor, LW/MW/MB VC2	1	
			1		4-224T-10100	Tuning Capacitor, SW VC3	1	
			1	CT1, 2, 3	4-224R-11671	Trimmer, 8pF	3	
			1	CT4, 7	4-224R-02471	Trimmer, 8pF x2	2	
			1	CT5, 6, 9	4-224R-11671	Trimmer, 8pF x2	3	
			1	CT8	4-224R-11800	Trimmer, 16pF x2	1	
			1	CT11	4-224T-07600	Trimmer, 16pF	1	

EXPLODED VIEW (CABINET)

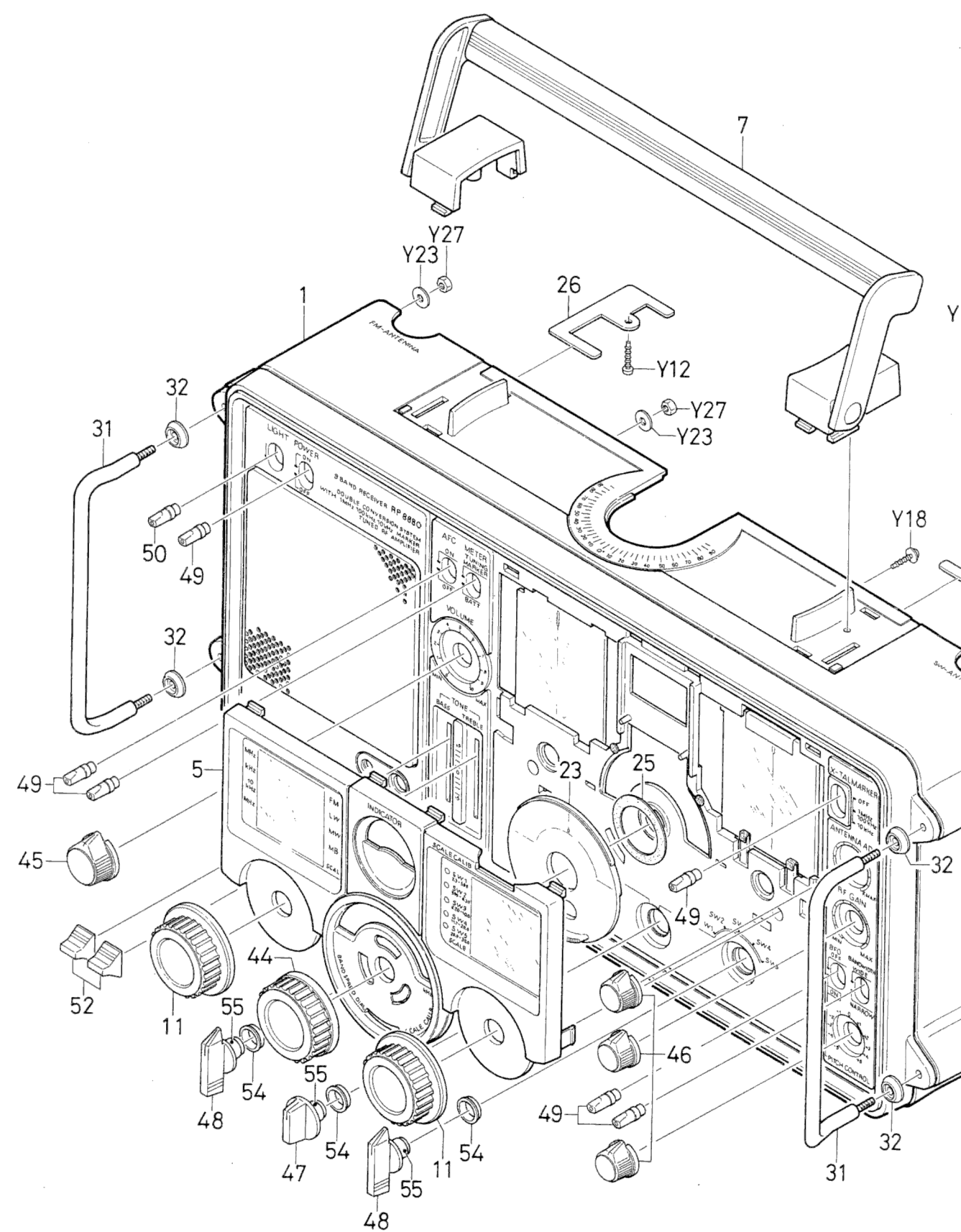

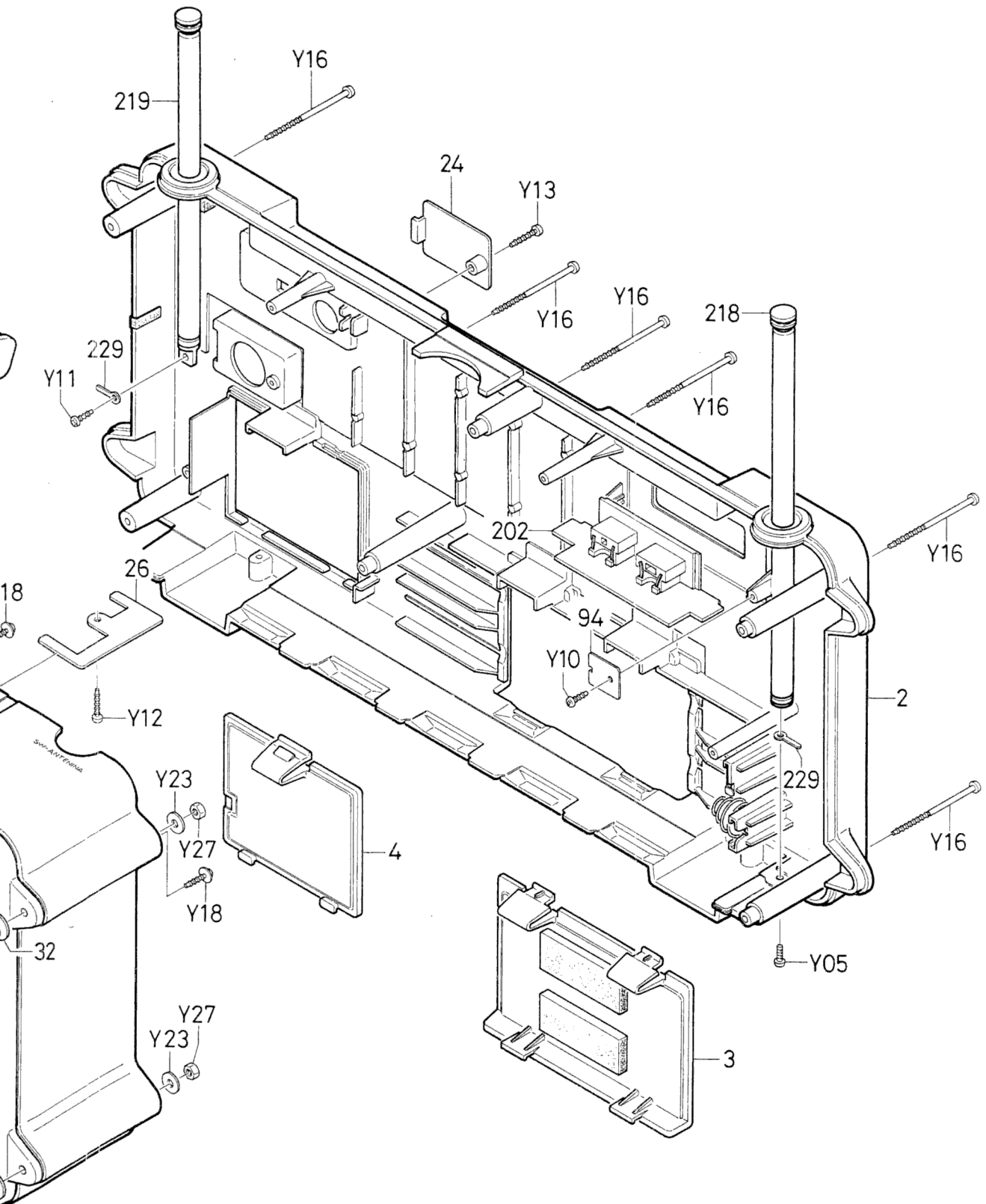

EXPLODED VIEW (CHASSIS)

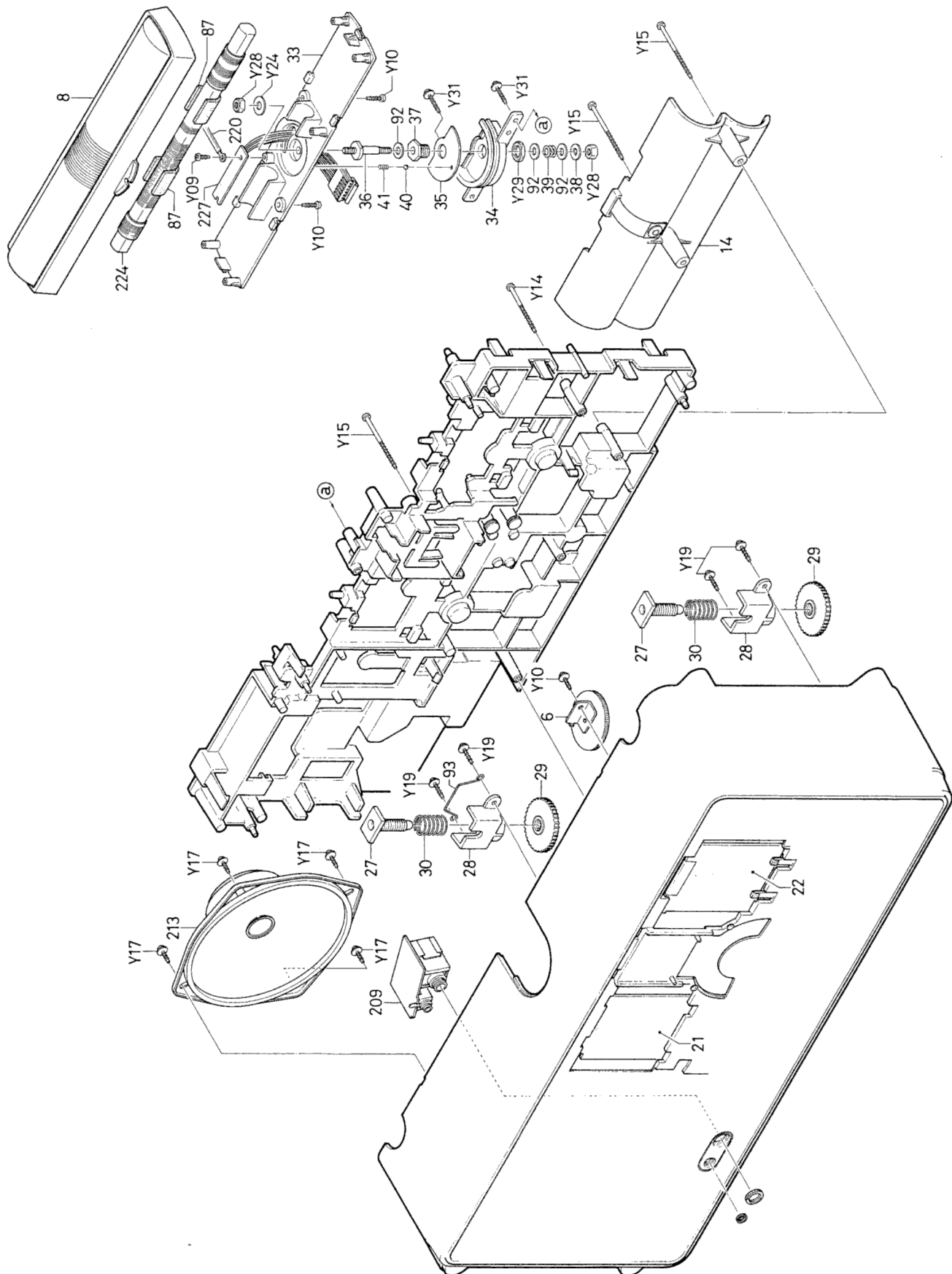

PARTS LIST

Ref. No.	Part No.	Description	Q'ty	Part No.	Description	Q'ty	
ELECTRICAL (TUNER)				ELECTRICAL (TUNER)			
CT12, 13, 14	4-224R-11671	Trimmer, 8pF	3	R109, 131, 132, 133, 134	Carbon, 220Ω, ±10%, 1/4W	5	
CT15, 16	4-224R-11800	Trimmer, 16pF	2	R307, 323	Carbon, 270Ω, ±10%, 1/4W	2	
CT17	4-224T-07300	Trimmer, 30pF	1	R161, 306, 309, 324	Carbon, 330Ω, ±10%, 1/4W	4	
CT19	4-224T-07300	Trimmer, 30pF	1	R115, 325	Carbon, 560Ω, ±10%, 1/4W	2	
B101, 102, 103, 104, 105, 106	123-2-471R-10400	Bead Core	6	R149, 152, 162	Carbon, 680Ω, ±10%, 1/2W	3	
CF101, 102	4-256T-80400) 4-256T-80472) 4-236T-10200) 4-236T-10276) 4-236T-10273) 4-236T-10272) 4-235T-49300) 4-235T-49400) 4-222T-39574) 4-222T-39575) 4-231T-64100) 4-237T-01000) 4-231T-64001) 4-231T-64201) 4-231T-57500) 141-2-471T-00100) 141-2-322T-36300) 141-2-322T-36400) 141-2-322T-36500) 141-2-322T-36600) 141-2-322T-36700) 141-2-322T-36800) 141-2-852T-46700)	IF Filter, 10.7MHz	3	R108, 111, 153, 308, 316, 317, 322, 329, 331, 342	Carbon, 1KΩ, ±10%, 1/4W	10	
R328		Socket, Control, 4P, U5	1	R311	Carbon, 1.2KΩ, ±10%, 1/4W	1	
R328		Socket, Audio, 7P, U6	1	R124, 126, 341	Carbon, 1.5KΩ, ±10%, 1/4W	3	
S4		Variable Resistor, Meter, 5KΩ	1	R127	Carbon, 1.8KΩ, ±10%, 1/4W	1	
		Variable Resistor, Meter, 10KΩ	1	R104, 154, 158, 302, 315, 321	Carbon, 2.2KΩ, ±10%, 1/4W	6	
225		Switch, SW1	1	R334, 343	Carbon, 3.3KΩ, ±10%, 1/4W	2	
226		Terminal, Wrapping	53	R358	Carbon, 470Ω, ±10%, 1/4W	1	
		Switch Assembly, FM/LW/MW/MB	1	R121, 349	Carbon, 3.9KΩ, ±10%, 1/4W	2	
S1		Slide Switch	1	R147, 148, 332, 333, 304	Carbon, 5.6KΩ, ±10%, 1/4W	5	
		Bead Core	1	R352	Carbon, 6.8KΩ, ±10%, 1/4W	1	
		Shield Plate, FM IF	1	R313, 340	Carbon, 10KΩ, ±10%, 1/4W	2	
		Shield Plate, SW 1st MIX	1	R119	Carbon, 15KΩ, ±10%, 1/4W	1	
		Shield Plate, SW 2nd OSC	1	R118	Carbon, 39KΩ, ±10%, 1/4W	1	
		Shield Plate, SW 1st OSC	1	R116	Carbon, 56KΩ, ±10%, 1/4W	1	
		Shield Plate, FM OSC	1	R351	Carbon, 82KΩ, ±10%, 1/4W	1	
		Shield Plate, FM MIX	1	R113, 335, 303	Carbon, 100KΩ, ±10%, 1/4W	3	
		Spring Wire	1	R157, 314, 318, 353	Carbon, 220KΩ, ±10%, 1/4W	4	
Q101, 105, 106		FET, 2SK49H1	3	R145	Carbon, 270KΩ, ±10%, 1/4W	1	
Q102		Transistor, 2SC930D	1	R301	Carbon, 330KΩ, ±10%, 1/4W	1	
Q103, 108, 111, 112		Transistor, 2SC930D Converter	4	R103, 107	Carbon, 390KΩ, ±10%, 1/4W	2	
Q104		Transistor, 2SC930E IF	1	R101, 112	Carbon, 470KΩ, ±10%, 1/4W	6	
Q107		FET, 3SK59GR	1	114, 113, 136, 151	Carbon, 2.7KΩ, ±10%, 1/4W	1	
Q109		FET, 2SK49H1	1	R129	Carbon, 8.2KΩ, ±10%, 1/4W	1	
Q110		FET, 2SK49F2	1	R165	Carbon, 330KΩ, ±10%, 1/4W	1	
Q301, 303, 304		Transistor, 2SC930D IF	3	R160	Carbon, 47KΩ, ±10%, 1/4W	1	
Q302		Transistor, 2SC930E IF	1	R312	Carbon, 180KΩ, ±10%, 1/4W	1	
Q305		Transistor, 2SC930D IF	1	R339	Carbon, 18KΩ, ±10%, 1/4W	1	
Q306		Transistor, 2SC930E Converter	1	R166	Carbon, 22Ω, ±10%, 1/4W	1	
Q308		Transistor, 2SD545F	1	R372	Carbon, 100Ω, ±10%, 1/4W	1	
D101, 301		Diode, DS442	2	R137	Carbon, 1KΩ, ±10%, 1/4W	1	
D102, 303, 304, 305, 306		Diode, 1S188FM	5	R139	Carbon, 1.8KΩ, ±10%, 1/4W	1	
D103, 313		Diode, 1S553	2	R146	Carbon, 2.2KΩ, ±10%, 1/4W	1	
D104, 105, 106, 107, 108, 302, 308		Diode, 1S188AM	7	R144	Carbon, 10KΩ, ±10%, 1/4W	1	
D118		Diode, DS442	1	R141	Carbon, 22KΩ, ±10%, 1/4W	1	
D309, 310, 311, 312		Diode, 1S188AM	4	R142	Carbon, 390KΩ, ±10%, 1/4W	1	
D314		Diode, YZ060	1	R155	Carbon, 470KΩ, 10%, 1/4W	1	
D315		Diode, YZ047	1	R143	Carbon, 470Ω, ±10%, 1/4W	1	
D307		Diode, 1S188FM	1	R156	Carbon, 330Ω, ±10%, 1/2W	1	
R159		Carbon, 5.6Ω, ±10%, 1/4W	1	R371	Solid, 330Ω, ±10%, 1/2W	1	
R326		Carbon, 15Ω, ±10%, 1/4W	1	R361	Carbon, 3900Ω, ±10%, 1/2W	1	
R128, 130, 344, 345		Carbon, 33Ω, ±10%, 1/4W	4	R369	Solid, 3900Ω, ±10%, 1/2W	1	
R117		Carbon, 56Ω, ±10%, 1/4W	1	R167	Carbon, 100KΩ, ±10%, 1/2W	1	
R102, 105, 106, 122, 138, 135, 305, 319, 359		Carbon, 100Ω, ±10%, 1/4W	9	C315, 377	Solid, 100KΩ, ±10%, 1/4W	1	
R125		Carbon, 150Ω, ±10%, 1/4W	1	C111	Carbon, 3.3KΩ, ±10%, 1/4W	1	
				C128, 135	Ceramic, 1pF, ±0.25pF, 50V	2	
				C154	Ceramic, 2pF, ±0.25pF, 50V	1	
				C109, 122	Ceramic, 3pF, ±0.25pF, 50V	2	
				C125	Ceramic, 5pF, ±10%, 50V	1	
				C103, 108, 121, 138	Ceramic, 6pF, ±10%, 50V	2	
				C101, 192	Ceramic, 7pF, ±10%, 50V	1	
				C143, 152	Ceramic, 8pF, ±10%, 50V	4	
					Ceramic, 10pF, ±10%, 50V	2	
					Ceramic, 15pF, ±10%, 50V	2	

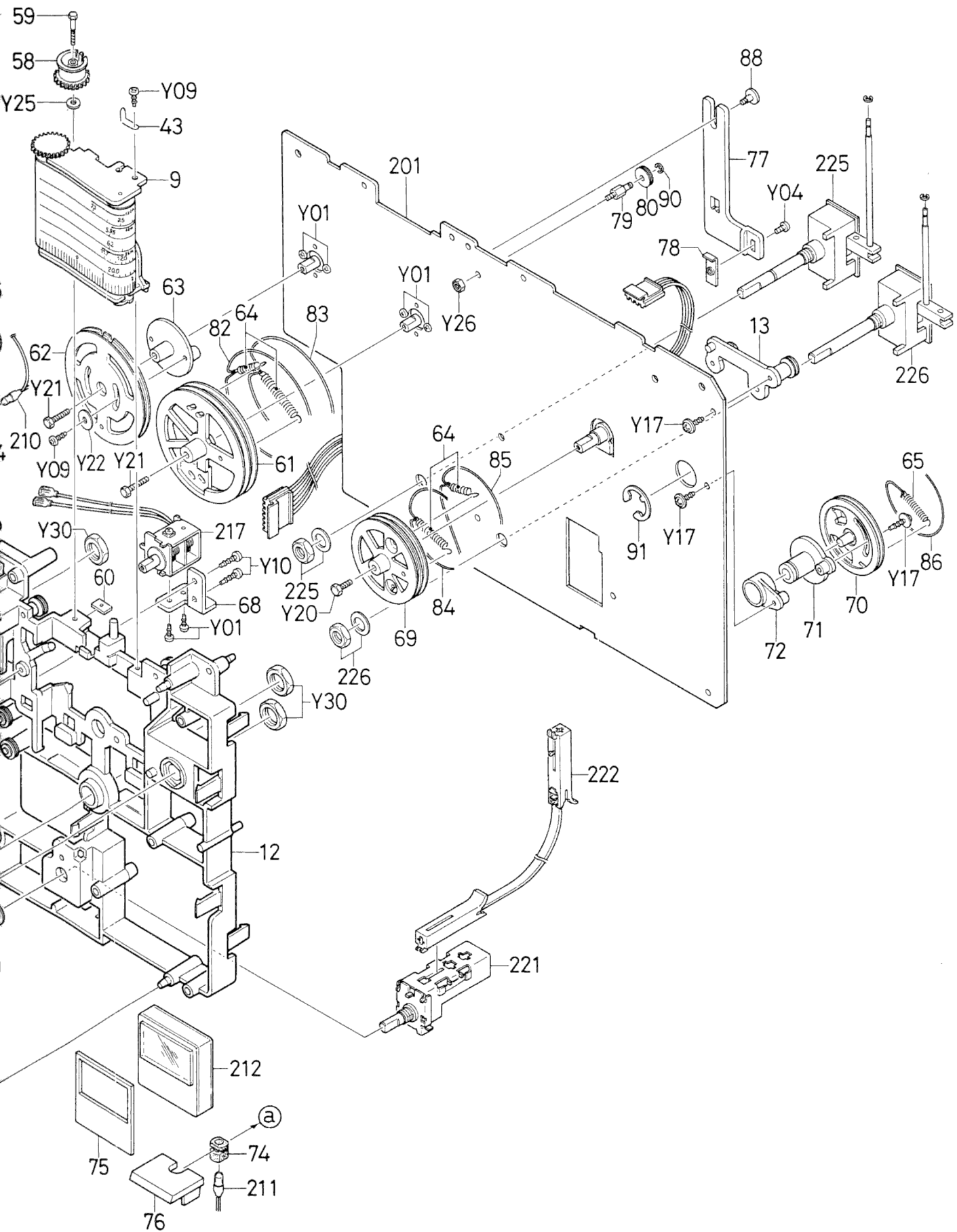

PARTS LIST

Ref. No.	Part No.	Description	Q'ty	Ref. No.	Part No.	Description	Q'ty
ELECTRICAL (TUNER)				ELECTRICAL (TUNER)			
C112, 132		Ceramic, 24pF, $\pm 10\%$, 50V	2	C176		Mylar, 0.0022 μ F, $\pm 20\%$, 50V	1
C159, 187, 165		Ceramic, 30pF, $\pm 10\%$, 50V	3	C173, 211		Mylar, 0.0033 μ F, $\pm 20\%$, 50V	2
C343		Ceramic, 36pF, $\pm 10\%$, 50V	1	C161, 381		Mylar, 0.0047 μ F, $\pm 20\%$, 50V	2
C319		Ceramic, 220pF, $\pm 10\%$, 50V	1	C316		Mylar, 0.0056 μ F, $\pm 20\%$, 50V	1
C148		Ceramic, 12pF, $\pm 10\%$, 50V	1	C133, 134, 156, 166, 193, 201, 206, 341, 355, 190		Mylar, 0.01 μ F, $\pm 20\%$, 50V	10
C144, 145, 186, 153, 167		Ceramic, 100pF, $\pm 5\%$, 50V	5	C204, 304, 312, 342		Mylar, 0.022 μ F, $\pm 20\%$, 50V	4
C102, 314, 335, 339, 146		Ceramic, 100pF, $\pm 20\%$, 50V	5	C120, 321, 303		Mylar, 0.039 μ F, $\pm 20\%$, 50V	3
C131, 137		Ceramic, 130pF, $\pm 5\%$, 50V	2	C344		Mylar, 0.068 μ F, $\pm 20\%$, 50V	1
C158, 188, 195, 378		Ceramic, 220pF, $\pm 20\%$, 50V	4	C202		Styrol, 150pF, $\pm 5\%$, 135V	1
C151		Ceramic, 330 μ F, $\pm 20\%$, 50V	1	C207		Styrol, 330pF, $\pm 5\%$, 135V	1
C113, 147, 196		Ceramic, 470pF, $\pm 20\%$, 50V	3	C127		Electrolytic, 1 μ F, 10V	1
C139		Ceramic, 0.001 μ F, +80 -20%, 50V	1	C323, 327		Electrolytic, 4.7 μ F, 10V	2
C104, 105, 106, 107		Ceramic, 0.01 μ F, +80 -20%, 50V	4	C309, 325		Electrolytic, 10 μ F, 10V	2
C149		Ceramic, 100pF, $\pm 20\%$, 50V	1	C302		Electrolytic, 470 μ F, 6.3V	1
C114, 115, 116, 117, 119, 123, 156, 199, 311, 313, 337, 354, 150		Ceramic, 0.01 μ F, +80 -20%, 50V	13	C359		Electrolytic, 100 μ F, 6.3V	1
C162, 163, 168, 191, 194, 197, 301, 302, 305, 306, 308, 316, 318, 326, 336, 338, 356, 357, 358, 361, 360, 118, 126, 129, 157		Ceramic, 0.022 μ F, +80 -20%, 50V	25	ELECTRICAL (EXT ANTENNA)			
C142, 164, 322, 324		Ceramic, 0.039 μ F, +80 -20%, 50V	4	BPF101	4-253T-10000	Filter	1
C221, 222, 223, 224, 225		Ceramic, 0.01 μ F, +80 -20%, 50V	5		4-237T-01000	Terminal, Wrapping	5
C226, 227, 228, 229, 230		Ceramic, 0.022 μ F, +80 -20%, 50V	5		4-235T-34600	Socket, Antenna	3
C205		Ceramic, 3pF, ± 0.25 pF, 50V	1	L131, 132	4-253T-49800	Socket, EXT Antenna 3P	1
C172		Ceramic, 15pF, $\pm 10\%$, 50V	1		4-265R-12700	VHF Coil	2
C352		Ceramic, 10pF, $\pm 10\%$, 50V	1		4-257R-14700	Antenna Coil	1
C185		Ceramic, 18pF, $\pm 10\%$, 50V	1		4-235T-37100	Socket	1
C124		Ceramic, 20pF, $\pm 10\%$, 50V	1		4-235T-37200	Socket	1
C182		Ceramic, 15pF, $\pm 10\%$, 50V	1	C141		Ceramic, 15pF, $\pm 10\%$, 50V	1
C317, 353		Ceramic, 30pF, $\pm 5\%$, 50V	2	C212		Ceramic, 10pF, $\pm 10\%$, 50V	1
C200		Ceramic, 33pF, $\pm 5\%$, 50V	1	C213		Ceramic, 47pF, $\pm 10\%$, 50V	1
C178		Ceramic, 39pF, $\pm 5\%$, 50V	1	ELECTRICAL (CONTROL)			
C175		Ceramic, 47pF, $\pm 5\%$, 50V	1	L302	4-253R-10310	Choke Coil	1
C184		Ceramic, 56pF, $\pm 5\%$, 50V	1	L303	4-255R-10700	Choke Coil	1
C198		Ceramic, 33pF, $\pm 5\%$, 50V	1	BPF301	4-253T-10000	Filter	1
C181		Ceramic, 100pF, $\pm 5\%$, 50V	1	CF302, 303	4-256T-80871	IF Filter, 455KHz	2
C208		Ceramic, 75pF, $\pm 5\%$, 50V	1	R354	4-222T-59072	Variable Resistor, 50K Ω , D DX/LOCAL	1
C209		Ceramic, 24pF, $\pm 5\%$, 50V	1	R357	4-222T-59071	Variable Resistor, 50K Ω , B	1
C177		Ceramic, 100pF, $\pm 5\%$, 50V	1	R356	4-222T-39577	Variable Resistor, 50K Ω ,	1
C140		Ceramic, 10pF, $\pm 10\%$, 50V	1	S6, 7	4-231T-47600	Slide Switch, Band	2
C214		Ceramic, 30pF, $\pm 10\%$, 50V	1	S8	4-231T-47500	Slide Switch, X-TAL Marker	1
C203		Ceramic, 47pF, $\pm 5\%$, 50V	1		4-237T-01000	Terminal, Wrapping	9
C235		Ceramic, 47pF, $\pm 10\%$, 50V	1		4-236T-10571	Plug, 4P	1
C174		Ceramic, 24pF, $\pm 5\%$, 50V	1		4-235T-49200	Socket, 9P	1
C170		Ceramic, 15pF, $\pm 5\%$, 50V	1		4-235T-01400	Crystal, Marker, 4MHz	1
C171		Ceramic, 75pF, $\pm 5\%$, 50V	1	IC301		Integrated Circuit, M54815L	1
C183		Ceramic, 470pF, $\pm 10\%$, 50V	1	Q303		Transistor, 2SC536F	1
C169, 179, 189, 307, 328, 329, 331, 350		Mylar, 0.001 μ F, $\pm 20\%$, 50V	8	R347		Carbon, 33 Ω , $\pm 10\%$, 1/4W	1
				R362		Carbon, 330 Ω , $\pm 10\%$, 1/4W	1
				R336		Carbon, 390 Ω , $\pm 10\%$, 1/4W	1
				R346, 366		Carbon, 1K Ω , $\pm 10\%$, 1/4W	2
				R363, 365		Carbon, 2.2K Ω , $\pm 10\%$, 1/4W	2
				R373		Carbon, 2.7K Ω , $\pm 10\%$, 1/4W	1
				R337, 370, 375		Carbon, 3.9K Ω , $\pm 10\%$, 1/4W	3
				R367		Carbon, 10K Ω , $\pm 10\%$, 1/4W	1
				R368, 376		Carbon, 15K Ω , $\pm 10\%$, 1/4W	2
				R364		Carbon, 12K Ω , $\pm 10\%$, 1/4W	1
				R355		Carbon, 56K Ω , $\pm 10\%$, 1/4W	1
				R338		Carbon, 1.5K Ω , $\pm 10\%$, 1/4W	1
				R348		Carbon, 1.5M Ω , $\pm 10\%$, 1/4W	1
				C340, 373, 371, 368, 369		Ceramic, 0.01 μ F, +80 -20%, 50V	5
				C367		Ceramic, 150pF, $\pm 10\%$, 50V	1
				C364		Ceramic, 47pF, $\pm 10\%$, 50V	1
				C334		Ceramic, 100pF, $\pm 10\%$, 50V	1
				C333		Ceramic, 27pF, $\pm 10\%$, 50V	1
				C366, 332		Ceramic, 220pF, $\pm 10\%$, 50V	1
				C370		Ceramic, 130pF, $\pm 10\%$, 50V	1

PARTS LIST

Ref. No.	Part No.	Description	Q'ty	Ref. No.	Part No.	Description	Q'ty
ELECTRICAL (CONTROL)				ELECTRICAL (SOURCE)			
C374		Ceramic, 30pF, ±10%, 50V	1	C723, 724,		Ceramic, 0.022μF, +80 -20%, 50V	4
C380		Ceramic, 1pF, ±0.25pF, 50V	1	725, 726			
C348		Mylar, 0.0047μF, ±20%, 50V	1	C733		Electrolytic, 330μF, 25V	1
C346		Mylar, 0.068μF, ±20%, 50V	1	C722		Electrolytic, 2200pF, 25V	1
C351		Mylar, 0.033μF, ±20%, 50V	1	ELECTRICAL (SPEAKER)			
C349		Mylar, 0.01μF, ±20%, 50V	1		4-235T-31971	Socket, Headphone	1
C375		Mylar, 0.039μF, +20%, 50V	1		4-235T-05300	Socket, EXT Speaker	1
C381		Electrolytic, 10μF, 6.3V	1	R721		Carbon, 100Ω, ±10%, 1/2W	1
ELECTRICAL (SWITCH & VOLUME)							
S704	4-231T-68800	Switch, Power	1				
S705	4-231T-50072	Switch, Light	1				
S706, 707	4-231T-47800	Switch, AFC, Meter	2				
VR701, 702	4-222T-45000	Variable Resistor, 50KΩ, A Bass, Treble	2				
VR703	4-222T-59073	Variable Resistor, 50KΩ, D	1				
	4-237T-00100	Terminal	2				
	4-236T-10574	Plug, 7P	1				
Q702, 701		Transistor, 2SC536G	2				
R714		Carbon, 22Ω, ±10%, 1/4W	1				
R709		Carbon, 680Ω, ±10%, 1/4W	1				
R715, 725		Carbon, 1.5KΩ, ±10%, 1/4W	2				
R724		Carbon, 2.7KΩ, ±10%, 1/4W	1				
R708, 711		Carbon, 4.7KΩ, ±10%, 1/4W	2				
R717		Carbon, 82KΩ, ±10%, 1/4W	1				
R713, 705		Carbon, 680KΩ, ±10%, 1/4W	2				
R707		Carbon, 10KΩ, ±10%, 1/4W	1				
C706		Ceramic, 220pF, ±10%, 50V	1				
C731		Ceramic, 330pF, ±10%, 50V	1				
C730		Ceramic, 680pF, ±10%, 50V	1				
C708		Mylar, 0.0022μF, ±20%, 50V	1				
C732		Mylar, 0.022μF, ±20%, 50V	1				
C709		Mylar, 0.033μF, ±20%, 50V	1				
C707		Electrolytic, 0.15μF, 16V	1				
C710		Electrolytic, 0.33μF, 16V	1				
C729, 703		Electrolytic, 0.1μF, 16V	2				
C728		Electrolytic, 1μF, 16V	1				
C705		Electrolytic, 100μF, 10V	1				
C702		Electrolytic, 2.2μF, 16V	1				
ELECTRICAL (POWER)							
IC701		Integrated Circuit, LA4420	1				
	4-235T-32900	Socket, Phono/Radio	1				
S708	4-231T-42100	Switch, Phono/Radio	1				
	4-231T-42171						
	4-237T-00100	Terminal	2				
	141-2-368T-11600	Heat Sink	1				
	141-2-322T-40400	Shield Plate	1				
R704		Carbon, 100Ω, ±10%, 1/4W	1				
R726		Carbon, 120Ω, ±10%, 1/2W	1				
R720		Carbon, 330Ω, ±10%, 1/4W	1				
R703		Carbon, 2.2MΩ, ±10%, 1/4W	1				
R701, 702		Carbon, 330KΩ, ±10%, 1/4W	2				
C714		Ceramic, 470pF, ±10%, 50V	1				
C712		Ceramic, 0.001μF, ±10%, 50V	1				
C715		Mylar, 0.022μF, ±20%, 50V	1				
C720		Mylar, 0.15μF, ±20%, 50V	1				
C701, 711		Electrolytic, 1μF, 16V	2				
C718		Electrolytic, 4.7μF, 16V or 25V	1				
C716		Electrolytic, 47μF, 16V	1				
C713		Electrolytic, 100μF, 10V	1				
C721		Electrolytic, 1000μF, 10V	1				
C719		Electrolytic, 10μF, 16V	1				
ELECTRICAL (SOURCE)							
	4-235T-35900	Socket, AC INPUT	1				
	141-2-135T-44900	Cover, AC INPUT	1				
	4-237T-00100	Terminal	4				
	4-237T-05800	Terminal, Lamp	1				
	4-252T-06900	Choke Coil, 100μH	1				
	4-252T-04700						
D701		Diode, DS132A	1				
D702		Diode, DS131A	1				
R718, 719		Carbon, 27Ω, ±10%, 1/2W	2				

SANYO ELECTRIC TRADING CO., LTD.
 33, Hiyoshi-cho 2-chome, Moriguchi-shi,
 Osaka-fu, 570 Japan