

# Set 55 TV Set 50 TV

Instruction manual

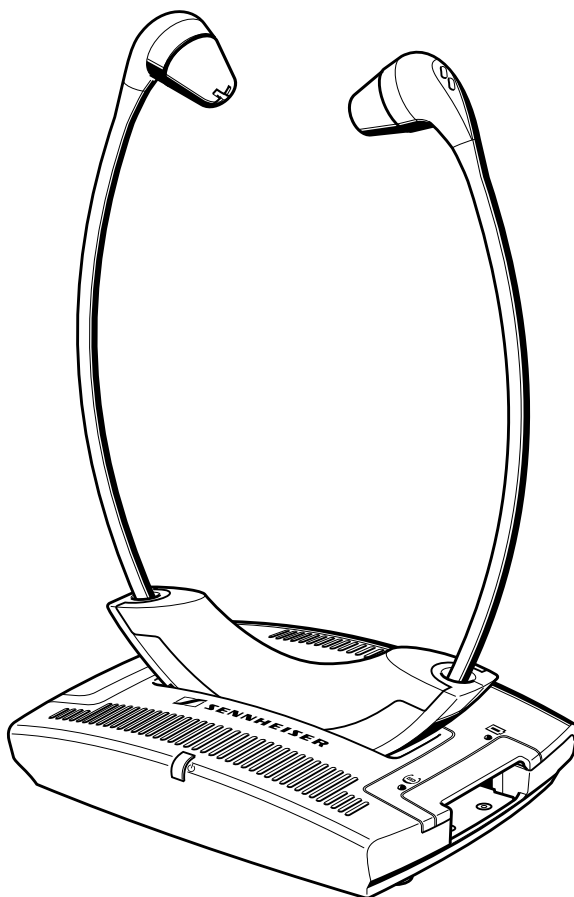

A

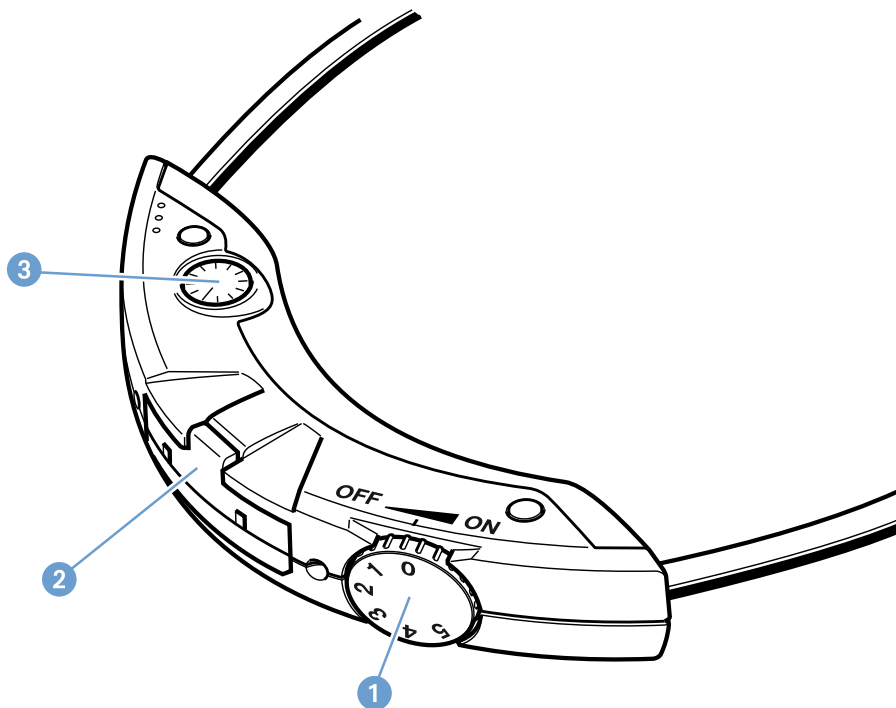

B

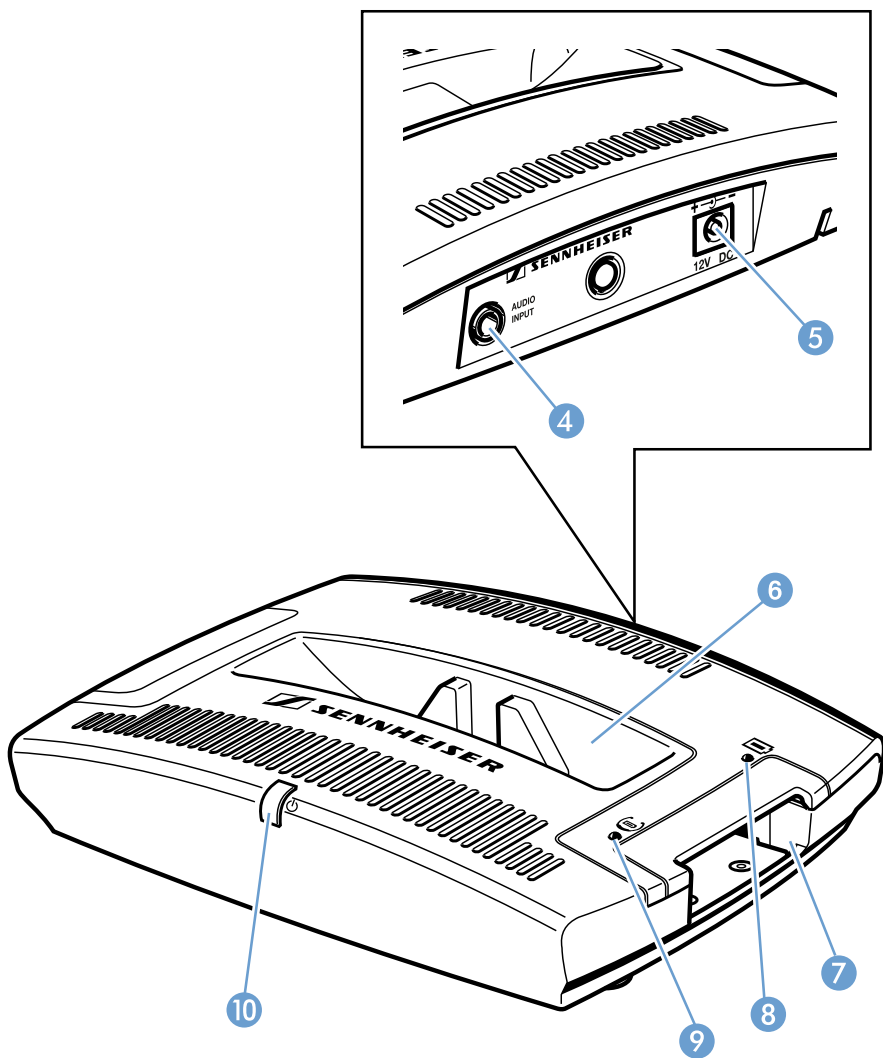

C

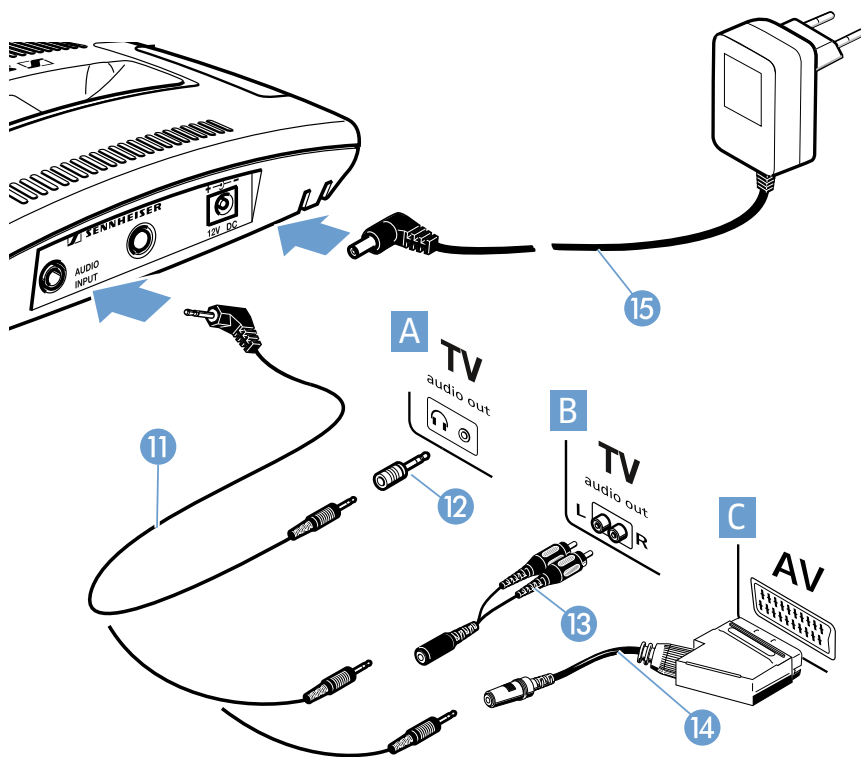

# Contents

<b>Safety instructions .....</b>	<b>2</b>
<b>The Set 50 TV/Set 55 TV stethoset receiver system .....</b>	<b>5</b>
<b>Set 50 TV: Delivery includes .....</b>	<b>5</b>
Set 55 TV product variant .....	5
<b>Operating controls .....</b>	<b>6</b>
Receiver (see inside cover) .....	6
Transmitter (see inside cover) .....	6
LED indications (see inside cover) .....	6
Connection possibilities (see inside cover) .....	6
<b>Putting the system into operation .....</b>	<b>7</b>
Setting up the transmitter .....	7
Connecting the transmitter to the sound source .....	8
Connecting the transmitter to the mains .....	10
Inserting and removing the receiver's rechargeable battery .....	10
Inserting a spare rechargeable battery into the transmitter's charging compartment .....	10
<b>Using the system components .....</b>	<b>11</b>
Switching the transmitter on .....	11
Switching the stethoset receiver on .....	11
Adjusting the volume .....	11
Adjusting the balance .....	12
Storing and charging the receiver .....	12
<b>Meaning of the LEDs .....</b>	<b>13</b>
LEDs on the transmitter .....	13
<b>Care and maintenance .....</b>	<b>14</b>
Cleaning the system .....	14
Cleaning the ear cushions .....	14
<b>If problems occur... ..</b>	<b>15</b>
<b>Accessories .....</b>	<b>16</b>
<b>Connector assignment .....</b>	<b>16</b>
<b>Specifications .....</b>	<b>17</b>
<b>Manufacturer Declarations .....</b>	<b>19</b>

Thank you for choosing Sennheiser!

We have designed this product to give you reliable operation over many years. Over 70 years of accumulated expertise in the design and manufacture of high-quality electro-acoustic equipment have made Sennheiser a world-leading company in this field.

Please take a few moments to read these instructions carefully, as we want you to enjoy your new Sennheiser products quickly and to the fullest.

# Safety instructions



- Please read this instruction manual carefully and completely before using the devices.
- Make this instruction manual easily accessible to all users at all times. Always include this instruction manual when passing the devices on to third parties.
- Do not use the devices in situations which require special attention (e.g. when performing skilled jobs).
- Always keep the devices dry and do not expose them to extreme temperatures.
- Use the devices with care and set them up in a clean, dust-free environment.
- Varnish or furniture polish may degrade the feet of the transmitter, which could stain your furniture. You should therefore place the transmitter on a non-slip pad to avoid potential staining of furniture.
- The receiver generates stronger permanent magnetic fields that could cause interference with cardiac pacemakers and implanted defibrillators (ICDs).  
Always maintain a **distance of at least 3.94" (10 cm)** between the ends of the earbuds with the ear pads and the cardiac pacemaker or implanted defibrillator.
- This receiver allows you to set higher volumes than conventional headphones. This can cause hearing damage in persons with healthy hearing and especially in children.
- Refer all servicing to qualified service personnel. Servicing is required if the devices have been damaged in any way, such as mains cable or plug damage, liquid has been spilled, objects have fallen inside, the devices have been exposed to rain or moisture, do not operate properly or have been dropped.
- **WARNING:** To reduce the risk of fire or electric shock, do not expose the device and the mains unit to rain or moisture.
- Use only the supplied mains unit.
- Disconnect the mains connector from the wall socket
  - to completely disconnect the device from the mains,
  - during lightning storms or when unused for long periods of time.

- Ensure that the mains unit is:
  - always readily operable and easily accessible,
  - properly plugged into the wall socket,
  - not covered or exposed to direct sunlight for longer periods of time in order to prevent heat accumulation,
  - only operated within the permissible temperature range (see “Specifications” on page 17),
  - not operated near heat sources.











### Safety instructions for the nickel metal hydride batteries





If abused or misused, the Set 50 TV/Set 55 TV's rechargeable battery may leak. In extreme cases, it may even present



- a heat hazard,
- a fire hazard,
- an explosion hazard,
- a smoke or gas hazard.

Please understand that Sennheiser does not accept liability for damage arising from abuse or misuse.

	Keep away from children.		Only charge rechargeable batteries with the charger recommended by Sennheiser.
	Only charge rechargeable batteries at ambient temperatures between 10°C/50°F and 40°C/104°F.		When not using rechargeable batteries for extended periods of time, charge them regularly (about every 3 months).
	Do not expose to moisture.		Observe correct polarity.
	Do not mutilate or dismantle.		Switch rechargeable battery-powered products off after use.
	Do not heat above 70°C/158°F, e.g. do not expose to sunlight or throw into a fire.		Pack/store charged batteries so that the terminals cannot contact each other – danger of shorting out/fire hazard.

	Immediately remove rechargeable batteries from an obviously defective product.		Do not continue to use defective rechargeable batteries.
	Only use rechargeable batteries specified by Sennheiser.		Dispose of rechargeable batteries at special collection points or return it to your specialist dealer.

### Intended use of the system

Intended use includes:

- having read these instructions, especially the chapter "Safety instructions".
- using the system within the operating conditions as described in these instructions.

### Improper use

Improper use means use of the system other than as described in these instructions or under operating conditions which differ from those described in these instructions.



# **The Set 50 TV/Set 55 TV stethoset receiver system**

The Set 50 TV/Set 55 TV is a cordless infra-red stethoset receiver system with which you can adjust the volume of your TV, radio, personal stereo and other hi-fi equipment to suit your individual needs. In addition, the system allows you to move around freely without the constrictions of cables within the room where the transmitter is placed..

The Set 50 TV/Set 55 TV is particularly easy and intuitive to operate. The volume can be adjusted directly on the receiver.

The transmitter has an integrated charging compartment for storing the receiver and simultaneously charging the receiver's rechargeable battery. In addition, a spare rechargeable battery can be charged in the small charging compartment at the side of the transmitter.

## **Set 50 TV: Delivery includes**

Delivery of the Set 50 TV stethoset receiver system includes:

- 1 RI 50 stethoset receiver
- 1 TI 50 transmitter with integrated charging compartment
- 1 BA 151 NiMH rechargeable battery
- 1 mains unit
- 1 connecting cable fitted with two 3.5 mm stereo jack plugs for connection to headphone socket (with one adapter to 1/4" (6.3 mm) jack socket)
- 1 adapter RCA socket (e.g. TB/Aux-Out)
- 1 pair of replacement ear cushions
- 1 Instructions for use

## **Set 55 TV product variant**

The scope of delivery of the Set 55 TV variant is identical to the delivery of the Set 50 TV but includes:

- 1 RI 55 stethoset receiver
- 1 TI 55 transmitter with integrated charging compartment
- 2 BA 151 NiMH rechargeable batteries

# Operating controls



## **A** Receiver (see inside cover)

- ① On/Off/volume control
- ② Compartment for BA 151 rechargeable battery
- ③ Balance control

## **B** Transmitter (see inside cover)

- ④ 3.5 mm stereo jack socket labeled AUDIO INPUT (marked blue) for connection of sound source
- ⑤ DC socket labeled 12 V (marked yellow) for connection of mains unit
- ⑥ Charging compartment for receiver
- ⑦ Charging compartment for spare rechargeable battery

## **B** LED indications (see inside cover)

- ⑧ Charging control LED for spare rechargeable battery 
- ⑨ Charging control LED for receiver rechargeable battery 
- ⑩ Operation indication 

## **C** Connection possibilities (see inside cover)

- ⑪ Connecting cable for headphone socket
- ⑫ Adapter to 1/4" (6.3 mm) jack socket
- ⑬ Adapter (RCA socket)
- ⑭ SCART adapter (optional)
- ⑮ Mains connector

# Putting the system into operation

## Setting up the transmitter

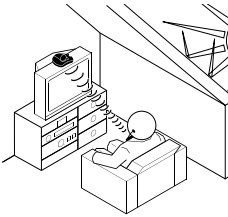

- ▶ Place the transmitter so that there are no obstacles in the light path between transmitter and receiver.

### Note:



Avoid exposure to direct sunlight. Direct sunlight may interfere with the reception and may damage the transmitter.

If you use a plasma TV screen, please observe the following to ensure interference-free reception:

- Make sure that the transmitter's infrared light beam is pointed directly at the receiver and that the light path between transmitter and receiver is not obstructed.
- If necessary, use a standard extension cable (3.5 mm stereo jack plug) to reduce the distance between transmitter and receiver. This extension cable is available from your Sennheiser dealer.

## Connecting the transmitter to the sound source

- ▶ Plug in one end of the connecting cable 11 to the blue AUDIO INPUT socket 4 on the transmitter.
- ▶ Check the connection possibilities of your sound source (e.g. TV).

A	B	C	D
<b>TV</b> 	<b>TV</b> L  R	<b>AV</b> 	No socket
Headphone socket	RCA sockets	SCART socket	External microphone

### A Connecting the transmitter via the headphone socket

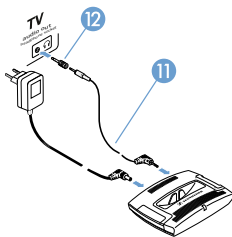

- ▶ Plug in the other end of the connecting cable 11 to the headphone socket on your sound source.
- ▶ Adjust the volume of the headphone socket on your sound source to a medium level. This improves the quality of cordless sound transmission.  
If necessary, check the menu setting of your TV.

#### Note:

With most TVs, the headphone socket is located at the front or sides. Depending on the socket, you may have to use the adapter 12.

In order to prevent damage to hearing, newer TVs often have a function that mutes the TV sound as soon as headphones are connected.

- ▶ If another person wants to listen to the TV sound via the loudspeaker, deactivate the muting function via the TV menu setting.

## B Connecting the transmitter via the RCA sockets

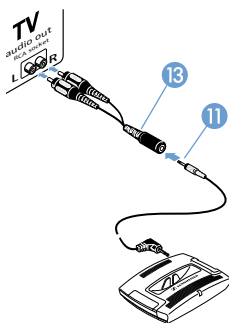

- ▶ Connect the connecting cable 11 to the adapter (RCA socket) 13.
- ▶ Connect the red and white RCA connectors of the adapter 13 to the matching red and white RCA sockets on your sound source.

### Note:

With most TVs, the RCA sockets are located at the rear.

## C Connecting the transmitter via the SCART socket

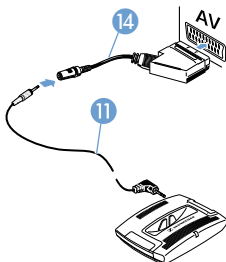

If your sound source has a SCART socket, you can order the suitable SCART adapter (see "Accessories" on page 16) from your Sennheiser dealer.

- ▶ Connect the connecting cable 11 to the SCART adapter 14.
- ▶ Plug in the SCART adapter 14 to the SCART socket on your TV. If your TV has several SCART sockets, select a SCART socket that is also an output (for details, see operating manual of your TV).

## D Using an external microphone

If your sound source doesn't have a headphone or audio output, SCART or RCA socket, you can use your system together with an external microphone (see "Accessories" on page 16).

- ▶ Connect the microphone to the blue socket AUDIO INPUT 4 on the transmitter.
- ▶ Position the microphone in front of the loudspeaker of your sound source. You can change the sound by varying the position of the microphone in front of the loudspeaker.

## Connecting the transmitter to the mains

- ▶ Connect the mains unit to the yellow socket (12 V<sub>DC</sub>) ⑤ on the transmitter.



- ▶ Plug the mains connector into a wall socket.  
The LED ⑩ lights up green. If the receiver is stored in the transmitter's charging compartment ⑥, the LED ⑩ goes off.

### Note:

Pull the mains connector out of the wall socket when the transmitter will not be used for extended periods of time (e.g. when you are on holiday). In this case, however, the rechargeable battery will not be recharged.

## Inserting and removing the receiver's rechargeable battery

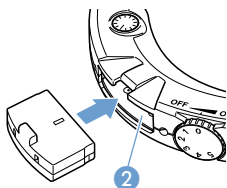

- ▶ Insert the battery into the compartment ② as shown on the left. Make sure that the battery is inserted correctly.
- ▶ To remove the battery, use the finger catch projection to pull the battery out of the receiver.

### Note:

- The receiver is delivered with the battery inserted.
- Charge the battery for at least 3 hours before you use it for the first time (see "Storing and charging the receiver" on page 12).



## Inserting a spare rechargeable battery into the transmitter's charging compartment

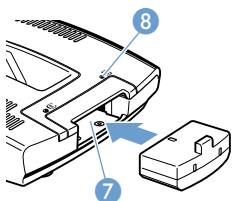

You can charge a spare battery (not included in the delivery of the Set 50 TV) in the charging compartment ⑦ at the side of the transmitter. This spare battery is not required for operating the Set 50 TV/Set 55 TV but offers extended listening time while the discharged first battery is being recharged.

- ▶ Insert the spare battery into the charging compartment ⑦ as shown on the left.



- ▶ If the rechargeable battery is inserted correctly, the LED ⑧ lights up red. The red LED ⑧ does **not** go off when the battery is fully charged.

# Using the system components

## Switching the transmitter on

- ▶ Take the stethoset receiver out of the transmitter's charging compartment **6**. The transmitter automatically switches on. The LED **10** lights up green.

### Note:

If the receiver is placed into the transmitter's charging compartment **6**, the transmitter automatically switches off. The LED **10** goes off.

## Switching the stethoset receiver on

---

### Attention! Volume up? - No!



When people use headphones, they tend to choose a higher volume than with loudspeakers. Listening at high volume levels for long periods can lead to permanent hearing defects. Please protect your hearing, Sennheiser headphones also sound exceptionally good at low volumes.

---

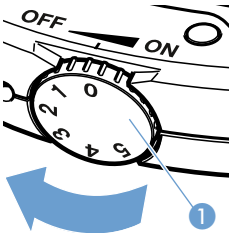

- ▶ Turn the volume control **1** in the direction of the arrow until it clicks.
- ▶ Before putting the receiver on, use the volume control **1** to adjust the volume to a low level. This protects your hearing from damage.
- ▶ Put the receiver on the correct way round, with the Sennheiser logo at the front.

## Adjusting the volume

- ▶ If the transmitter is connected to a headphones socket of your sound source:  
Adjust the volume of the sound source to a medium level. This improves the quality of cordless sound transmission.
- ▶ Use the volume control **1** to adjust the volume to a sufficient and comfortable level.

## Adjusting the balance

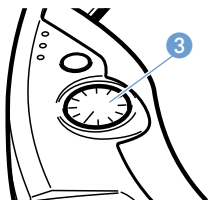

The Set 50 TV/Set 55 TV features a balance control for right/left volume adjustment.

- ▶ Use the balance control 3 to adjust the volume so that you hear equally well with both ears.

## Storing and charging the receiver

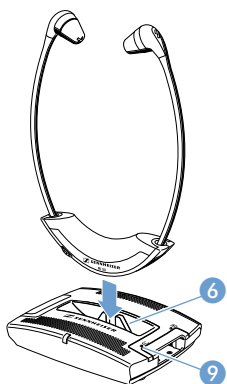

Do not store your receiver on a glass dummy head, chair armrest, or similar for long periods of time as this can reduce the contact pressure of the earbuds.

- ▶ To switch the receiver off, turn the volume control 1 backwards until it clicks.
- ▶ After use, place the receiver into the transmitter's charging compartment 6 as shown on the left, without exerting too much pressure. The transmitter automatically switches off.
- ▶  If the receiver is placed correctly into the charging compartment, the LED 9 lights up red and the battery is being charged. The red LED 9 does not go off when the battery is fully charged.
- ▶ Charge the battery for at least 14 hours before you use it for the first time. With a fully charged battery, the operating time is approx. 9 hours.



### Note:

Always store the receiver in the transmitter's charging compartment 6 to ensure that it is fully charged. The intelligent battery charging technology prevents over-charging.



# Meaning of the LEDs

## LEDs on the transmitter

LED		Status	Meaning
	Operation indication 10	lit green	The transmitter is switched on. The receiver is not stored in the transmitter's charging compartment 6.
		off	The transmitter is switched off. The receiver is stored in the transmitter's charging compartment 6.
	Charging control LED of spare rechargeable battery 8	lit red	Spare rechargeable battery or rechargeable battery is being charged
	Charging control LED of receiver rechargeable battery 9		

# Care and maintenance

## Cleaning the system

---

**Attention!** Liquids can damage the electronics of the units!



Liquids entering the housing of the units can cause a short-circuit and damage the electronics.

- ▶ Keep all liquids far away from the units.
- 

- ▶ Before cleaning, disconnect the transmitter from the mains.
- ▶ Only use a slightly damp cloth to clean the units. Do not use any cleansing agents or solvents.

## Cleaning the ear cushions

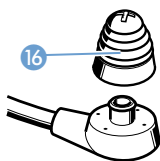

- ▶ Carefully remove the ear cushions 16 from the receiver.
- ▶ Clean the ear cushions 16 with warm soapy water and rinse thoroughly.
- ▶ Dry the ear cushions 16 before putting them back on the receiver.

### Note:

For reasons of hygiene, the ear cushions 16 should be replaced from time to time. Please order the ear cushions from your Sennheiser dealer.

## If problems occur...

► Check if the problem you face is listed in the table below:

Problem	Possible cause	Page
You cannot hear anything	• Are all jack plugs connected correctly?	6 ff
	• Is the transmitter connected to the sound source?	8 ff
	• Is the transmitter connected to the mains?	10
	• Is the volume of the sound source sufficient?	8
	• Is the green operation indication lit?	10
	• Is the volume of the receiver sufficient?	11
	• Is the rechargeable battery fully charged and inserted properly into the receiver?	10
	• Do you wear the receiver the right way round, with the Sennheiser logo at the front?	11
	• Is there a free line of sight between transmitter and receiver?	7
You hear the sound only with one ear	• Is the balance adjusted correctly?	12
The rechargeable battery is not being charged	• Is the receiver switched off during charging?	12

If problems occur that are not listed in the above table or if the problems cannot be solved with the proposed solutions, please contact your local Sennheiser agent for assistance.

## Accessories

**Attention!** Components from other manufacturers (e.g. for power supply or rechargeable battery) may cause damage to the unit and will invalidate the warranty.



► Only use original Sennheiser accessories and spare parts.

The following accessories are available from your authorized Sennheiser dealer:

BA 151 spare rechargeable battery Cat. No. 004146

Ear cushions (normal), 5 pairs Cat. No. 517625

Ear cushions (lamellar form), 5 pairs Cat. No. 517626

SCART adapter Cat. No. 077798

3 m extension cable Cat. No. 517627  
(3.5 mm stereo jack plug)

MKE 800 TV-N Cat. No. 500974  
external microphone (mono)

## Connector assignment

The blue socket AUDIO INPUT ④ is designed for use with two different connector types (Line/Mic). The connector type used is identified automatically.

3.5 mm 3-pole jack/standard stereo

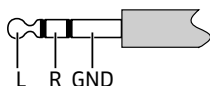

3.5 mm 4-pole jack/microphone with additional power supply

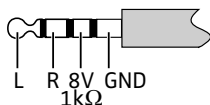

# Specifications

## System

Modulation	FM mono
Carrier frequencies	2.3 MHz
Range	approx 12 m within a room
AF frequency response	50 Hz–12 kHz
THD	< 1 %

## Transmitter

Audio /microphone connection	3.5 mm stereo jack socket
Charging time of rechargeable battery	approx. 14 hours
Power supply	12 V <sub>DC</sub> /200 mA via NT 12-2A mains unit
Weight	approx. 90 g
Dimensions	approx. 95 x 130 x 30 mm

## Receiver

Max. SPL	120 dB (SPL)
Power supply	via BA 151 NiMH rechargeable battery (2.4 V / 80 mAh)
Operating time	approx. 9 hours
Weight	approx. 55 g
Dimensions	approx. 200 x 150 x 20 mm

## NT 12-2A plug-in power supply unit

Nominal input voltage	100–240 V~
Input current	max. 50 mA @ 240 V/50 Hz, full load
Mains frequency	50–60 Hz
Nominal output voltage	12 V DC
Nominal output current	max. 250 mA
Stand-by power consumption	≤ 0.3 W
Energy efficiency	DOE Level VI
Temperature range	Operation: 0°C to +40°C
Relative humidity	Operation: max. 80%, non condensing

### NT 12-2A plug-in power supply unit in accordance with

Europe	EMC: EN 55013, EN 55020 Safety: EN 60950-1
USA	EMC: 47CFR15_B Safety: UL 60950-1
Canada	EMC: ICES-003 Safety: CAN/CSA-C22.2 NO. 60950-1

The NT 12-2A plug-in power supply unit is certified in accordance with the safety requirements of legislation in Europe, the US and Canada.

# Manufacturer Declarations

## Warranty

Sennheiser electronic GmbH & Co. KG gives a warranty of 24 months on this product.

For the current warranty conditions, please visit our website at [www.sennheiser.com](http://www.sennheiser.com) or contact your Sennheiser partner.

## In compliance with the following requirements:

- WEEE Directive (2012/19/EU)



Please dispose of this product by taking it to your local collection point or recycling centre for such equipment.

- Battery Directive (2006/66/EG & 2013/56/EU)



The supplied rechargeable battery can be recycled. Please dispose of it as special waste or return it to your specialist dealer. In order to protect the environment, only dispose of exhausted batteries.

## CE Declaration of Conformity

- EMC Directive (2012/19/EU)
- RoHS Directive (2011/65/EU)
- Low Voltage Directive (2014/35/EU)
- ErP Directive (2009/125/EC)

The declaration is available at [www.sennheiser.com/download](http://www.sennheiser.com/download). Before putting the devices into operation, please observe the respective country-specific regulations.

## In compliance with

Europe	CE
Canada	CAN ICES-3 (B)/NMB-3(B)
USA	FC

## Statements regarding FCC and Industry Canada

FCC Declaration of Conformity (DoC)	
	<div> SENNHEISER Model No: Set 50 TV, Set 55 TV</div>
We,	Sennheiser Electronic Corporation One Enterprise Drive • Old Lyme • CT 06371 • USA Tel: +1 (860) 434 9190 Fax: +1 (860) 434 1759
declare the above device comply with the requirements of Federal Communications Commission.	
This device complies with Part 15 of the FCC rules. Operation is subjected to the following two conditions: 1) This device may not cause harmful interference, and 2) This device must accept any interference received, including interference that may cause undesired operation.	
Responsible Party: Markus Warlitz	

This equipment complies with Part 15 of the FCC Rules and with RSS-210 of Industry Canada. Operation is subject to the following two conditions: (1) this equipment may not cause harmful interference, and (2) this equipment must accept any interference received, including interference that may cause undesired operation.

This equipment has been tested and found to comply with the limits for a Class B digital device, pursuant to Part 15 of the FCC Rules. These limits are designed to provide reasonable protection against harmful interference in a residential installation. This equipment generates, uses and can radiate radio frequency energy and, if not installed and used in accordance with the instructions, may cause harmful interference to radio communications. However, there is no guarantee that interference will not occur in a particular installation. If this equipment does cause harmful interference to radio or television reception, which can be determined by turning the equipment off and on, the user is encouraged to try to correct the interference by one or more of the following measures:

- Reorient or relocate the receiving antenna.
- Increase the separation between the equipment and receiver.
- Connect the equipment into an outlet on a circuit different from that to which the receiver is connected.
- Consult the dealer or an experienced radio/TV technician for help.



This class B digital equipment complies with the Canadian ICES-003.

Changes or modifications made to this equipment not expressly approved by Sennheiser electronic Corp. may void the FCC authorization to operate this equipment.

Before putting the equipment into operation, please observe the respective country-specific regulations!



Sennheiser electronic GmbH & Co. KG  
Am Labor 1, 30900 Wedemark, Germany

[www.sennheiser.com](http://www.sennheiser.com)