

JVC

MICRO COMPONENT SYSTEM

UX-G375

—Consists of CA-UXG375 and SP-UXG375

INSTRUCTIONS



Thank you for purchasing a JVC product.

For turning off the demonstration display, see "Canceling the display demonstration".

LVT2110-022A(UW)
0310NYMCRECDT

©2010 Victor Company of Japan, Limited

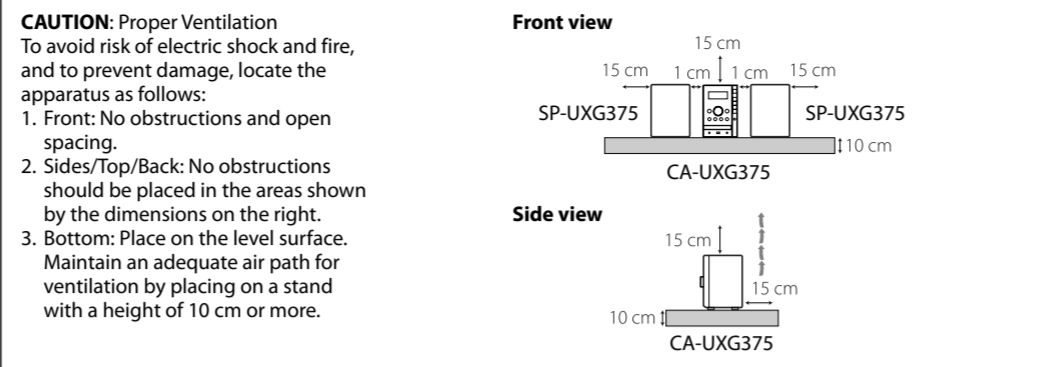

Specifications

Amplifier section		General	
OUTPUT POWER:	60 W (30 W + 30 W) at 6 Ω (10% THD)	Power requirements:	AC 110 V-127 V/AC 220 V-240 V √ adjustable with the voltage selector,
Speakers/Impedance:	6 Ω - 16 Ω		
AUDIO input		Power consumption:	50 Hz/60 Hz 30 W (power on) 1.00 W or less (standby)
AUDIO IN:	500 mV/47 kΩ (at "LEVEL 1") 250 mV/47 kΩ (at "LEVEL 2") 125 mV/47 kΩ (at "LEVEL 3")	Dimensions (W x H x D):	165 mm x 251 mm x 245 mm (W/H/D)
Digital input:	USB MEMORY	Mass:	1.9 kg
Tuner section		Speakers	
FM tuning range:	87.50 MHz - 108.00 MHz	Speaker units:	10 cm cone x 1 6 Ω
AM tuning range:	531 kHz - 1 710 kHz (in 9 kHz spacing) 530 kHz - 1 710 kHz (in 10 kHz spacing)	Impedance:	
		Dimensions (approx.):	140 mm x 251 mm x 141 mm (W/H/D)
		Mass (approx.):	1.3 kg each

CD player section
Dynamic range: 88 dB
Signal-to-noise ratio: 85 dB
Wow and flutter: Immeasurable

USB section
USB specification: Compatible with USB 2.0 Full Speed
Compatible device: Mass storage class
Compatible file system: FAT16, FAT32
Output power: DC 5 V ≡ 500 mA

Microsoft and Windows Media are either registered trademarks or trademarks of Microsoft Corporation in the United States and/or other countries.

Getting started

Supplied Accessories

- After unpacking, check to be sure that you have all the following items.
- Remote control (x 1):
– RM-SUXG355U (for UX-G375)
 - Lithium coin battery CR2025 (x 1)
– The battery has been installed in the remote control when shipped from the factory.
 - AM loop antenna (x 1)
 - FM antenna (x 1)
 - AC plug adapter (x 1)
- If anything is missing, consult your dealer immediately.

Prepare the Remote Control

When you use the remote control for the first time, pull out the insulation sheet.

To Replace the Battery in the Remote Control

Lithium coin battery (product number: CR2025)

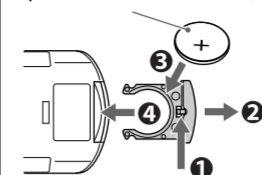

NOTES:

- Store the battery in a place where children cannot reach. If a child accidentally swallows the battery, consult a doctor immediately.
- To prevent the battery from overheating, cracking, or starting a fire:
– Do not recharge, short, disassemble or heat the battery or dispose of it in a fire.
– Do not leave the battery with other metallic materials.
– Wrap the battery with tape and insulate when throwing away or saving it.
– Do not poke the battery with tweezers or similar tools.
- Dispose of battery in the proper manner, according to federal, state, and local regulations.

CAUTION:

Danger of explosion if battery is incorrectly replaced. Replace only with the same or equivalent type.

Connections

Do not connect the AC power cord until all other connections have been made.

NOTES:

- Make sure the antenna conductors do not touch any other terminals, connecting cords and power cord. Also, keep the antennas away from metallic parts of the System, connecting cords, and the AC power cord. This could cause poor reception.
- Make sure both the speakers are connected correctly and firmly.
- When connecting the speaker cords, match the polarity of the speaker terminals: red color to (+) and black color to (-).
- DO NOT connect more than one speaker to each terminal.
- DO NOT allow the conductor of the speaker cords to be in touch with the metallic parts of the System.

To connect the speaker cords

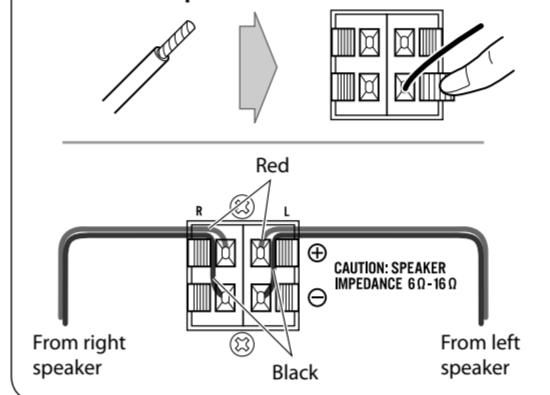

Mains (AC) Line Instruction

CAUTION for mains (AC) line
BEFORE PLUGGING IN, do check that your mains (AC) line voltage corresponds with the position of the voltage selector switch provided on the outside of this equipment and, if different, reset the voltage selector switch, to prevent from a damage or risk of fire/electric shock.

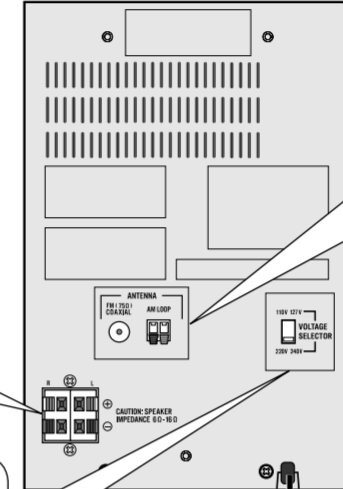

To connect the FM antenna (supplied)
Extend it so that you can obtain the best reception.

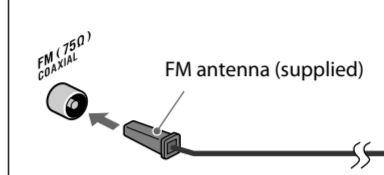

For better FM reception

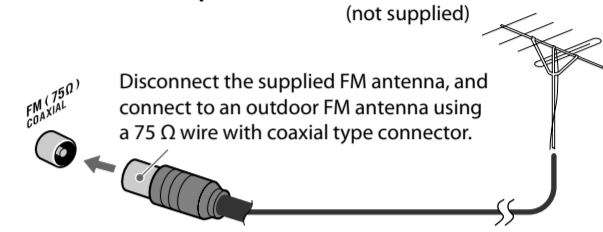

To assemble the AM loop antenna

AM loop antenna (supplied)
Turn it until the best reception is obtained.
NOTE:
Keep the AM loop antenna cable wrapped around the AM loop antenna frame, otherwise the effectiveness and sensitivity of the AM loop antenna may be reduced.

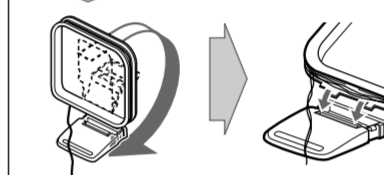

To connect the AM loop antenna (supplied)

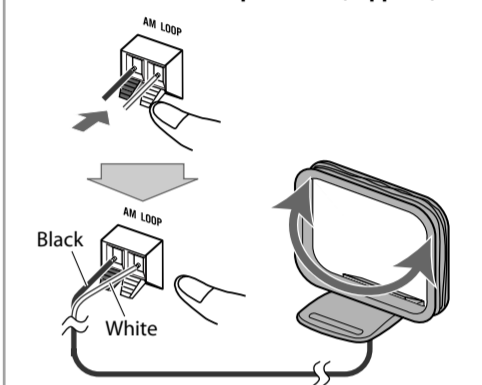

To a wall outlet
Plug the AC power cord only after all connections are complete.

Sound and other adjustments

Initial settings

Canceling the display demonstration

When the System is turned on and no operation is done for about 2 minutes, the display demonstration automatically starts.
To cancel the display demonstration temporarily, press and hold **DEMO** while the System is turned on, until "DEMO OFF" appears.



Setting the clock

Set the built-in clock before using Daily timer or Sleep Timer.

1. Press and hold CLOCK/TIMER.



2. Press SET.



3. Adjust the hour, then the minute.



- To go back to the previous step, press **CANCEL**.
- If you have already adjusted the clock before, perform steps 1 to 3.

Display settings

Dim the display

You can dim the display window and illumination lamp.

While the System is turned on...

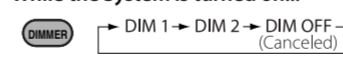

Change the display information

DISPLAY

The display information changes as follows:

- FM/AM: Frequency → Clock
- CD: Current track elapsed time → Clock
- MP3/WMA: Current track elapsed time → ID3 tag → Current group/track → Clock

Sound adjustments

Drop the volume in a moment

FADE MUTE



- To restore the volume, press again, or adjust the volume level.

Emphasize the sound (Sound Turbo)

SOUND TURBO



- The **S.TURBO** indicator lights up.
- To cancel this function, press again.

Reinforce the bass sound (Hyper Bass Sound)

HBS



- The **BASS** indicator lights up.
- When Sound Turbo function is activated (see above), the **BASS** indicator goes off and **HBS** button does not work.
- To cancel this function, press again.

Adjust the tone (Bass/Treble)

Press once for adjusting the bass level; twice for treble level, then, press **VOLUME +/-**.
Adjustable range: -3 to +3.



Timers

Setting the Sleep Timer

Press repeatedly to specify the time (in minutes) as follows:

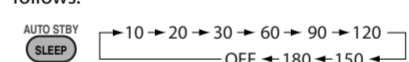

- The **SLEEP** indicator lights up.
- To check the remaining time until the System shuts off, press once.

Turning Off the System Automatically —AUTO STANDBY (only for CD/USB)

Press and hold until the **A.STBY** indicator lights on the display.

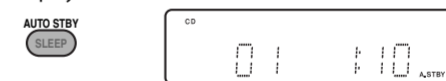

- The **A.STBY** indicator starts flashing after playback stops. If no operation is done for about 3 minutes, the System turns off.
- To cancel this function, press and hold again.

Setting the Daily Timer

Using Daily Timer, you can wake up with your favorite music.

- You can store three Daily Timer settings.
- Tune into a station, place a CD, or connect a USB mass storage class device to the System beforehand.

1. Press CLOCK/TIMER repeatedly to display the desired Daily Timer number (1/2/3 lights up), then press SET during DAILY 1, DAILY 2 or DAILY 3 is displayed.



2. ① Adjust the hour then the minute for on-time. ② Adjust the hour then the minute for off-time. ③ Select the playback source—"CD", "USB", "TUNER FM", or "TUNER AM". ④ Select the volume.



- You can select the volume level—"VOLUME 0" (VOL MIN) to "VOLUME 40" (VOL MAX) and "VOLUME -". If you select "VOLUME -", the volume is set to the last level when the System is turned off.

3. Turn off the System (on standby).

⏻

- When the on-time comes, the System sets the volume gradually to the preset level.

- After you have set the Daily Timer and turn off (standby) the system, the **STANDBY** lamp will start flashing. (While on standby, ⏻ indicator will not be displayed.)
- To exit from the timer setting, press **CANCEL** as required.
- To correct a misentry during the process, press **CANCEL**. You can return to the previous step.

To Turn Off the Daily Timer

Press **CANCEL** when ⏻ "DAILY" is lit up.

NOTE:

The operations are explained using the remote control, unless mentioned otherwise. However, if the System has the same or similar button names, they can also be used for the operations.

Troubleshooting

If you are having a problem with your System, check this list for a possible solution before calling for service.

General	
Power does not turn on.	➔ Power plug is not inserted securely. Plug in securely.
Adjustments or settings are suddenly canceled before you finish.	➔ There is a time limit. Repeat the procedure again.
Operations are disabled.	➔ The built-in microprocessor may malfunction due to external electrical interference. Unplug the AC power cord and then plug it back in.
Unable to operate the System from the remote control.	➔ The path between the remote control and the remote sensor on the System is blocked. ➔ The batteries are exhausted.
No sound is heard.	➔ Speaker connections are incorrect or loose. ➔ Headphones are connected.
Disc/USB Mass Storage Class Device Operations	
The disc/USB mass storage class device does not play.	➔ The disc is placed upside down. Place the disc with the label side up. ➔ The disc is recorded with the "packet writing (UDF file system)". It cannot be played. Check the files you want to play back. ➔ The USB mass storage class device is not connected properly.
MP3/WMA groups and tracks are not played back in order as you expect.	➔ Playing order is determined when the groups and tracks were recorded. It depends on the writing application.
The disc/USB mass storage class device sound is discontinuous.	➔ The disc is scratched or dirty. ➔ MP3/WMA files have not been properly copied into the USB mass storage class device.
Sound from USB mass storage class device is interrupted.	➔ Static electricity may stop the sound. In this case, disconnect and connect the USB mass storage class device again after turning off the System.
The disc tray does not open or close.	➔ The AC power cord is not plugged in. ➔ Disc ejection is prohibited (see page 2).
Radio Operations	
Hard to listen to broadcasts because of noise.	➔ Antennas connections are incorrect or loose. ➔ The AM loop antenna is too close to the System. ➔ The FM antenna is not properly extended and positioned.
Daily Timer Operations	
Daily Timer does not work.	➔ The System has been turned on when the on-time comes. Timer starts working only when the System is turned off. ➔ There might have been a power failure, set the clock first, then the time again.

JVC bears no responsibility for any loss of data in USB mass storage class device while using this System.



Playing Back a Disc/USB Mass Storage Class Device

This System can play back...

- Audio CD.
- CD-R/CD-RW recorded in audio CD format (CD-DA) or recorded MP3/WMA files in ISO 9660 format.
- USB mass storage class device containing MP3/WMA files.
- When playing back an MP3 or WMA track, MP3 or WMA indicator lights up.

Loading a Disc (on the System only)

1. Press to open the disc tray.
2. Press to close the disc tray.

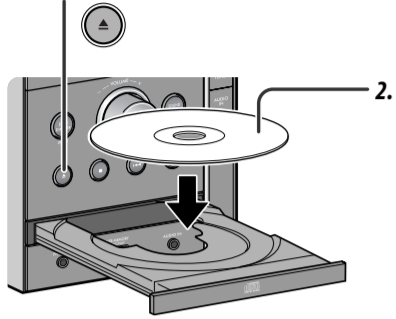

NOTE:
When using an 8 cm disc, place it on the inner circle of the disc tray.

Play back the disc

- Current track number and elapsed playing time appear.
- During playback, press again to pause.

Connecting a USB Mass Storage Class Device

You can connect a USB mass storage class device such as a USB flash memory device, MP3 player, multimedia card reader, etc. to the System.

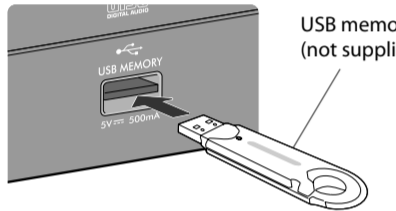

Play back the USB mass storage class device

- Current track number and elapsed playing time appear.
- During playback, press again to pause.

NOTES:

- Always set volume to the minimum level when connecting or disconnecting the USB mass storage class device.
- When connecting with a USB cable, use the USB 2.0 cable whose length is less than 1 m.
- You cannot connect a computer to the USB MEMORY terminal of the System.
- Do not disconnect the USB mass storage class device while playing back a file. It may cause malfunction of both this System and the device.
- Electrostatic shock at connecting a USB device may cause abnormal playback of the device. In this case, disconnect the USB device then reset this unit and the USB device.

Programming the Playing Order—Program Play

1. During stops, press so that the PRGM (program) indicator lights up.
2. Select a track number.
3. Press to program the selected track.

Operations for Program Play (while program stop mode)

- To check the programmed contents, press SET repeatedly.
- To add tracks, repeat steps 2 and 3 above.
- To erase or exit the program, press ■.
- The stored program is not kept.

Playing Repeatedly—Repeat Play

1. Press repeatedly to specify the repeat mode as follows:
 - 1: Repeats the current (or specified) track.
 - : Repeats all tracks in the current group (MP3/WMA only).
 - ALL: Repeats all tracks.
 - No indicator (Off): Normal playback
2. Press or

Stop playback

While playback is stopped, total track number and total playing time (for MP3/WMA files, group number and track number) appear.

RESUME Play
Press RESUME to activate RESUME Play so that the RESUME indicator lights up.
When you stop the playback by one of the following operations, "RESUME" appears and this System stores the beginning of the stopped track on the disc or USB mass storage class device.
- Pressing ■ once
- Changing the source
When you start playback again, playback starts from the beginning of the stopped track.
To clear the memory, open the disc tray, disconnect the USB mass storage class device or press ■ twice.
• When you clear the memory and start playback, playback starts from the first track.
To deactivate RESUME Play, press RESUME again.

Select a track

- ▶▶ Select the next tracks.
- ◀◀ To go back to the beginning of the current or previous tracks.

Select a group (MP3/WMA only)

- UP Select the next groups.
- DOWN Select the previous groups.

Forward search

- ▶▶ Press and hold to fast-forward the track during playback. To stop searching, release the button.
- ▶▶ Press to fast-forward the track during playback. To stop searching, press ▶▶.

Reverse search

- ◀◀ Press and hold to fast-reverse the track during playback. To stop searching, release the button.
- ◀◀ Press to fast-reverse the track during playback. To stop searching, press ▶▶.

NOTES:

- If no disc is inserted or no USB mass storage class device is connected, "NO DISC" or "NO USB" appears on the main display.
- If MP3/WMA files are not recorded on the disc or in the USB mass storage class device, "NO PLAY" or "NO DATA" appears on the main display.

Playing at Random—Random Play

1. Press so that the RND (random) indicator lights up and random play starts.

Operations for Random Play

- To skip a track, press ▶▶.
- To go back to the beginning of the current track, press ◀◀.
- To exit from random play, press RANDOM so that the RND (random) indicator disappears during playback.

Prohibiting Disc Ejection (on the System only)

You can lock the disc tray so that no one can eject the loaded disc while the System is on standby.

Press these buttons for 2 seconds while the System is on standby.

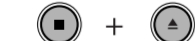

- To cancel the prohibition, repeat the same procedure.

Function of each part

Illustrations shown in this manual depict the UX-G375.

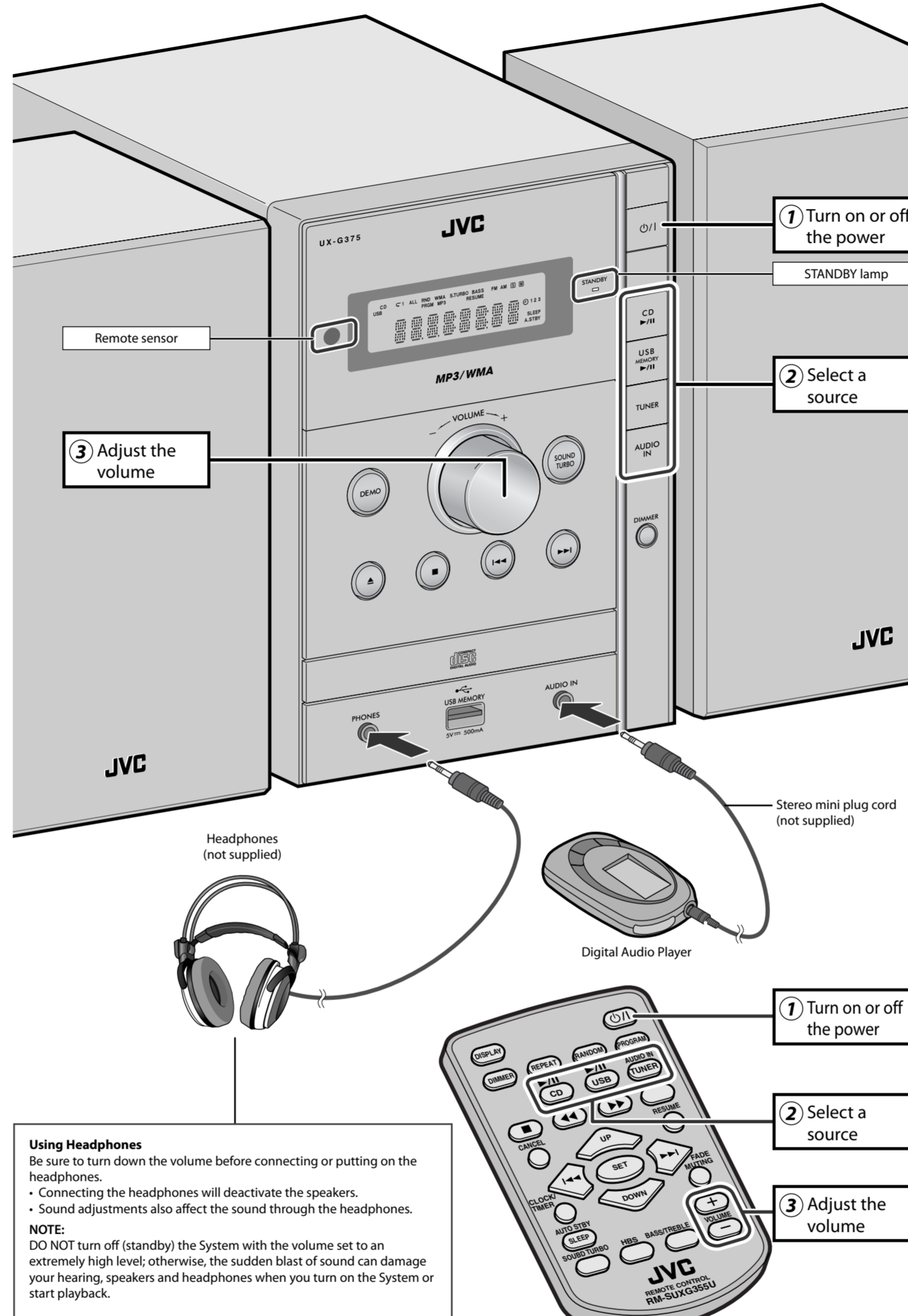

Using Headphones
Be sure to turn down the volume before connecting or putting on the headphones.
• Connecting the headphones will deactivate the speakers.
• Sound adjustments also affect the sound through the headphones.
NOTE:
DO NOT turn off (standby) the System with the volume set to an extremely high level; otherwise, the sudden blast of sound can damage your hearing, speakers and headphones when you turn on the System or start playback.

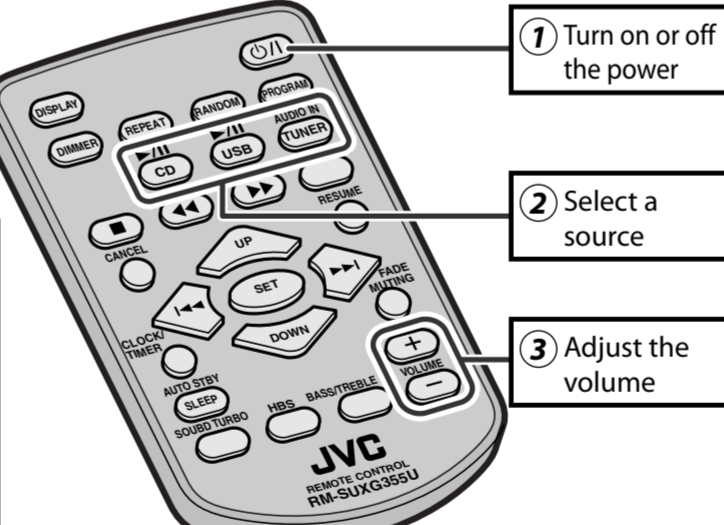

Listening to FM and AM Broadcasts

Basic Tuner Operations

1. Select FM or AM
Press repeatedly until FM band or AM band is selected.
Set the AM tuner intervals to 10 kHz or 9 kHz spacing
On the System only:
When AM band is selected, press and hold ■.
• Each time you press and hold, you can select "9K → 10K" or "10K → 9K".
2. Select a frequency
Press and hold for more than 2 seconds.
The System starts searching for stations and stops when a station of sufficient signal strength is tuned in.
• If an FM program is broadcast in stereo, the (S) (stereo) indicator lights up (only when the reception is good).
• Press during searching to stop.
• Press repeatedly to change the frequency step by step.

Change the FM reception mode (When an FM stereo broadcast is hard to receive)

- Press to improve reception.
- The (M) (mono) indicator lights up.
 - Stereo effect will be lost.
 - To restore the stereo effect, press again.

Presetting Stations

You can preset 30 FM and 15 AM stations manually.

1. Tune in to a station you want to preset.
2. Press to activate the preset number entry mode.

- Finish the following steps while the indication on the display is flashing.
- 3. Press to select a preset number for the station you want to store.
- 4. Press to store the station.

Tune in to a preset station

- Press to select its preset number.



Listening to Other Equipment

1. Turn the volume to minimum.
2. Press repeatedly to select "AUDIO IN".
3. Start playing the connected equipment.
4. Adjust the volume.

To Adjust the Audio Input Level

If the sound from the other equipment connected to the AUDIO IN jack is too loud or too quiet, you can change the audio input level through the AUDIO IN jack (without changing the volume level).
Press and hold for more than 2 seconds while "AUDIO IN" is selected as the source.
You can select one of three levels as follows:
• As the number increases, the sound becomes louder.

Learning More about This System

Basic and Common Operations

- Pressing one of the source buttons also turns on the System and starts playing back if the source is ready or connected.
- Playing Back a Disc/USB Mass Storage Class Device**
 - This System cannot play "packet write" discs.
 - For MP3/WMA playback...
 - In this manual, "file" and "track" are interchangeably used for MP3/WMA operations.
 - MP3/WMA discs are required a longer readout time than regular CDs. (It depends on the complexity of the group/file configuration.)
 - Some MP3/WMA files cannot be played back and will be skipped. This result from their recording processes and conditions.
 - When making MP3/WMA discs, use ISO 9660 Level 1 or Level 2 for the disc format.
 - This System can play back MP3/WMA files with the extension code <.mp3> or <.wma> (regardless of the letter case—upper/lower).
 - It is recommended that you make each MP3/WMA file at a sampling rate of 44.1 kHz and at bit rate of 128 kbps. This System cannot play back files made at bit rate of less than 64 kbps.
 - Playback order of MP3/WMA tracks may be different from the one you have intended while recording. If a folder (group) does not include MP3/WMA tracks, they are ignored.
 - Some characters or symbols will not be shown correctly on the display. The maximum character number shown on the display is 30 for ID3 tag.
 - This System can recognize a total of 999 tracks and 255 groups. Those exceeding the maximum number cannot be recognized.
 - For the USB mass storage class device playback...
 - When connecting a USB mass storage class device, also refer to its manual.
 - Connect one USB mass storage class device directly to the System at a time.
 - This System is compatible with USB 2.0 Full Speed.
 - You cannot play back a file larger than 2 GB.
 - This System may not play back some USB mass storage class devices and does not support DRM (Digital Rights Management).

- Coded or encrypted tracks in a special method cannot be played on the System.
- This System cannot recognize a USB mass storage class device whose rating exceeds 5 V/500 mA.
- When playing a file which has a large transfer rate, sounds may be dropped during playback.
- Some USB mass storage class devices may not be recognized or may not work properly.
- The compatible format is FAT16/FAT32.
- JVC bears no responsibility for any loss of data in the USB mass storage class device while using this System.
- USB mass storage class device is charged through the USB MEMORY terminal when the System is turn on. (Some USB mass storage class device may be charged through the USB terminal only when "USB" is selected as the source.)

Listening to Other Equipment

- If the audio output on the other equipment is not stereo mini plug type, use a plug adapter to convert the stereo mini plug to the corresponding plug of the audio output.
Refer to the manuals supplied with the other equipment.
- Setting the Clock and Using Timers**
 - You can set the clock and Daily Timer while the System is turned on. While setting the clock or Daily Timer, the display is turning on.
 - The clock may gain or lose 1 to 2 minutes per month. If this happens, readjust the clock.
 - When you unplug the AC power cord or if a power failure occurs, the clock and the timer will be canceled. You need to set the clock first, then the timer again.
- Timer Priority:
 - If you activate the Sleep Timer after Daily Timer starts playing the selected source, Daily Timer is canceled.