

03/87

PS 4200

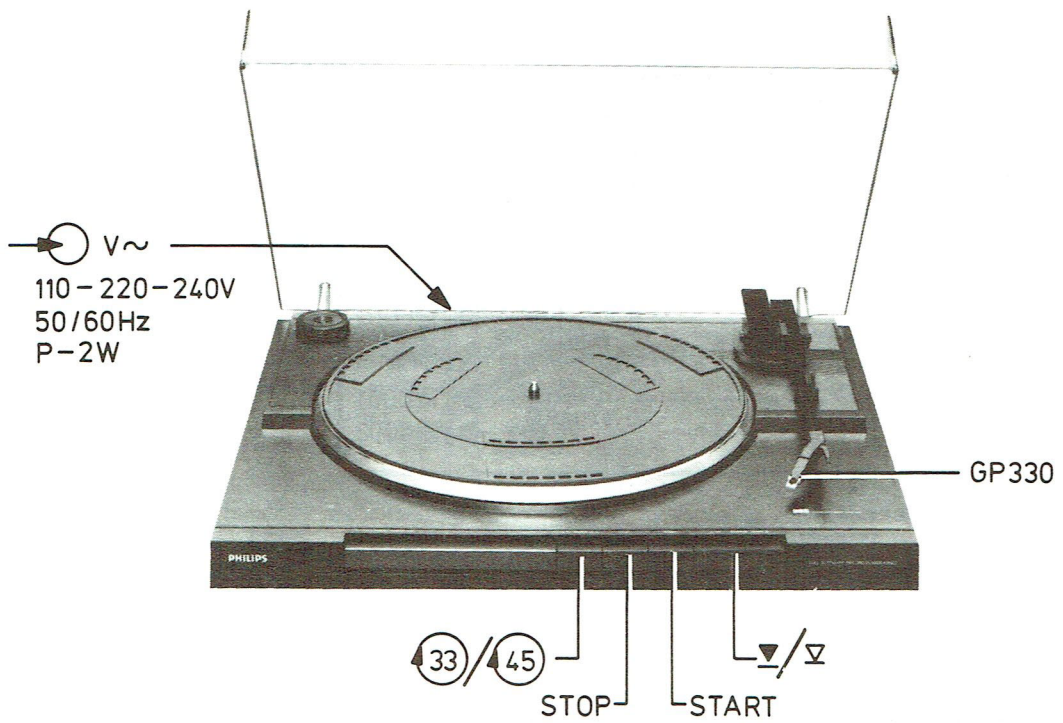

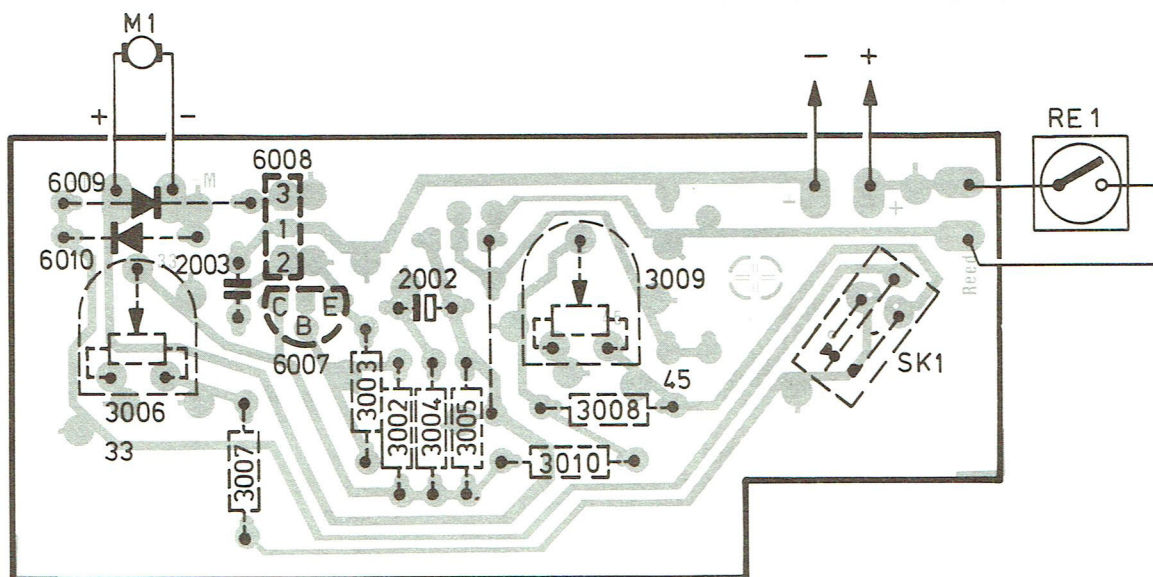

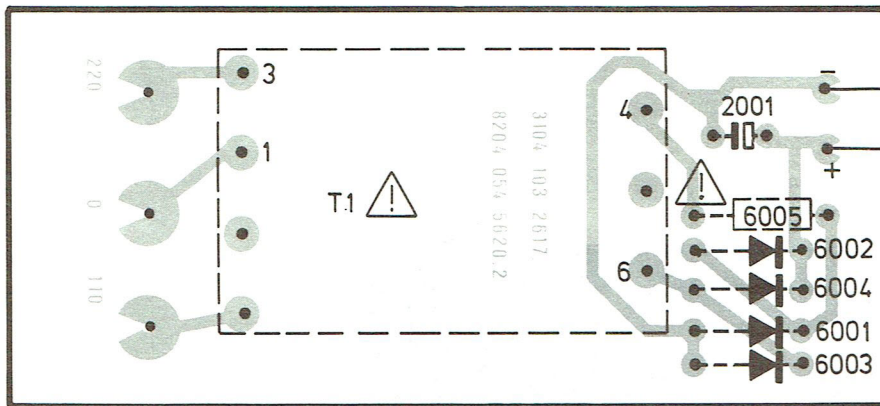
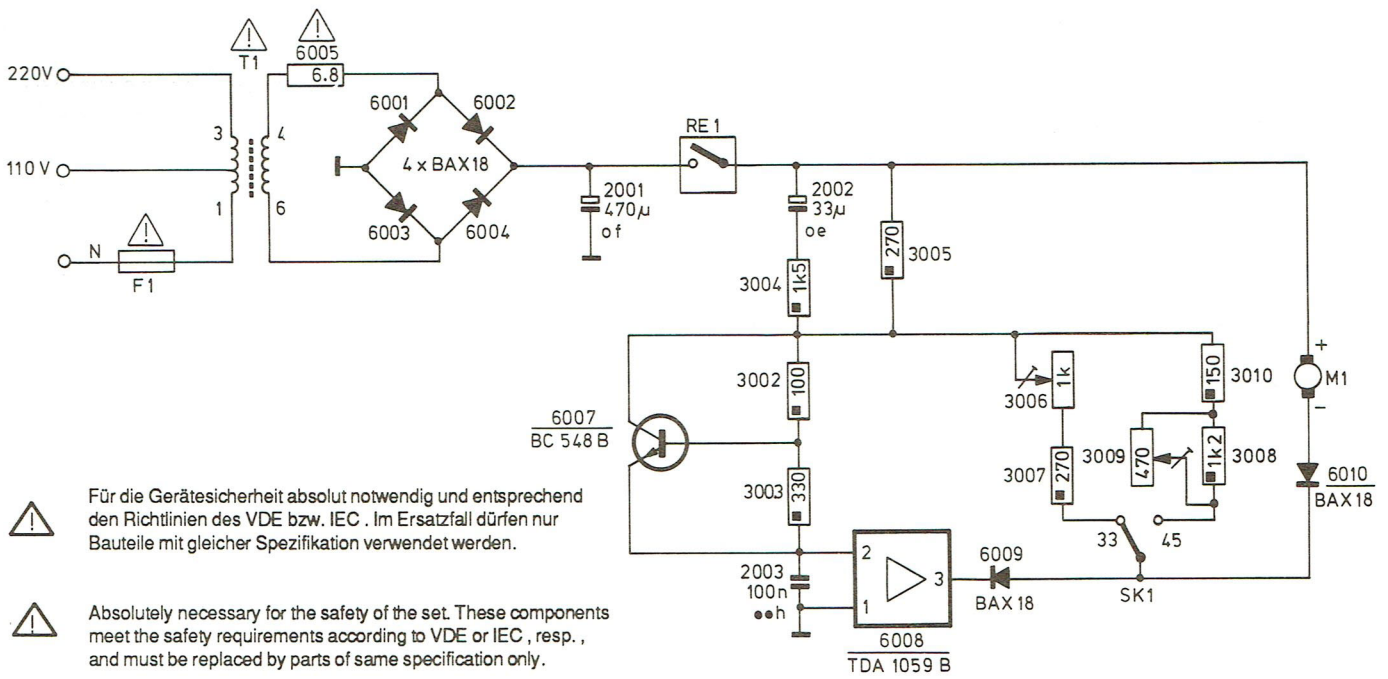
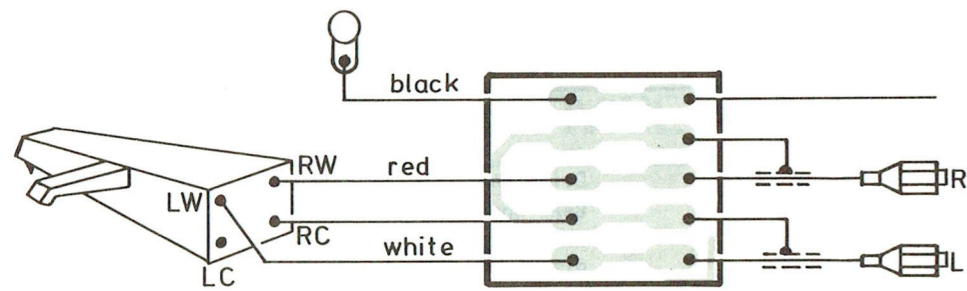

Aufsetzpunkt einstellen

- Geschwindigkeitswahlschalter auf 33 U/min.
- Testplatte auflegen und Starttaste drücken
- Aufsetzpunkt mit Schraube (A) einstellen
- Bei 45 U/min. kontrollieren

Adjustment of touch-down position

- Set the speed selector to 33 rpm.
- Put on the test record and push the start button.
- Adjust the touch-down position with screw (A).
- Check at 45 rpm.

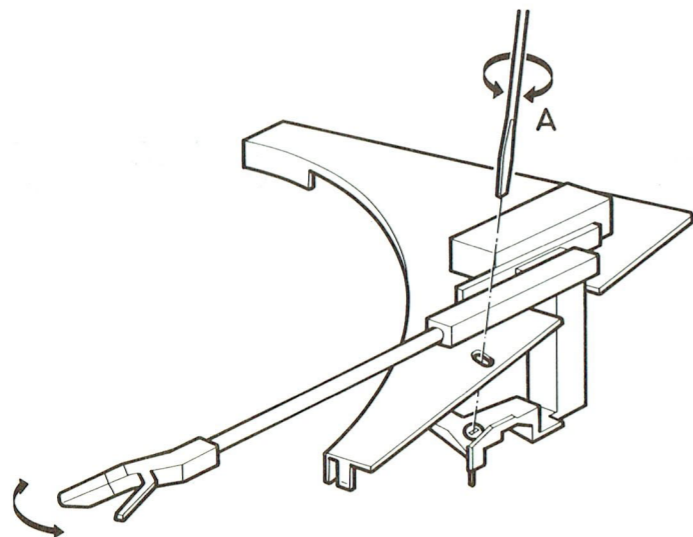

Geschwindigkeit einstellen

- Geschwindigkeitswahlschalter auf 45 U/min. bzw. 33 U/min. stellen
- Mit R 3009 bzw. R 3006 erforderliche Drehzahl einstellen

Speed adjustment

- Set the speed selector to 45rpm and 33rpm, respectively
- Use R 3009 and R 3006 to set the required number of revolutions.

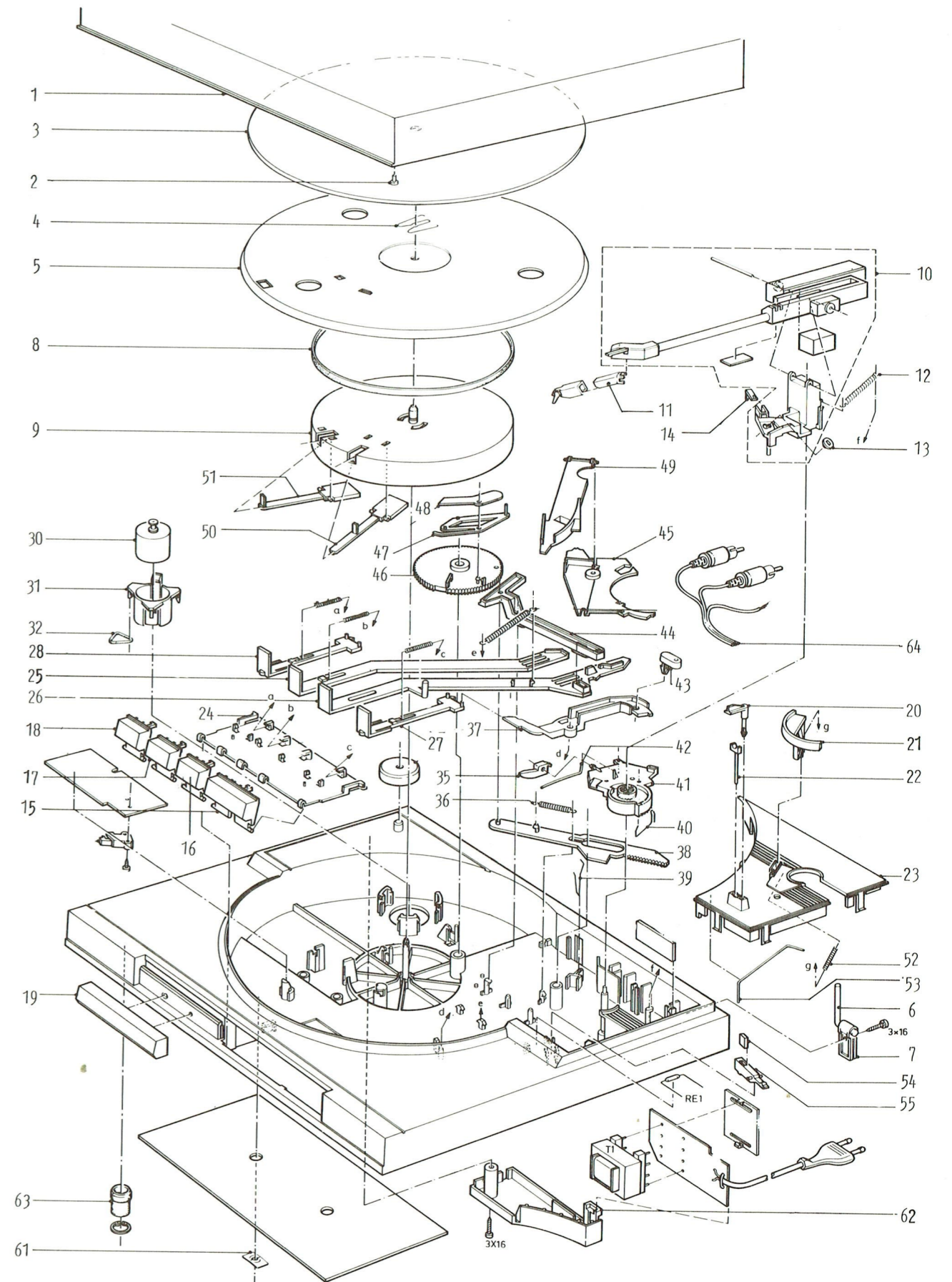

Pos. No.	Fig. No.	Bestell-Nr./Part No. Réf./Nr. d'ordinazioni	Benennung	Description	Désignation	Denominazione
1		75987-393.77	Abdeckhaube	Dust cover	Capot	Coperchio antipolv.
2		75987-393.54	Gummi-Stopsel	Rubber plug	Embout caoutchouc	Tappo di gomma
3		75987-393.53	Gummi-Auflage	Rubber limit	Garniture caoutch.	Rivestim. in gomma
4		75987-393.61	Klemmfeder	Clamping spring	Pince	Molla di fissaggio
5		75987-393.66	Plattenteller	Turntable	Plateau	Piatto
6		75987-393.49	2x Haubenhalter	Lid holder	Support capot	Supporto coperchio
7		75987-393.24	2x Befestigung/Halter	Fixing support	Fixiation/Support	Fissaggio/Supporto
8		75987-393.21	Riemen	Belt	Couroie	Cinghia
9		75987-393.64	Antriebsscheibe	Drive disc	Poulie/volant	Puleggia
10		75987-393.16	Tonarm kpl.	Tone arm cpl.	Levier de son	Brancio(pick up)
11		75987-393.15	TA-System	Cartridge	Cellule	Testina
12		75987-393.56	Stab	Bar	Tige	Bastoncino
13		75987-393.28	Schraube-Bolzen	Screw-Bolt	Vis-Goujon	Vita-Perno
14		75987-393.27	Zwischenstück	Intermediate piece	Piece intermedia.	Pezzo intermedio
15		75987-393.44	Taste	Push button	Touche	Tasto
16		75987-393.45	Taste	Push button	Touche	Tasto
17		75987-393.46	Taste	Push button	Touche	Tasto
18		75987-393.47	Taste	Push button	Touche	Tasto
19		75987-393.48	Taste	Push button	Touche	Tasto
20		75987-393.23	Liftbühne-Führung	Tonearmlift guide	Guide plat.leve br.	Guida disp. sollevabrac
21		75987-393.38	Liftbühne	Tonearm support	Guide plateau	Guida dispos.
22		75987-393.30	Hebel	Lever	Levier	Leva
23		75987-393.50	Abdeckung(TA-Montage)	Cover (TA-mounting)	Recouvrement	Copertura
24		75987-393.51	Tasthalter	Keyboard holder	Support touche	Supp. tasto
25		75987-393.26	Schieber/Stop	Slider/stop	Poussoir/stop	Cursore/stop
26		75987-393.42	Schieber/Start	Slider/start	Poussoir/depart	Cursore/start
27		75987-393.39	Schieber/Lift	Slider	Poussoir	Cursore
28		75987-393.71	Schieber/Geschw.	Slider/speed	Poussoir/vitesse	Cursore/velocita
30		75987-393.22	Motor	Motor	Moteur	Motore
31		75987-393.17	Motorhalter	Motor holder	Support moteur	Supporto motore
32		75987-393.67	Gummidämpfung	Rubber clamber	Amortisseur	Ammortizzatore in gomma
35		75987-393.25	Hebel	Lever	Levier	Leva
36		75987-393.55	Zugfeder	Tension spring	Ressort a traction	Molla di trazione
37		75987-393.41	Hebel	Lever	Levier	Leva
38		75987-393.62	Schiebehebel	Slide lever	Levier	Leva a slitta
39		75987-393.31	Bügelfeder	Leaf	Ressort	Molla curva
40		75987-393.60	Federbügel	Spring clip	Etrier	Supporto a molla
41		75987-393.65	Rad	Wheel	Galet/pignon	Ruota
42		75987-393.59	Feder	Spring	Ressort	Molla
43		75987-393.40	Kappe	Cap	Chapeau	Cappa
44		75987-393.37	Umlenkhebel	Pivoting lever	Pivot	Leva di rinvio

Pos. No.	Fig. No.	Bestell-Nr./Part No. Réf./Nr. d'ordinazioni	Benennung	Description	Désignation	Denominazione
45		75987-393.32	Umlenkplatte	Guide board	Plaquette de renvoi	Piastra di rinvio
46		75987-393.63	Zahnrad	Gear wheel	Roue dentee	Ruota dentata
47		75987-393.78	Umlenkung	Reversing	Piece de renvoi	Rinvio
48		75987-393.36	Platte	Plate	Plaque	Piastra
49		75987-393.33	Hebel/Platte	Lever/Plate	Levier/Plaque	Leva/Piastra
50		75987-393.34	Schieber	Slider	Poussoir	Cursore
51		75987-393.35	Schieber	Slider	Poussoir	Cursore
52		75987-393.58	Zugfeder	Tension spring	Ress. a traction	Molla di trazione
53		75987-393.69	Metallbügel	Metalbow	Etrier metal	Staffa di metallo
54		75987-393.74	Magnet	Solenoid	Aimant	Magnete
55		75987-393.29	Hebel	Lever	Levier	Leva
56		75987-393.43	Halter	Holder	Fixation	Supporto
57		75987-393.57	Feder	Spring	Ressort	Molla
58		75987-393.58	Zugfeder	Tension spring	Ress. a traction	Molla di trazione
59		75987-393.72	Feder	Spring	Ressort	Molla
60		75987-393.73	Feder	Spring	Ressort	Molla
61		75987-393.68	Metallring	Metal ring	Baque metal	Anello di metallo
62		75987-393.75	Schieber	Slider	Poussoir	Cursore
63		75987-393.52	Fuß	Foot	Pied	Piedino
64		75987-393.20	Anschlußkabel	Connecting cable	Cable de connection	Cavo di collegamento
			<u>Elektrische Teile</u>	<u>Electrical parts</u>	<u>Pieces electriques</u>	<u>Parti elettriche</u>
		75987-393.13	Netztrafo	Mains transformer	Transf. secteur	Trasform.di rete
		75987-393.18	Schalter	Switch	Commutateur	Commutatore

Pos. No.	Fig. No.	Bestell-Nr./Part No. Réf./Nr. d'ordinazioni	Benennung Description Désignation Denominazione	Pos. No.	Fig. No.	Bestell-Nr./Part No. Réf./Nr. d'ordinazioni	Benennung Description Désignation Denominazione
----------	----------	---	---	----------	----------	---	---



RE 1

75987-393.19



IC 6008

75987-393.14

TDA 1059 B



T 6007

8302-202-543

BC 548 B



D 6001

72007-215.00

BAX 18

D 6002

72007-215.00

BAX 18

D 6003

72007-215.00

BAX 18

D 6004

72007-215.00

BAX 18

D 6009

72007-215.00

BAX 18

D 6010

72007-215.00

BAX 18



R 3006

75987-393.11

1 Kohm

R 6005

75987-393.12

6,8 ohm



Si 1

75987-393.70

GRUNDIG
PS 4200