

**haut-parleurs**

**pour enceintes et sonorisation**

***loudspeakers***

***for closed cabinets - sonorisation***

**lautsprecher**

**für geschlossene boxen - beschallung**



**AUDAX**

**45, Avenue Pasteur - 93-MONTREUIL**

**Tél. : 287-50-90 - Telex : AUDAX 22.387 F**

**Catalogue N° 15**



# AUDAX

Haut-Parleurs Spéciaux pour Enceintes Closes  
Special Loudspeakers for Closed Cabinets  
Lautsprecher speziell für geschlossene Boxen

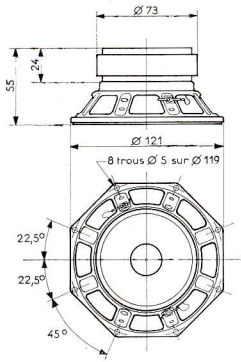

**Puissance nominale 8 W**  
**Fréquence de résonance 60 Hz**  
**Caractéristiques magnétiques :**  
- Induction 12000 G  
- Flux d'induction 37000 M

**Power handling capacity 8 W**  
**Fundamental resonance 60 c/s**  
**Magnetic characteristics :**  
- Flux density 12000 G  
- Total flux 37000 M

**Nennbelastbarkeit 8 W**  
**Eigenresonanz 60 Hz**  
**Magnetische Daten :**  
- Magnetisches Feld 12000 G  
- Magnetischer Fluss 37000 M

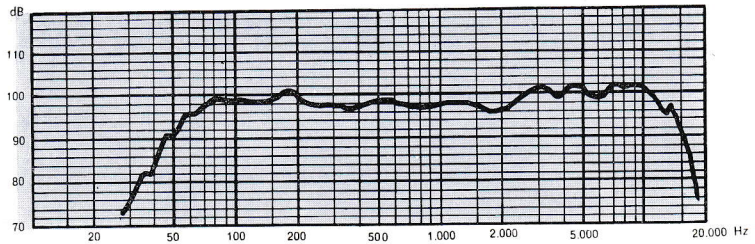

**WFR 12**

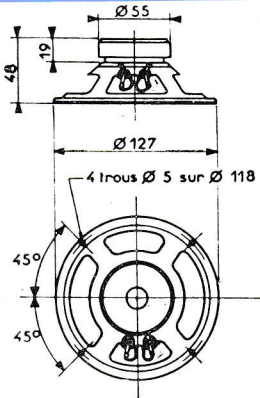

**Puissance nominale 8 W**  
**Fréquence de résonance 50 Hz**  
**Caractéristiques magnétiques :**  
- Induction 10000 G  
- Flux d'induction 25000 M

**Power handling capacity 8 W**  
**Fundamental resonance 50 c/s**  
**Magnetic characteristics :**  
- Flux density 10000 G  
- Total flux 25000 M

**Nennbelastbarkeit 8 W**  
**Eigenresonanz 50 Hz**  
**Magnetische Daten :**  
- Magnetisches Feld 10000 G  
- Magnetischer Fluss 25000 M

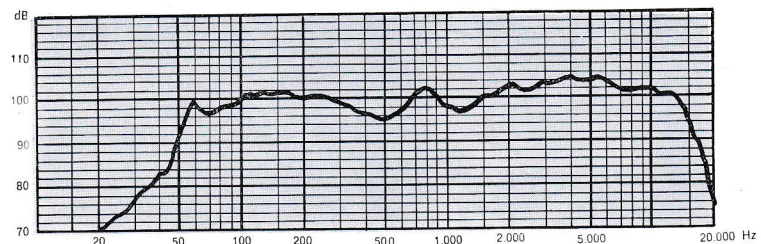

**HIF 12 B**

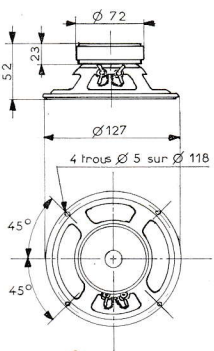

**Puissance nominale 8 W**  
**Fréquence de résonance 50 Hz**  
**Caractéristiques magnétiques :**  
- Induction 13000 G  
- Flux d'induction 35000 M

**Power handling capacity 8 W**  
**Fundamental resonance 50 c/s**  
**Magnetic characteristics :**  
- Flux density 13000 G  
- Total flux 25000 M

**Nennbelastbarkeit 8 W**  
**Eigenresonanz 50 Hz**  
**Magnetische Daten :**  
- Magnetisches Feld 13000 G  
- Magnetischer Fluss 35000 M

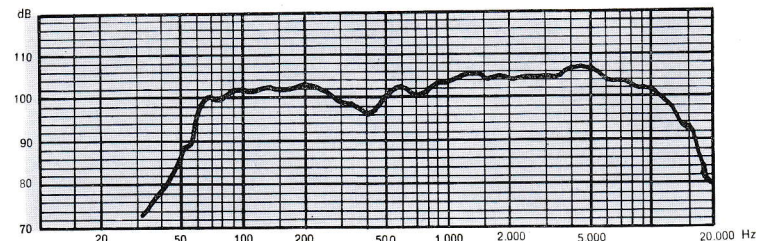

**HIF 12 EB**

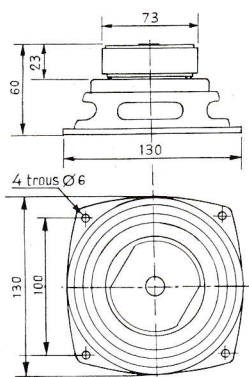

**Puissance nominale 10 W**  
**Fréquence de résonance 37 Hz**  
**Caractéristiques magnétiques :**  
- Induction 13000 G  
- Flux d'induction 35000 M

**Power handling capacity 10 W**  
**Fundamental resonance 37 c/s**  
**Magnetic characteristics :**  
- Flux density 13000 G  
- Total flux 35000 M

**Nennbelastbarkeit 10 W**  
**Eigenresonanz 37 Hz**  
**Magnetische Daten :**  
- Magnetisches Feld 13000 G  
- Magnetischer Fluss 35000 M

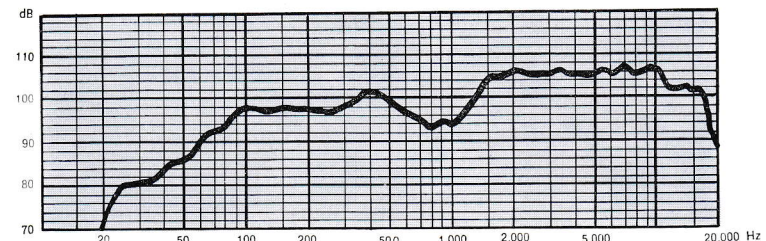

**HIF 13 EB**

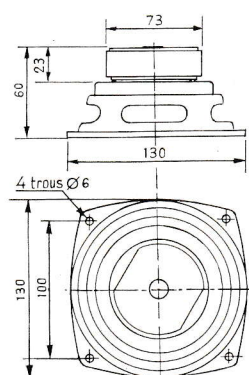

**Puissance nominale 10 W**  
**Fréquence de résonance 37 Hz**  
**Caractéristiques magnétiques :**  
- Induction 10000 G  
- Flux d'induction 30800 M

**Power handling capacity 10 W**  
**Fundamental resonance 37 c/s**  
**Magnetic characteristics :**  
- Flux density 10000 G  
- Total flux 30800 M

**Nennbelastbarkeit 10 W**  
**Eigenresonanz 37 Hz**  
**Magnetische Daten :**  
- Magnetisches Feld 10000 G  
- Magnetischer Fluss 30800 M

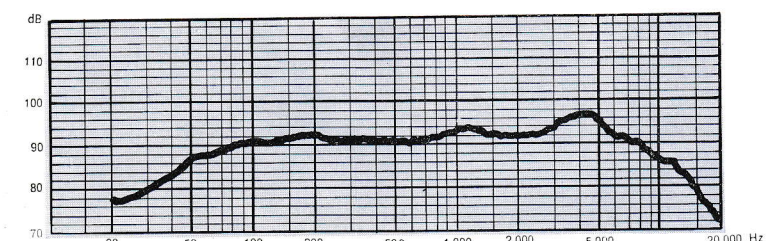

**HIF 13 E**



# AUDAX

Haut-Parleurs Spéciaux pour Enceintes Closes  
Special Loudspeakers for Closed Cabinets  
Lautsprecher speziell für geschlossene Boxen

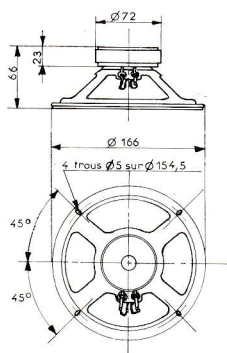

**Puissance nominale 10 W**  
**Fréquence de résonance 50 Hz**  
**Caractéristiques magnétiques :**  
- Induction 10000 G  
- Flux d'induction 30800 M

*Power handling capacity 10 W*  
*Fundamental resonance 50 c/s*  
*Magnetic characteristics :*  
- Flux density 10000 G  
- Total flux 30800 M

**Nennbelastbarkeit 10 W**  
**Eigenresonanz 50 Hz**  
**Magnetische Daten :**  
- Magnetisches Feld 10000 G  
- Magnetischer Fluss 30800 M

**HIF 17 E**

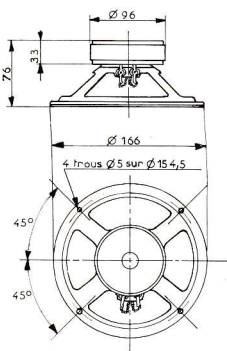
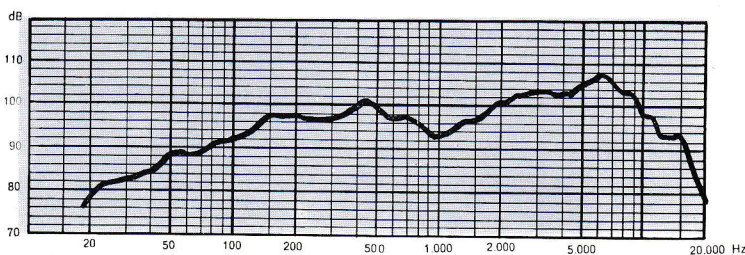

**Puissance nominale 12 W**  
**Fréquence de résonance 40 Hz**  
**Caractéristiques magnétiques :**  
- Induction 14000 G  
- Flux d'induction 44600 M

*Power handling capacity 12 W*  
*Fundamental resonance 40 c/s*  
*Magnetic characteristics :*  
- Flux density 14000 G  
- Total flux 44600 M

**Nennbelastbarkeit 12 W**  
**Eigenresonanz 40 Hz**  
**Magnetische Daten :**  
- Magnetisches Feld 14000 G  
- Magnetischer Fluss 44600 M

**HIF 17 H**

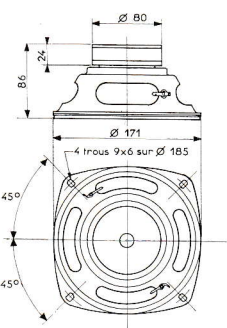
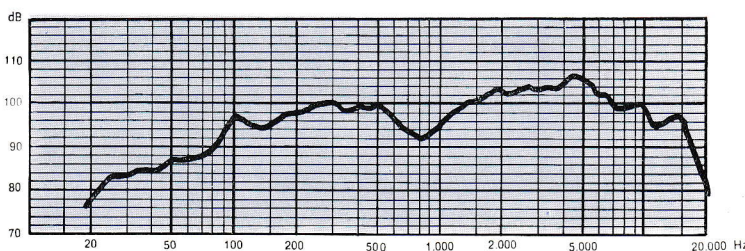

**Puissance nominale 20 W**  
**Fréquence de résonance 35 Hz**  
**Caractéristiques magnétiques :**  
- Induction 12000 G  
- Flux d'induction 44000 M

*Power handling capacity 20 W*  
*Fundamental resonance 35 c/s*  
*Magnetic characteristics :*  
- Flux density 12000 G  
- Total flux 44000 M

**Nennbelastbarkeit 20 W**  
**Eigenresonanz 35 Hz**  
**Magnetische Daten :**  
- Magnetisches Feld 12000 G  
- Magnetischer Fluss 44000 M

**Nouveau  
Modèle**

**HIF 17 JS**

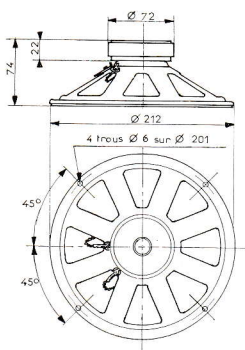
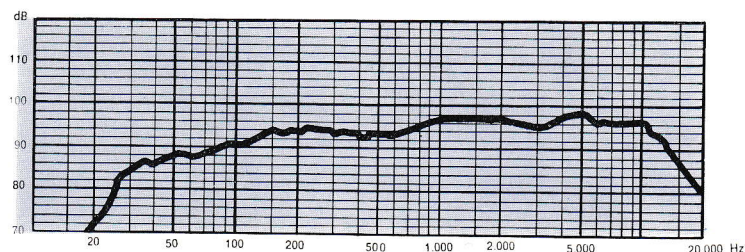

**Puissance nominale 12 W**  
**Fréquence de résonance 37 Hz**  
**Caractéristiques magnétiques :**  
- Induction 10000 G  
- Flux d'induction 57300 M

*Power handling capacity 12 W*  
*Fundamental resonance 37 c/s*  
*Magnetic characteristics :*  
- Flux density 10000 G  
- Total flux 57300 M

**Nennbelastbarkeit 12 W**  
**Eigenresonanz 37 Hz**  
**Magnetische Daten :**  
- Magnetisches Feld 10000 G  
- Magnetischer Fluss 57300 M

**HIF 21 E**

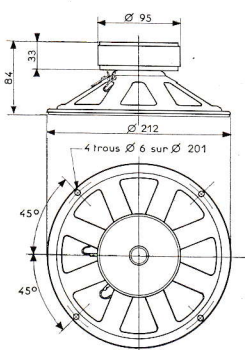
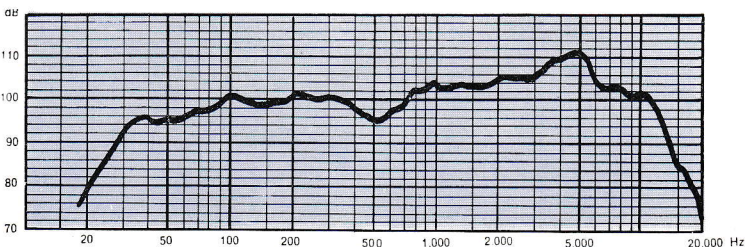

**Puissance nominale 15 W**  
**Fréquence de résonance 37 Hz**  
**Caractéristiques magnétiques :**  
- Induction 14000 G  
- Flux d'induction 66000 M

*Power handling capacity 15 W*  
*Fundamental resonance 37 c/s*  
*Magnetic characteristics :*  
- Flux density 14000 G  
- Total flux 66000 M

**Nennbelastbarkeit 15 W**  
**Eigenresonanz 37 Hz**  
**Magnetische Daten :**  
- Magnetisches Feld 14000 G  
- Magnetischer Fluss 66000 M

**HIF 21 H**

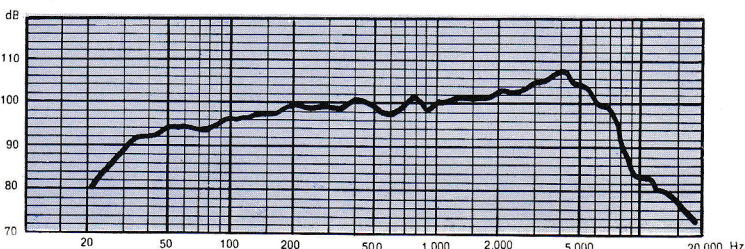



# AUDAX

**Haut-Parleurs Spéciaux pour Enceintes Fermées**  
*Special Loudspeakers for Closed Cabinets*  
**Lautsprecher speziell für geschlossene Boxen**

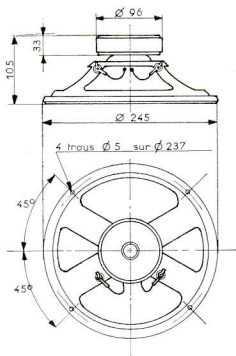

**Puissance nominale 15 W**  
**Fréquence de résonance 35 Hz**  
**Caractéristiques magnétiques :**  
 - Induction 14000 G  
 - Flux d'induction 66000 M

*Power handling capacity 15 W*  
*Fundamental resonance 35 c/s*  
*Magnetic characteristics :*  
 - Flux density 14000 G  
 - Total flux 66000 M

**Nennbelastbarkeit 15 W**  
**Eigenresonanz 35 Hz**  
**Magnetische Daten :**  
 - Magnetisches Feld 14000 G  
 - Magnetischer Fluss 66000 M

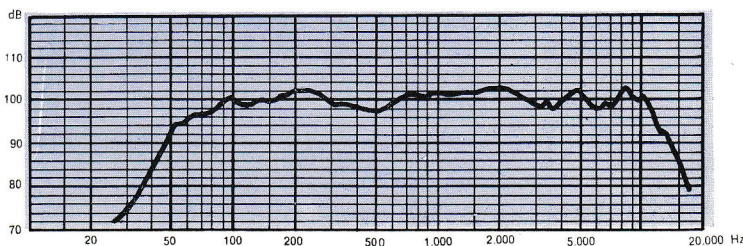

**HIF 24 H**

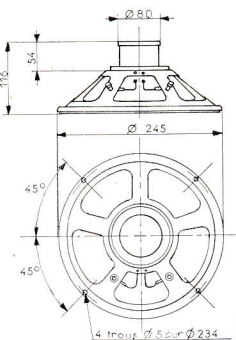

**Puissance nominale 30 W**  
**Fréquence de résonance 24 Hz**  
**Caractéristiques magnétiques :**  
 - Induction 12000 G  
 - Flux d'induction 90000 M

*Power handling capacity 30 W*  
*Fundamental resonance 24 c/s*  
*Magnetic characteristics :*  
 - Flux density 12000 G  
 - Total flux 90000 M

**Nennbelastbarkeit 30 W**  
**Eigenresonanz 24 Hz**  
**Magnetische Daten :**  
 - Magnetisches Feld 12000 G  
 - Magnetischer Fluss 90000 M

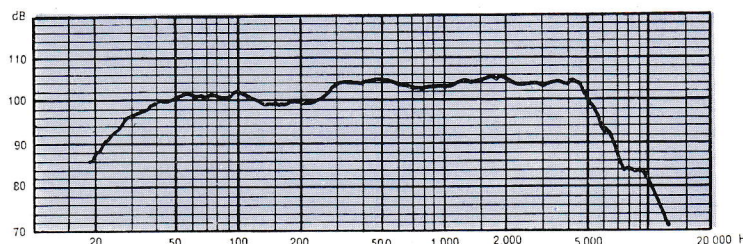

**HIF 24 HS**

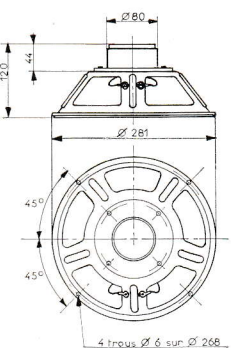

**Puissance nominale 15 W**  
**Fréquence de résonance 28 Hz**  
**Caractéristiques magnétiques :**  
 - Induction 10000 G  
 - Flux d'induction 90000 M

*Power handling capacity 15 W*  
*Fundamental resonance 28 c/s*  
*Magnetic characteristics :*  
 - Flux density 10000 G  
 - Total flux 90000 M

**Nennbelastbarkeit 15 W**  
**Eigenresonanz 28 Hz**  
**Magnetische Daten :**  
 - Magnetisches Feld 10000 G  
 - Magnetischer Fluss 90000 M

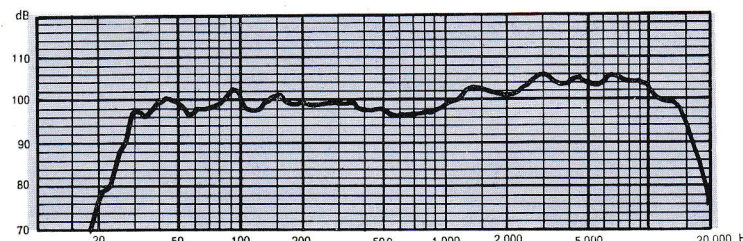

**HIF 28 H**

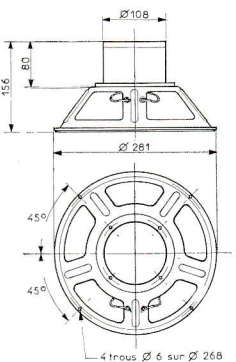

**Puissance nominale 15 W**  
**Fréquence de résonance 28 Hz**  
**Caractéristiques magnétiques :**  
 - Induction 16500 G  
 - Flux d'induction 148000 M

*Power handling capacity 15 W*  
*Fundamental resonance 28 c/s*  
*Magnetic characteristics :*  
 - Flux density 16500 G  
 - Total flux 148000 M

**Nennbelastbarkeit 15 W**  
**Eigenresonanz 28 Hz**  
**Magnetische Daten :**  
 - Magnetisches Feld 16500 G  
 - Magnetischer Fluss 148000 M

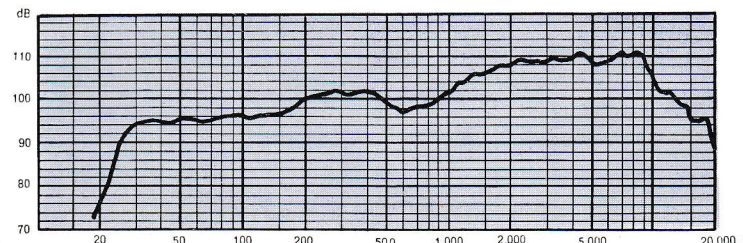

**HIF 28 HA**

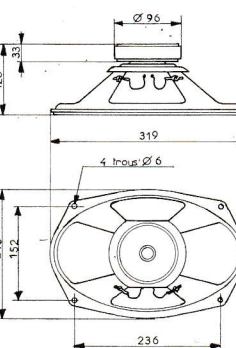

**Puissance nominale 12 W**  
**Fréquence de résonance 30 Hz**  
**Caractéristiques magnétiques :**  
 - Induction 14000 G  
 - Flux d'induction 66000 M

*Power handling capacity 12 W*  
*Fundamental resonance 30 c/s*  
*Magnetic characteristics :*  
 - Flux density 14000 G  
 - Total flux 66000 M

**Nennbelastbarkeit 12 W**  
**Eigenresonanz 30 Hz**  
**Magnetische Daten :**  
 - Magnetisches Feld 14000 G  
 - Magnetischer Fluss 66000 M

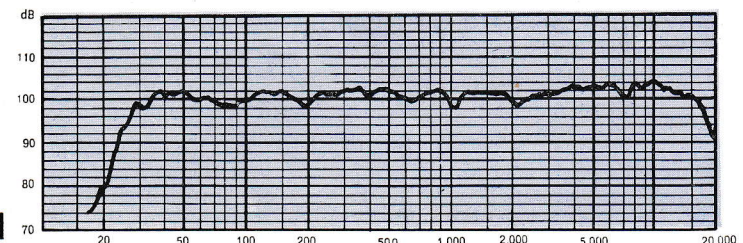

**HIF 21.32 H**



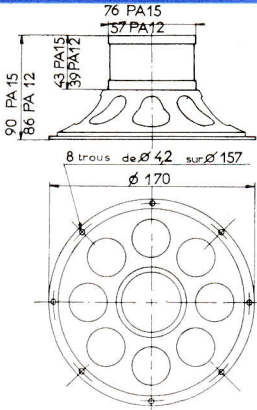

**T 17 PRA 12**

**Puissance nominale 3 W**  
**Fréquence de résonance 80 Hz**  
**Caractéristiques magnétiques :**  
 - Induction 11000 G  
 - Flux d'induction 54000 M

**Power handling capacity 3 W**  
**Fundamental resonance 80 c/s**  
**Magnetic characteristics :**  
 - Flux density 11000 G  
 - Total flux 54000 M

**Nennbelastbarkeit 3 W**  
**Eigenresonanz 80 Hz**  
**Magnetische Daten :**  
 - Magnetisches Feld 11000 G  
 - Magnetischer Fluss 54000 M

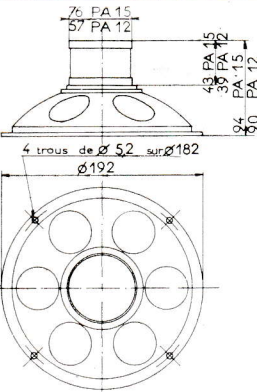
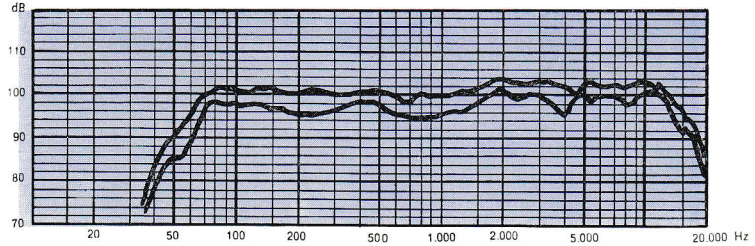

**T 19 PA 15**

**Puissance nominale 5 W**  
**Fréquence de résonance 70 Hz**  
**Caractéristiques magnétiques :**  
 - Induction 13800 G  
 - Flux d'induction 79000 M

**Power handling capacity 5 W**  
**Fundamental resonance 70 c/s**  
**Magnetic characteristics :**  
 - Flux density 13800 G  
 - Total flux 79000 M

**Nennbelastbarkeit 5 W**  
**Eigenresonanz 70 Hz**  
**Magnetische Daten :**  
 - Magnetisches Feld 13800 G  
 - Magnetischer Fluss 79000 M

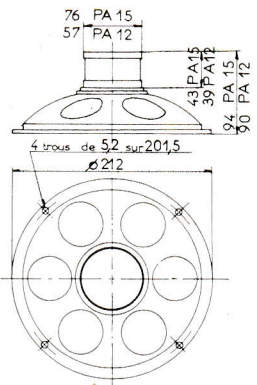
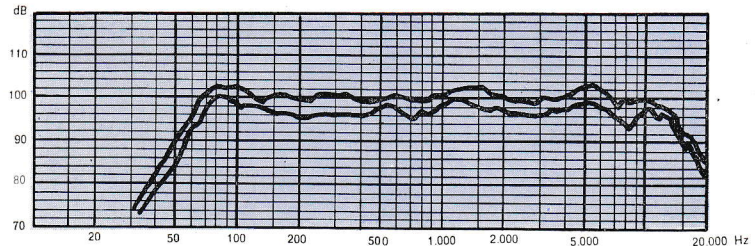

**T 21 PA 12**

**Puissance nominale 5 W**  
**Fréquence de résonance 60 Hz**  
**Caractéristiques magnétiques :**  
 - Induction 11000 G  
 - Flux d'induction 54000 M

**Power handling capacity 5 W**  
**Fundamental resonance 60 c/s**  
**Magnetic characteristics :**  
 - Flux density 11000 G  
 - Total flux 54000 M

**Nennbelastbarkeit 5 W**  
**Eigenresonanz 60 Hz**  
**Magnetische Daten :**  
 - Magnetisches Feld 11000 G  
 - Magnetischer Fluss 54000 M

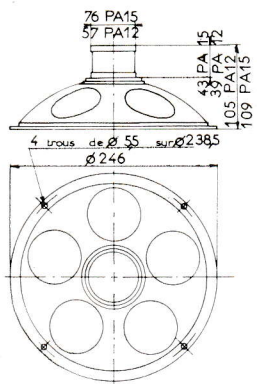
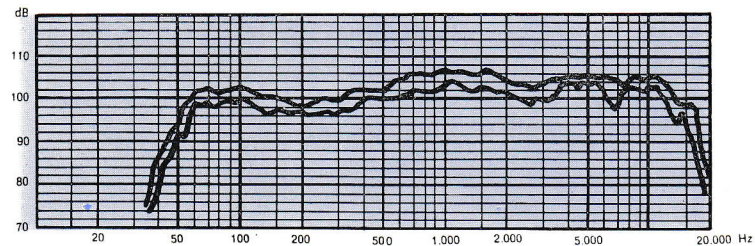

**T 24 PA 15**

**Puissance nominale 9 W**  
**Fréquence de résonance 55 Hz**  
**Caractéristiques magnétiques :**  
 - Induction 13800 G  
 - Flux d'induction 79000 M

**Power handling capacity 9 W**  
**Fundamental resonance 55 c/s**  
**Magnetic characteristics :**  
 - Flux density 13800 G  
 - Total flux 79000 M

**Nennbelastbarkeit 9 W**  
**Eigenresonanz 55 Hz**  
**Magnetische Daten :**  
 - Magnetisches Feld 13800 G  
 - Magnetischer Fluss 79000 M

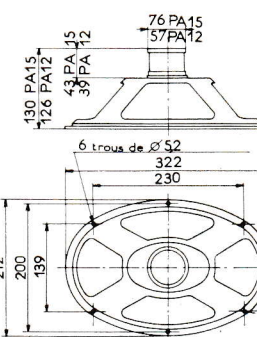
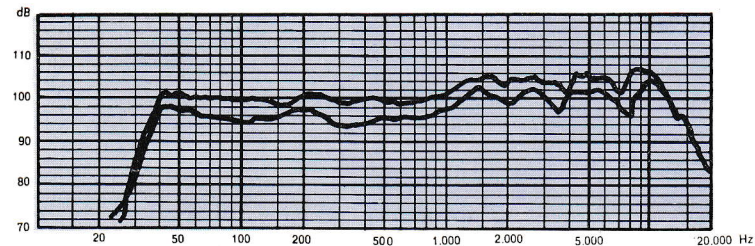

**T 21.32 PA 15**

**Puissance nominale 10 W**  
**Fréquence de résonance 45 Hz**  
**Caractéristiques magnétiques :**  
 - Induction 13800 G  
 - Flux d'induction 79000 M

**Power handling capacity 10 W**  
**Fundamental resonance 45 c/s**  
**Magnetic characteristics :**  
 - Flux density 13800 G  
 - Total flux 79000 M

**Nennbelastbarkeit 10 W**  
**Eigenresonanz 45 Hz**  
**Magnetische Daten :**  
 - Magnetisches Feld 13800 G  
 - Magnetischer Fluss 79000 M

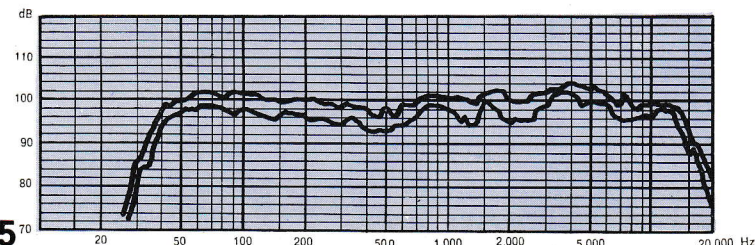



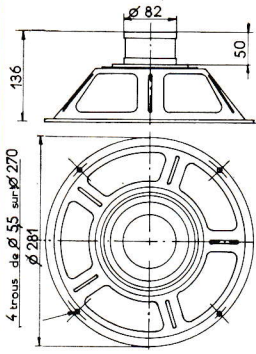

**Puissance nominale 12 W**  
**Fréquence de résonance 35 Hz**  
**Caractéristiques magnétiques :**  
 - Induction 12000 G  
 - Flux d'induction 125000 M

**Power handling capacity 12 W**  
**Fundamental resonance 35 c/s**  
**Magnetic characteristics :**  
 - Flux density 12000 G  
 - Total flux 125000 M

**Nennbelastbarkeit 12 W**  
**Eigenresonanz 35 Hz**  
**Magnetische Daten :**  
 - Magnetisches Feld 12000 G  
 - Magnetischer Fluss 125000 M

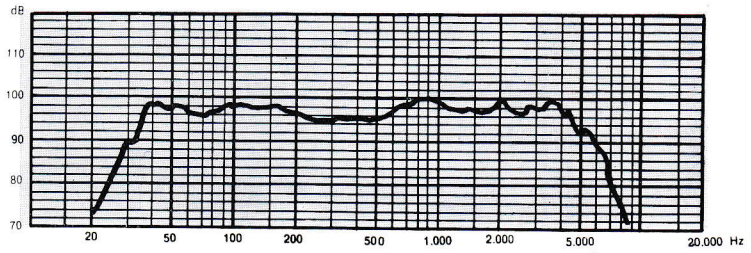

**W FR 15**

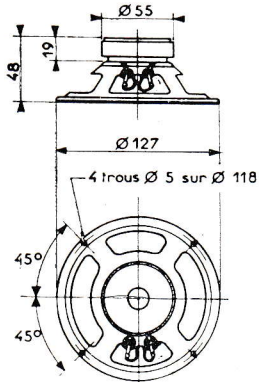

**Puissance nominale 2 W**  
**Fréquence de résonance 150 Hz**  
**Caractéristiques magnétiques :**  
 - Induction 10000 G  
 - Flux d'induction 25000 M

**Power handling capacity 2 W**  
**Fundamental resonance 150 c/s**  
**Magnetic characteristics :**  
 - Flux density 10000 G  
 - Total flux 25000 M

**Nennbelastbarkeit 2 W**  
**Eigenresonanz 150 Hz**  
**Magnetische Daten :**  
 - Magnetisches Feld 10000 G  
 - Magnetischer Fluss 25000 M

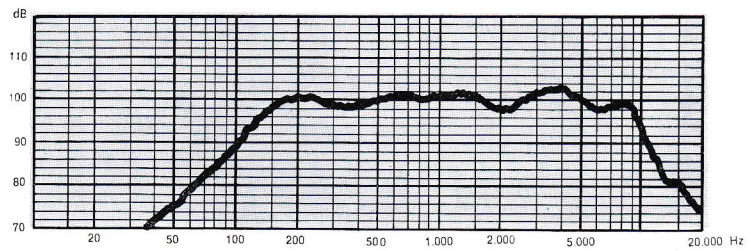

**SON 12 B**

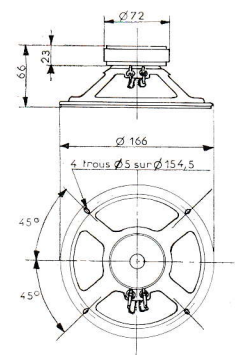

**Puissance nominale 4 W**  
**Fréquence de résonance 120 Hz**  
**Caractéristiques magnétiques :**  
 - Induction 10000 G  
 - Flux d'induction 44000 M

**Power handling capacity 4 W**  
**Fundamental resonance 120 c/s**  
**Magnetic characteristics :**  
 - Flux density 10000 G  
 - Total flux 44000 M

**Nennbelastbarkeit 4 W**  
**Eigenresonanz 120 Hz**  
**Magnetische Daten :**  
 - Magnetisches Feld 10000 G  
 - Magnetischer Fluss 44000 M

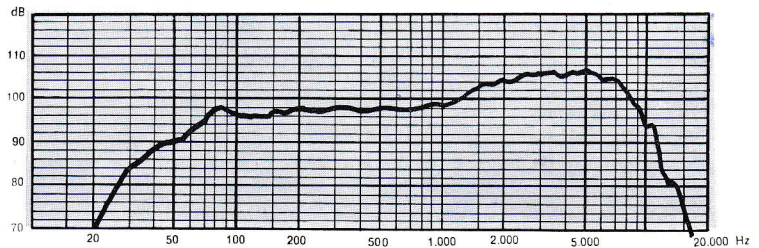

**SON 17 E**

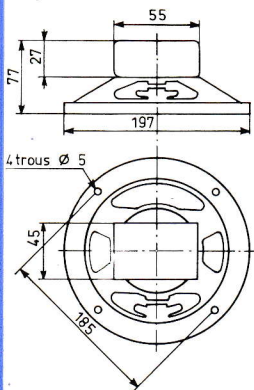

**Puissance nominale 4 W**  
**Fréquence de résonance 90 Hz**  
**Caractéristiques magnétiques :**  
 - Induction 10000 G  
 - Flux d'induction 32000 M

**Power handling capacity 4 W**  
**Fundamental resonance 90 c/s**  
**Magnetic characteristics :**  
 - Flux density 10000 G  
 - Total flux 32000 M

**Nennbelastbarkeit 4 W**  
**Eigenresonanz 90 Hz**  
**Magnetische Daten :**  
 - Magnetisches Feld 10000 G  
 - Magnetischer Fluss 32000 M

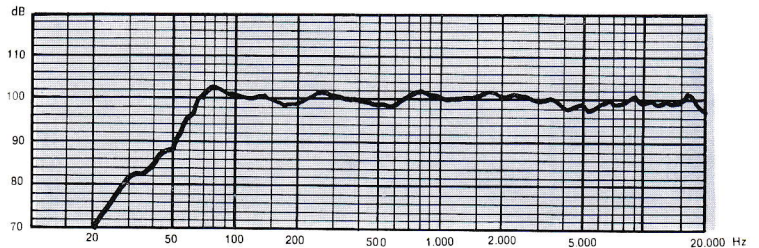

**SON 20 BF BC**

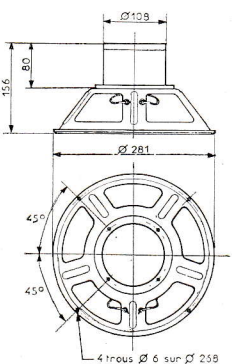

**Puissance nominale 15 W**  
**Fréquence de résonance 45 Hz**  
**Caractéristiques magnétiques :**  
 - Induction 16500 G  
 - Flux d'induction 148000 M

**Power handling capacity 15 W**  
**Fundamental resonance 45 c/s**  
**Magnetic characteristics :**  
 - Flux density 16500 G  
 - Total flux 148000 M

**Nennbelastbarkeit 15 W**  
**Eigenresonanz 45 Hz**  
**Magnetische Daten :**  
 - Magnetisches Feld 16500 G  
 - Magnetischer Fluss 148000 M

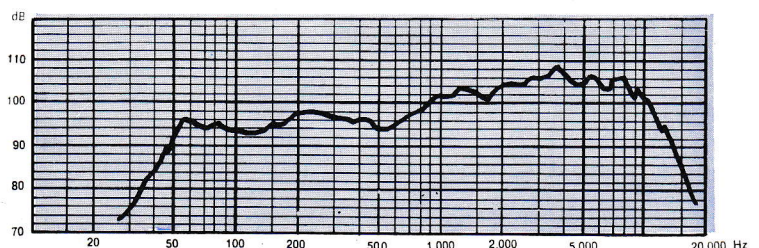

**SON 28 T 5**



# AUDAX

Haut-Parleurs pour Enceintes Bass-Reflex Sonorisation  
 Loudspeakers for Bass-Reflex Sonorisation  
 Lautsprecher für Bass-Reflex - Beschallung

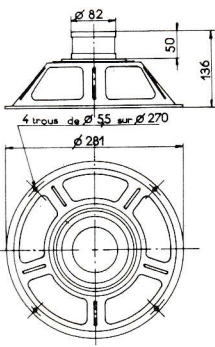

**Puissance nominale 12 W**  
**Fréquence de résonance 60 Hz**  
**Caractéristiques magnétiques :**  
 - Induction 12000 G  
 - Flux d'induction 125000 M

*Power handling capacity 12 W*  
*- Flux density 12000 G*  
*Magnetic characteristics :*  
*Fondamental resonance 60 c/s*  
*- Total flux 125000 M*

**Nennbelastbarkeit 12 W**  
**Eigenresonanz 60 Hz**  
**Magnetische Daten :**  
 - Magnetisches Feld 12000 G  
 - Magnetischer Fluss 125000 M

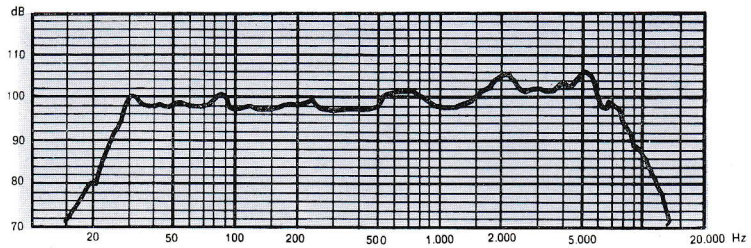

**SON 28 A**

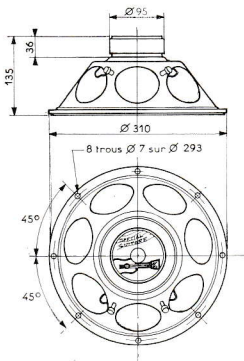

**Puissance nominale 30 W**  
**Fréquence de résonance 90 Hz**  
**Caractéristiques magnétiques :**  
 - Induction 12000 G  
 - Flux d'induction 51500 M

*Power handling capacity 30 W*  
*Fondamental resonance 90 c/s*  
*Magnetic characteristics :*  
*- Flux density 12000 G*  
*- Total flux 51500 M*

**Nennbelastbarkeit 30 W**  
**Eigenresonanz 90 Hz**  
**Magnetische Daten :**  
 - Magnetisches Feld 12000 G  
 - Magnetischer Fluss 51500 M

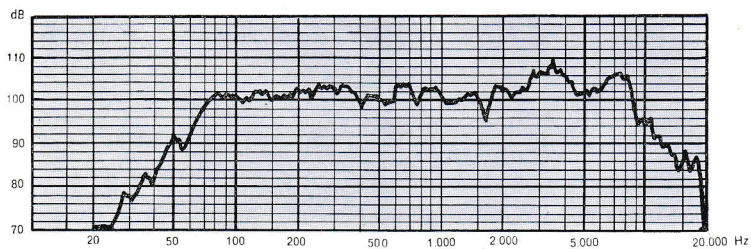

**Modèle Spécial  
 GUITARE**

**SON 30 H**

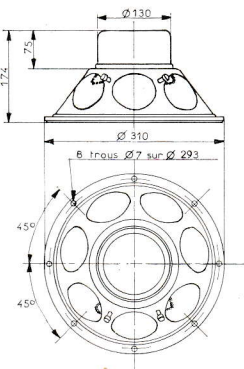

**Puissance nominale 30 W**  
**Fréquence de résonance 40 Hz**  
**Caractéristiques magnétiques :**  
 - Induction 13800 G  
 - Flux d'induction 85000 M

*Power handling capacity 30 W*  
*Fondamental resonance 40 c/s*  
*Magnetic characteristics :*  
*- Flux density 13800 G*  
*- Total flux 85000 M*

**Nennbelastbarkeit 30 W**  
**Eigenresonanz 40 Hz**  
**Magnetische Daten :**  
 - Magnetisches Feld 13800 G  
 - Magnetischer Fluss 85000 M

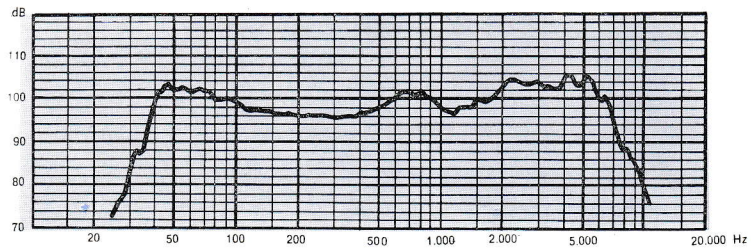

**SON 30 X**

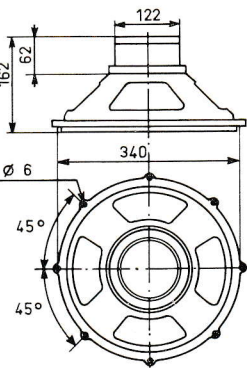

**Puissance nominale 25 W**  
**Fréquence de résonance 60 Hz**  
**Caractéristiques magnétiques :**  
 - Induction 13000 G  
 - Flux d'induction 216000 M

*Power handling capacity 25 W*  
*Fondamental resonance 60 c/s*  
*Magnetic characteristics :*  
*- Flux density 13000 G*  
*- Total flux 216000 M*

**Nennbelastbarkeit 25 W**  
**Eigenresonanz 60 Hz**  
**Magnetische Daten :**  
 - Magnetisches Feld 13000 G  
 - Magnetischer Fluss 216000 M

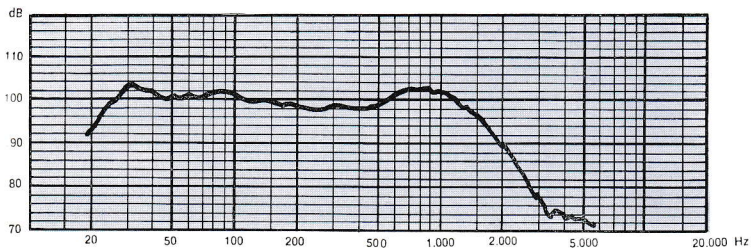

**SON 34 A**

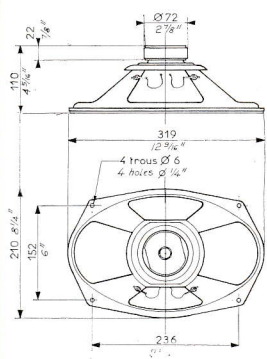

**Puissance nominale 12 W**  
**Fréquence de résonance 60 Hz**  
**Caractéristiques magnétiques :**  
 - Induction 10000 G  
 - Flux d'induction 30800 M

*Power handling capacity 12 W*  
*Fondamental resonance 60 c/s*  
*Magnetic characteristics :*  
*- Flux density 10000 G*  
*- Total flux 30800 M*

**Nennbelastbarkeit 12 W**  
**Eigenresonanz 60 Hz**  
**Magnetische Daten :**  
 - Magnetisches Feld 10000 G  
 - Magnetischer Fluss 30800 M

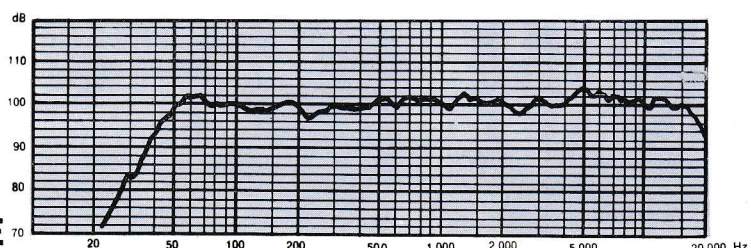

**SON 21.32 E**



# AUDAX

Haut-Parleurs Spéciaux - Tweeters  
 Spécial Loudspeaker - Tweeters  
 Lautsprecher speziell - Hochtöner

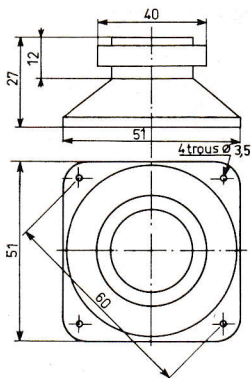

**Puissance nominale 1,5 W**  
**Fréquence de résonance 2000 Hz**  
**Caractéristiques magnétiques :**  
 - Induction 8000 G  
 - Flux d'induction 8800 M

*Power handling capacity 1,5 W*  
*Fundamental resonance 2000 c/s*  
*Magnetic characteristics :*  
 - Flux density 8000 G  
 - Total flux 8800 M

Nennbelastbarkeit 1,5 W  
 Eigenresonanz 2000 Hz  
 Magnetische Daten :  
 - Magnetisches Feld 8000 G  
 - Magnetischer Fluss 8800 M

**Tweeter**

**T W 5 G**

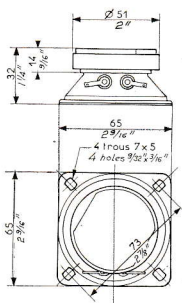
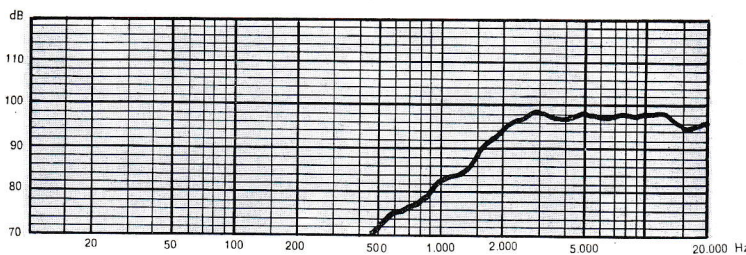

**Puissance nominale 2 W**  
**Fréquence de résonance 2000 Hz**  
**Caractéristiques magnétiques :**  
 - Induction 12000 G  
 - Flux d'induction 13200 M

*Power handling capacity 2 W*  
*Fundamental resonance 2000 c/s*  
*Magnetic characteristics :*  
 - Flux density 12000 G  
 - Total flux 13200 M

Nennbelastbarkeit 2 W  
 Eigenresonanz 2000 Hz  
 Magnetische Daten :  
 - Magnetisches Feld 12000 G  
 - Magnetischer Fluss 13200 M

**Tweeter**

**T W 6 Bi**

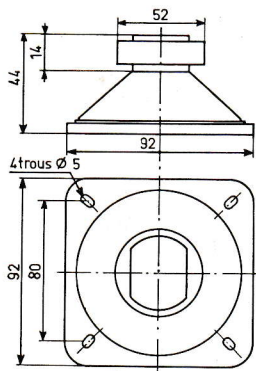
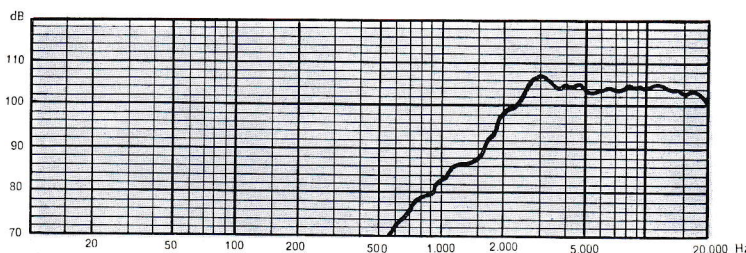

**Puissance nominale 2 W**  
**Fréquence de résonance 2000 Hz**  
**Caractéristiques magnétiques :**  
 - Induction 12000 G  
 - Flux d'induction 13200 M

*Power handling capacity 2 W*  
*Fundamental resonance 2000 c/s*  
*Magnetic characteristics :*  
 - Flux density 12000 G  
 - Total flux 13200 M

Nennbelastbarkeit 2 W  
 Eigenresonanz 2000 Hz  
 Magnetische Daten :  
 - Magnetisches Feld 12000 G  
 - Magnetischer Fluss 13200 M

**Tweeter**

**T W 9 Bi**

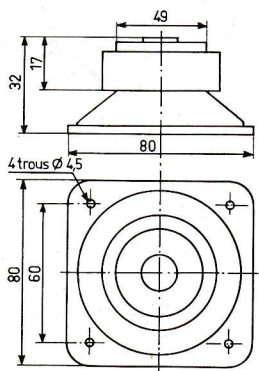
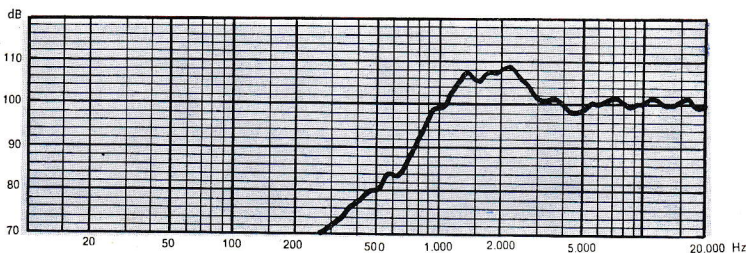

**Puissance nominale 4 W**  
**Fréquence de résonance 1500 Hz**  
**Caractéristiques magnétiques :**  
 - Induction 12500 G  
 - Flux d'induction 16000 M

*Power handling capacity 4 W*  
*Fundamental resonance 1500 c/s*  
*Magnetic characteristics :*  
 - Flux density 12500 G  
 - Total flux 16000 M

Nennbelastbarkeit 4 W  
 Eigenresonanz 1500 Hz  
 Magnetische Daten :  
 - Magnetisches Feld 12500 G  
 - Magnetischer Fluss 16000 M

**Tweeter**

**T W 8 B**

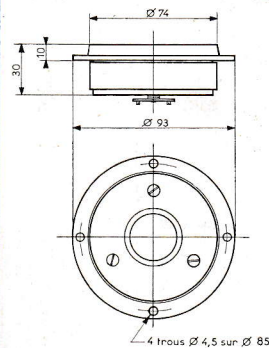
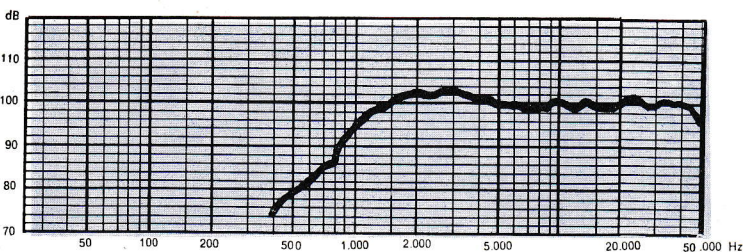

**Puissance nominale 20 W**  
**Fréquence de résonance 1500 Hz**  
**Caractéristiques magnétiques :**  
 - Induction 10000 G  
 - Flux d'induction 30800 M

*Power handling capacity 20 W*  
*Fundamental resonance 1500 c/s*  
*Magnetic characteristics :*  
 - Flux density 10000 G  
 - Total flux 30800 M

Nennbelastbarkeit 20 W  
 Eigenresonanz 1500 Hz  
 Magnetische Daten :  
 - Magnetisches Feld 10000 G  
 - Magnetischer Fluss 30800 M

**Tweeter**  
**« CALOTTE »**

**Nouveau**  
**Modèle**

**T W 10 E**

