



SERVICE MANUAL

MONITOR SERIES

3100

INTEGRATED
AMPLIFIER



PAGE

CONTENTS

3	REAR / FRONT VIEW
4	SPECIFICATIONS
5	MAIN AMPLIFIER ADJUSTMENT POINT
7-8	MAIN AMPLIFIER PCB LAYOUT
6	MAIN/PREAMPLIFIER ADJUSTMENT METHOD
9-10	MAIN AMPLIFIER SCHEMATIC
11-12	PREAMPLIFIER PCB LAYOUT
13-14	PREAMPLIFIER SCHEMATIC
15	MAIN AMPLIFIER WIRING
16	PREAMPLIFIER WIRING
17	DIFFERENT PARTS LIST
18-19	ELECTRICAL PARTS LIST
20	EXPLODED VIEW
21	EXPLODED PARTS LIST
22	PACKING DIAGRAM

REAR PANEL

- | | |
|-----------------------------------|--------------------------|
| 1. AC Line Cord | 10. CD Input |
| 2. AC Outlets (not in all models) | 11. Video Sound Input |
| 3. Speakers A | 12. Tape 1 Input/Output |
| 4. Speakers B | 13. Tape 2 Input/Output |
| 5. Infrasonic Filter | 14. Preamp Out/Normal In |
| 6. Ground | 15. Soft Clipping |
| 7. Phono Input | 16. Bridging |
| 8. MM/IC Selector | 17. Speaker Impedance |
| 9. Tuner Input | |

ATTENTION!
 This product contains a laser beam. Do not stare into the beam or allow it to reflect off surfaces. Avoid direct eye contact. Do not use this product if you are wearing contact lenses.

CAUTION
 HIGH VOLTAGE
 RISK OF ELECTRIC SHOCK
 DO NOT OPEN
 RISK OF ELECTRIC SHOCK
 DO NOT TOUCH THE INSIDE WHEN THE COVER IS REMOVED
 NEVER USE FLAMMABLE SOLVENTS FOR CLEANING

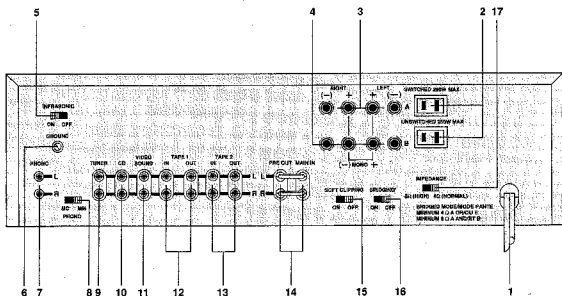

⚠ The lightning flash with arrowhead, within an equilateral triangle, is intended to alert the user of the presence of unenclosed "live parts" within the product's enclosure that may be of sufficient magnitude to constitute a risk of electric shock to persons.

⚠ The exclamation point within an equilateral triangle is intended to alert the user of the presence of important operating and maintenance (servicing) instructions in the literature accompanying the appliance.

FRONT PANEL

- | | |
|--------------------------|--|
| 1. Power | 8. Tape Copy |
| 2. Phones | 9. Tape Monitor |
| 3. Speakers A/B | 10. Input Selector (Phono, CD, Video, Tuner) |
| 4. Bass EQ | 11. Mono |
| 5. Bass | 12. Low Level |
| 6. Loudness Compensation | 13. Volume/Balance |
| 7. Treble | 14. Status Indicators |

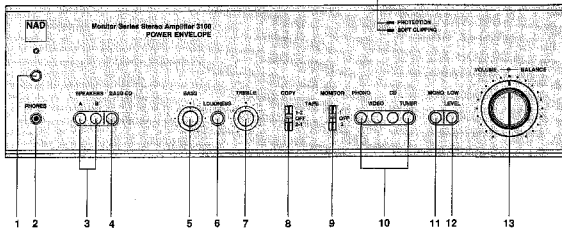

NAD 3100 INTEGRATED AMPLIFIERS
SPECIFICATIONS

Note: Specifications are measured in accordance with EIA Standard RS-490 (IIF A-202). Measurements referred to 8 ohms are taken with the Speaker Impedance selector set to 8 ohm (High). Measurements for 4 and 2 ohm are taken with Impedance selector at 4 ohm (Normal).

POWER AMPLIFIER SECTION

Stereo Mode		
CONTINUOUS AVERAGE POWER OUTPUT INTO 8 OHMS (Min. RMS power per channel, 20Hz-20kHz, both channels driven, with no more than the rated distortion.)		50 W(17 dBW)
Rated Distortion (THD 20 Hz-20 kHz)		0.03%
Clipping Power (maximum continuous power per channel)	8 ohms	70 W
	4 ohms	
IHF Dynamic Headroom at 8 ohms		+6 dB
IHF Dynamic Power (maximum short-term power per channel)	8 ohms	200 W(23 dBW)
	4 ohms	250 W(24 dBW)
	2 ohms	330 W(25 dBW)
Damping Factor (ref 8 ohms, 50 Hz)		100
Slew Factor		>50
Slew Rate		>38V/ussec
THD (Total Harmonic Distortion, 20 Hz-20kHz, from 250 mW to rated output)		<0.03%
SMPTE I.M. (Intermodulation distortion, 60Hz & 7kHz, 4:1, from 250mW to rated output)		<0.03%
IHF I.M. (CCIF IM Distortion 15 + 20kHz at rated output)		<0.03%
Input Impedance		R=10 kohms/C=600pF
Input sensitivity for 1 Watt/50 Watts out		120 mV/850 mV
Voltage Gain		x23(27 dB)
Frequency Response Lab Input		4 Hz-100 kHz
		+0, -3 dB
		100 dB ref. 1W
		117 dB ref. 50W
Signal/Noise Ratio, A-weighted		
Bridged (Monophonic) Mode		
CONTINUOUS AVERAGE POWER OUTPUT INTO 8 OHMS (Min. RMS power per channel, 20Hz-20kHz, one channel driven, with no more than the rated distortion.)		100 W(20 dBW)
IHF Dynamic Headroom at 8 ohms		+7 dB
IHF Dynamic Power (maximum short-term power per channel)	8 ohms	500 W(27 dBW)
	4 ohms	680 W(28 dBW)

PREAMPLIFIER SECTION

PHONO INPUT

Input Impedance	MM:	R = 47 kohms, C = 100 pF
	MC:	R = 100 ohms, C = 100 pF
Input Sensitivity (1 kHz)	MM:	0.35 mV
	MC:	0.025 mV
Input Overload at 20 Hz/1kHz/20kHz	MM:	20mV/180mV/1.5V
	MC:	1.4mV/13mV/100mV
Signal/Noise Ratio, IHF A-weighted, with cartridge connected	MM:	75 dB ref. 5 mV
	MC:	75 dB ref. 0.5mV
THD(20Hz-20kHz) AND IM distortion at +30 dB level		<0.04%
RIAA Accuracy		±0.5 dB
LINE LEVEL INPUTS (CD, VIDEO, TAPE, TUNER)		
Input Impedance		R=50 kohms, C=500 pF
Input Sensitivity ref. 1W/rated output		20 mV/150 mV
Maximum Input Signal		10V
Signal/Noise Ratio, A-weighted		94 dB ref. 1W
		111 dB ref. 50W out
Frequency Response, 20 Hz-20 kHz		0.5 dB

OUTPUTS

Front Output Impedance		600 ohms
Maximum Output Level		10V
Tape Output Impedance		100 (buffered)
Tape Output Infrasonic Filter		-3 dB at 12 Hz
		12 dB/octave

CONTROLS

Treble		±9 dB at 10kHz
Bass		±10 dB at 50 Hz
Bass Equalization		+3 dB at 55 Hz
		+6 dB at 36 Hz
		-3 dB at 12 Hz
Infrasonic Filter (switchable)		12 dB/octave

PHYSICAL SPECIFICATIONS

Width x Height x Depth		43.5 x 10.8 x 38.1 cm. (17.1 x 4.25 x 15 in.)
Net Weight		10.5 kg (23.2 lbs)
Shipping Weight		11.5 kg (25.5 lbs)
Power Consumption		50/60 Hz at 110,120, 220 or 240 VAC/220 VA.

MAIN AMPLIFIER ADJUSTMENT POINT

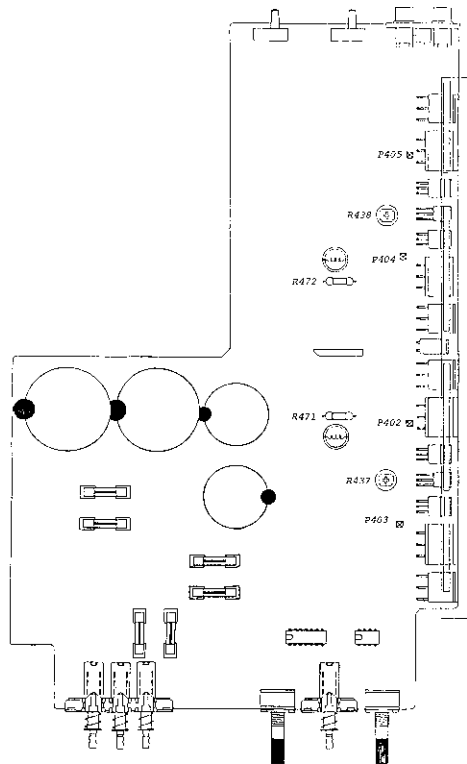

5

MAIN AMPLIFIER ADJUSTMENT

IMPORTANT NOTES:

- 1) Before adjusting, remove input signal and load, and set Speaker impedance switch to 8 ohms (reset to 4 ohms when finished).
- 2) These adjustments are always necessary after repair to main amplifier.
- 3) After repair, it is recommended to use current limiter (70-100W lightbulb) in mains line, for initial turn-on.

A. CENTER VOLTAGE CHECK

1. Connect DMM between Ground and R-471 (L channel)(R-472, R channel)(amplifier output).
2. Turn on, and read voltage. Specification $0V \pm 100mVDC$.

B. IDLE CURRENT ADJUSTMENT

1. Connect DMM across P-402(+) and P-403(-), and adjust R-437 for reading of $15mV \pm 2.5mVDC$.
2. Repeat, using P-404(+) and P-405(-), adjust R-438.

C. FINAL ADJUSTMENT

1. Leave power on minimum 5 minutes.
2. Repeat center voltage check and idle current adjustments.

PREAMPLIFIER ADJUSTMENT

A. CHANNEL BALANCE

1. Feed 1kHz, 100mV to CD input; connect AC VTVM's to preamp output.
2. Set volume to maximum, balance to center, low level off.
3. Adjust R-315 so that both channels have same output level $\pm 0.25dB$.

PREAMPLIFIER ADJUSTMENT POINT

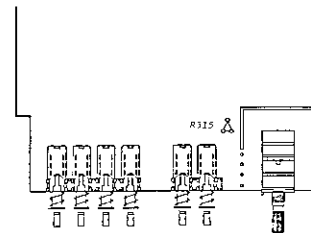

6

MAIN AMPLIFIER PCB LAYOUT

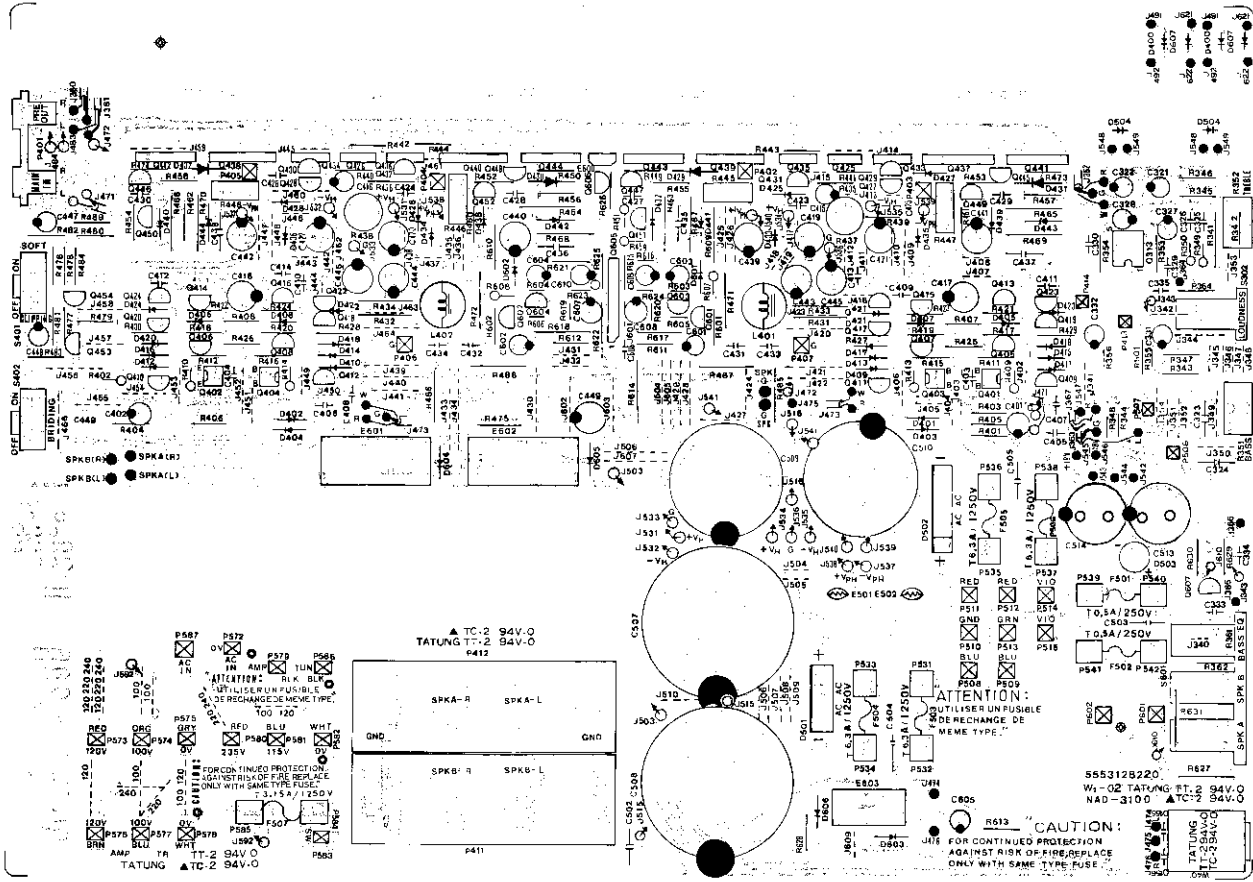

- 0400 ●
- 0401 ●
- 0402 ●
- 0403 ●
- 0404 ●
- 0405 ●
- 0406 ●
- 0407 ●
- 0408 ●
- 0409 ●
- 0410 ●
- 0411 ●
- 0412 ●
- 0413 ●
- 0414 ●
- 0415 ●
- 0416 ●
- 0417 ●
- 0418 ●
- 0419 ●
- 0420 ●
- 0421 ●
- 0422 ●
- 0423 ●
- 0424 ●
- 0425 ●
- 0426 ●
- 0427 ●
- 0428 ●
- 0429 ●
- 0430 ●
- 0431 ●
- 0432 ●
- 0433 ●
- 0434 ●
- 0435 ●
- 0436 ●
- 0437 ●
- 0438 ●
- 0439 ●
- 0440 ●
- 0441 ●
- 0442 ●
- 0443 ●
- 0444 ●
- 0445 ●
- 0446 ●
- 0447 ●
- 0448 ●
- 0449 ●
- 0450 ●
- 0451 ●
- 0452 ●
- 0453 ●
- 0454 ●
- 0455 ●
- 0456 ●
- 0457 ●
- 0458 ●
- 0459 ●
- 0460 ●
- 0461 ●
- 0462 ●
- 0463 ●
- 0464 ●
- 0465 ●
- 0466 ●
- 0467 ●
- 0468 ●
- 0469 ●
- 0470 ●
- 0471 ●
- 0472 ●
- 0473 ●
- 0474 ●
- 0475 ●
- 0476 ●
- 0477 ●
- 0478 ●
- 0479 ●
- 0480 ●
- 0481 ●
- 0482 ●
- 0483 ●
- 0484 ●
- 0485 ●
- 0486 ●
- 0487 ●
- 0488 ●
- 0489 ●
- 0490 ●
- 0491 ●
- 0492 ●
- 0493 ●
- 0494 ●
- 0495 ●
- 0496 ●
- 0497 ●
- 0498 ●
- 0499 ●
- 0500 ●

P570 AC 125V
 P571 100V
 P572 100V
 P573 100V
 P574 100V
 P575 100V
 P576 100V
 P577 100V
 P578 100V
 P579 100V
 P580 100V
 P581 100V
 P582 100V
 P583 100V
 P584 100V
 P585 100V
 P586 100V
 P587 100V
 P588 100V
 P589 100V
 P590 100V
 P591 100V
 P592 100V
 P593 100V
 P594 100V
 P595 100V
 P596 100V
 P597 100V
 P598 100V
 P599 100V
 P600 100V
 P601 100V
 P602 100V
 P603 100V
 P604 100V
 P605 100V
 P606 100V
 P607 100V
 P608 100V
 P609 100V
 P610 100V
 P611 100V
 P612 100V
 P613 100V
 P614 100V
 P615 100V
 P616 100V
 P617 100V
 P618 100V
 P619 100V
 P620 100V
 P621 100V
 P622 100V
 P623 100V
 P624 100V
 P625 100V
 P626 100V
 P627 100V
 P628 100V
 P629 100V
 P630 100V
 P631 100V
 P632 100V
 P633 100V
 P634 100V
 P635 100V
 P636 100V
 P637 100V
 P638 100V
 P639 100V
 P640 100V
 P641 100V
 P642 100V
 P643 100V
 P644 100V
 P645 100V
 P646 100V
 P647 100V
 P648 100V
 P649 100V
 P650 100V
 P651 100V
 P652 100V
 P653 100V
 P654 100V
 P655 100V
 P656 100V
 P657 100V
 P658 100V
 P659 100V
 P660 100V
 P661 100V
 P662 100V
 P663 100V
 P664 100V
 P665 100V
 P666 100V
 P667 100V
 P668 100V
 P669 100V
 P670 100V
 P671 100V
 P672 100V
 P673 100V
 P674 100V
 P675 100V
 P676 100V
 P677 100V
 P678 100V
 P679 100V
 P680 100V
 P681 100V
 P682 100V
 P683 100V
 P684 100V
 P685 100V
 P686 100V
 P687 100V
 P688 100V
 P689 100V
 P690 100V
 P691 100V
 P692 100V
 P693 100V
 P694 100V
 P695 100V
 P696 100V
 P697 100V
 P698 100V
 P699 100V
 P700 100V
 P701 100V
 P702 100V
 P703 100V
 P704 100V
 P705 100V
 P706 100V
 P707 100V
 P708 100V
 P709 100V
 P710 100V
 P711 100V
 P712 100V
 P713 100V
 P714 100V
 P715 100V
 P716 100V
 P717 100V
 P718 100V
 P719 100V
 P720 100V
 P721 100V
 P722 100V
 P723 100V
 P724 100V
 P725 100V
 P726 100V
 P727 100V
 P728 100V
 P729 100V
 P730 100V
 P731 100V
 P732 100V
 P733 100V
 P734 100V
 P735 100V
 P736 100V
 P737 100V
 P738 100V
 P739 100V
 P740 100V
 P741 100V
 P742 100V
 P743 100V
 P744 100V
 P745 100V
 P746 100V
 P747 100V
 P748 100V
 P749 100V
 P750 100V
 P751 100V
 P752 100V
 P753 100V
 P754 100V
 P755 100V
 P756 100V
 P757 100V
 P758 100V
 P759 100V
 P760 100V
 P761 100V
 P762 100V
 P763 100V
 P764 100V
 P765 100V
 P766 100V
 P767 100V
 P768 100V
 P769 100V
 P770 100V
 P771 100V
 P772 100V
 P773 100V
 P774 100V
 P775 100V
 P776 100V
 P777 100V
 P778 100V
 P779 100V
 P780 100V
 P781 100V
 P782 100V
 P783 100V
 P784 100V
 P785 100V
 P786 100V
 P787 100V
 P788 100V
 P789 100V
 P790 100V
 P791 100V
 P792 100V
 P793 100V
 P794 100V
 P795 100V
 P796 100V
 P797 100V
 P798 100V
 P799 100V
 P800 100V
 P801 100V
 P802 100V
 P803 100V
 P804 100V
 P805 100V
 P806 100V
 P807 100V
 P808 100V
 P809 100V
 P810 100V
 P811 100V
 P812 100V
 P813 100V
 P814 100V
 P815 100V
 P816 100V
 P817 100V
 P818 100V
 P819 100V
 P820 100V
 P821 100V
 P822 100V
 P823 100V
 P824 100V
 P825 100V
 P826 100V
 P827 100V
 P828 100V
 P829 100V
 P830 100V
 P831 100V
 P832 100V
 P833 100V
 P834 100V
 P835 100V
 P836 100V
 P837 100V
 P838 100V
 P839 100V
 P840 100V
 P841 100V
 P842 100V
 P843 100V
 P844 100V
 P845 100V
 P846 100V
 P847 100V
 P848 100V
 P849 100V
 P850 100V
 P851 100V
 P852 100V
 P853 100V
 P854 100V
 P855 100V
 P856 100V
 P857 100V
 P858 100V
 P859 100V
 P860 100V
 P861 100V
 P862 100V
 P863 100V
 P864 100V
 P865 100V
 P866 100V
 P867 100V
 P868 100V
 P869 100V
 P870 100V
 P871 100V
 P872 100V
 P873 100V
 P874 100V
 P875 100V
 P876 100V
 P877 100V
 P878 100V
 P879 100V
 P880 100V
 P881 100V
 P882 100V
 P883 100V
 P884 100V
 P885 100V
 P886 100V
 P887 100V
 P888 100V
 P889 100V
 P890 100V
 P891 100V
 P892 100V
 P893 100V
 P894 100V
 P895 100V
 P896 100V
 P897 100V
 P898 100V
 P899 100V
 P900 100V
 P901 100V
 P902 100V
 P903 100V
 P904 100V
 P905 100V
 P906 100V
 P907 100V
 P908 100V
 P909 100V
 P910 100V
 P911 100V
 P912 100V
 P913 100V
 P914 100V
 P915 100V
 P916 100V
 P917 100V
 P918 100V
 P919 100V
 P920 100V
 P921 100V
 P922 100V
 P923 100V
 P924 100V
 P925 100V
 P926 100V
 P927 100V
 P928 100V
 P929 100V
 P930 100V
 P931 100V
 P932 100V
 P933 100V
 P934 100V
 P935 100V
 P936 100V
 P937 100V
 P938 100V
 P939 100V
 P940 100V
 P941 100V
 P942 100V
 P943 100V
 P944 100V
 P945 100V
 P946 100V
 P947 100V
 P948 100V
 P949 100V
 P950 100V
 P951 100V
 P952 100V
 P953 100V
 P954 100V
 P955 100V
 P956 100V
 P957 100V
 P958 100V
 P959 100V
 P960 100V
 P961 100V
 P962 100V
 P963 100V
 P964 100V
 P965 100V
 P966 100V
 P967 100V
 P968 100V
 P969 100V
 P970 100V
 P971 100V
 P972 100V
 P973 100V
 P974 100V
 P975 100V
 P976 100V
 P977 100V
 P978 100V
 P979 100V
 P980 100V
 P981 100V
 P982 100V
 P983 100V
 P984 100V
 P985 100V
 P986 100V
 P987 100V
 P988 100V
 P989 100V
 P990 100V
 P991 100V
 P992 100V
 P993 100V
 P994 100V
 P995 100V
 P996 100V
 P997 100V
 P998 100V
 P999 100V
 P1000 100V

▲ TC-2 94V-0
 TATUNG TT-2 94V-0
 6412
 SPKA-R SPKA-L
 GND GND
 SPKB-R SPKB-L
 6411

ATTENTION:
 UTILISER UN FUSIBLE
 DE RECHANGE DE
 MEME TYPE.

5553128220
 W1-02 TATUNG TT-2 94V-0
 NAD-310
 CAUTION:
 FOR CONTINUED PROTECTION
 AGAINST RISK OF FIRE REPLACE
 ONLY WITH SAME TYPE FUSE

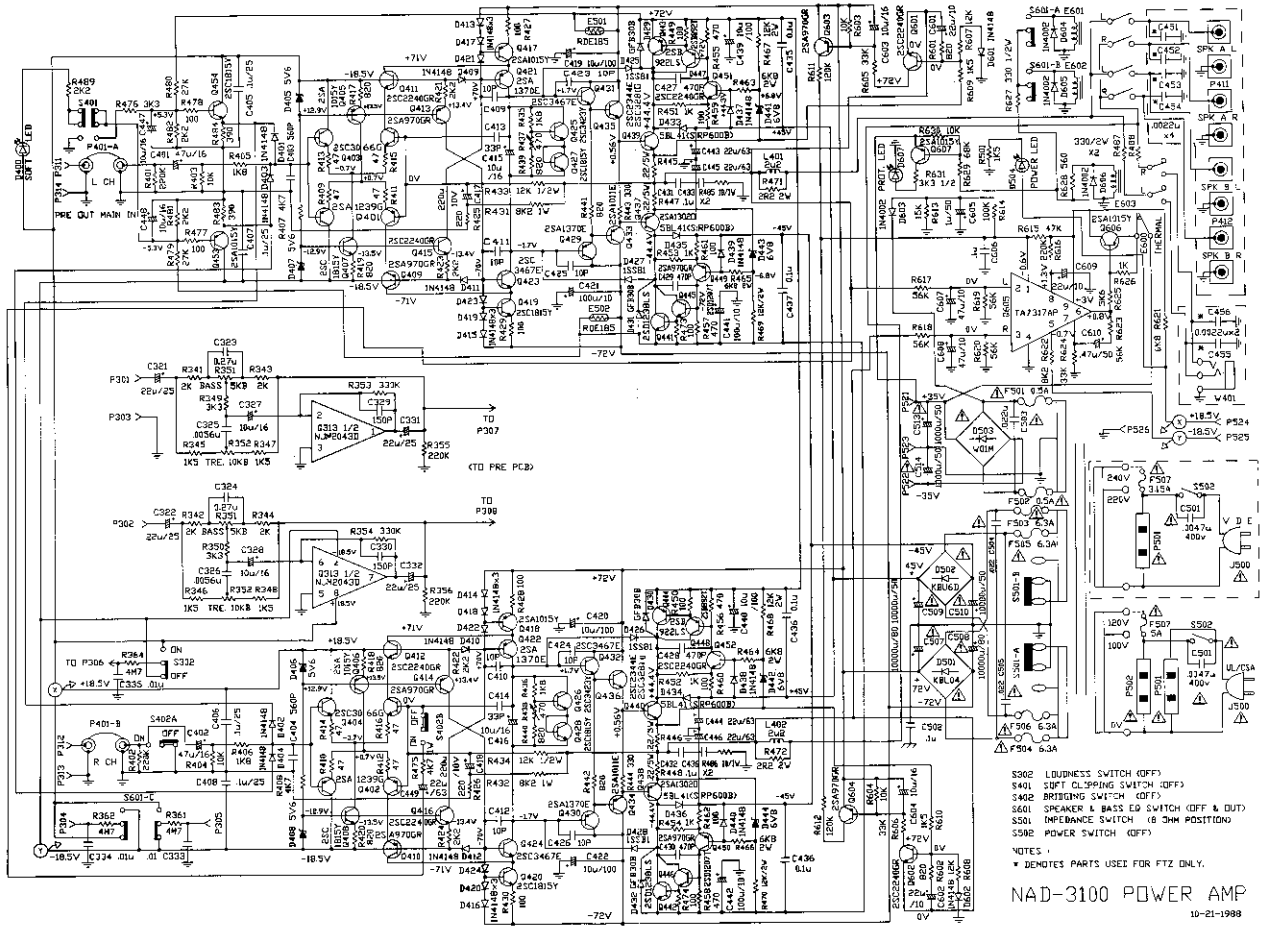

- S302 LOUDNESS SWITCH (OFF)
- S401 SOFT CLIPPING SWITCH (OFF)
- S402 BRIDGING SWITCH (OFF)
- S601 SPEAKER & BASS EQ SWITCH (OFF & BUT)
- S501 IMPEDANCE SWITCH (8 OHM POSITION)
- S502 POWER SWITCH (OFF)

NOTES:
 * DENOTES PARTS USED FOR FTZ ONLY.

NAD-3100 POWER AMP
 10-21-1988

PREAMPLIFIER PCB LAYOUT

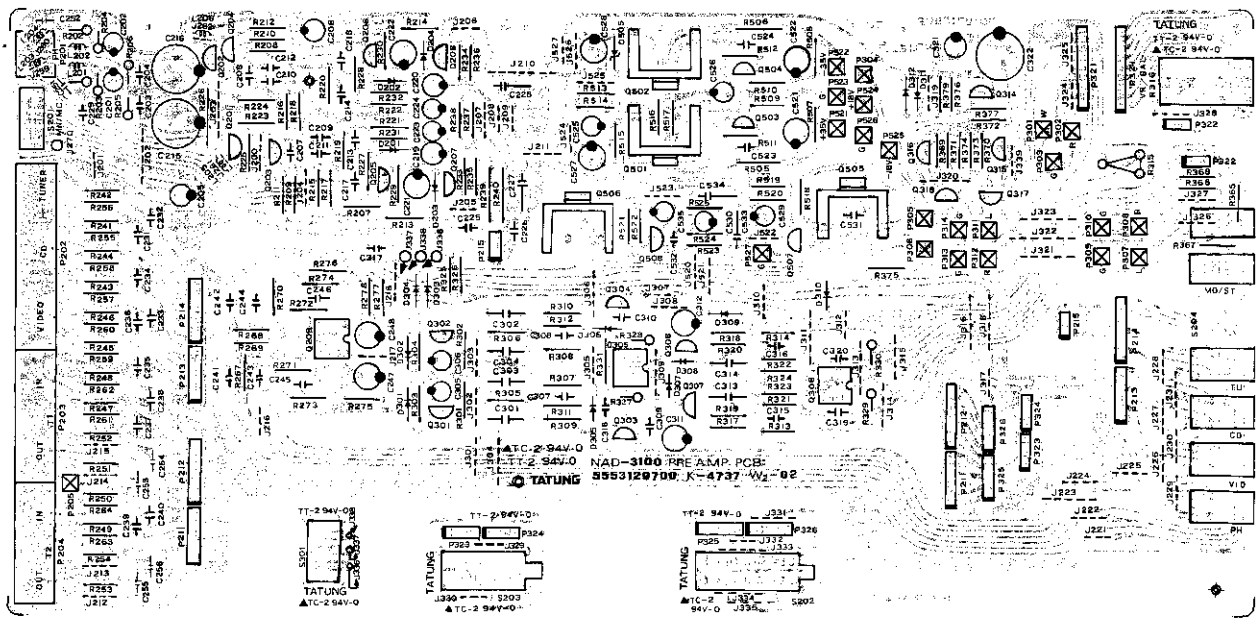

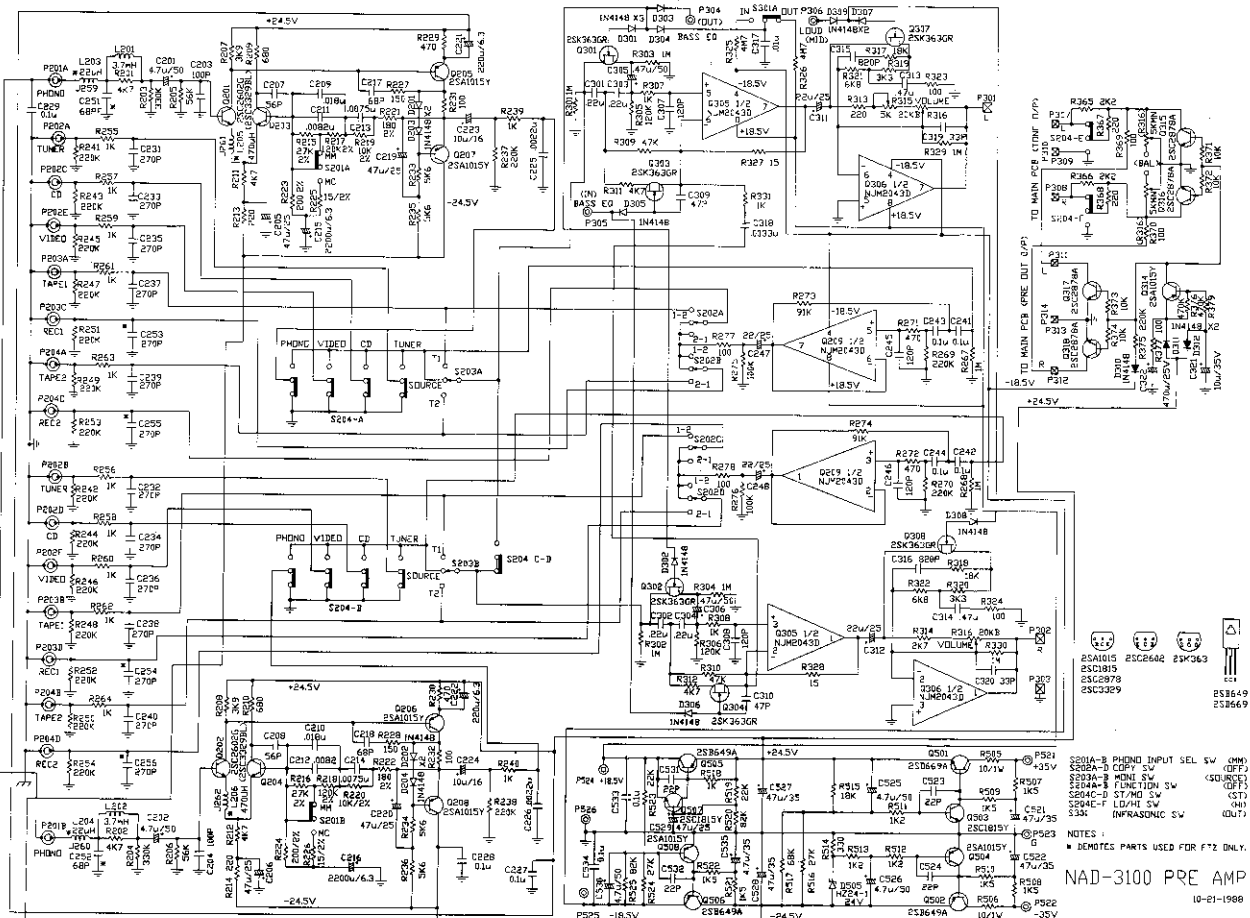

PRE AMP WIRING DIAGRAM

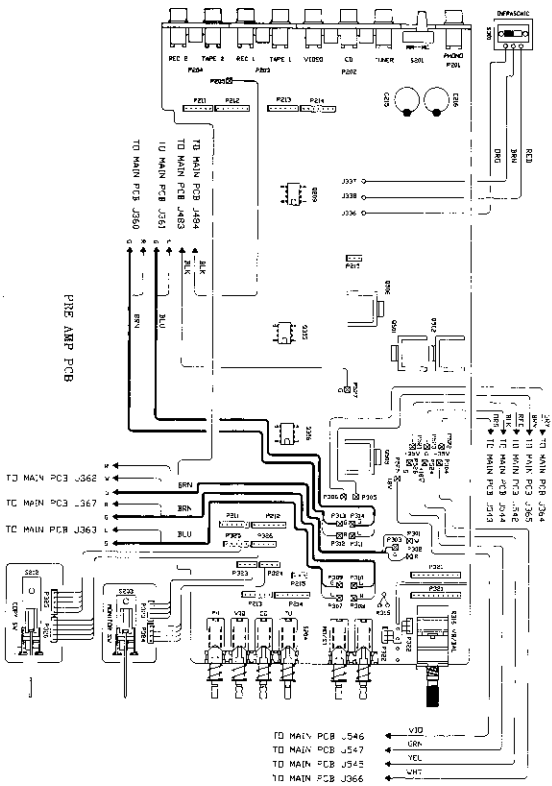

AMPLIFIER WIRING DIAGRAM

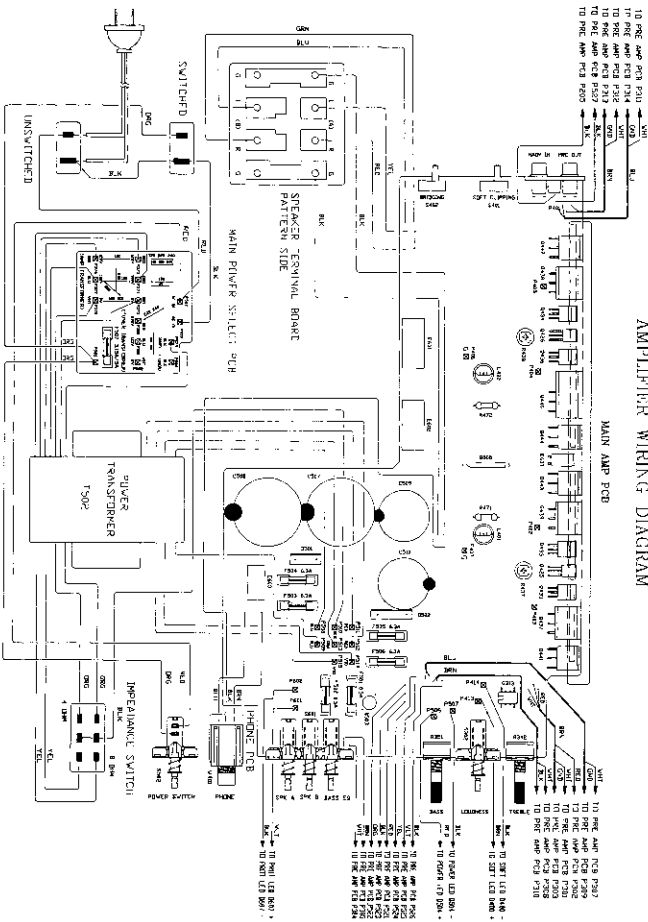

EXPLODED VIEW

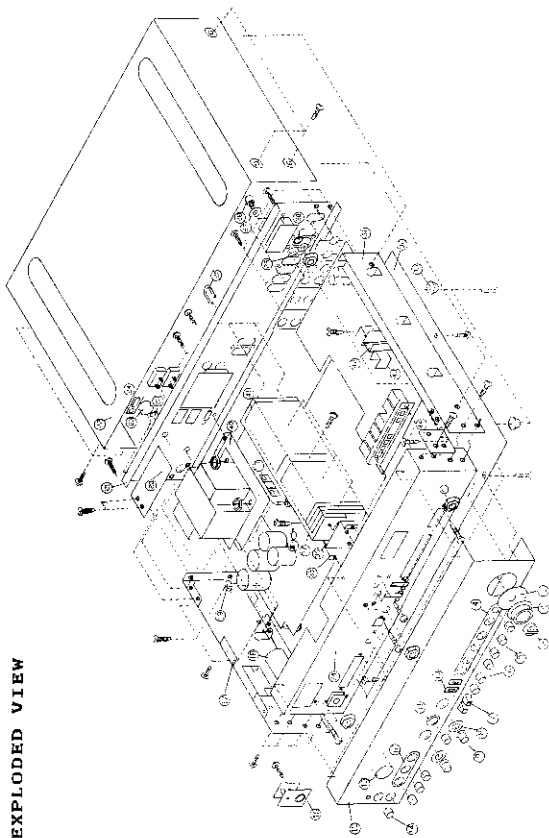

NAD-3100 ITEM	EXPLODED PARTS PARTS NO.	LIST : PARTS NAME	Q'TY
1	5542006130	HEMELON(L)	1
2	5541540000	VOL. KNOB	1
	5542228400	KNOB HOLDER, VOL.	1
3	5541539900	BAL. KNOB	1
4	5542227000	FUNCTION, BEZEL	1
5	5541537710	PUSH BUTTON(W)	4
6	5541537700	PUSH BUTTON(B)	6
7	5541537800	TOGGLE CAP	2
8	5542006100	HEMELON (S)	2
9	5541537510	CONTROL, KNOB	2
10	5542225200	BEZEL, COPY	2
11	5542225000	BEZEL, LOUDNESS	1
12	5542225100	BEZEL, SPEAKER	1
13	5535448300	LABEL, FRONT	1
14	5541539000	POWER, KNOB	1
15	5541307400	PANEL, FRONT	1
16	5542226100	BEZEL, POWER	1
17	5547131600	LEFT PLATE	1
18	5547528600	TUBE	1
19	5547504600	VFS	1
20	5545403700	SHIELD COVER	1
21	5547133600	BACK PLATE, 120V	1
	{5547133610}	OR 240V	1
	{5547133620}	OR 220V	1
22	5541002300	TOP COVER	1
23	5547501200	POWER CORD	1
24	5547528400	PLATE, SWITCH LOCK (PVC)	2
25	5547530400	HOLDER-PCB	3
26	5547033600	TERMINAL CONNECTOR	2
27	7101200352	LOCK WASHER, TOOTH	1
28	5546121400	TERMINAL	1
29	5556200810	LUG	1
30	7096210006	WASHER	1
31	5547131700	RIGHT PLATE	1
32	5547131800	CHASSIS	1
33	5547802120	FOOT	4
34	5547133700	FRONT BRACKET	1
35	5547034110	BRACKET, H.S.	1
36	5545307700	TRANSISTOR HOLDER	1
37	5545307810	HEAT SINK (B)	1
38	5546323400	RING, TRANS.	2
39	5547034000	THERMAL PROTECTOR HOLDE	1
40	5547131100	TRS. PLATE	1
41	5545307800	HEAT SINK (A)	1
42	5545306900	HEAT SINK (L)	2
43	5545306910	HEAT SINK (S)	2
44	5547033800	RIGHT BRACKET PLATE	1

PACKING DIAGRAM

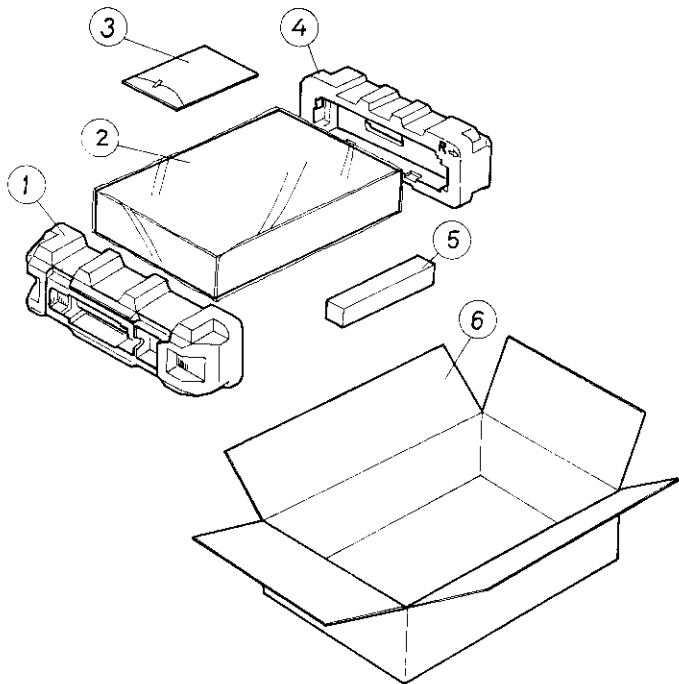

PACKING LIST FOR NAD-3100/NAD-2100

ITEM	PARTS NO.	NAME	QTY
1	9520680155	POLYVLON L.	1
2	9530680155	PE BAG	1
3	5535122011	OWNERS MANUAL	1
4	9520680255	POLYVLON R.	1
5	9520685155	POLYVLON BAR	1
6	9510680155	CARTON	1

NOTES:

SERVICE MANUAL

© 1992 BY NAD. MAY BE REPRODUCED IN WHOLE OR IN PART.

3100
INTEGRATED AMPLIFIER

NAD ELECTRONICS
BOSTON/LONDON