

AKAI SERVICE MANUAL



SEMI AUTOMATIC TURNTABLE

MODEL AP-M 300



SECTION 1	SERVICE MANUAL	2
SECTION 2	PARTS LIST	6

SECTION 1

SERVICE MANUAL

TABLE OF CONTENTS

I. SPECIFICATIONS	3
II. DISMANTLING OF UNIT	3
III. CONTROLS	4
IV. PRINCIPAL PARTS LOCATION	4
V. ADJUSTMENTS	5
5-1 AUTO RETURN ADJUSTEMENT	5
5-2 STYLUS PRESSURE ADJUSTMENT	5
5-3 SPEED ADJUSTMENT	5

For basic adjustments, measuring methods, and operating principles, refer to GENERAL TECHNICAL MANUAL

I. SPECIFICATIONS

MOTOR	DC E.G. MOTOR
SPEED	33. 1/3 & 45 rpm
WOW & FLUTTER	0.15 % (JIS WRMS)
RUMBLE	50dB (DIN-B)
CARTRIDGE	MM Plug-in (TP Plug-in type)
OUTPUT VOLTAGE	4mV
CHANNEL SEPARATION	18dB
CHANNEL BALANCE	Less than 3dB
EFFECTIVE ARM LENGTH	208mm
POWER REQUIREMENTS	DC 12V
DIMENSIONS	324(D) x 350 (W) x 92(H) mm (12.7 x 13.8 x 3.61 inches)
WEIGHT	4Kg (8.8 lbs)

* For improvement purposes, specifications and design are subject to change without notice.

II. DISMANTLING OF UNIT

In case of trouble, etc. necessitating dismantling, please dismantle in the order shown in the Reassemble in reverse order photographs.

2

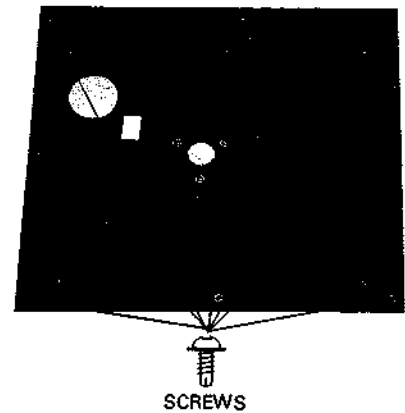

SCREWS

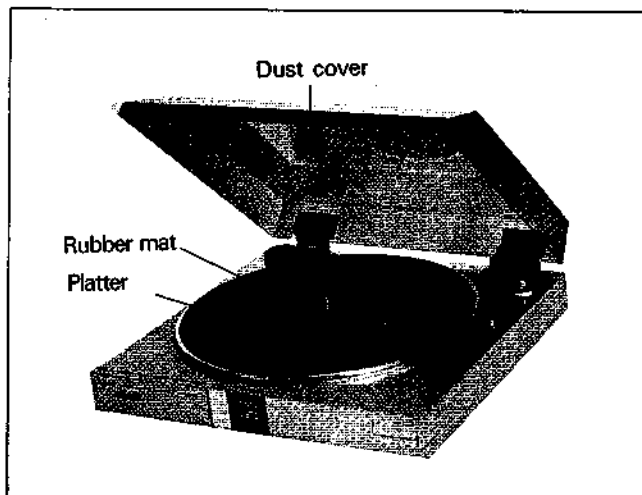

3

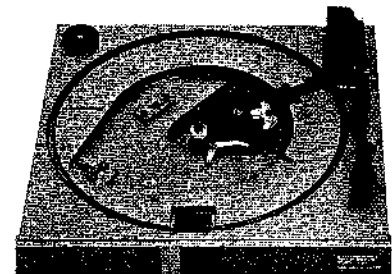

III. CONTROLS

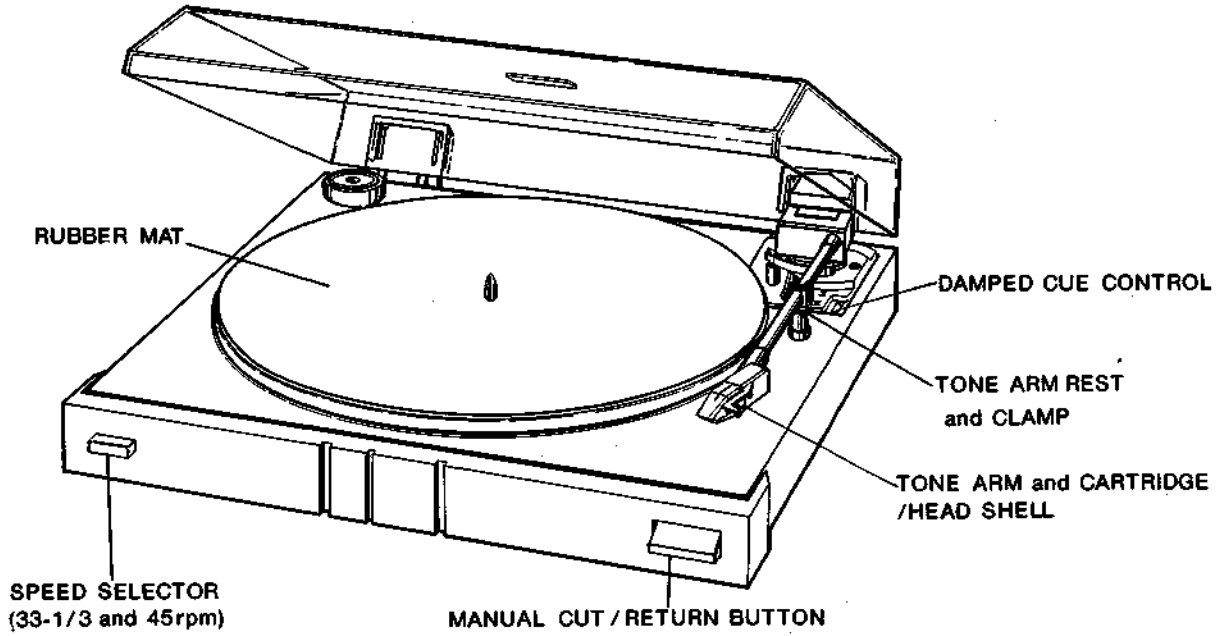
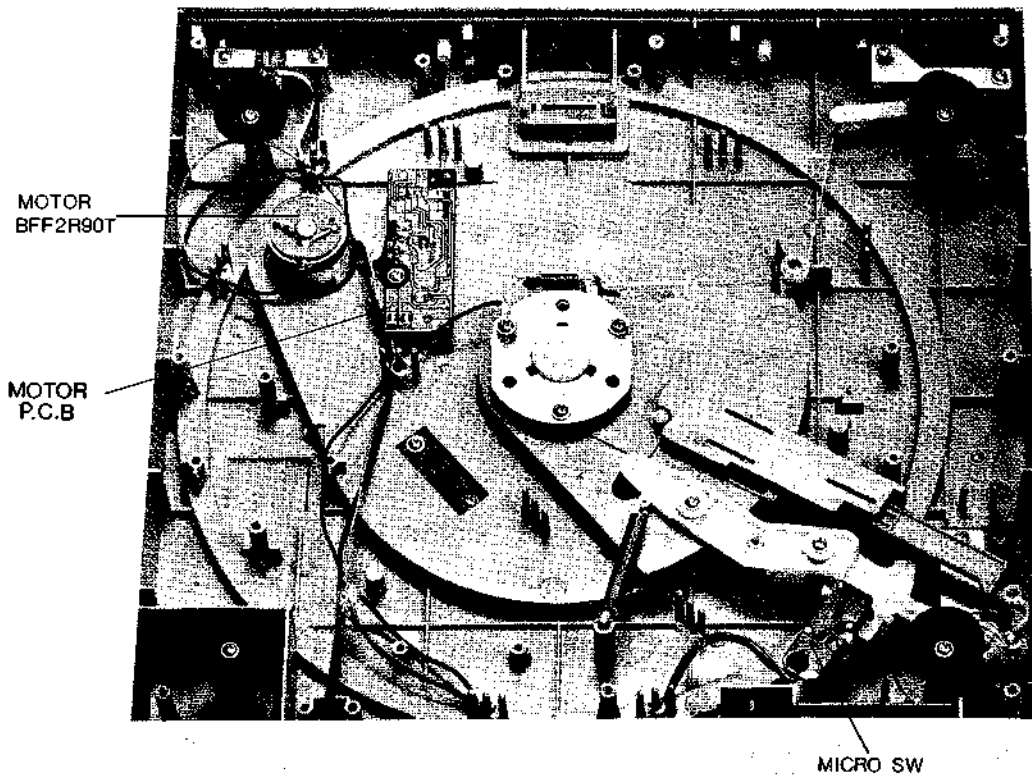

Fig. 3

IV. PRINCIPAL PARTS LOCATION



V. ADJUSTMENTS

5-1. AUTO RETURN ADJUSTMENT

(Refer to Fig. 5)

- (1) If the Tone Arm returns to early or does not return at all, Open the Bottom cover and adjust the auto return point as follows.
(The location of auto return is within 54-64mm from the center spindle.)
- (2) Adjust the Cam in the hole located at the right side of Tone Arm after locking Tone Arm to the ARM REST.
 - a) Counter clock wise: Auto return point to the out side of record.
 - b) Clock wise; Auto return point to the center of record.

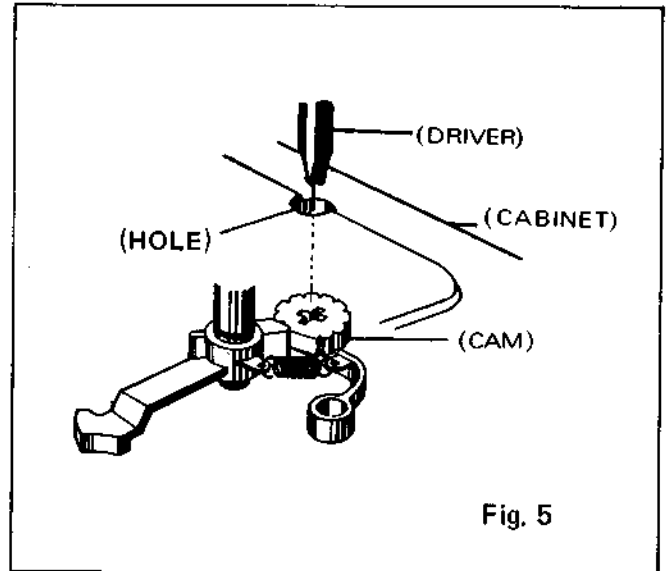

5-2. STYLUS PRESURE ADJUSTMENT

(Refer to Fig. 6)

Turn the screw which is located in the slot as follows.

- a) Counter clock wise: Increase stylus pressure.
- b) Clock wise: Decrease stylus pressure.

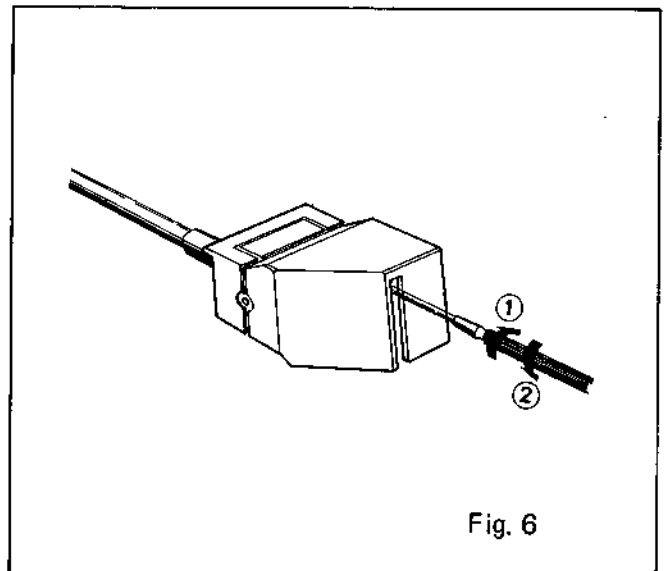

5-3 SPEED ADJUSTMENT (Refer to Fig. 7)

- (1) Set the speed selector to 33-1/3 rpm.
- (2) Play back the test record (1000Hz 33-1/3 rpm), and adjust VR1 so that the speed is 1000Hz.
- (3) Set the speed selector to 45 rpm.
- (4) Play back the test record (1000Hz 45 rpm), and adjust VR2 so that the speed is 1000Hz.

NOTE: This speed adjustment should be adjust 33-1/3 rpm position first then dajust 45 rpm next.

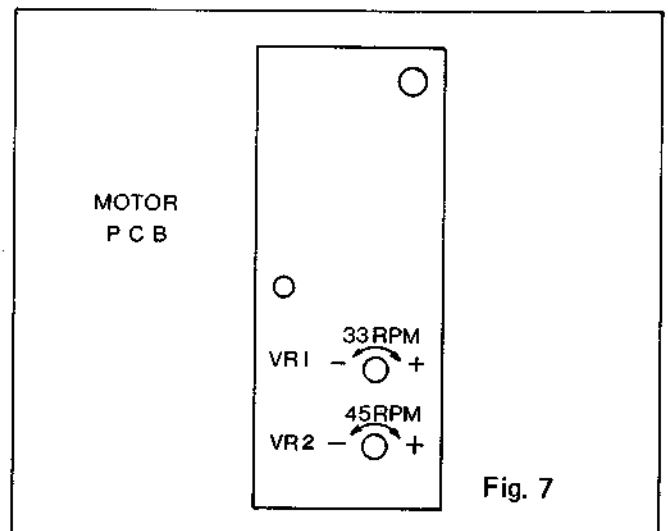

SECTION 2
PARTS LIST

TABLE OF CONTENTS

FINAL ASSEMBLY BLOCK.....7

FINAL ASSEMBLY BLOCK

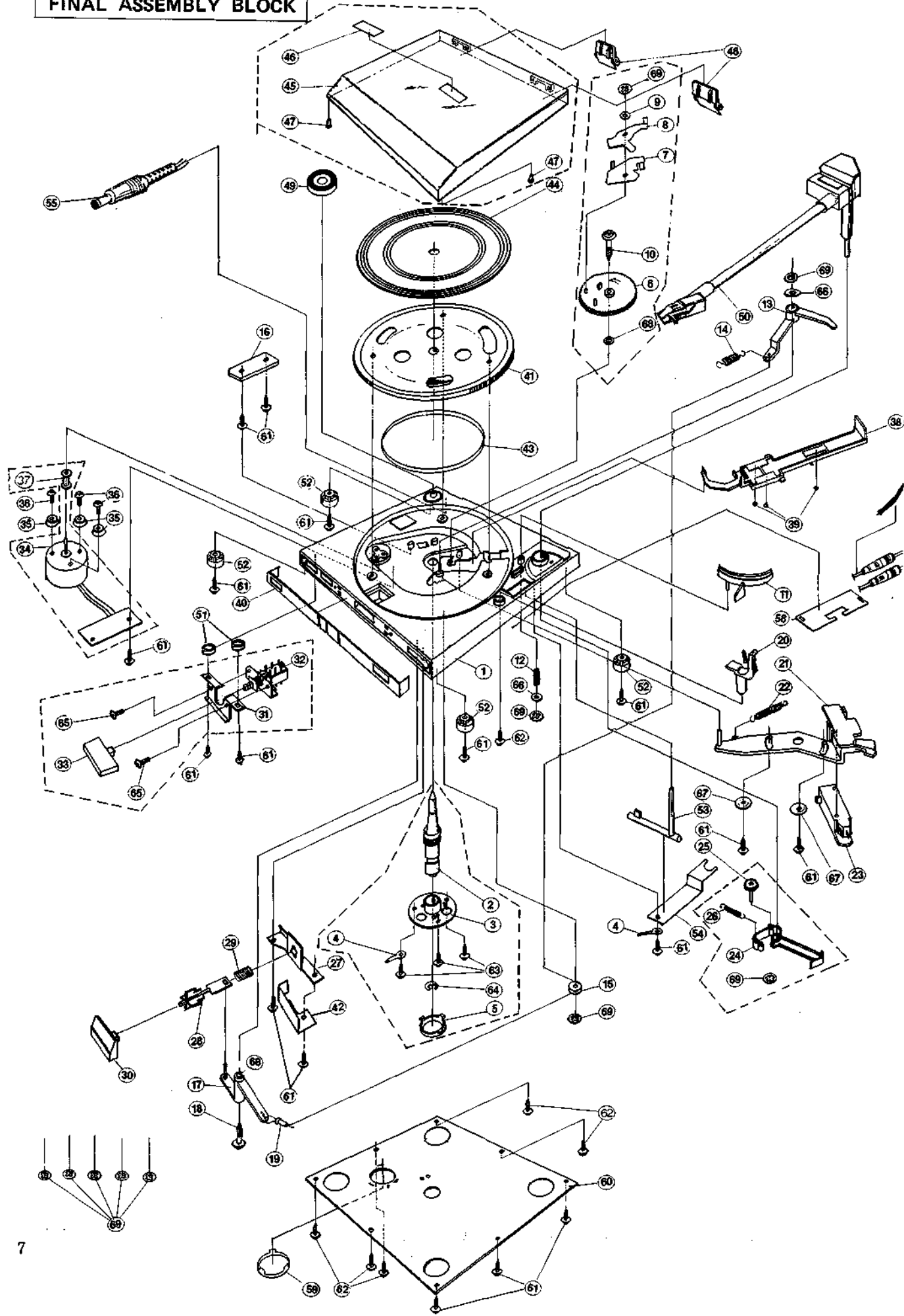

PARTS LIST

1. FINAL ASSEMBLY BLOCK

REF NO.	PART NO.	DESCRIPTION
1-23	ES-718344	SW MICRO AH-4700
1-32	ES-718343	SW BRACKET ASSY AP-M300 (INCL.1-31,1-33,1-65)
1-34	BM-718340	MOTOR ASSY AP-M300 (INCL.1-37,MOTOR PCB)
1-43	MB-718346	BELT CR-WRT AP-M300
1-45	BC-718341	DUST COVER ASSY AP-M300 (INCL.1-46,1-47)
1-48	TP-718347	HINGE BLK HT-506B AP-M300
1-50	TP-718342	TONE ARM ASSY AP-M300
1-55	TP-718349	CORD POWER DC AP-M300
1-56	EW-718348	CORD PHONO AP-M300

SCHEMATIC DIAGRAM

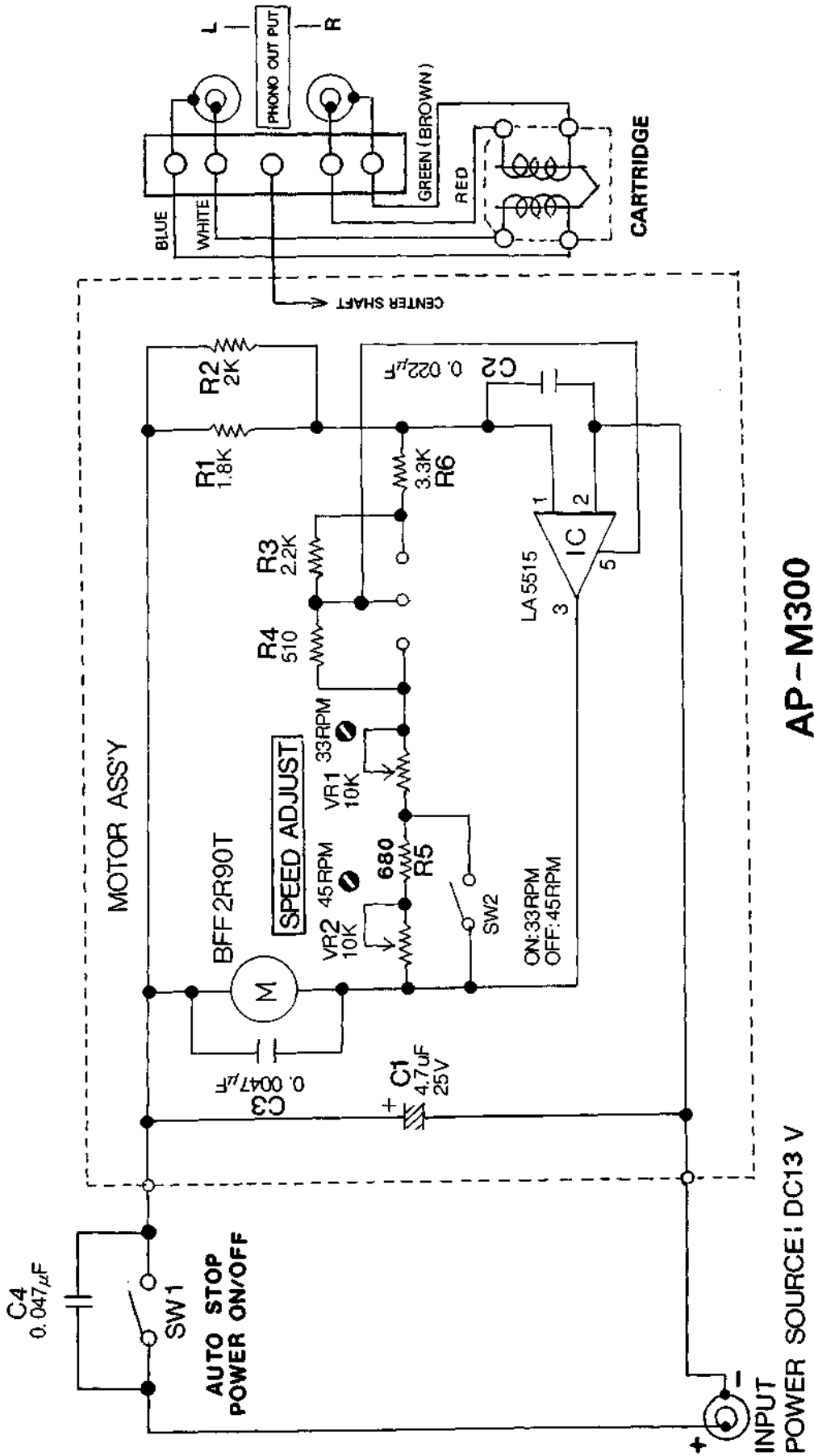

AP - M300

PARTS LIST AP-M300

WIRING DIAGRAM

