

AKAI STEREO CASSETTE DECK

MODEL GXC-706D

ALSO APPLICABLE TO BLACK MODEL

SECTION 1 SERVICE MANUAL 3
 SECTION 2 PARTS LIST 25
 SECTION 3 SCHEMATIC DIAGRAM 39

SECTION 1
SERVICE MANUAL

TABLE OF CONTENTS

I. TECHNICAL DATA 4
 II. DISMANTLING OF UNIT 5
 III. CONTROLS 6
 IV. PRINCIPAL PARTS LOCATION 7
 V. MECHANISM ADJUSTMENT 8
 1. FLYWHEEL LOOSE PLAY ADJUSTMENT 8
 2. PINCH ROLLER PRESSURE MEASUREMENT 8
 3. TAKE-UP TORQUE AT VARIOUS MODES 8
 4. MUTE SWITCH ADJUSTMENT 8
 5. MOTOR SWITCH ADJUSTMENT 9
 6. TAPE SPEED ADJUSTMENT 9
 VI. HEAD ADJUSTMENT 10
 1. TAPE GUIDE HEIGHT ADJUSTMENT 10
 2. RECORDING/PLAYBACK HEAD HEIGHT ADJUSTMENT 10
 3. RECORDING/PLAYBACK HEAD AZIMUTH
 ALIGNMENT ADJUSTMENT 10
 VII. AMPLIFIER ADJUSTMENT 11
 VIII. DC RESISTANCE OF VARIOUS COILS 14
 IX. CLASSIFICATION OF VARIOUS P.C BOARDS 14
 1. P.C BOARD TITLE AND IDENTIFICATION NUMBER 14
 2. COMPOSITION OF VARIOUS P.C BOARDS 15

For basic adjustments, measuring methods, and operating principles, refer to GENERAL TECHNICAL MANUAL.

I. TECHNICAL DATA

TRACK SYSTEM	4 Track, 2 Channel Stereo System
TAPE	Philips Type Cassette
TAPE SPEED	1-7/8 ips
WOW & FLUTTER	Less than 0.055% WRMS, 0.17% (DIN 45500, 45507)
FREQUENCY RESPONSE	35 to 13,000 Hz ± 3 dB using LN tape 35 to 14,000 Hz ± 3 dB using LH tape 35 to 15,000 Hz ± 3 dB using CrO ₂ (SA) tape 35 to 15,000 Hz ± 3 dB using FeCr tape
DISTORTION (1,000 Hz "0" VU)	Less than 1.3% using LN tape Less than 1.3% using LH tape Less than 1.5% using CrO ₂ (SA) tape Less than 1.5% using FeCr tape
SIGNAL TO NOISE RATIO	Better than 54 dB using LN tape Better than 54 dB using LH tape Better than 56 dB using CrO ₂ (SA) tape Better than 56 dB using FeCr tape (measured via tape with peak recording level of +3 VU) Dolby N.R. switch ON: Improves up to 10 dB above 5 kHz Better than 70 dB
ERASE RATIO	
BIAS FREQUENCY	85 kHz
HEADS	(2): One Recording/Playback Head, One Erase Head
MOTOR	(1): Electronically speed controlled DC Motor
F.F. & REWIND TIME	120 sec using a C-60 cassette tape
OUTPUT JACKS	Line (2): 410 mV (0 VU) Required load impedance: More than 20 kohms Phone (1): 100 mV/8 ohms
INPUT JACKS	Microphone (2): 0.25 mV (Input impedance 5 kohms) Required microphone impedance: 600 ohms Line (2): 70 mV (Input impedance 100 kohms)
DIN JACK	Input: 0.25 mV (Input impedance 5 kohms) Output: 410 mV Required load impedance: more than 20 kohms
SEMICONDUCTORS	Transistors: 16, Diodes: 21, FETs: 2, ICs: 3
DIMENSION	440(W) x 150(H) x 290(D) mm. (17.3 x 5.9 x 11.4")
WEIGHT	6.5 kg (14.4 lbs)
POWER REQUIREMENTS	120V/60 Hz for U.S.A. & CANADA 100V, 50/60 Hz for JAPAN 220V/50 Hz for European Countries except U.K. 240V/50 Hz for U.K. & Australia 110-120/220-240V (Switchable), 50/60 Hz for the other countries

- * For improvement purposes, specifications and design are subject to change without notice.
- * "Dolby" and the Double D symbol are trademarks of Dolby Laboratories.
(Manufactured under license from Dolby Laboratories.)

II. DISMANTLING OF UNIT

In case of trouble, etc. necessitating dismantling, please dismantle in the order shown in the photographs. Reassemble in reverse order.

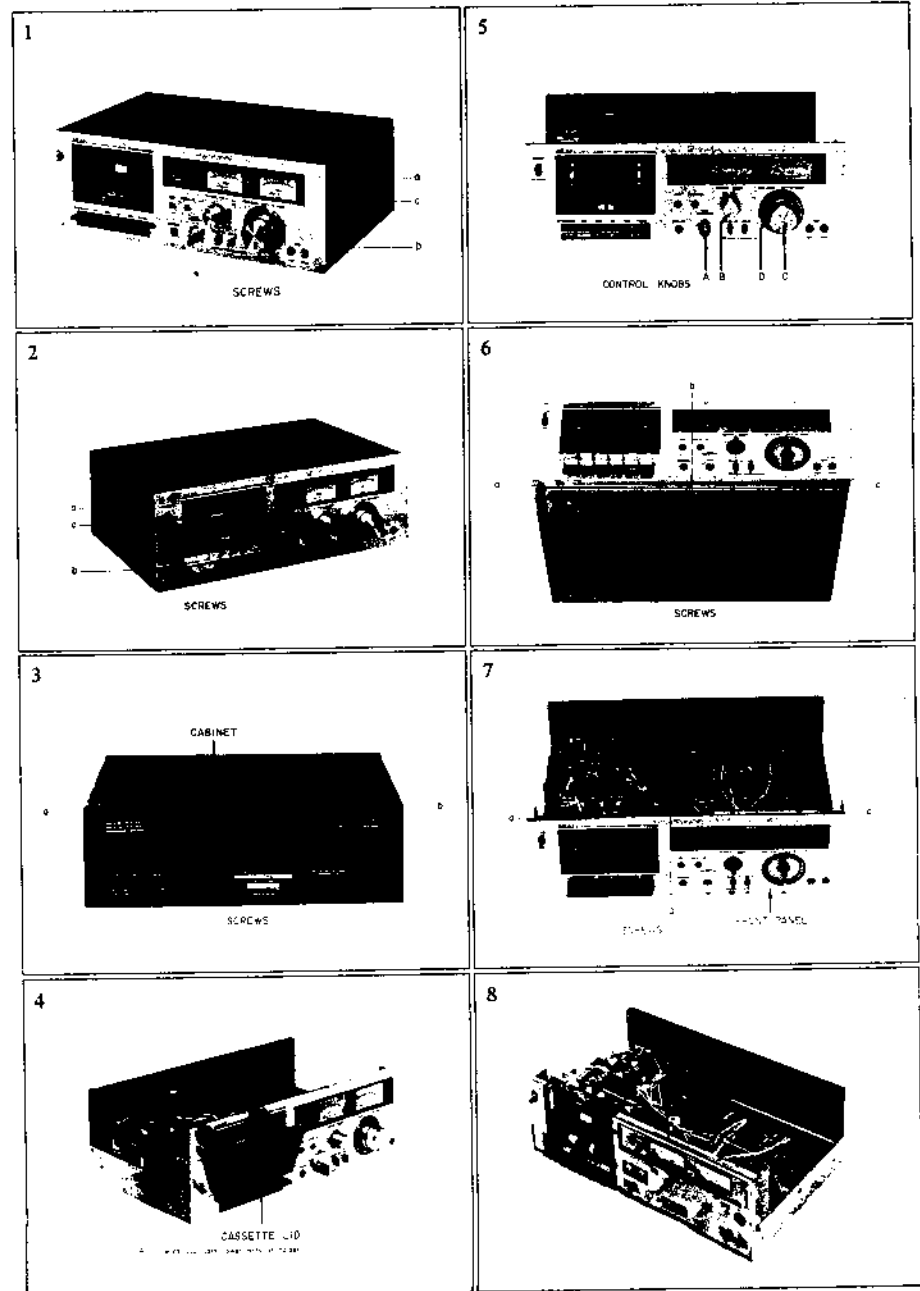

III. CONTROLS

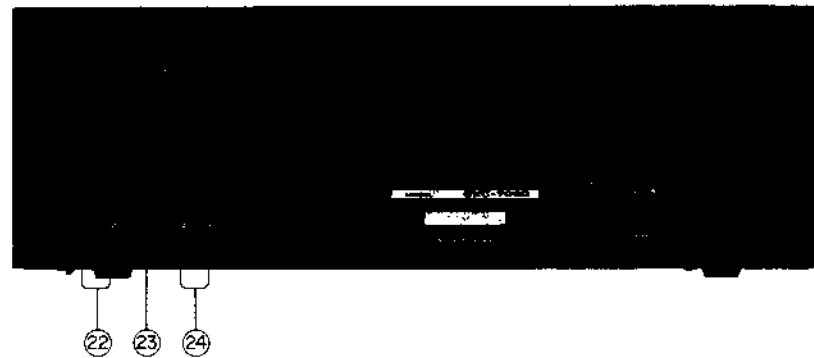
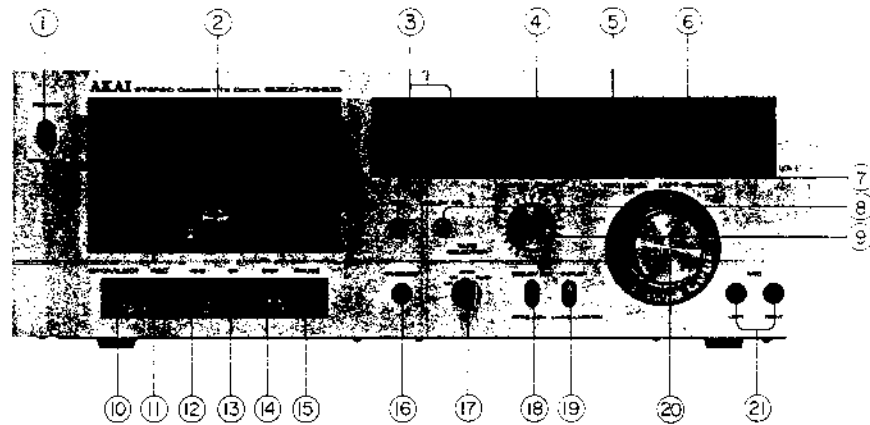

Fig. 1 Controls

- | | |
|--|--|
| 1. POWER SWITCH (POWER) | 13. PLAY KEY |
| 2. CASSETTE RECEPTACLE (with tape view window) | 14. FAST FORWARD KEY |
| 3. INDEX COUNTER AND RESET BUTTON | 15. PAUSE KEY |
| 4. LEFT VU METER | 16. HEADPHONE JACK |
| 5. PEAK LEVEL INDICATOR | 17. TAPE SELECTOR SWITCHES |
| 6. RIGHT VU METER | 18. DOLBY N.R. SWITCH |
| 7. RECORDING INDICATOR LAMP | 19. INPUT SELECTOR SWITCH |
| 8. DOLBY N.R. INDICATOR LAMP | 20. RECORDING LEVEL CONTROLS |
| 9. OUTPUT/PHONES LEVEL CONTROL | 21. MICROPHONE JACKS (left and right) |
| 10. STOP/EJECT KEY | 22. LINE INPUT JACKS (left and right) |
| 11. RECORDING KEY | 23. DIN JACK |
| 12. REWIND KEY | 24. LINE OUTPUT JACKS (left and right) |

IV. PRINCIPAL PARTS LOCATION

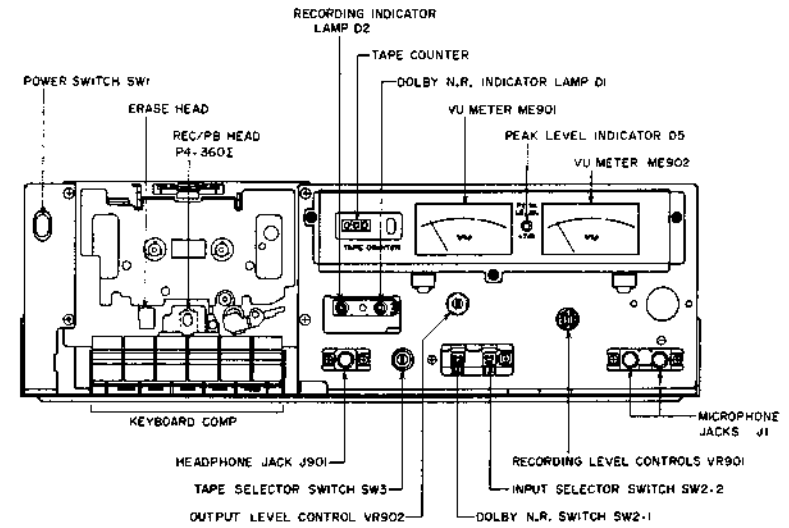

Fig. 2 Front View

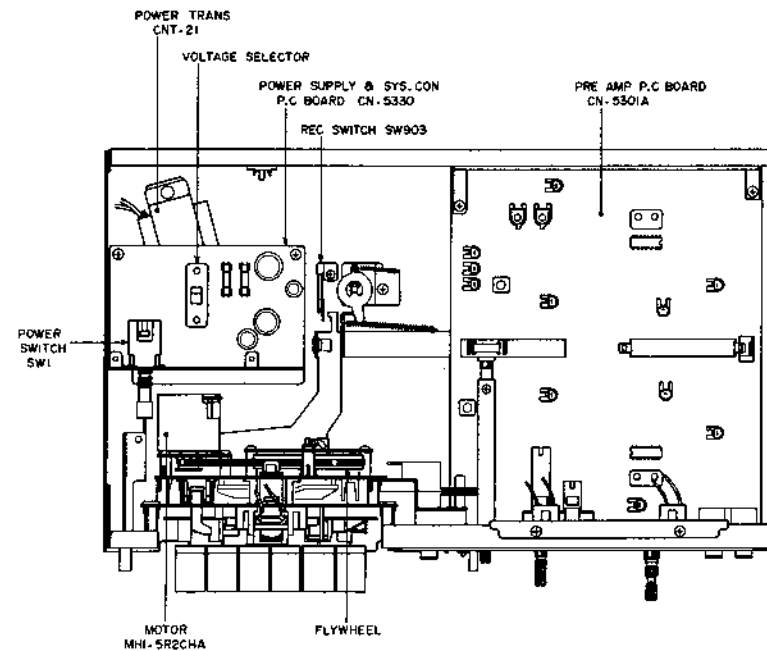

Fig. 3 Top View

V. MECHANISM ADJUSTMENT

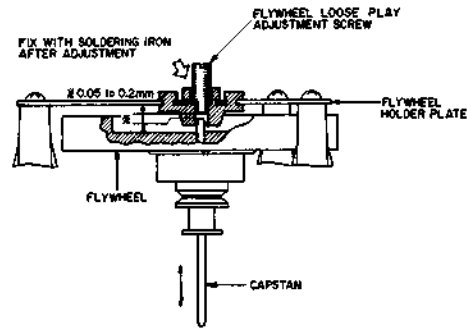

Fig. 4 Flywheel Loose Play Adjustment

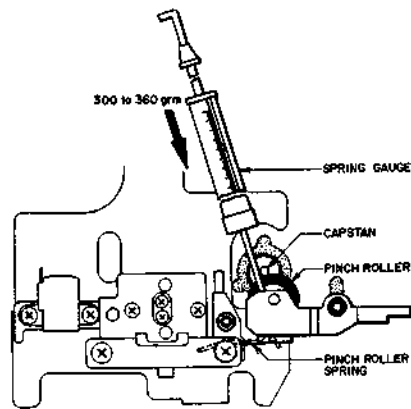

Fig. 5 Pinch Roller Pressure Measurement

1. FLYWHEEL LOOSE PLAY ADJUSTMENT (Refer to Fig. 4)

Adjust by turning flywheel loose play adjustment screw to obtain a 0.05 to 0.2 mm of loose play when the flywheel is moved as indicated by the arrow mark.

2. PINCH ROLLER PRESSURE MEASUREMENT (Refer to Fig. 5)

At playback mode, push the pinch roller with a spring gauge until the pinch roller separates from the capstan by about 1 mm to 2 mm and then gently return. Take a reading of the spring gauge indication at the moment the pinch roller touches the capstan and begins to rotate.

Specified Pinch Roller Pressure: 300 to 360 grm
In case specified pressure cannot be attained, replace the pinch roller spring.

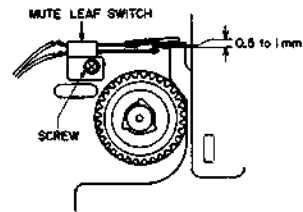

Fig. 6 Mute Switch Adjustment

3. TAKE-UP TORQUE AT VARIOUS MODES

Playback mode: 35 to 55 grm-cm

Fast Forward mode: 70 to 120 grm-cm

Rewind mode: 70 to 120 grm-cm

In case specified take-up torque cannot be attained.

Playback mode:

Replace Take-up reel table Block Comp.

Fast Forward or Rewind mode:

Replace Middle lever Part

4. MUTE SWITCH ADJUSTMENT

(Refer to Fig. 6)

When in the playback mode, the space should be 0.5 mm to 1 mm as in Fig. 6. To adjust, turn the leaf switch screw.

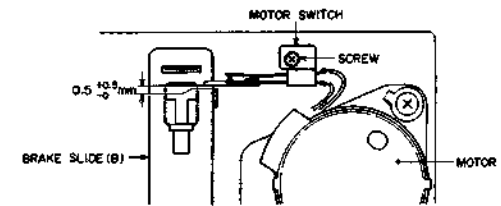

Fig. 7 Motor Switch Adjustment

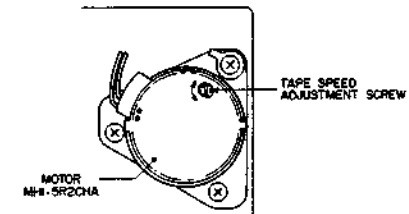

Fig. 8 Tape Speed Adjustment

5. MOTOR SWITCH ADJUSTMENT

(Refer to Fig. 7)

When in the Stop position, the space between the upper part of the Brake Slide switch and the lower part of the Motor leaf switch should be 0.5 mm ± 0.5 - 0 mm.

To adjust, loosen the leaf switch screw and move the leaf switch.

6. TAPE SPEED ADJUSTMENT

(Refer to Fig. 8)

Playback a 1,000 Hz pre-recorded test tape and adjust tape speed adjustment screw to obtain a tape speed of 1,000 Hz $\pm 2\%$.

VI. HEAD ADJUSTMENT

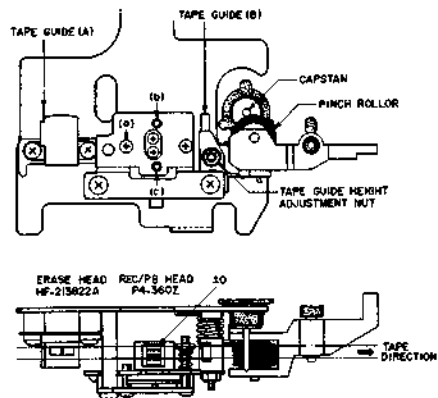

Fig. 9 Head Adjustment

1. TAPE GUIDE HEIGHT ADJUSTMENT

(Refer to Figs. 9, 10)

- 1) When using an ordinary cassette, the tape guides and heads, etc. are not visible. As shown in Fig. 10 use a cassette tape from which part of the cassette case has been cut out and a mirror installed for easy visibility of the head area when making tape guide height adjustment
- 2) At playback mode, using the Tape guide (A) shown in Fig. 9 as standard for height, adjust tape guide (B) height with tape guide height adjustment nut so that the tape runs smoothly and does not catch on the tape guides.

2. RECORDING/PLAYBACK HEAD HEIGHT ADJUSTMENT (Refer to Figs. 9, 10)

- 1) Utilize the cassette tape used in Tape Guide Height Adjustment above, and playback the leader tape part of cassette tape.
- 2) As shown in Fig. 9, adjust head height with screws (a), (b) and (c) until the upper edge of the tape is the same height as the upper edge of the left channel REC/PB head core.
- 3) After completing adjustment step 2, playback the Head Height Adjustment tape (4 track, 1,000 Hz) and adjust Head Height Adjustment screws (a), (b), (c) to put the output power from both channels to maximum.

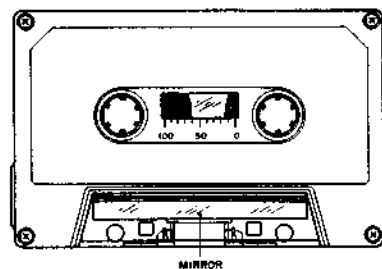

Fig. 10

3. RECORDING/PLAYBACK HEAD AZIMUTH ALIGNMENT ADJUSTMENT (Refer to Fig. 9)

- 1) Playback a 10 kHz pre-recorded cassette azimuth alignment test tape and adjust screw (a) shown in Fig. 9 to obtain maximum output on both channels.
- 2) Invert cassette and confirm that the output level does not change from that obtained in Item 3-1) above. If the output level differs, adjust in the same way as in Item 3-1) above until both sides of the test tape display equal output.
- 3) After adjustment, it is better to check again head height and azimuth alignment.

NOTES:

1. Be sure to clean the heads prior to head adjustment.
2. Be careful not to use a magnetized driver or other magnetized tools in the vicinity of the heads.
3. Be sure to demagnetize the heads with a Head Demagnetizer before and after head adjustment.
4. When a mirror installed cassette test tape as shown in Fig. 10 is required, it can be ordered from AKAI Electric Co.

VII. AMPLIFIER ADJUSTMENT

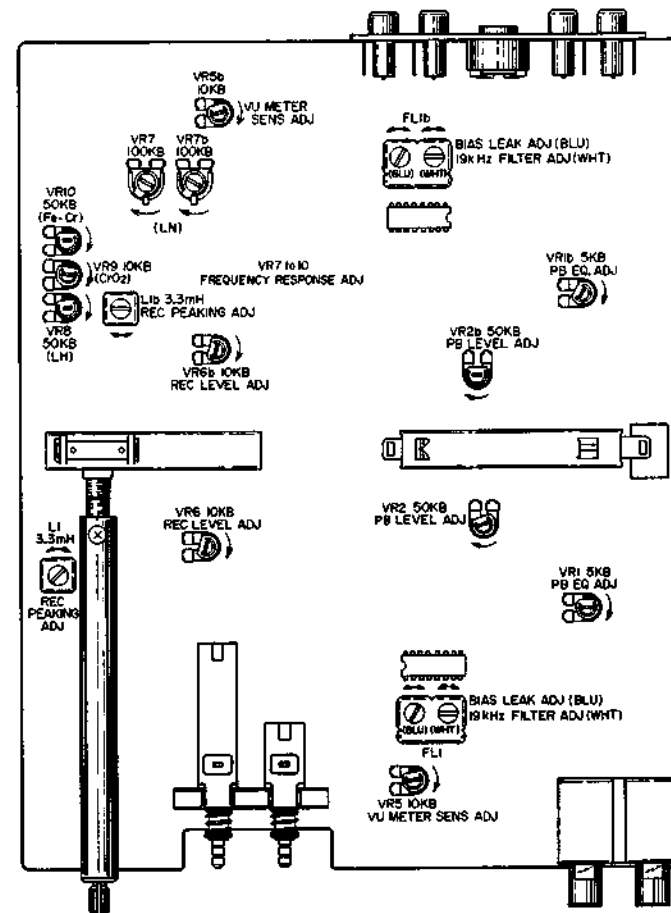

Fig. 11 Pre Amp P.C Board CN-5301A

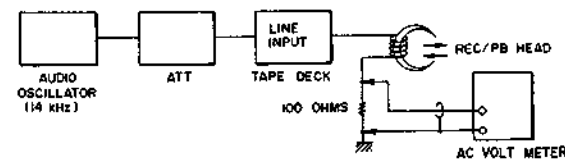

Fig. 12 Instruments Connection

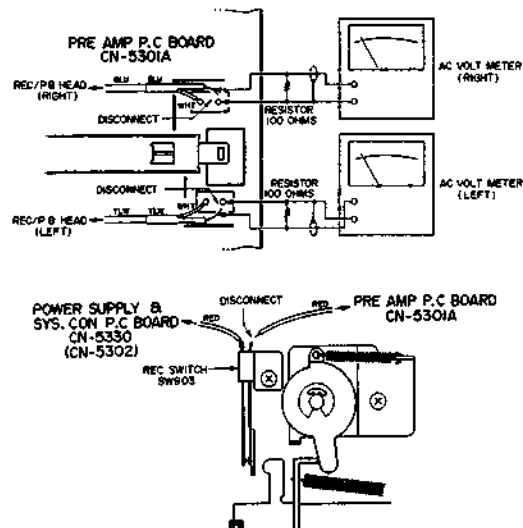

Fig. 13 Rec Peaking Adjustment

Step	Adjustment Item	Test Tape Supply Signal	Mode	Adjustment Point	Result	Remarks
1	Playback level adjustment	333 Hz, 0 VU Test Tape	PLAY	VR2 50 kB	-5.5 ± 0.5 dBm (410 mV)	
2	VU Meter sensitivity adjustment	1,000 Hz, from an oscillator	REC	VR9 5 kB	0 VU indication	(Refer to NOTE 3)
3	Playback equalizer adjustment	10 kHz Test Tape	PLAY	VR1 10 kB	-20.0 ± 0.5 dBm	
4	Rec peaking adjustment	14 kHz from an oscillator	REC	L1 3.3 mH	Maximum AC volt meter indication	(Refer to NOTE 7 and Figs. 12, 13)
5	LN Position frequency response adjustment	Low Noise Blank tape, 1,000 Hz, 10,000 Hz, -20 VU recording	REC/PLAY	VR7 100 kB	1,000 Hz to 10,000 Hz flat response	
6	LH Position frequency response adjustment	LH Blank tape, 1,000 Hz, 10,000 Hz, -20 VU recording	REC/PLAY	VR8 50 kB	1,000 Hz to 10,000 Hz flat response	Set tape selector to LH. (Refer to NOTE 8)
7	CrO ₂ Position frequency response adjustment	CrO ₂ Blank tape, 1,000 Hz, 10,000 Hz, -20 VU recording	REC/PLAY	VR9 20 kB	1,000 Hz to 10,000 Hz flat response	Set tape selector to CrO ₂ . (Refer to NOTE 8)

Step	Adjustment Item	Test Tape Supply Signal	Mode	Adjustment Point	Result	Remarks
8	Fe-Cr Position frequency response adjustment	Fe-Cr Blank tape, 1,000 Hz, 10,000 Hz, -20 VU recording	REC/PLAY	VR10 50 kB	1,000 Hz to 10,000 Hz flat response	Set tape selector to Fe-Cr. (Refer to NOTE 8)
9	Recording level adjustment	Low Noise Blank tape, 1,000 Hz, 0 VU recording	REC/PLAY	VR6 10 kB	-5.5 ± 0.5 dBm (410 mV)	
10	Distortion Factor Confirmation	1,000 Hz 0 VU recording	REC/PLAY		LN: Less than 1.3% LH: Less than 1.3% CrO ₂ : Less than 1.5% Fe-Cr: Less than 1.5%	(Refer to NOTE 9)
11	Bias Leak adjustment	No signal Input	REC	FL1 FB2000B (BLU)	Minimum AC voltmeter indication	Recording volume to maximum.
12	19 kHz filter adjustment	19 kHz from an oscillator	REC	FL1 FB2000B (WHT)	Minimum AC voltmeter indication	DOLBY N.R. Switch to ON. (Refer to NOTE 10, 11)

Chart-1

- NOTES:
- Output Level Control should be at maximum.
 - Because each of these adjustments are vital to perfect Dolby N.R. circuit operation, be sure that they are carried out with as little error as possible.
 - Supply the 1,000 Hz signal from the oscillator, adjust the Rec VR or the oscillator output to give an output of -5.5 dBm (410 mV).
 - Except for Steps 6 thru 8 and 10 set tape selector to Low Noise position.
 - Except for Step 11, set DOLBY N.R. switch to OFF position.
 - Use the following cassette measuring tape:
 - LN Tape: Fuji FL C-60
 - LH Tape: Maxell UD C-60
 - CrO₂ Tape: TDK SA C-60
 - Fe-Cr Tape: SONY Duad C-60
 - Stop recording bias oscillator while making Rec Peaking Adjustment (Refer to Fig. 12, 13)
 - If a flat characteristic cannot be obtained from 1,000 Hz to 10,000 Hz at LH, CrO₂, or Fe-Cr positions, fine adjust at VR8 (LH), VR9 (CrO₂), or VR10 (Fe-Cr) respectively.
 - If it does not comply with the specifications, repeat Steps 5 to 9 and re-adjust.
 - Adjust the oscillator's frequency to give a frequency counter reading of 19.00 kHz.
 - Unless the core is moved intentionally this adjustment is not necessary.

VIII. DC RESISTANCE OF VARIOUS COILS

Parts	Designation	DC Resistance
Recording/Playback Head	P4-360E	370 ohms
Erase Head	HF213822A	4.5 ohms
Plunger Solenoid	0730PHT1	15 ohms \pm 10%

Chart-2

IX. CLASSIFICATION OF VARIOUS P.C BOARDS

1. P.C BOARD TITLE AND IDENTIFICATION NUMBER

P.C Board Title	P.C Board Number
Pre Amp P.C Board	CN-5301A
Power Supply & Sys. Con P.C Board	CN-5330
Power Supply & Sys. Con P.C Board	CN-5302
Peak Indicator P.C Board	CN-5301B
Headphone P.C Board	CN-5305
Dolby & REC Indicator P.C Board	CN-5304
Housing Lamp P.C Board	CN-5303

Chart-3

3) POWER SUPPLY & SYS. CON P.C BOARD CN-5330 and HOUSING LAMP P.C BOARD CN-5303 (BEAB, SAA)

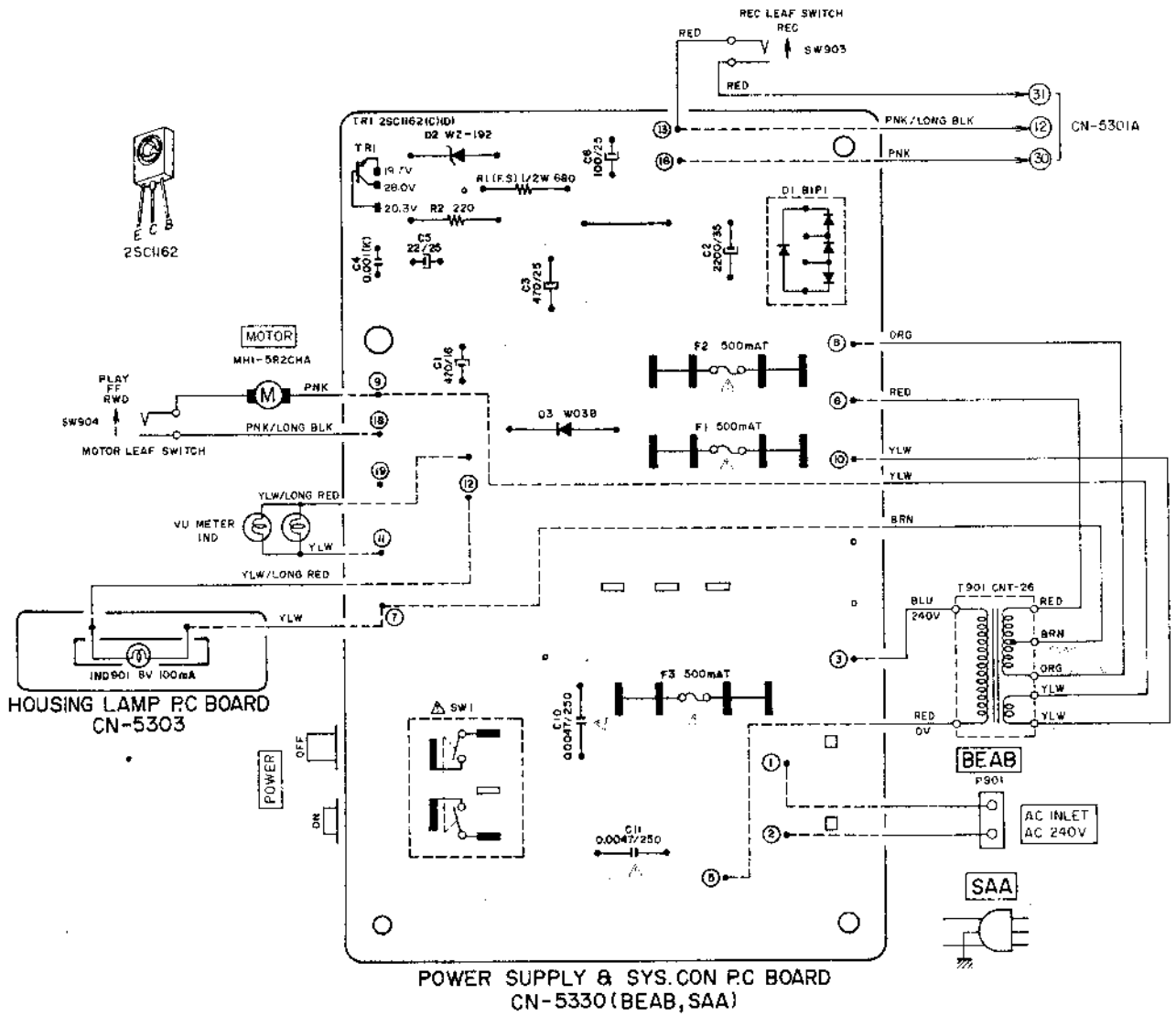

SECTION 2

PARTS LIST

TABLE OF CONTENTS

1. RECOMMENDED SPARE PARTS LIST	28
2. HEAD BLOCK	30
3. MOTOR BLOCK	31
4. MECHA FRAME BLOCK	32
5. P.C BOARDS	34
(1) PRE AMP P.C BOARD (CN-5301A) BLOCK	34
(2) POWER SUPPLY & SYS. CON P.C BOARD (CN-5302)/(CN-5330) BLOCK	34
6. FINAL ASSEMBLY BLOCK (1)	35
7. FINAL ASSEMBLY BLOCK (2)	36
8. LIST OF INTERCHANGEABLE SEMICONDUCTORS	37
INDEX	38

Resistor and Capacitor which is not listed in this parts list, please refer to COMMON LIST FOR SERVICE PARTS.

HOW TO USE THIS PARTS LIST

1. This parts list is compiled by various individual blocks based on assembly process.
2. When ordering parts, please describe parts number, serial number, and model number in detail.
3. How to read List

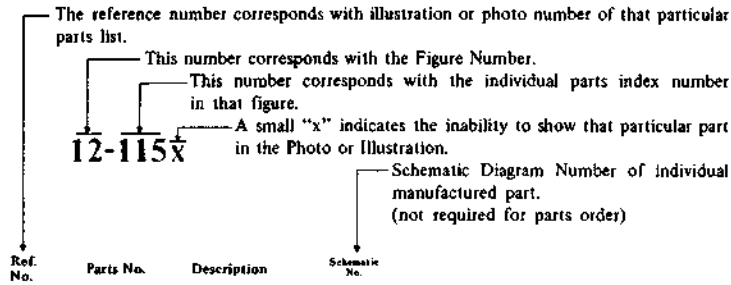

4. The symbol numbers shown on the P.C. Board list can be matched with the Composite Views of Components of the Schematic Diagram or Service Manual.
5. Please utilize separate "Common List for Service Parts" for Resistor Parts orders.
6. The shape of the parts and parts name, etc. can be confirmed by comparing them with the parts shown on the Electrical Parts Table of P.C. Board.
7. Both the kind of part and installation position can be determined by the Parts Number. To determine where a parts number is listed, utilize Parts Index at end of Parts List.
It is necessary first of all to find the Parts Number. This can be accomplished by using the Reference Number listed at right of parts number in the Parts Index. (meaning of ref. no. outlined in Item 3 above).
8. Utilize separate "Price List for Parts" to determine unit price. The most simple method of finding parts Price is to utilize the reference number.

CAUTION:

1. When placing an order for parts, be sure to list the parts no., model no., and description. There are instances in which if any of this information is omitted, parts cannot be shipped or the wrong parts will be delivered.
2. Please be careful not to make a mistake in the parts no. If the parts no. is in error, a part different from the one ordered may be delivered.
3. Because parts number and parts unit supply in the Preliminary Service Manual (Basic Parts List) may be partially changed, please use this parts list for all future reference.

WARNING: Δ INDICATES SAFETY CRITICAL COMPONENTS. FOR CONTINUED SAFETY, REPLACE SAFETY CRITICAL COMPONENTS ONLY WITH MANUFACTURER'S RECOMMENDED PARTS.

AVERTISSEMENT: Δ IL INDIQUÉ LES COMPOSANTS CRITIQUES DE SÛRETÉ. POUR MAINTENIR LE DEGRÉ DE SÛRETÉ DE L'APPAREIL NE REMPLACER LES COMPOSANTS DONT LE FONCTIONNEMENT EST CRITIQUE POUR LA SÛRETÉ QUE PAR DES PIÈCES RECOMMANDÉES PAR LE FABRICANT.

AC INLET SYSTEM

This model is equipped with an AC INLET SYSTEM. Please refer to the AC INLET SYSTEM CHART below for the specific type. By the AC INLET SYSTEM, AC (mains) cord can be connected to and disconnected from the model because the model is provided with socket exclusively for AC (mains) cord on its main body. Please note, however, that certain models are not equipped with this system and has a built-in AC (mains) cord as before.

AC INLET SYSTEM CHART

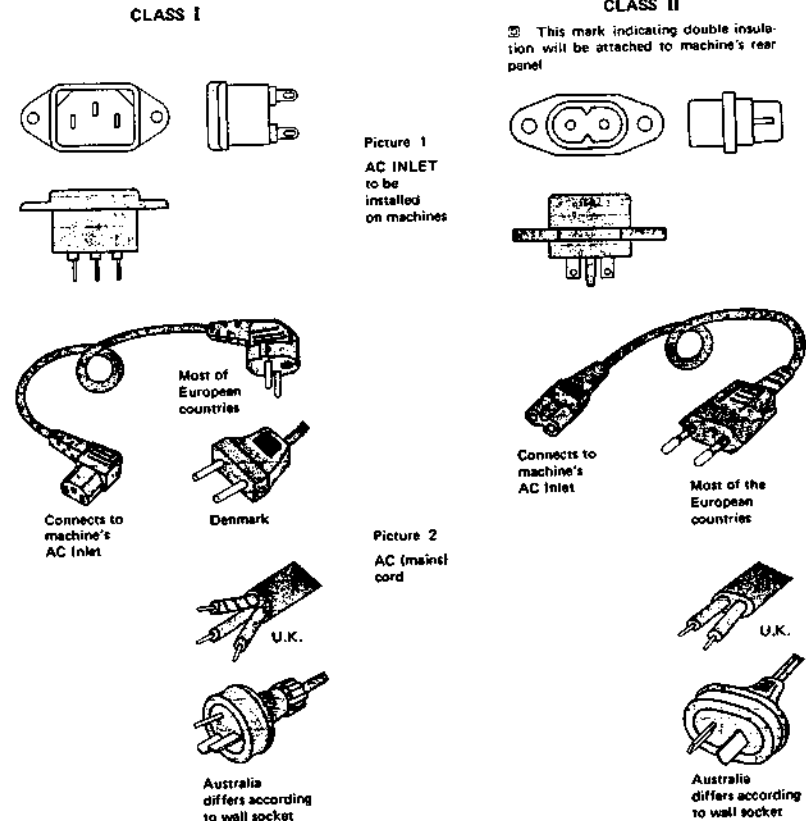

Parts List for AC (mains) Cord Set

	Standard	Description	Type of AC Inlet	Parts No.
Class I	CEE	Cord Set CEE (3 cores)	3P	EW302993
	BEAB	Cord Set BEAB (3 cores)	3P	EW302994
	SAA	Cord Set SAA (3 cores)	3P	EW302996
	U/T	Cord Set U/T (3 cores)	3P	EW302646
Class II	CEE	Cord Set CEE (2 cores)	2P	EW638144
	BEAB	Cord Set BEAB (2 cores)	2P	EW302995
	SAA	Cord Set SAA (2 cores)	2P	EW302991
	U/T	Cord Set U/T (2 cores)	2P	EW302899

1. RECOMMENDED SPARE PARTS LIST

Because, if the parts listed below are on hand, almost any repair can be accomplished, we suggest that you stock these Recommended Spare Parts Items.

Parts No.	Description	Note
BA305883	Pre Amp P.C Board Comp. GXC-706D	
BA305851	Power Supply & Sys. Con P.C Board Comp. GXC-706D (U/T)	
BA305852	Power Supply & Sys. Con P.C Board Comp. GXC-706D (JPN)	
BA305854	Power Supply & Sys. Con P.C Board Comp. GXC-706D (CSA)	
BA305855	Power Supply & Sys. Con P.C Board Comp. GXC-706D (AAL)	
BA305856	Power Supply & Sys. Con P.C Board Comp. GXC-706D (CEE)	
BA305857	Power Supply & Sys. Con P.C Board Comp. GXC-706D (BEAB)	
BH305861	Head Block Comp. GXC-706D	
BM305865	Motor Block Comp. GXC-706D CN-1311	
BT305600	△ Power Trans. CNT-21 (U/T)	T901
BT305601	△ Power Trans. CNT-22 (JPN)	T901
BT305603	△ Power Trans. CNT-24 (CSA, AAL)	T901
BT305602	△ Power Trans. CNT-23 (CEE)	T901
BT305604	△ Power Trans. CNT-26 (BEAB)	T901
BZ282881	Auto Stop Comp. CN-3014	Same as CS-702D
ED306110	Silicon Diode B1P1	
ED306109	Silicon Diode W03B	
ED624903	Silicon Diode 1S2473	
ED219464	Germanium Diode 1N34A	
ED498150	Zener Diode WZ-192	
ED249377	LED GL-3AR1	
ED283138	LED GL-3PG1	
EI605013	IC NE545B	
EI306141	IC LA4170	
EL283184	Lamp (L/T) 8V 100 mA	
ES301747	Leaf SW. BSW-1F TX-2	SW903
ES283151	Leaf SW. BSW-31 (PL)	SW904
ES283173	Leaf SW. BUW-31PLC	SW901
ES312050	Slide SW. CL212K12A	SW1
ES305727	Push SW. SUF-24	SW2
ES305723	Rotary Slide SW. SRZ-L084	SW3
ES665807	△ Push SW. SDG-5P 5A/80A 250V	U/T, CEE, BEAB, SW1
ES665806	△ Push SW. SDG-1P	JPN SW1
ES665875	△ Push SW. SDG-1P U/L	CSA, AAL SW1
ES306134	△ Slide SW. TSS-012164	U/T SW2
ET603257	Transistor 2SC1312 (G) (H)	
ET399846	Transistor 2SC945L (Q)	
ET638504	Transistor 2SC945L (P)	
ET639437	Transistor 2SC945L (Q) (P)	
ET520266	Transistor 2SC1211 (E)	

Parts No.	Description	Note
ET301154	Transistor 2SC1162 (C) (D)	
ET563905	Transistor 2SC711 (G) (H)	JPN
ET398711	Transistor 2SC945L (Q) (R)	JPN
ET303697	FET 2SK117 (GR)	
EV464207	Semi-fixed/Vol. V8K4-1 5 kB	VR1
EV464220	Semi-fixed/Vol. V8K4-1 50 kB	VR2, 8, 10
EV520806	Semi-fixed/Vol. V8K4-1 10 kB	VR5, 6, 9
EV550023	Semi-fixed/Vol. V10K8-4-2 100 kB	VR7
EV305631	Double axial 2 throw Vol. DM20R-50 kA×2	VR901
EV305630	Single axial 2 throw Vol. GM70R-10 kA×2	VR902
HE266466	ERASE HEAD HF213822A	Same as GXC-709D
HP300795	REC/PB HEAD P4-360Σ	Same as GXC-709D
MB283421	AS Belt CN-1066	Same as CS-702D
MB282093	Capstan Belt CN-1017	Same as CS-702D

2. ILLUSTRATION OF HEAD BLOCK

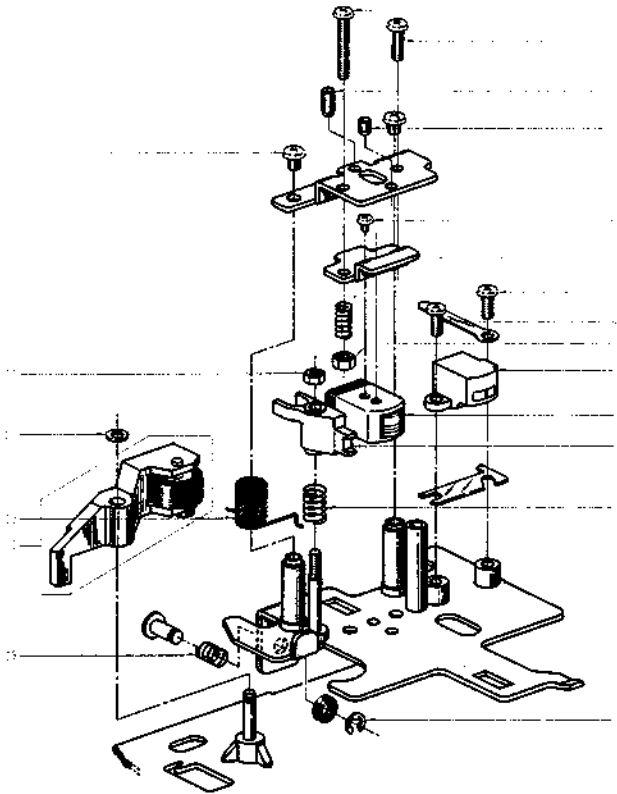

2) HEAD BLOCK

Ref. No.	Parts No.	Description	Schematic No.	Ref. No.	Parts No.	Description	Schematic No.
2-1	BL300249	Pinch Roller Block Comp. GXC-709D	CN-9708	2-11	HP300795	REC/PB HEAD P4-360Σ	
				2-12	ZS300626	Screw, pan head 2x1.5 (camera standard)	
2-2x	BH305861	Head Block Comp. GXC-7-6D		2-13	ZG305736	Pinch Roller Spring	CN-6304
2-3	HE266466	ERASE HEAD HF213822A	37-24	2-14	ZG289236	Tape Guide Spring	CN-0005
2-4	ZS375118	Screw, binding head 1.3x6		2-15	ZW273734	Nut #1, M2	
2-5	ZG465636	Angle Adjust Spring	CC-0029	2-16	TC286007	Tape Guide (B)	CN-0002
2-6	ZS391522	Screw, pan head 2.3x8		2-17	ZS422076	Screw, pan head 3x5	
2-7	ZS303625	Screw, pan head 2.3x16		2-18	ZG310453	Clamp Spring	CN-6311
2-8	ZW273690	Nut #1, M2.3		2-19	ZW270088	'E' Ring 1.9M	6-1-9
2-9	ZS356804	Set Screw, hexagon socket 3x4 (CUP/P.)		2-20x	ZS432843	Screw, pan head 2.6x4	
2-10	ZS356815	Set Screw, hexagon socket 3x6 (CUP/P.)		2-21	ZW282407	Push Washer (B)	CN-1056

When ordering parts, please describe Parts Number, Description, and Model Number in detail.

3. ILLUSTRATION OF MOTOR BLOCK

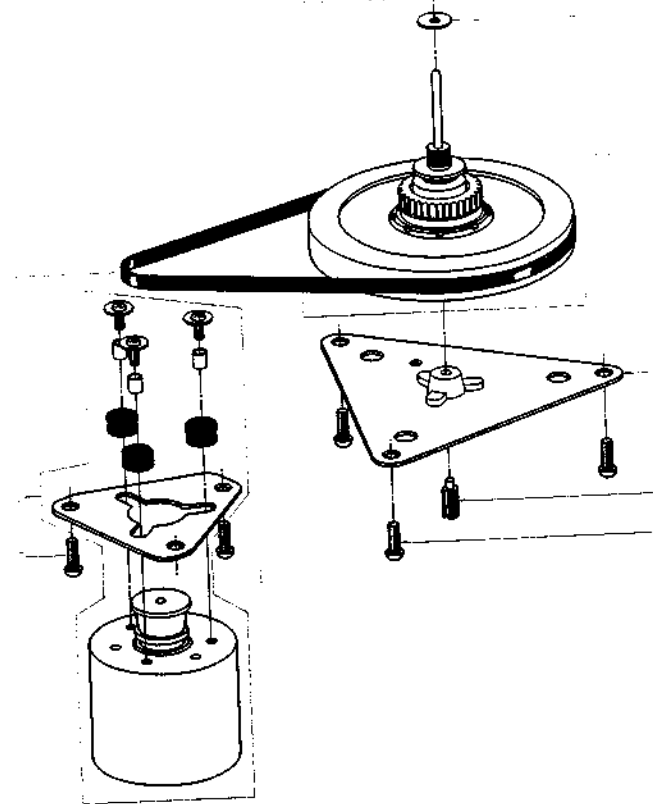

3) MOTOR BLOCK

Ref. No.	Parts No.	Description	Schematic No.
3-1	BM305865	Motor Block Comp. GXC-706D	CN-1311
3-2	BF305887	Flywheel Part GXC-706D	CN-1060
3-3	ZW232442	Thrust Washer	CN-1017
3-4	MB382093	Capstan Belt	CN-1010
3-5	BZ280337	Flywheel Holder Plate Part	CN-1009
3-6	ZS297628	Adjust Screw	
3-7	ZS447840	Tapping Screw #2, 3x8 (BR)	

When ordering parts, please describe Parts Number, Description, and Model Number in detail.

4. ILLUSTRATION OF MECHA FRAME BLOCK

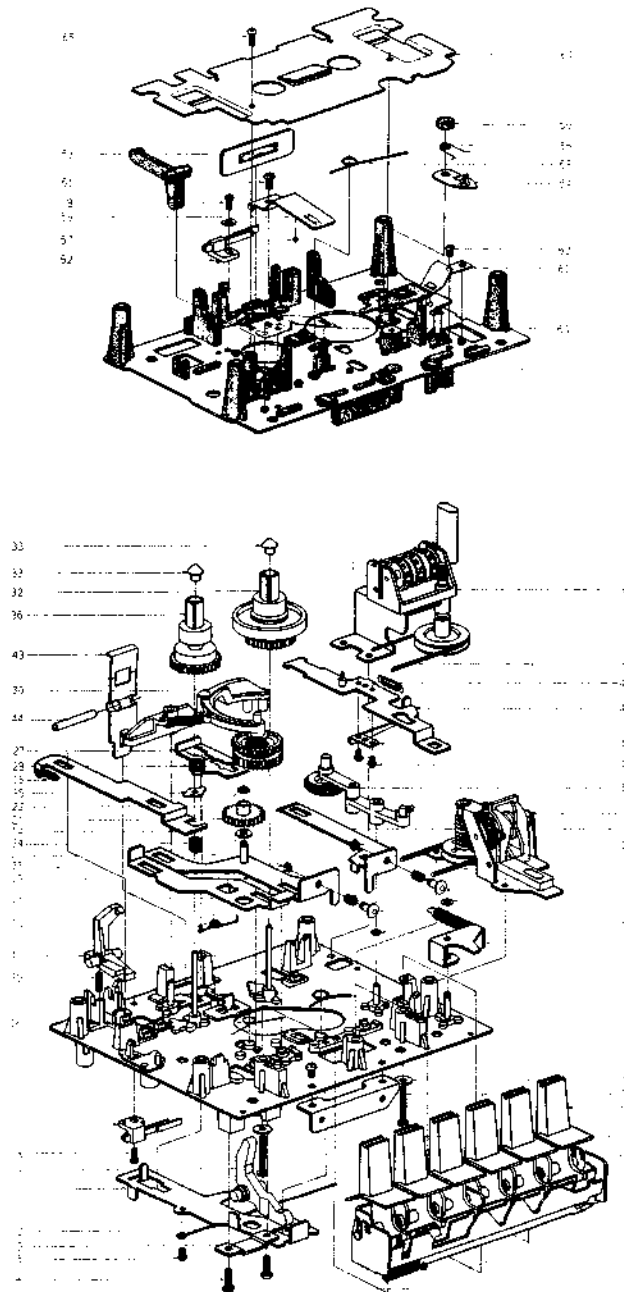

4) MECHA FRAME BLOCK

Ref. No.	Parts No.	Description	Schematic No.	Ref. No.	Parts No.	Description	Schematic No.
4-1	TC282047	Brake Slide (B)	CN-1812	4-73	ZW550642	Washer (SPC) D3.1x8x0.5t	
4-2	TC282238	Reset Spoke	CN-1834	4-74x	ZW287458	Washer (BSP) D3.3x6x0.3t	
4-3	ZS417251	Screw, binding head 2.3x3		4-75x	ZS523664	Tapping Screw #2, 3x10 (BR)	
4-4	ML282328	REC Lever	CN-1043				
4-5	MZ282330	REC Lever Stopper	CN-1044				
4-6	ZS447840	Tapping Screw #2, 3x8 (BR)					
4-7	ES283151	Leaf SW. BSW-31 (PL)	25-10-26				
4-8	ZS537085	Screw, binding head 2x5					
4-9	MC305717	Counter MP-390-211	9-1-59				
4-10x	ZS200384	Screw, countersunk head 3x6					
4-11	BZ282881	Auto Stop Comp.	CN-3014				
4-12	MB283421	AS Belt	CN-1046				
4-13	ZS432843	Screw, pan head 2.6x4					
4-14	ML305618	Eject Slide	CN-1302				
4-15	ZG385986	Safety Lever Return Spring	CS-2539				
4-16	ZG282126	Return Spring	CN-1822				
4-17	ZG282464	Return Spring (B)	CN-1905				
4-18	TC282197	REC Slide	CN-1823				
4-19	TC281788	RWD Slide Part CN	CN-1824				
4-20	ZW694798	Washer (Teflon) D3.1x7x0.2t					
4-21	TC282161	RWD Wheel	CN-1825				
4-22	ZW282407	Push Washer (B)	CN-1856				
4-23	MS282172	Spring Shaft	CN-1827				
4-24	ZG282183	Spring	CN-1828				
4-25	ZW270088	'E' Ring 1.9M	9-1-59				
4-26	ZG282115	Brake Spring	CN-1831				
4-27	TC282262	Brake Slide (A)	CN-1837				
4-28	MB282104	Brake Rubber	CN-1820				
4-29	TC282194	F, F Slide	CN-1829				
4-30	BL282510	Middle Lever Part	CN-2023				
4-31	MB305617	Counter Belt	CN-1501				
4-32	MT305769	Take-up Reel Table (B) Part	13-2-49				
4-33	MT305793	Reel Cap	CF-2839				
4-34	ZG282418	Back Tension Spring	CN-1857				
4-35	ZW282420	Spring Spot Facing Washer	CN-1858				
4-36	MT305770	Supply Reel Table (B) Part	13-2-50				
4-37	ZW381644	Washer (Polyslider) D2.1x4.0x0.131					
4-38	BL282508	Take-up Lever Part	CN-2022				
4-39	ZG282431	REC Safety Spring	CN-1859				
4-40	ML282240	REC Safety Lever	CN-1035				
4-41	ML282273	Auto Stop Lever	CN-1038				
4-42	ZG606723	Spring T	K3-2059				
4-43	ZG282251	Cassette Stopping Spring	CN-1838				
4-44	MH284185	Spring Pin 3x22					
4-45	TC288468	Pause Slide Part CN	CN-1831				
4-46	TC282227	Scraper	CN-1833				
4-47	ZS374646	Screw, pan head 2x2					
4-48	ZG387178	Idler Tension Spring	CS-1106				
4-49x	ZG303235	Tapping Screw #2, 3x10 (Blad)					
4-50x	ZS650013	Tapping Screw #1, 3x15 (BR)					
4-51	ZS417216	Screw, pan head 3x4					
4-52	ES283173	Leaf SW. BUW-31PLC	25-10-26				
4-53	EL283184	Lamp (L/T) 8V 100mA	28-2-59				
4-54	TC513575	SW. Lock Cam (B)	CG-2301				
4-55	ZG632553	Button Lock Spring (C)	CG-2303				
4-56	TC282396	Cap	CN-1655				
4-57	MV357208	Steel Ball D2					
4-58	ZG282341	Head Return Spring	CN-1048				
4-59	ZG305620	Head Base Holder Spring	CN-1304				
4-60	ZG300881	Head Retaining Spring (A)	CN-1079				
4-61	ZG300882	Head Retaining Spring (B)	CN-1079				
4-62	ZS201407	Screw, pan head 2.3x3					
4-63x	ZS422076	Screw, pan head 3x5 (JPN)					
4-64	TC305762	Decoration Plate Assy GXC-706D	CN-1370				
4-65	ZS306078	Tapping Screw #2, 2.3x5 (Truss) (Black)					
4-66	BK305797	Keyboard Comp. (A) CN-2	25-5-274				
4-67	SK306096	Function Key (A)	CN-3031				
4-68	SK306097	Function Key (B)	CN-3031				
4-69x	BK305798	Keyboard Comp. (B) CN-2 (BL)	25-5-274				
4-70x	SK306098	Function Key (C)	CN-3031				
4-71x	SK306099	Function Key (D)	CN-3031				
4-72	ZS608253	Screw, pan head 3x20					

When ordering parts, please describe Parts Number, Description, and Model Number in detail.

5. P.C BOARDS

(1) PRE AMP P.C BOARD (CN-5301A) BLOCK

Symbol No.	Parts No.	Description	Schematic No.
(1)-1	BA305883	Pre Amp P.C Board	
		Comp. GXC-706D	CN-5331
(1)-JC1	E1605013	IC NE545B	45-1-117
(1)-JC2	E1306141	IC LA4170	45-4-305
(1)-TR1(to3)	ET603257	Transistor	
		2SC1312S (G) (H)	45-1-182
(1)-TR4	ET399846	Transistor 2SC945L (Q)	45-1-85
(1)-TR5	ET303697	FET 2SK117 (GR)	45-12-15
(1)-TR6	ET639437	Transistor	
		2SC945L (Q) (P)	45-1-85
(1)-TR7,8	ET638504	Transistor 2SC945L (P)	45-1-85
(1)-TR9	ET639437	Transistor	
		2SC945L (Q) (P)	45-1-85
(1)-TR10,11	ET520266	Transistor 2SC1211 (E)	45-1-95
(1)-D1(to4)	ED219464	Germanium Diode 1N34A	45-3-1
(1)-D5	ED249377	LED GL-3AR1	45-15-14
(1)-D6	ED219464	Germanium Diode 1N34A	45-3-1
(1)-D7	ED624903	Silicon Diode 1S2473	45-3-28
(1)-VR1	EV464207	Semi-fixed/Vol. V8K4-1	36-10-266
		5 kΩ	
(1)-VR2	EV464220	Semi-fixed/Vol. V8K4-1	36-10-266
		50 kΩ	
(1)-VR5,6	EV520806	Semi-fixed/Vol. V8K4-1	36-10-266
		10 kΩ	
(1)-VR7	EV550023	Semi-fixed/Vol.	
		V10K8-4-2 100kΩ	36-10-250
(1)-VR8	EV464220	Semi-fixed/Vol. V8K4-1	36-10-266
		50 kΩ	
(1)-VR9	EV520806	Semi-fixed/Vol. V8K4-1	36-10-266
		10 kΩ	
(1)-VR10	EV464220	Semi-fixed/Vol. V8K4-1	36-10-266
		50 kΩ	
(1)-T1	EO283050	OSC Coil 09A-1359	23-4-0
(1)-L1	EO692741	Ferr Inductor 33Y-740	23-1-254
(1)-L2	EO656943	Inductor RCP-095	
		22mH (K)	23-1-85
(1)-FL1	ER305676	Dolby Filter FB-2000B	53-1-128
(1)-SW1	ES312050	Slide SW. CL212K12A	25-3-163
(1)-SW2	ES305727	Push SW. SUF-24	25-5-277
(1)-SW3	ES305723	Rotary Slide SW.	
		SRZ-L084	25-5-146
(1)-J1	EJ305739	Mic Jack J12	31-5-89
(1)-J2	EJ283094	4P PIN Jack 1-01-0107-01	31-5-137
(1)-R32	ER306639	Metal Oxide Film/R.	
		(Homing Type)	
		3W 100 ohms (J)	35-11-23
(1)-R48	ER305722	Metal Oxide Film/R.	
		(Homing Type)	
		2W 220 ohms (J)	35-11-22
(1)-R54	ER305722	Metal Oxide Film/R.	
		(Homing Type)	
		2W 220 ohms (J)	35-11-22
(1)-C1	EC305677	Styrol/C. 200PF (K)	
		50WV	24-11-14
(1)-C3	EC306635	Mylar/C. (Tape Type)	
		10μF 16WV NL	24-21-3
(1)-C4	EC305678	Styrol/C. 470PF (K)	
		50WV	24-11-14
(1)-C7	EC306600	Elect./C. (Tape Type)	
		0.47μF 50WV	24-21-1
(1)-C50	EC305680	Styrol/C. 150PF (J)	
		50WV	24-11-14
(1)-C60	EC284163	Styrol/C. (w/rubber)	
		1000PF (J) 250WV	24-11-13
(1)-2	ZS379350	Screw, pan head 3x6	
(1)-3	ZS558101	Screw, pan head 3x6	
		w/washer	
(1)-4	ZW263946	Nylon Rivet 4x5	2-7-57
(1)-5	ZS325495	Tapping Screw #2, 3x6	
		(BR)	
(1)-6	ZW273802	Toothed Lock Washer, M3	
(1)-7	MS305048	Selector Shaft	CN-5328
(1)-8	ZS417216	Screw, pan head 3x4	

(2) POWER SUPPLY & SYS. CON P.C BOARD (CN-5302)/(CN-5330) BLOCK

Symbol No.	Parts No.	Description	Schematic No.
(2)-1	BA305851	Power Supply & Sys. Con	
		P.C Board Comp.	
		GXC-706D (U/T)	CN-5334
(2)-2	BA305852	Power Supply & Sys. Con	
		P.C Board Comp.	
		GXC-706D (JPN)	CN-5334
(2)-3	BA305854	Power Supply & Sys. Con	
		P.C Board Comp.	
		GXC-706D (CSA)	CN-5334
(2)-4	BA305855	Power Supply & Sys. Con	
		P.C Board Comp.	
		GXC-706D (AAL)	CN-5334
(2)-5	BA305856	Power Supply & Sys. Con	
		P.C Board Comp.	
		GXC-706D (CEE)	CN-5334
(2)-6	BA305857	Power Supply & Sys. Con	
		P.C Board Comp.	
		GXC-706D (BEAB)	CN-5334
(2)-TR1	ET301154	Transistor	
		2SC1162 (C) (D)	45-1-268
(2)-TR2	ET563905	Transistor	
		2SC711 (G) (H) (JPN)	45-1-47
(2)-TR3	ET398711	Transistor	
		2SC945L (Q) (R) (JPN)	45-1-85
(2)-TR4	ET301154	Transistor	
		2SC1162 (C) (D) (JPN)	45-1-268
(2)-D1	ED306110	Silicon Diode B1P1	45-3-77
(2)-D2	ED498150	Zener Diode WZ-192	45-6-87
(2)-D3	ED306109	Silicon Diode W03B	45-3-78
(2)-D4	ED306109	Silicon Diode W03B(JPN)	45-3-78
(2)-R1	ER306127	Carbon/R. (Stop. Type)	
		(F) 1/2W 680 ohms (J)	35-11-27
(2)-R3	ER336442	Carbon/R. RD1/4	
		10k (J) (JPN)	35-10-1
(2)-SW1	ES665807	Δ Push SW. SDG-5P	
		5A/80A 250V	
		(U/T, CEE, BEAB)	25-5-102
(2)-SW1	ES655806	Δ Push SW. SDG-1P	
		(JPN)	25-5-107
(2)-SW1	ES665875	Δ Push SW. SDG-1P	
		U/L (CSA, AAL)	25-5-109
(2)-SW2	ES306134	Δ Slide SW. TSS-012164	
		(U/T)	25-3-148
(2)-F1,2	EF593706	Δ Fuse (SEMKO	
		T Type) 500 mA T	
		(U/T, CEE, BEAB)	39-1-53
(2)-F1,2	EF563681	Δ Fuse 1A 250V (JPN)	39-1-50
(2)-F1,2	EF304626	Δ Fuse ST-4 1A	
		(CSA, AAL)	39-1-28
(2)-F3	EF593706	Δ Fuse (SEMKO	
		T Type) 500mA T (BEAB)	39-1-53
(2)-C2	EC286222	Elect./C. (Vert. Type)	
		2200μF 35WV	24-12-9
(2)-C8	EC286222	Elect./C. (Vert. Type)	
		2200μF 35WV (JPN)	24-12-9
(2)-C10	EC301320	Δ MP/C. PME271Y447	
		4700PF 250WV	
		(U/T, CEE, BEAB)	24-9-122
(2)-C10	EC551160	Δ Ceramic/C. DB821NA	
		0.01μF (Z) 1.4kVW (JPN)	24-5-55
(2)-C10	EC286198	Δ Ceramic/C. AL-10	
		0.01μF (Z) 125WV (CSA)	24-5-49
(2)-C10	EC551160	Δ Ceramic/C. DB821NA	
		0.01μF (Z) 1.4kVW (AAL)	24-5-55
(2)-C11	EC301320	Δ MP/C. PME271Y447	
		4700PF 250WV	
		(U/T, CEE, BEAB)	24-9-122
(2)-7	ZS422076	Screw, pan head 3x5	
(2)-8	ZS379350	Screw, pan head 3x6	
(2)-9	TC289484	SW. Joint	CN-6015

When ordering parts, please describe Parts Number, Description, and Model Number in detail.

6. ILLUSTRATION FINAL ASSEMBLY BLOCK (1)

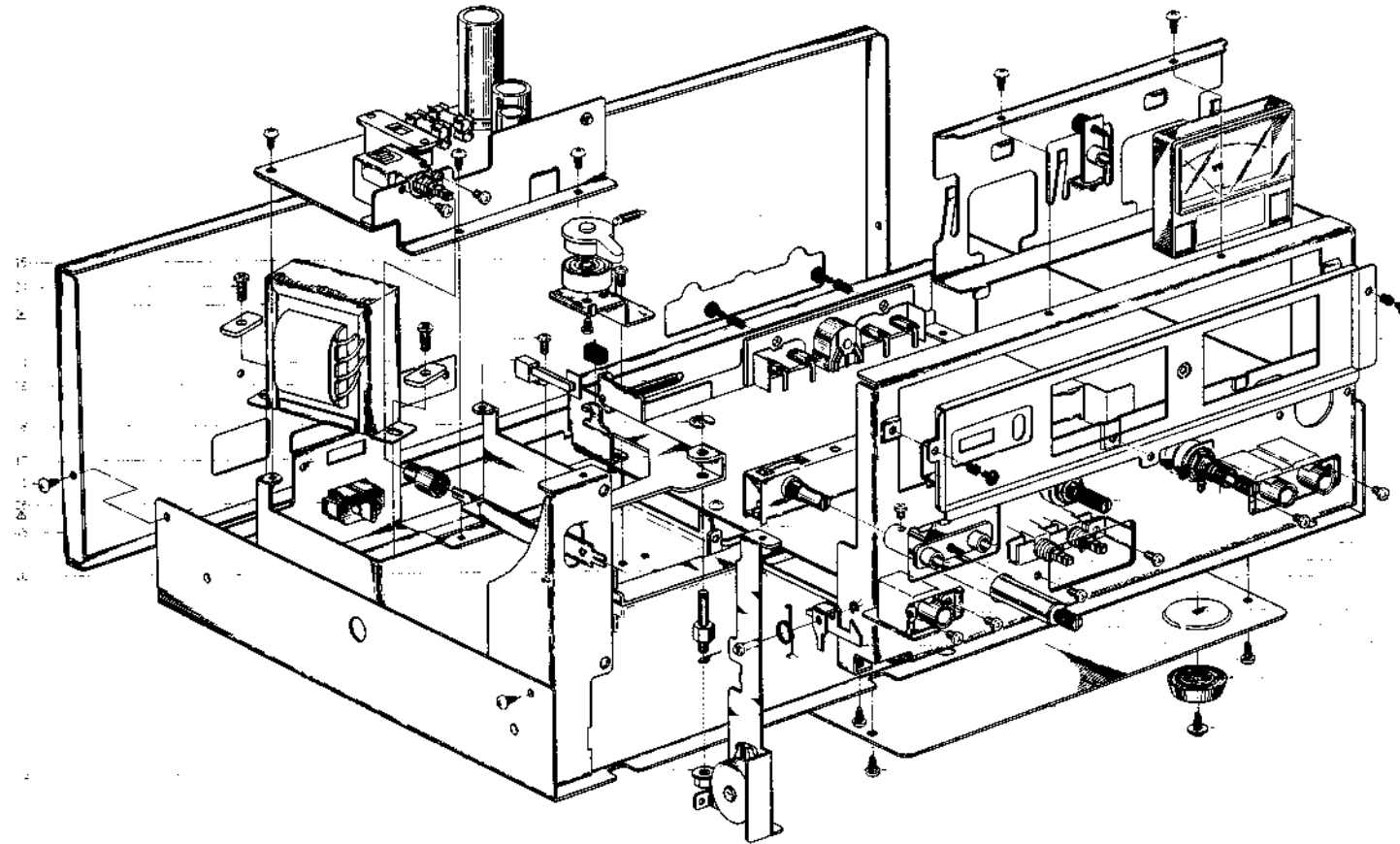

6) FINAL ASSEMBLY BLOCK (1)

Ref. No.	Parts No.	Description	Schematic No.	Ref. No.	Parts No.	Description	Schematic No.	Ref. No.	Parts No.	Description	Schematic No.				
FRONT PANEL BLOCK				6-13	ZS306021	S Tight Screw, 3x6 (Pan)	25-10-34	6-28x	EZ631945	Strain Relief SR-4N-4 (JPN, CSA, AAL)	2-7-49				
6-1	ZS325495	Tapping Screw #2, 3x6 (BR)	CN-4359	6-14	ES301747	Leaf SW. BSW-1F TX-2	CN-5335	6-29x	ZS301574	S Tight Screw, 4x6 (Pan)	6-40x	EM305633	VU Meter S11ADR68A (JPN)	46-1-166	
6-2	TC305729	Damper Comp. (A) GXC-706D		6-15	TC305728	OH Clutch Comp. (E) GXC-706D	CN-5312	6-30x	EW306152	Δ AC Cord Set U/T Type 2 (U/T)	26-3-71	6-41x	EM306132	VU Meter S11ADR68C	46-1-193
6-3x	ZS422076	Screw, pan head 3x5		6-16	ML305683	REC Slide Lever	CN-5311					6-42	SP305698	Meter Panel	CN-6320, 6321
6-4x	ZW603797	Adjust. Washer (U) D4x13x0.5t		6-17	ML305628	REC Lever	CN-5312					6-43x	SP306170	Meter Panel (BL)	CN-6320, 6321
6-5	TC305664	Lock Plate	CN-6315	6-18	ZG308641	REC Spring	CN-5313	6-31x	ZS447840	Tapping Screw #2, 3x8 (BR)		6-44	ZW302909	Nylon Rivet (FNRP) 3x3.5 (Black)	2-7-54
6-6	ZG300172	Lock Spring	CM-6029	6-19	BT305600	Δ Power Trans. CNT-21 (U/T)	38-4-580	6-32x	ZW273802	Toothed Lock Washer, M3	45-15-15	6-45	SP306158	Rear Panel (E) (U/T)	CN-6324, 6325
6-7	ZW270058	E' Ring 1.9M	6-1-9	6-20x	BT305601	Δ Power Trans. CNT-22 (JPN)	38-4-581	6-33	ED283138	LED GL-3PG1	45-15-14	6-46x	SP306153	Rear Panel (A) (JPN)	CN-6324, 6325
6-8	ZW290283	U' Ring 2.65M	6-1-1	6-21x	BT305603	Δ Power Trans. CNT-24 (CSA, AAL)	38-4-583	6-34	ED249377	LED GL-3AR1	31-2-98	6-47x	SP306155	Rear Panel (C) (CSA)	CN-6324, 6327
FINAL ASSEMBLY BLOCK				6-22x	BT305602	Δ Power Trans. CNT-23 (CEE)	38-4-582	6-35	EJ305629	Headphone Jack J1.3A	38-18-12	6-48x	SP306154	Rear Panel (B) (AAL)	CN-6324, 6328
6-9	SP305746	Bottom Plate	CN-4322	6-23x	BT305604	Δ Power Trans. CNT-26 (BEA B)	38-4-584	6-36	EV305631	Double axial 2 throw Vol. GM20R-50KAx2	38-1-12	6-49x	SP306160	Rear Panel (G) (CEE)	CN-6324, 6354
6-10	SA305646	Rubber Foot (A) (Black)	CN-5323	6-24	ZS301576	S Tight Screw, 4x10 (Pan)		6-37	EV305630	Single axial 2 throw Vol. GM70R-10KAx2	38-1-56	6-50x	SP306159	Rear Panel (F) (BEA B)	CN-4324, 6353
6-11	ZS498273	Tapping Screw #2, 3x8 (BR)	W=8	6-25	EJ301513	2P Inlet (U/T, CEE, BEA B)	31-1-200					6-51x	ZS307259	Tapping Screw #2, 3x5 (BR) (BLACK)	7-6-9
6-12	ZW413267	Flange Nut M4		6-26x	EW524845	Δ AC Cord (JPN)	26-3-31	6-38x	ZS523664	Tapping Screw #2, 3x10 (BR)	46-1-187	6-52x	ZW305013	Pop Rivet D3.2 (AAL)	
				6-27x	EW207742	Δ AC Cord CUL (CSA, AAL)	26-3-45	6-39	EM305634	VU Meter S11ADR68B					

When ordering parts, please describe Parts Number, Description, and Model Number in detail.

7. PHOTO OF FINAL ASSEMBLY BLOCK

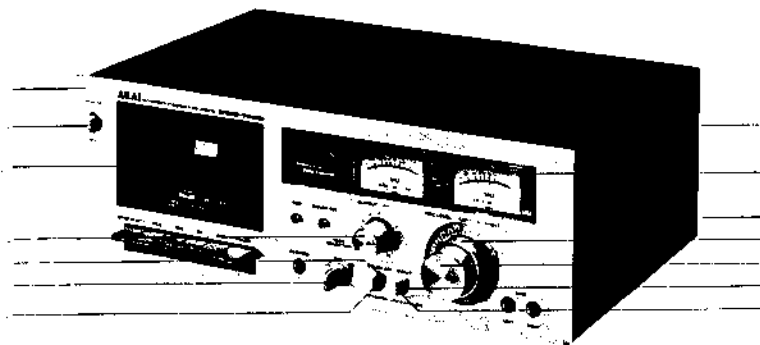

7) FINAL ASSEMBLY BLOCK

Ref. No.	Parts No.	Description	Schematic No.
FRONT PANEL BLOCK			
7-1	BD305862	Front Panel Block Comp. GXC-706D (U/T)	CN-6350
		(U/T, CSA, AAL, CEE, BEAB)	
7-2x	BD305863	Front Panel Block Comp. GXC-706D (JPN)	CN-6350
7-3x	BD305864	Front Panel Block Comp. GXC-706D-BL	CN-6350
7-4x	TC306770	Lid Frame (B)	CN-6358
7-5x	ZG282690	Set Spring	CN-6009
7-6x	ZS201407	Screw, pan head 2.3x3	
7-7x	ZW270101	'E' Ring 3M	61-9
7-8x	ZW516611	Nut M3	
7-9	SE306143	Button Escutcheon (A)	CN-6380
7-10x	SE306144	Button Escutcheon (A-BL)	CN-6380
7-11x	ZG305657	Button Spring	CN-6310
7-12	SK305653	Push Button (A)	CN-6309
7-13x	SK305656	Push Button (D) (BL)	CN-6309
7-14x	SE305651	Button Escutcheon (B) (JPN)	CN-6352
7-15x	ZG305657	Button Spring (JPN)	CN-6310
7-16x	SK305654	Push Button (B) (JPN)	CN-6309
7-17	BD305885	Lid Panel Assy GXC-706D	CN-6351
FINAL ASSEMBLY BLOCK			
7-18	SK305674	Power SW. Cap	CN-6338
7-19x	SK306130	Power SW. Cap (BL)	CN-6338
7-20	SK305669	Double Knob (Lower)	CN-6333
		GXC-706D	
7-21x	SK306104	Double Knob (Lower-BL)	CN-6333
		GXC-706D	
7-22	SK305668	Double Knob (Upper)	CN-6331
		GXC-706D	
7-23x	SK306103	Double Knob (Upper-BL)	CN-6331
		GXC-706D	
7-24	SK305670	Output Knob GXC-706D	CN-6335
7-25x	SK306105	Output Knob (BL) GXC-706D	CN-6335
7-26	SK305671	Selector Knob	CN-6337
7-27x	SK305672	Selector Knob (BL)	CN-6337
7-28	SZ305690	Meter Cover	CN-6395
7-29	BC305744	Upper Cover (A)	CN-6323
7-30x	BC305743	Upper Cover (B) (AAL)	CN-6323
7-31	ZS306798	S Tight Screw, 4x8 (Blnd)(Black)	
7-32x	ZS463353	Tapping Screw #2, 3x8 (BR) (Black)	

When ordering parts, please describe Parts Number, Description, and Model Number in detail.

8. LIST OF INTERCHANGEABLE SEMICONDUCTORS

If, while servicing, the original parts cannot be obtained, the interchangeable parts listed below can be substituted.

Original Parts			Interchangeable Parts	
Description	Parts No.	Utilizing P.C Board	Description	Parts No.
2SC945L (P)	ET638504	CN-5301A	2SC1641 (Q) (R) (S) (E)	ET603843
2SC945L (Q)	ET399846	CN-5301A	2SC536 (E) (F) (G) (H)	ET246846
2SC945L (Q) (P)	ET639437	CN-5301A	2SC536 (F) (G) (H)	ET632215
			2SC711 (E) (F) (G) (H)	ET619727
2SC1162 (C) (D)	ET301154	CN-5330		
2SC1211 (E)	ET520266	CN-5301A	2SC1175 (E) (F)	ET622080
2SC1312S (G) (H)	ET603257	CN-5301A	2SC458LG (C)	ET234854
			2SC693U (F)	ET315472
2SK117 (GR)	ET303697	CN-5301A		
1N34A	ED219464	CN-5301A	1S188AM 1N60	ED562386 ED428264
1S2473	ED624903	CN-5301A	1S1588	ED557447
W03B	ED306109	CN-5330		
WZ-192	ED498150	CN-5330		
GL-3ARI	ED249377	CN-5304		
GL-3PG1	ED283138	CN-5304		
BiPi	ED306110	CN-5330		

INDEX

Parts No.	Ref. No. & Symbol No.	Parts No.	Ref. No. & Symbol No.	Parts No.	Ref. No. & Symbol No.	Parts No.	Ref. No. & Symbol No.	Parts No.	Ref. No. & Symbol No.
BA305851	(2)-1	ES655806	(2)-SW1	TC281788	4-19	ZS588101	(1)-3		
BA305852	(2)-2	ES665807	(2)-SW1	TC282047	4-1	ZS608253	4-72		
BA305854	(2)-3	ES665875	(2)-SW1	TC282137	4-18	ZS650013	4-50x		
BA305855	(2)-4	ET301154	(2)-TR1	TC282161	4-21	ZW263946	(1)-4		
BA305856	(2)-5	ET301154	(2)-TR4	TC282194	4-29	ZW270888	2-19		
BA305857	(2)-6	ET303697	(1)-TR5	TC282227	4-46	ZW270888	4-25		
BA305863	(1)-1	ET398711	(2)-TR3	TC282238	4-2	ZW270888	6-7		
BC305743	7-30x	ET399846	(1)-TR3	TC282262	4-27	ZW270401	7-7x		
BC305744	7-29	ET520266	(1)-TR10,11	TC282396	4-56	ZW273690	2-8		
BD305863	7-2x	ET563905	(2)-TR2	TC286007	2-16	ZW273734	2-15		
BD305864	7-3x	ET603257	(1)-TR1to3	TC289484	(1)-9	ZW273802	(1)-6		
BD305885	7-17	ET638504	(1)-TR7,8	TC305664	6-5	ZW273802	6-32x		
BF305887	3-2	ET639437	(1)-TR6	TC305728	6-15	ZW282407	2-21		
BH305861	2-2x	ET639437	(1)-TR9	TC305729	6-2	ZW282407	4-22		
BK305797	4-66	EV305630	6-37	TC305762	4-64	ZW282420	4-35		
BK305798	4-69x	EV305631	6-36	TC306770	7-4x	ZW282442	3-3		
BL282508	4-38	EV464207	(1)-VR1	TC515575	4-54	ZW287458	4-74x		
BL282510	4-30	EV464220	(1)-VR2	ZG282115	4-26	ZW290283	6-8		
BL300249	2-1	EV464220	(1)-VR8	ZG282126	4-16	ZW302909	6-44		
BM305865	3-1	EV464220	(1)-VR10	ZG282183	4-24	ZW305013	6-52x		
BT305600	6-19	EV520806	(1)-VR5,6	ZG282251	4-43	ZW381644	4-37		
BT305601	6-20x	EV520806	(1)-VR9	ZG282341	4-58	ZW413267	6-12		
BT305602	6-22x	EV550023	(1)-VR9	ZG282418	4-34	ZW516611	7-8x		
BT305603	6-21x	EW207742	6-27x	ZG282431	4-39	ZW550642	4-73		
BT305604	6-23x	EW306152	6-30x	ZG282464	4-17	ZW603797	6-4x		
BZ280337	3-5	EW524845	6-26x	ZG282690	7-5x	ZW694798	4-20		
BZ282881	4-11	EZ631945	6-28x	ZG289236	2-14				
EC284163	(1)-C60	HE266466	2-3	ZG300171	6-6				
EC286198	(2)-C10	HP300795	2-11	ZG300881	4-60				
EC286222	(2)-C2	MB282093	3-4	ZG300882	4-61				
EC286222	(2)-C8	MB282104	4-28	ZG303225	4-49x				
EC301320	(2)-C10	MB283421	4-12	ZG305620	4-59				
EC301320	(2)-C11	MB305617	4-31	ZG305641	6-18				
EC305677	(1)-C1	MC305717	4-9	ZG305657	7-11x				
EC305678	(1)-C4	MH284188	4-44	ZG305657	7-15x				
EC305680	(1)-C50	ML282240	4-40	ZG305736	2-13				
EC306600	(1)-C7	ML282273	4-41	ZG310453	2-18				
EC306635	(1)-C3	ML282328	4-4	ZG385986	4-15				
EC551160	(2)-C10	ML305618	4-14	ZG387178	4-48				
ED219464	(1)-D1to4	ML305628	6-17	ZG465636	2-5				
ED219464	(1)-D6	ML305683	6-16	ZG606723	4-42				
ED249377	(1)-D5	MS282172	4-23	ZG632553	4-55				
ED249377	6-34	MS305648	(1)-7	ZS200384	4-10x				
ED283138	6-33	MT305769	4-32	ZS201407	4-62				
ED305862	7-1	MT305770	4-36	ZS201407	7-6x				
ED306109	(2)-D3	MT305793	4-33	ZS297628	3-6				
ED306109	(2)-D4	MV357208	4-57	ZS300626	2-12				
ED306110	(2)-D1	MZ282330	4-5	ZS301574	6-29x				
ED496150	(2)-D2	SA305646	6-10	ZS301576	6-24				
ED624903	(1)-D7	SE305651	7-14x	ZS303628	2-7				
EF304626	(2)-F1,2	SE306143	7-9	ZS306021	6-13				
EF563681	(2)-F1,2	SE306144	7-10x	ZS306078	4-65				
EF593706	(2)-F1,2	SK305653	7-12	ZS306798	7-31				
EF593706	(2)-F3	SK305654	7-16x	ZS307259	6-51x				
EI306141	(1)-IC2	SK305656	7-13x	ZS326495	(1)-5				
EI605013	(1)-IC1	SK305668	7-22	ZS325495	6-1				
EJ183094	(1)-J1	SK305669	7-30	ZS356804	2-9				
EJ301513	6-25	SK305670	7-24	ZS356815	2-10				
EJ305629	6-35	SK305671	7-26	ZS374646	4-47				
EJ305739	(1)-J1	SK305672	7-27x	ZS375118	2-4				
EL283184	4-53	SK305674	7-18	ZS379350	(1)-2				
EM305633	6-40x	SK306096	4-67	ZS379350	(2)-8				
EM305634	6-39	SK306097	4-68	ZS391822	2-6				
EM306132	6-41x	SK306098	4-70x	ZS417216	(1)-8				
EO283050	(1)-T1	SK306099	4-71x	ZS417216	4-51				
EO656943	(1)-L2	SK306103	7-23x	ZS417251	4-3				
EO691741	(1)-L1	SK306104	7-21x	ZS422076	(2)-7				
ER305676	(1)-FL1	SK306105	7-25x	ZS422076	2-17				
ER305722	(1)-R48	SK306130	7-19x	ZS422076	4-63x				
ER305722	(1)-R54	SP305698	6-42	ZS422076	6-3x				
ER306127	(2)-R1	SP305746	6-9	ZS432843	2-20x				
ER306639	(1)-R32	SP306153	6-46x	ZS432843	4-13				
ER306642	(1)-R3	SP306154	6-48x	ZS447840	3-7				
ES283151	4-7	SP306155	6-47x	ZS447840	4-6				
ES283173	4-52	SP306156	6-45	ZS447840	6-31x				
ES301747	6-14	SP306159	6-50x	ZS463353	7-32x				
ES305713	(1)-SW3	SP306160	6-49x	ZS498273	6-11				
ES305727	(1)-SW2	SP306170	6-43x	ZS523664	4-75x				
ES306134	(2)-SW2	SZ305690	7-28	ZS523664	6-38x				
ES312050	(1)-SW1	TC288468	4-45	ZS537085	4-8				

SECTION 3

SCHEMATIC DIAGRAM

1. GXC-706D NO. 1561250A SCHEMATIC DIAGRAM

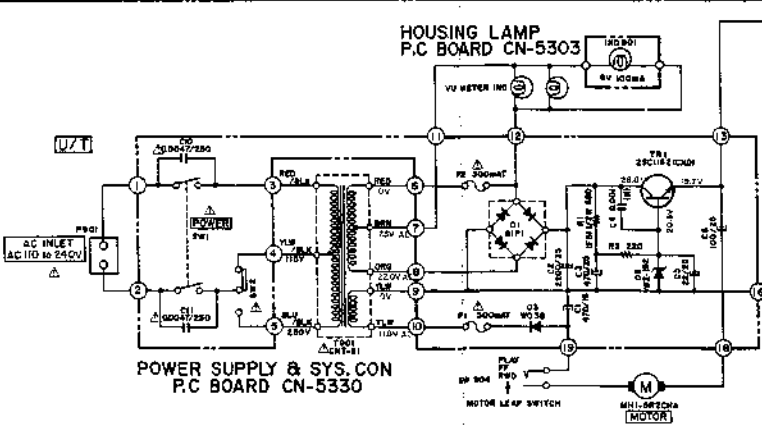
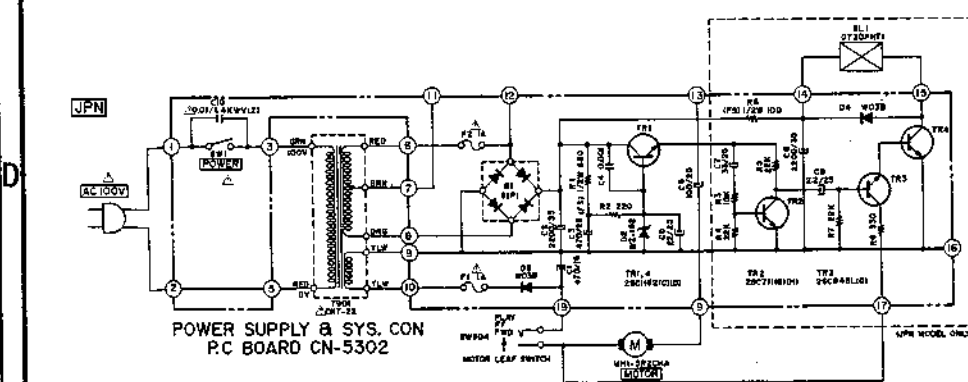
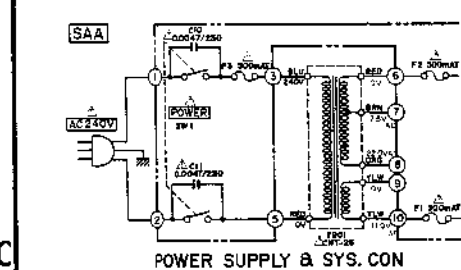
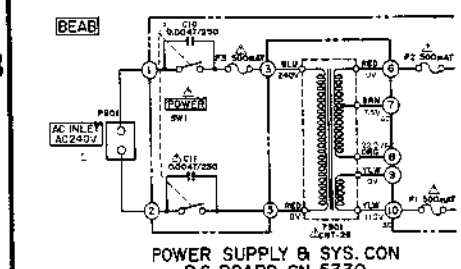
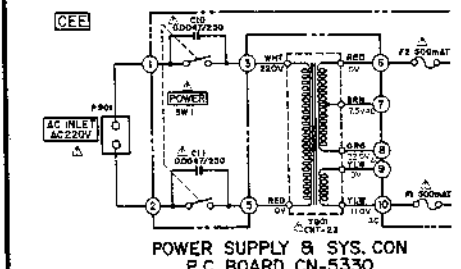
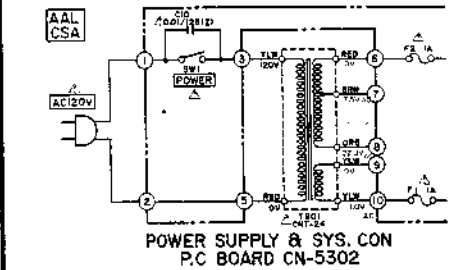
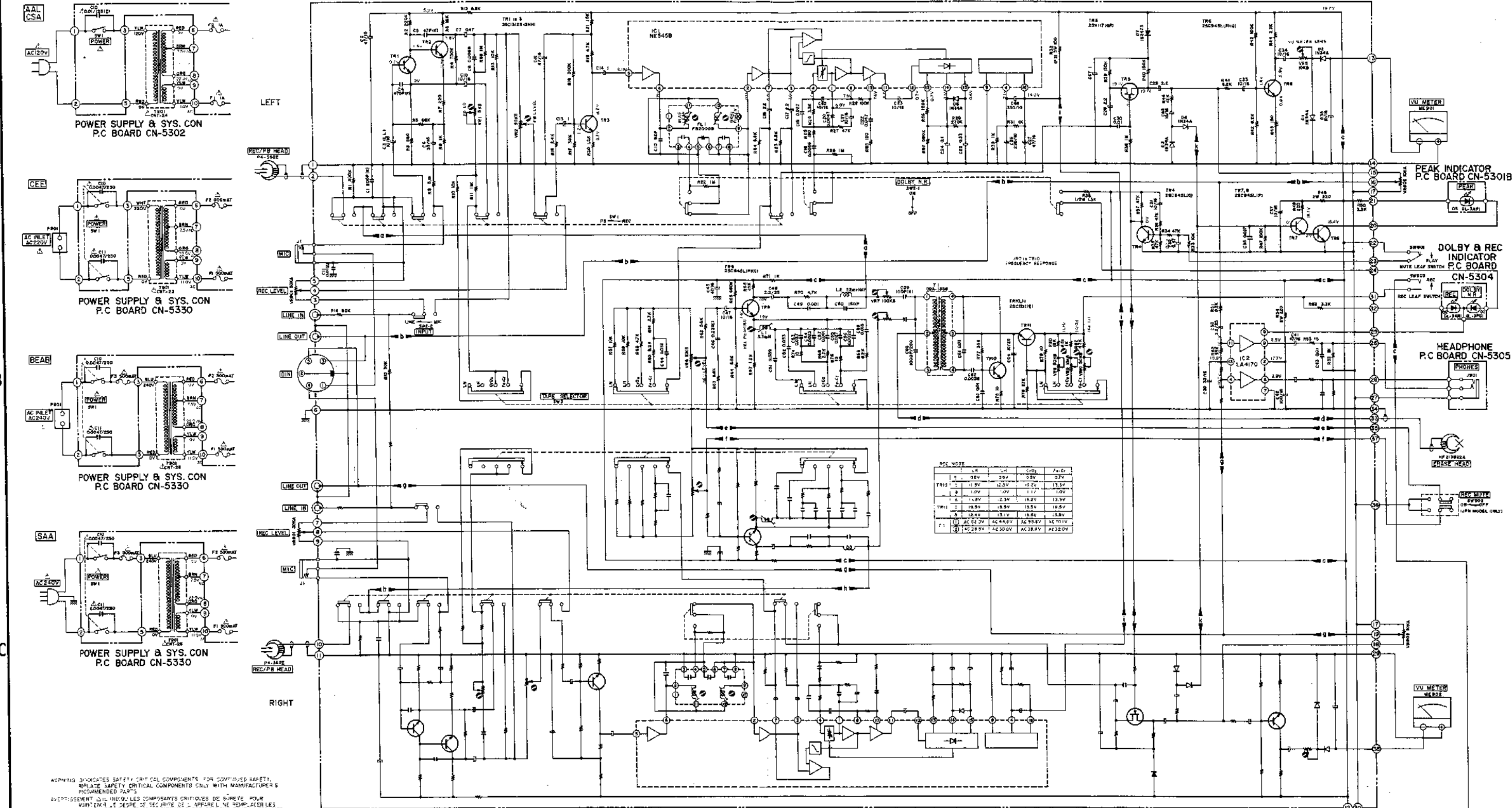

REC MODE

TR10	TR9	TR8	TR7	TR6	TR5	TR4	TR3	TR2	TR1
1	1.8V	3.6V	0.8V	0.3V	1.3V	1.3V	1.3V	1.3V	1.3V
2	1.8V	3.6V	0.8V	0.3V	1.3V	1.3V	1.3V	1.3V	1.3V
3	1.8V	3.6V	0.8V	0.3V	1.3V	1.3V	1.3V	1.3V	1.3V
4	1.8V	3.6V	0.8V	0.3V	1.3V	1.3V	1.3V	1.3V	1.3V
5	1.8V	3.6V	0.8V	0.3V	1.3V	1.3V	1.3V	1.3V	1.3V
6	1.8V	3.6V	0.8V	0.3V	1.3V	1.3V	1.3V	1.3V	1.3V
7	1.8V	3.6V	0.8V	0.3V	1.3V	1.3V	1.3V	1.3V	1.3V
8	1.8V	3.6V	0.8V	0.3V	1.3V	1.3V	1.3V	1.3V	1.3V
9	1.8V	3.6V	0.8V	0.3V	1.3V	1.3V	1.3V	1.3V	1.3V
10	1.8V	3.6V	0.8V	0.3V	1.3V	1.3V	1.3V	1.3V	1.3V

WARNING: INDICATES SAFETY CRITICAL COMPONENTS FOR CONTINUED SAFETY. REPLACE SAFETY CRITICAL COMPONENTS ONLY WITH MANUFACTURER'S RECOMMENDED PARTS.

AVERTISSEMENT: IL INDIQUE LES COMPOSANTS CRITIQUES DE SURETE. POUR MONTREUR LE DEGRE DE SECURITE DE L'APPAREIL NE REMPLACEZ LES COMPOSANTS QU'AVEC LE POMPONNEMENT EST CRITIQUE POUR LA SECURITE DE PAR DES PIECES RECOMMENDEES PAR LE FABRICANT.

NOTE
UNLESS OTHERWISE SPECIFIED
ALL RESISTORS IN OHMS (1/4W/1)
ALL CAPACITORS IN μ F (50WV/1)
IF S-FAIL SAFE RESISTORS
ILLUSTRATED CAPACITORS